

RESTORATION OF WORK AREA, RESTORATION OF THE TRAFFIC SIGNAL WORK AREA SHALL BE INCLUDED IN THE RELATED PAY ITEM SUCH AS FOUNDATION, CONDUIT, HANDHOLE, TRENCH AND BACKFILL, ETC., AND NO EXTRA COMPENSATION SHALL BE ALLOWED. ALL ROADWAY SURFACES SUCH AS SHOULDERS, MEDIAN, SIDEWALKS, PAVEMENT ETC. SHALL BE REPLACED IN KIND. ALL DAMAGE TO MOWED LAWNS SHALL BE REPLACED WITH AN APPROVED SOD, AND ALL DAMAGE TO UNMOWED FIELDS SHALL BE SEEDED IN ACCORDANCE WITH STANDARD SPECIFICATIONS 252 AND 250 RESPECTIVELY.

FOR "NOTES FOR TEMPORARY TRAFFIC SIGNALS" SEE SHEET NO. 15

CONSTRUCTION NOTES

- ① MAINTAIN DURING TEMPORARY TRAFFIC SIGNAL OPERATIONS. REMOVE / ABANDON AS INDICATED IN THE PLANS AFTER PROPOSED TRAFFIC SIGNAL INSTALLATION IS COMPLETE AND FULLY OPERATIONAL.
- ② REBUILD EXISTING HANDHOLE. EXISTING AND PROPOSED ELECTRIC CABLES SHALL BE MAINTAINED AT ALL TIMES DURING THIS WORK.
- ③ RELOCATE EXISTING EVP DETECTOR UNITS AND CONFIRMATION BEACONS TO THE NEW MAST ARMS.
- ④ RELOCATE EXISTING EVP PHASING UNITS TO THE NEW CONTROLLER CABINETS.



MATCH LINE STA. 731+00

MATCH LINE STA. 736+50

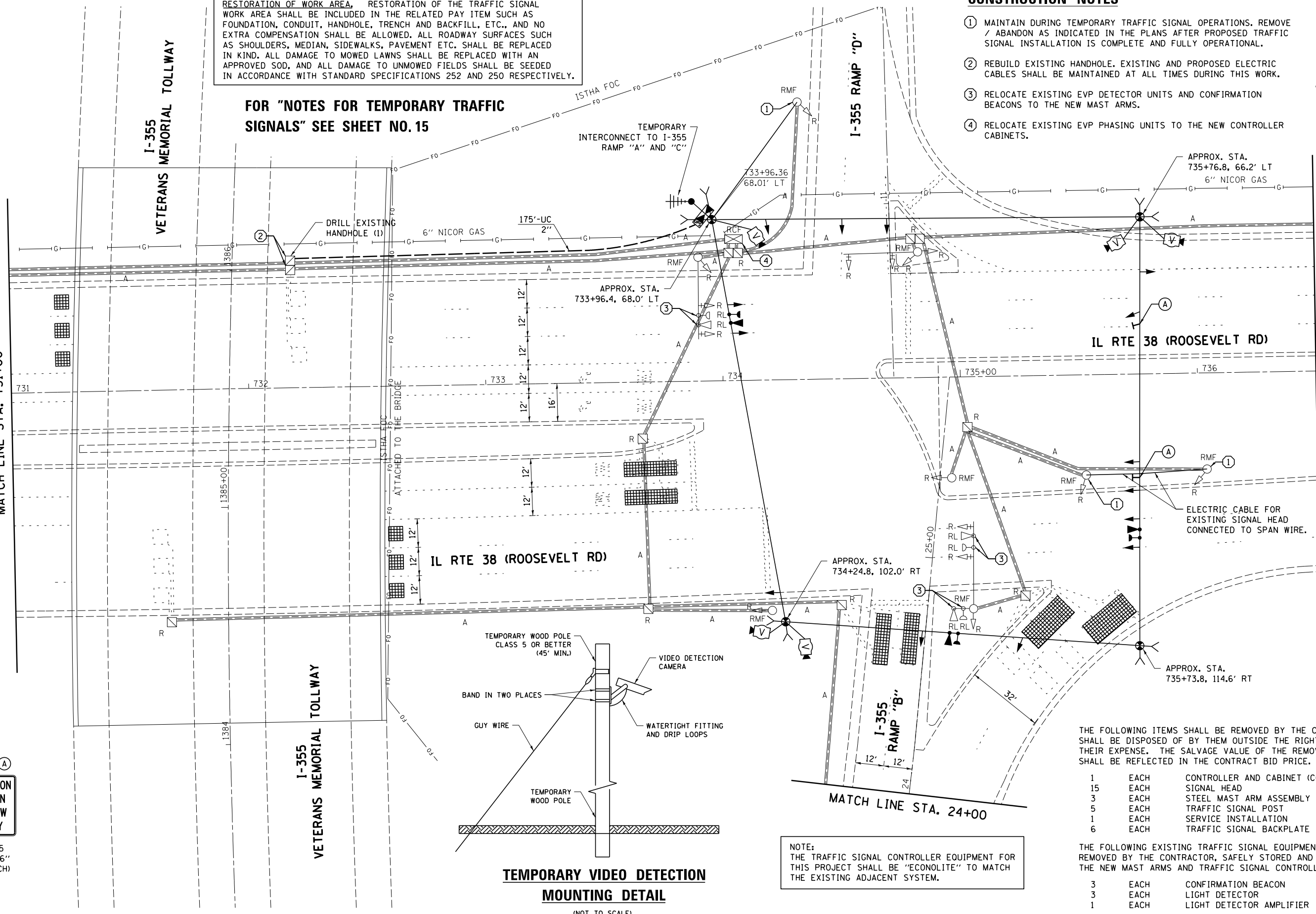

SIGN (A)
LEFT ON GREEN ARROW ONLY
 R10-5
 30"x36"
 (2 EACH)

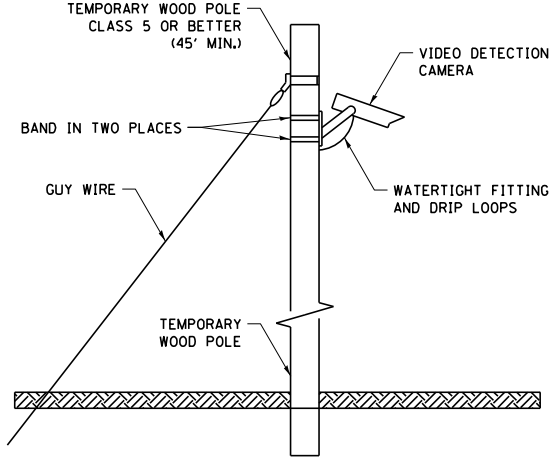

NOTE:
 THE TRAFFIC SIGNAL CONTROLLER EQUIPMENT FOR THIS PROJECT SHALL BE "ECONOLITE" TO MATCH THE EXISTING ADJACENT SYSTEM.

THE FOLLOWING ITEMS SHALL BE REMOVED BY THE CONTRACTOR AND SHALL BE DISPOSED OF BY THEM OUTSIDE THE RIGHT-OF-WAY AT THEIR EXPENSE. THE SALVAGE VALUE OF THE REMOVED EQUIPMENT SHALL BE REFLECTED IN THE CONTRACT BID PRICE.

1	EACH	CONTROLLER AND CABINET (COMPLETE)
15	EACH	SIGNAL HEAD
3	EACH	STEEL MAST ARM ASSEMBLY AND POST
5	EACH	TRAFFIC SIGNAL POST
1	EACH	SERVICE INSTALLATION
6	EACH	TRAFFIC SIGNAL BACKPLATE

THE FOLLOWING EXISTING TRAFFIC SIGNAL EQUIPMENT SHALL BE REMOVED BY THE CONTRACTOR, SAFELY STORED AND RELOCATED TO THE NEW MAST ARMS AND TRAFFIC SIGNAL CONTROLLER.

3	EACH	CONFIRMATION BEACON
3	EACH	LIGHT DETECTOR
1	EACH	LIGHT DETECTOR AMPLIFIER