

# FOR INFORMATION ONLY

Bench Mark; chiseled Sq.  
at S.W. Corner on Concrete  
Bridge Rail on East Side  
La Grange Rd. Bridge over I-55.  
El. 644.42

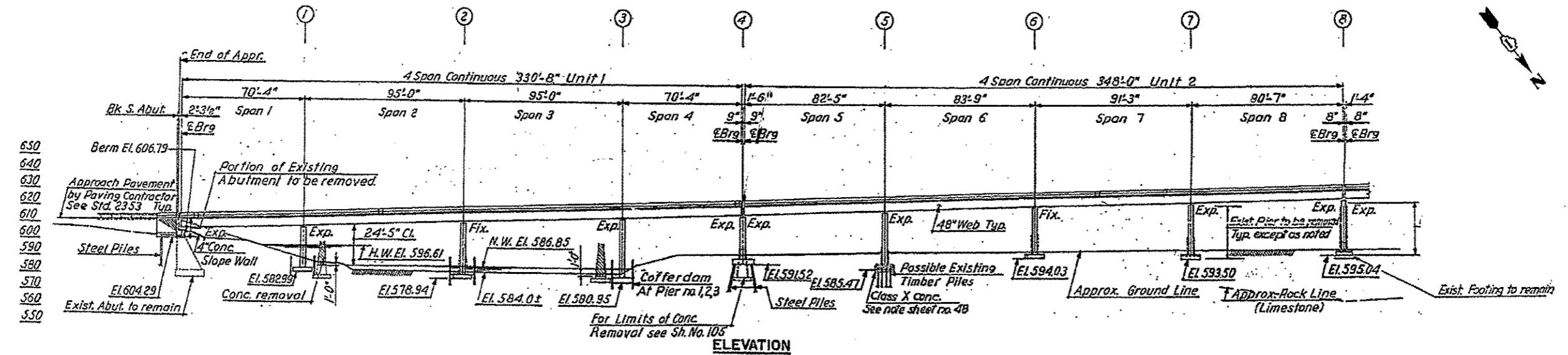
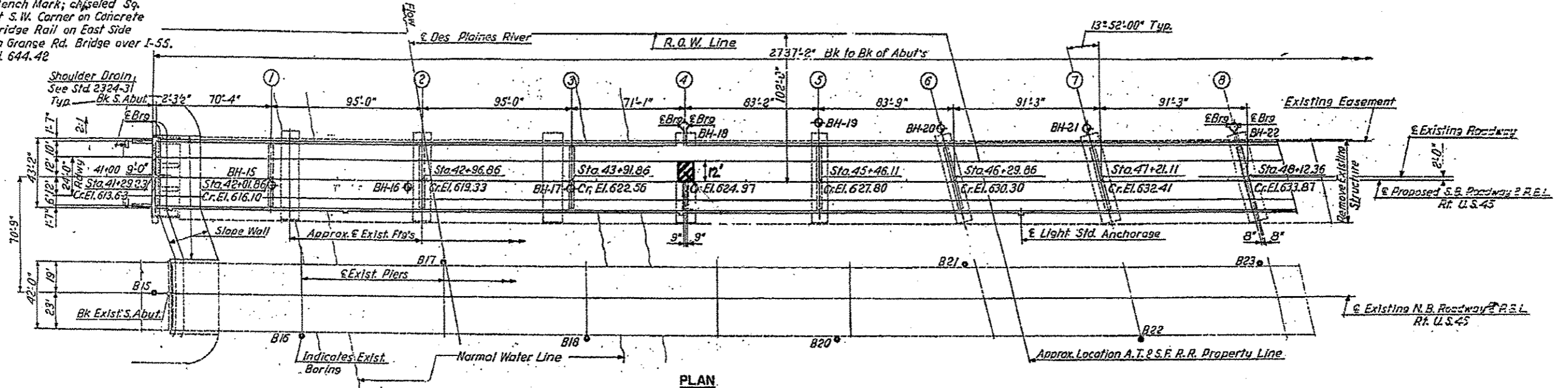

FILE NAME *	USER NAME * r10afj	DESIGNED -	REVISED -	STATE OF ILLINOIS DEPARTMENT OF TRANSPORTATION	EXISTING BRIDGE PLAN		F.A.P. RTE.	SECTION	COUNTY	TOTAL SHEETS	SHEET NO.
c:\pwwork\p10afj\10afj\08313773\010851	shs-plan.dgn	DRAWN -	REVISED -		SN 016-2407: US 12/2045 OVER DES PLAINES RIVER & SANTA FE DR	330	2012-054 BP	COOK	75	28	
	PLOT SCALE = 1/8" = 1'-0"	CHECKED -	REVISED -		SCALE:	SHEET 1	OF 16 SHEETS	STA.	TO STA.	CONTRACT NO. 60V56	
#MODELNAME	PLOT DATE = 9/28/2012	DATE -	REVISED -		ILLINOIS FED. AID PROJECT						