

SURVEYED PLOTTED
 SURVEY PLOTTED
 NOTE BOOK TEMPLATE
 NO. SHEETS 78
 AREAS CHECKED
 FILE NAME: M:\255-012 Lawrence Phase II\CROSS SECTION\255-012-MCHENRY-080612.dwg

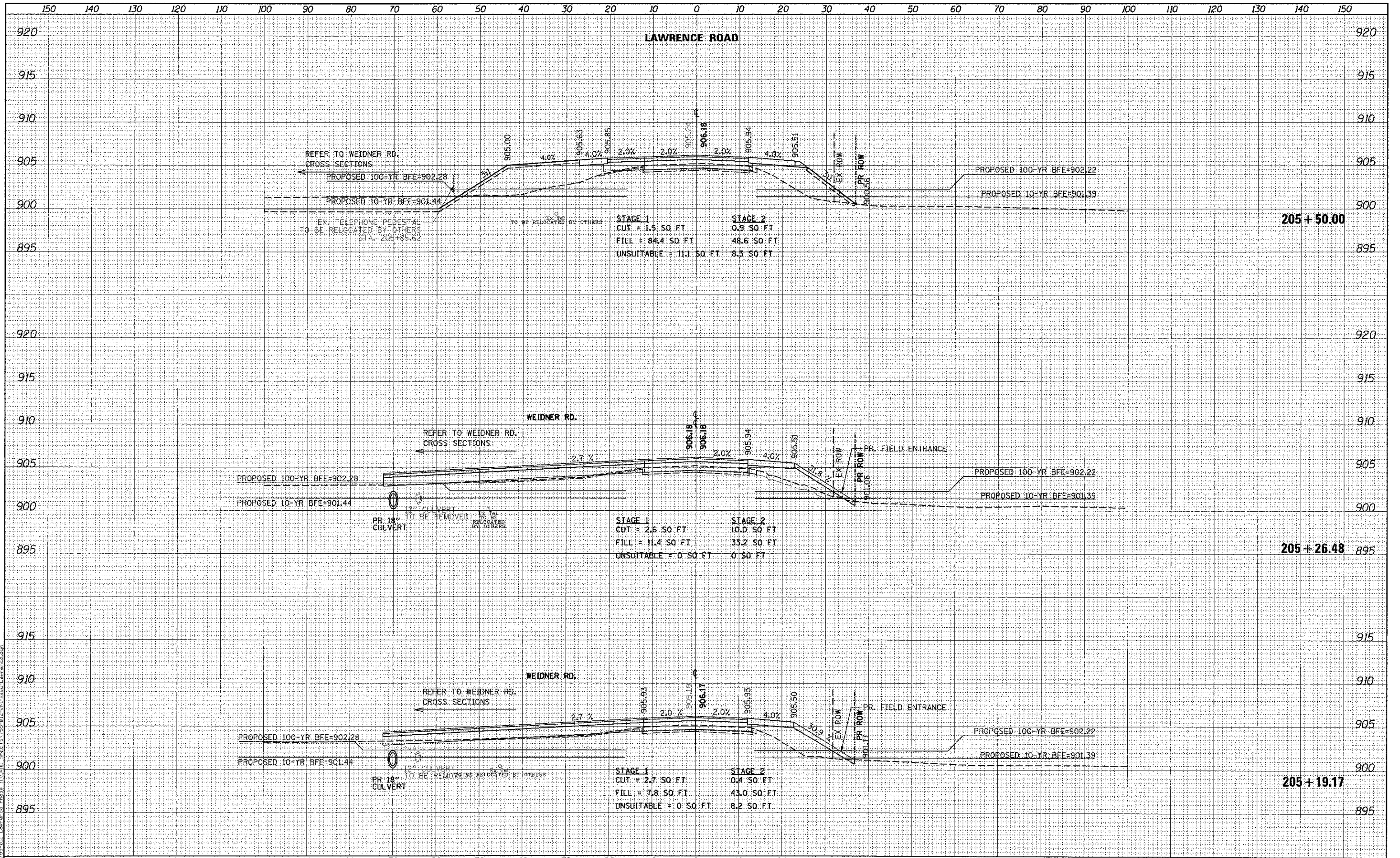

Bollinger, Lach & Associates, Inc.
 ITASCA, ILLINOIS

USER NAME = gullwanger
 PLOT SCALS = 1/4"=100' HZ
 PLOT DATE = 10/3/2012

DESIGNED - GJE	REVISED -
DRAWN - GJE	REVISED -
CHECKED - CRF	REVISED -
DATE - 06/17/12	REVISED -

MCHENRY COUNTY
DIVISION OF TRANSPORTATION

LAWRENCE ROAD BRIDGE OVER PISCASAW CREEK
LAWRENCE ROAD CROSS SECTION
 1"=5' VT
 SCALE: 1"=10' HZ

F.A.S. RTE. 0028	SECTION 08-00355-01-BR	COUNTY MCHENRY	TOTAL SHEETS 87	SHEET NO. 78
			CONTRACT NO. 63694	
ILLINOIS FED. AID PROJECT				

SHEET NO. 78 OF 87 SHEETS STA. 205+19.17 TO STA. 205+50.00