

STATE OF ILLINOIS
DEPARTMENT OF TRANSPORTATION
DIVISION OF HIGHWAYS

F. A. I. I. NO.	SECTION	COUNTY	TOTAL SHEETS	SHEET NO.
1041	11-00030-00-RS	COOK	10	1
STA. 100+67		TO STA. 125+92		
FED. ROAD DIST. NO. 1		ILLINOIS	FED. AID PROJECT M-9003 (914)	

CONTRACT #63739

PLANS FOR PROPOSED FEDERAL AID HIGHWAY

- INDEX OF SHEETS**
- COVER SHEET, INDEX OF SHEETS & STATE STANDARDS
 - SUMMARY OF QUANTITIES & GENERAL NOTES
 - TYPICAL CROSS SECTIONS
 - PAVEMENT PLAN
 - PAVEMENT MARKINGS
 - 6.-10. IDOT DISTRICT 1 DETAILS

- HIGHWAY STANDARDS**
- | | |
|-----------|--|
| 000001-06 | STANDARD SYMBOLS, ABBREVIATIONS AND PATTERNS |
| 424001-06 | PERPENDICULAR CURB RAMPS FOR SIDEWALKS |
| 442201-03 | CLASS C AND D PATCHES |
| 606001-04 | CONCRETE CURB TYPE B AND COMBINATION CURB AND GUTTER |
| 701501-06 | URBAN LANE CLOSURE, 2L, 2W UNDIVIDED |
| 701801-05 | LANE CLOSURE, MULTILANE 1W OR 2W CROSSWALK |
| 701901-02 | TRAFFIC CONTROL DEVICES |

**FAU 1041 (223RD STREET)
NICHOLS DRIVE TO MURPHY AVENUE
ROAD RESURFACING
SECTION NO.: 11-00030-00-RS
PROJECT NO.: M-9003 (914)
VILLAGE of SAUK VILLAGE
COOK COUNTY
JOB NO. C-91-175-12**

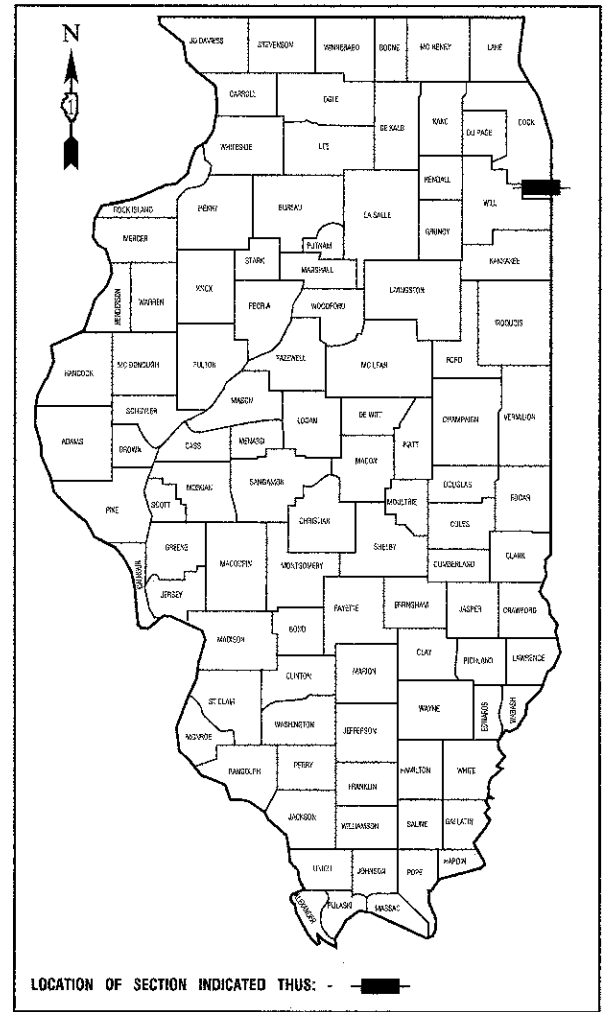

	<u>SOME ST. & OTHER ST</u>
2006 ADT -	3,000
2030 ADT -	3,000
POSTED SPEED LIMIT -	25 mph
DESIGN PERIOD -	20 YEARS
DESIGN SPEED LIMIT -	30 mph
STREET CLASSIFICATION -	LOCAL COLLECTOR

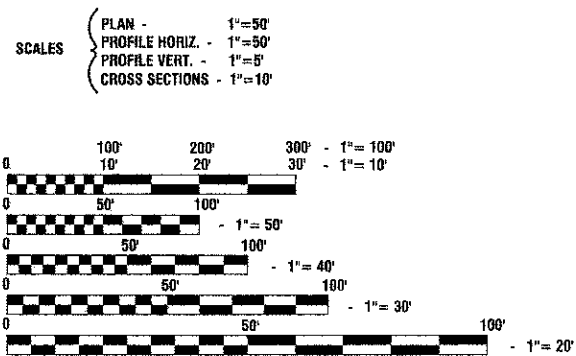

FULL SIZE PLANS HAVE BEEN PREPARED USING STANDARD ENGINEERING SCALES, REDUCED SIZED PLANS WILL NOT CONFORM TO STANDARD SCALES, IN MAKING MEASUREMENTS ON REDUCED PLANS, THE ABOVE SCALES MAY BE USED.

J. U. L. I. E.
JOINT UTILITY LOCATION INFORMATION FOR EXCAVATION
1 - 800 - 892 - 0123 or 811

BEGINNING OF IMPROVEMENTS
223RD ST STA 100+67.08

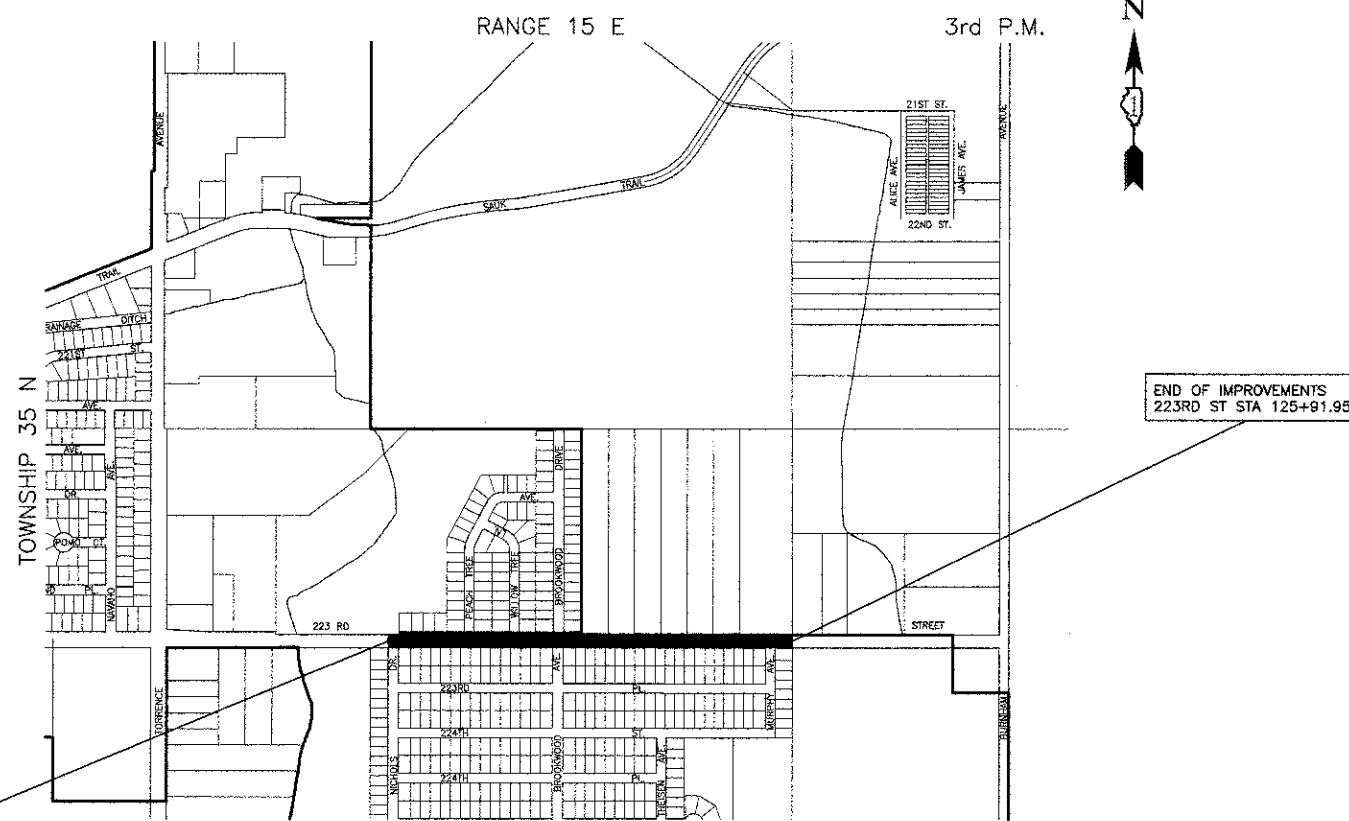

LOCATION MAP

GROSS LENGTH=2520 FEET=0.48 MILES
NET LENGTH=2520 FEET=0.48 MILES

STATE OF ILLINOIS DEPARTMENT OF TRANSPORTATION
DIVISION OF HIGHWAYS

Approved: [Signature] 8-14-12
President, Village of Sauk Village

Passed: [Signature] August 23, 2012
District 1 Engineer of Local Roads & Streets

Released for Bid Based on Limited Review: [Signature] August 23 2012
Deputy Director of Highways, Region 1 Engineer

PRINTED BY THE AUTHORITY OF THE STATE OF ILLINOIS

PREPARED BY OR UNDER THE DIRECT SUPERVISION OF:

[Signature]
8-10-12

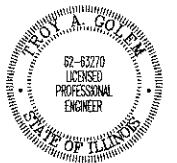

ISSUE DATES: 11/30/13

PROGRAM AND OFFICE ENGINEER: CHARLES F. RIDDLE, P.E. (847) 705-4406, SCHAUMBURG, IL
CONSULTANTS: ROBINSON ENGINEERING, LTD. 708-331-6700

CONTRACT NO. 63739

SUMMARY OF QUANTITIES					CONSTRUCTION TYPE CODE
S.I.	CODE NO.	PAY ITEM	UNIT	QUAN	0005
	21101615	TOPSOIL FURNISH AND PLACE, 4"	SQ YD	542	542
	25200200	SUPPLEMENTAL WATERING	UNIT	2	2
	28000510	INLET FILTERS	EACH	5	5
	35101600	AGGREGATE BASE COURSE, TYPE B 4"	SQ YD	130	130
	40600100	BITUMINOUS MATERIALS (PRIME COAT)	GALLON	2710	2710
	40600300	AGGREGATE (PRIME COAT)	TON	28	28
	40600400	MIXTURE FOR CRACKS, JOINTS, AND FLANGEWAYS	TON	10	10
	40600827	POLYMERIZED LEVELING BINDER (MACHINE METHOD), IL-4.75, N50	TON	586	586
	40600982	HOT-MIX ASPHALT SURFACE REMOVAL - BUTT JOINT	SQ YD	262	262
	40603335	HOT-MIX ASPHALT SURFACE COURSE, MIX "D", N50	TON	1171	1171
	42300200	PORTLAND CEMENT CONCRETE DRIVEWAY PAVEMENT, 6 INCH	SQ YD	41	41
	42400200	PORTLAND CEMENT CONCRETE SIDEWALK 5 INCH	SQ FT	800	800
	42400800	DETECTABLE WARNINGS	SQ FT	156	156
	44000157	HOT-MIX ASPHALT SURFACE REMOVAL, 2"	SQ YD	13528	13528
	44000200	DRIVEWAY PAVEMENT REMOVAL	SQ YD	293	293
	44000600	SIDEWALK REMOVAL	SQ FT	800	800
	44201713	CLASS D PATCHES, TYPE I, 6 INCH	SQ YD	4	4
	44201717	CLASS D PATCHES, TYPE II, 6 INCH	SQ YD	81	81
	44201721	CLASS D PATCHES, TYPE III, 6 INCH	SQ YD	76	76
	44201723	CLASS D PATCHES, TYPE IV, 6 INCH	SQ YD	1641	1641
	60250200	CATCH BASINS TO BE ADJUSTED	EACH	5	5
	60266600	VALVE BOXES TO BE ADJUSTED	EACH	3	3
	67100100	MOBILIZATION	L SUM	1	1
	70102620	TRAFFIC CONTROL AND PROTECTION, STANDARD 701501	L SUM	1	1

* - INDICATES SPECIALTY ITEMS

SUMMARY OF QUANTITIES					CONSTRUCTION TYPE CODE
S.I.	CODE NO.	PAY ITEM	UNIT	QUAN	0005
	70102640	TRAFFIC CONTROL AND PROTECTION, STANDARD 701801	L SUM	1	1
*	78000400	THERMOPLASTIC PAVEMENT MARKING - LINE 6"	FOOT	905	905
*	78000650	THERMOPLASTIC PAVEMENT MARKING - LINE 24"	FOOT	175	175
	X2520700	SODDING, SPECIAL	SQ YD	542	542
	XX004847	STONE DRIVEWAY REMOVAL	SQ YD	23	23
	XX008200	STABILIZED DRIVEWAY PAVEMENT	SQ YD	275	275
	Z0004562	COMBINATION CURB AND GUTTER REMOVAL AND REPLACEMENT	FOOT	2500	2500

GENERAL NOTES

- BEFORE STARTING ANY EXCAVATION THE CONTRACTOR SHALL CALL "J.U.L.I.E." AT (800) 892-0123 AND (312) 744-7000 FOR FIELD LOCATIONS OF BURIED ELECTRIC, TELEPHONE AND GAS UTILITIES. (48 HOUR NOTIFICATION REQUIRED)
- UTILITIES INDICATED ON THE PLANS ARE PROVIDED FOR THE CONTRACTORS USE AND ARE BASED UPON INFORMATION AVAILABLE AT THE TIME OF THE ADVERTISEMENT FOR BIDS. THE OWNER AND ENGINEER DO NOT GUARANTEE THE ACCURACY OF UTILITY INFORMATION.
- IT SHALL BE THE CONTRACTOR'S RESPONSIBILITY TO VERIFY ALL DIMENSIONS AND CONDITIONS EXISTING IN THE FIELD PRIOR TO CONSTRUCTION AND ORDERING OF MATERIALS.
- THE THICKNESS OF HMA MIXTURE STATED IN THE SPECIFICATIONS IS THE NOMINAL THICKNESS. DEVIATIONS FROM THE NOMINAL THICKNESS WILL BE PERMITTED WHEN SUCH DEVIATIONS OCCUR DUE TO IRREGULARITIES IN THE EXISTING SURFACE OR BASE ON WHICH THE HMA SURFACE IS PLACED.
- ACCESS TO DRIVEWAYS SHALL BE MAINTAINED AT ALL TIMES BY LIMITING CURB AND GUTTER REPAIR TO ONE-HALF THE DRIVEWAY WIDTH AT ONE TIME AS WELL AS TEMPORARY AGGREGATE.
- THE REMOVAL AND/OR REPLACEMENT OF ANY DRIVEWAYS, PAVEMENT, CURB, SIDEWALK, ETC. SHALL BE ACCOMPLISHED BY MEANS OF A SAW CUT JOINT, AT THE DIRECTION OF THE ENGINEER. THIS WORK WILL NOT BE PAID FOR SEPARATELY, BUT SHALL BE INCLUDED IN THE UNIT PRICE FOR THE VARIOUS ITEMS.
- ANY LOOSE MATERIAL DEPOSITED IN THE FLOW LINE OF DITCHES, GUTTERS OR OTHER DRAINAGE STRUCTURES SHALL BE REMOVED BY THE END OF EACH DAY BY THE CONTRACTOR AT THEIR EXPENSE.

FILE NAME = 11999-QUAN-01 - QUAN P01

USER NAME =	DESIGNED -	REVISED -
	CHECKED - TAG	REVISED -
PLOT SCALE =	DRAWN - MED	REVISED -
PLOT DATE = 08-10-12	CHECKED - AG	REVISED -

STATE OF ILLINOIS
DEPARTMENT OF TRANSPORTATION

223RD STREET RESURFACING
NICHOLS DR TO MURPHY AVE
SUMMARY OF QUANTITIES & GENERAL NOTES

FAU RTE.	SECTION	COUNTY	TOTAL SHEETS	SHEET NO.
1041	11-00030-00-RS	COOK	10	2
CONTRACT NO. 63739				
FED. ROAD DIST. NO. 1 ILLINOIS FED. AID PROJECT M-9003 (914)				

SCALE: NONE SHEET NO. 2 OF 10 SHEETS STA. TO STA.

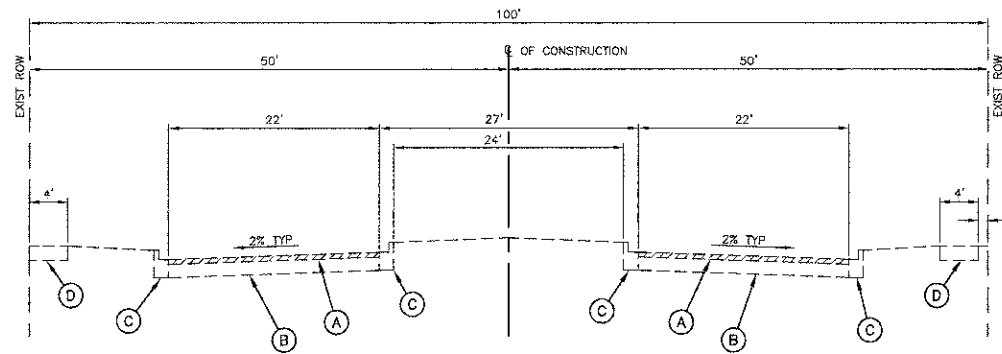

EXISTING TYPICAL SECTION

223RD STREET
NICHOLS DRIVE TO BROOKWOOD DRIVE
STA 100+67.08 TO 111+33

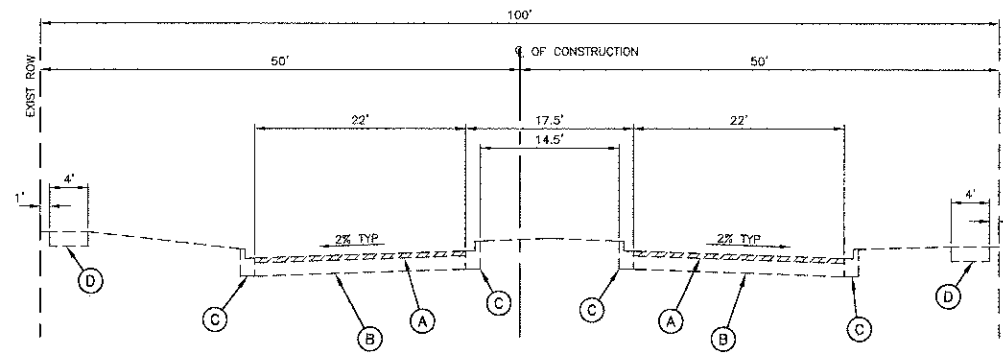

EXISTING TYPICAL SECTION

223RD STREET
BROOKWOOD DRIVE TO MURPHY AVENUE
STA 111+33 TO 125+91

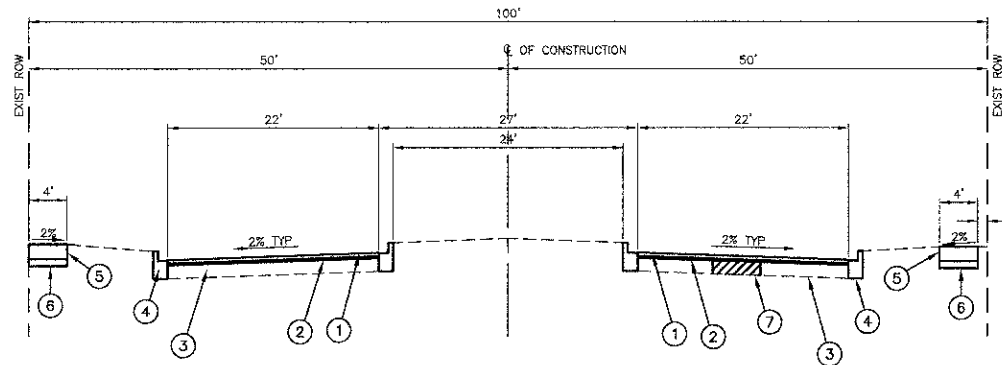

PROPOSED TYPICAL SECTION

223RD STREET
NICHOLS DRIVE TO BROOKWOOD DRIVE
STA 100+67.08 TO 111+33

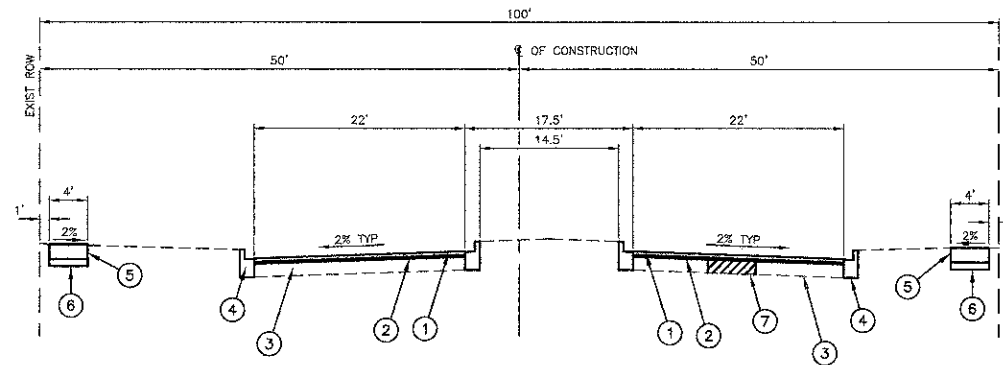

PROPOSED TYPICAL SECTION

223RD STREET
BROOKWOOD DRIVE TO MURPHY AVENUE
STA 111+33 TO 125+91

EXISTING LEGEND

- (A) HOT MIX ASPHALT SURFACE REMOVAL, 2"
- (B) EXISTING PAVEMENT
- (C) COMBINATION CURB & GUTTER REMOVAL AND REPLACEMENT (PER PLANS)
- (D) PCC SIDEWALK, 5" REMOVE AND REPLACEMENT (PER PLANS)

PROPOSED LEGEND

- (1) HOT-MIX ASPHALT SURFACE COURSE, MIX "D", N50 (IL 9.5mm) - 1 1/2"
- (2) POLYMERIZED LEVELING BINDER (MACHINE METHOD) IL-4.75, N50 - 3/4"
- (3) EXISTING PAVEMENT
- (4) COMBINATION CONCRETE CURB AND GUTTER, REPLACEMENT (PER PLANS)
- (5) PORTLAND CEMENT CONCRETE SIDEWALK, 5" REPLACEMENT (PER PLANS)
- (6) AGGREGATE BASE COURSE, TYPE B, 4"
- (7) CLASS D PATCHES, 6" (DIRECTED BY ENGINEER)

HOT-MIX ASPHALT MIXTURE REQUIREMENTS

* CONTRACTOR SHALL MILL BEFORE PATCHING

MIXTURE TYPE	AIR VOIDS
RESURFACING	
HOT MIX ASPHALT SURFACE COURSE, MIX "D", N50(IL-9.5mm); 1 1/2"	4% @ 50 Gyr.
POLYMERIZED LEVELING BINDER (MACHINE METHOD), IL-4.75mm, N50, 3/4"	3.5% @ 50 Gyr.
DRIVEWAYS	
HOT MIX ASPHALT SURFACE COURSE, MIX "D", N50(IL-9.5mm); 2 1/2"	4% @ 50 Gyr.
PATCHING	
CLASS D PATCHES, TYPE I, II, III, IV (HMA BINDER IL-19mm), 6" (2 LIFTS)	4% @ 70 Gyr.

NOTE:

THE UNIT WEIGHT USED TO CALCULATE ALL HMA SURFACE MIXTURE QUANTITIES IS 112 LBS/SY/IN.

THE "AC-TYPE" FOR POLYMERIZED HMA MIXES SHALL BE "SBS/SBR PG 76-22" AND FOR NON-POLYMERIZED HMA, THE "AC-TYPE" SHALL BE "PG 64-22" UNLESS MODIFIED BY DISTRICT ONE SPECIAL PROVISIONS. FOR "PERCENT OF RAP" SEE SPECIAL PROVISIONS.

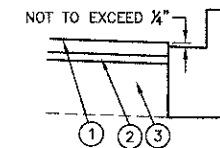

HMA WITH RESPECT TO GUTTER

FILE NAME = 11599-TYP-K01 - TYP 01

USER NAME =	DESIGNED =	REVISED =
PLOT SCALE =	CHECKED = TAG	REVISED =
PLOT DATE = 08-10-12	DRAWN = ACAD	REVISED =
	CHECKED = ACAD	REVISED =

STATE OF ILLINOIS
DEPARTMENT OF TRANSPORTATION

223RD STREET RESURFACING
NICHOLS DR TO MURPHY AVE
TYPICAL CROSS SECTIONS

SCALE: SHEET NO. 3 OF 10 SHEETS STA. TO STA.

F.A.U. RTE.	SECTION	COUNTY	TOTAL SHEETS	SHEET NO.
1041	11-00080-00-RS	COOK	10	3
CONTRACT NO. 63739				
FED. ROAD DIST. NO. 1 ILLINOIS FED. AID PROJECT M-9003 (814)				

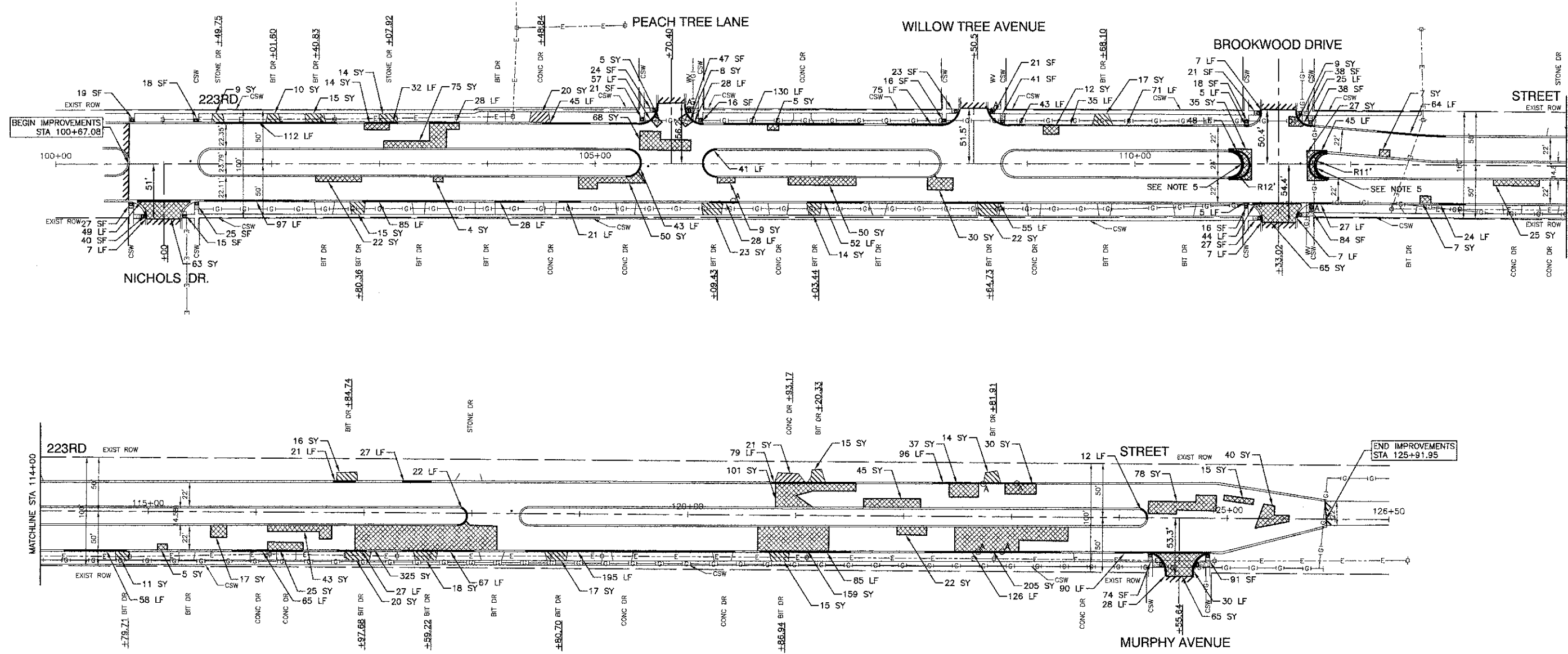

NOTES:

1. DETECTABLE WARNINGS ARE TO BE INSTALLED AT LOCATIONS OF SIDEWALK REMOVAL AND REPLACEMENT. CONTRACTOR TO POSITION AND PLACE DETECTABLE WARNINGS AT THE DIRECTION OF THE ENGINEER IN ACCORDANCE WITH ADA REQUIREMENTS AND IDOT STANDARDS.
2. LIMIT OF CONSTRUCTION ON ALL SIDE STREETS IS THE RADIUS RETURN PLUS 10' BUTT JOINT OR ROW AS NOTED.
3. ACCESS TO ALL DRIVEWAYS SHALL BE MAINTAINED UPON COMPLETION OF EACH WORKDAY. RESIDENTS SHALL BE NOTIFIED 24 HOURS IN ADVANCE OF WHEN DRIVEWAY REPLACEMENT WILL TAKE PLACE.
4. ADDITIONAL PATCHING MAY BE PERFORMED AT THE INSTRUCTION OF THE ENGINEER.
5. PROPOSED CURB AND GUTTER TO BE PAID FOR AS COMBINATION CURB AND GUTTER REMOVAL AND REPLACEMENT.
6. AGGREGATE BASE COURSE, TYPE B, 4" TO BE USED AS BASE OF CONCRETE DRIVEWAYS AND SIDEWALK.

LEGEND

- CLASS D PATCH, 6"
- HMA DRIVEWAY REMOVAL AND REPLACEMENT
- CONCRETE DRIVEWAY REMOVAL AND REPLACEMENT
- CONCRETE SIDEWALK REMOVAL AND REPLACEMENT
- BUTT JOINTS
- CURB AND GUTTER REMOVAL AND REPLACEMENT
- "A" STRUCTURE TO BE ADJUSTED
- "R" STRUCTURE TO BE RECONSTRUCTED
- DETECTABLE WARNING 3'X2' (6 SF)

FILE NAME = 11568-PLAN-01 - IDOT P01

USER NAME =	DESIGNED ---	REVISED --
CHECKED --- TAG	CHECKED --- TAG	REVISED --
PLOT SCALE =	DRAWN --- MED	REVISED --
PLOT DATE = 08-10-12	CHECKED --- AG	REVISED --

**STATE OF ILLINOIS
DEPARTMENT OF TRANSPORTATION**

**NICHOLS DR TO MURPHY AVE
223RD STREET RESURFACING
PAVEMENT PLAN**

SCALE: 1"=50' SHEET NO. 4 OF 10 SHEETS STA. 100+67.08 TO STA. 125+91.95

F.A.U. RTE.	SECTION	COUNTY	TOTAL SHEETS	SHEET NO.
1041	11-00030-00-RS	COOK	10	4
CONTRACT NO. 63739				
FED. ROAD DIST. NO. 1 ILLINOIS FED. AID PROJECT M-9003 (914)				

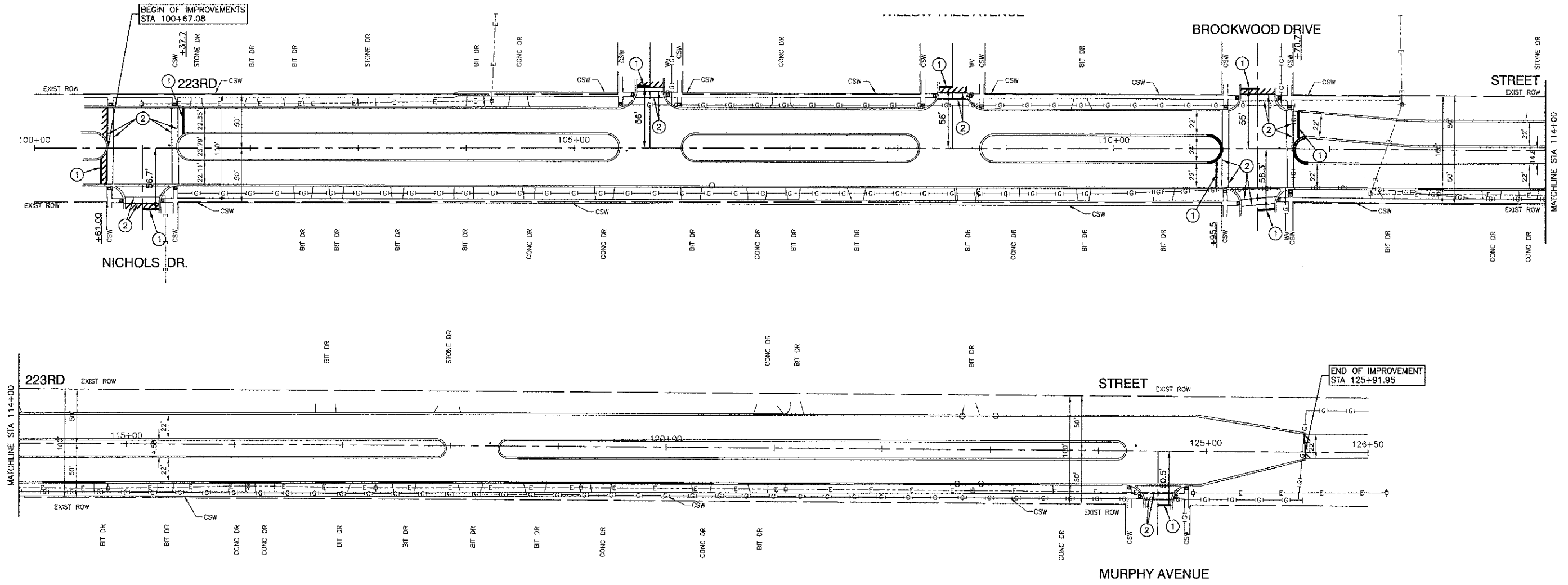

PAVEMENT MARKING LEGEND

- ① THERMOPLASTIC PAVEMENT MARKING
WHITE, 24"
- ② THERMOPLASTIC PAVEMENT MARKING
WHITE, 6"

FILE NAME = 11599-PLAN-01 - IDOT PMRG 01

USER NAME =	DESIGNED =	REVISED =
	CHECKED = TAG	REVISED =
PLOT SCALE =	DRAWN = MED	REVISED =
PLOT DATE = 08-10-12	CHECKED = AG	REVISED =

STATE OF ILLINOIS
DEPARTMENT OF TRANSPORTATION

NICHOLS DR TO MURPHY AVE
223RD STREET RESURFACING
PAVEMENT MARKING

SCALE: 1"=50' SHEET NO. 5 OF 10 SHEETS STA. 100+67.08 TO STA. 125+91.95

F.A.U. RTE.	SECTION	COUNTY	TOTAL SHEETS	SHEET NO.
1041	11-00030-00-RS	COOK	10	5
CONTRACT NO. 63739				
FED. ROAD DIST. NO. 1 ILLINOIS FED. AID PROJECT M-9003 (914)				

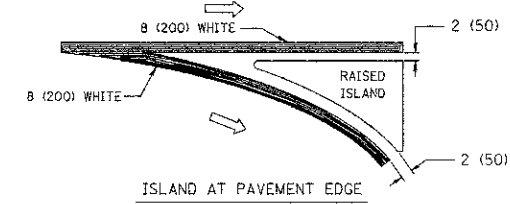
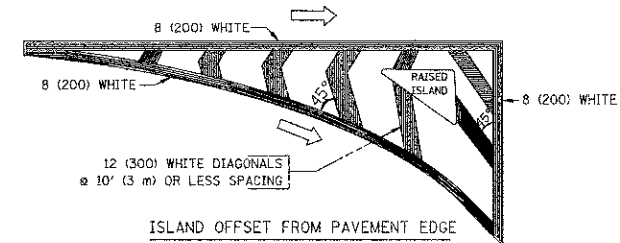
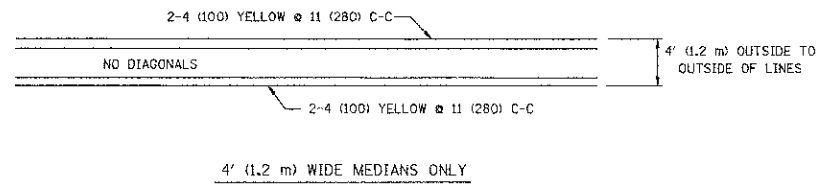
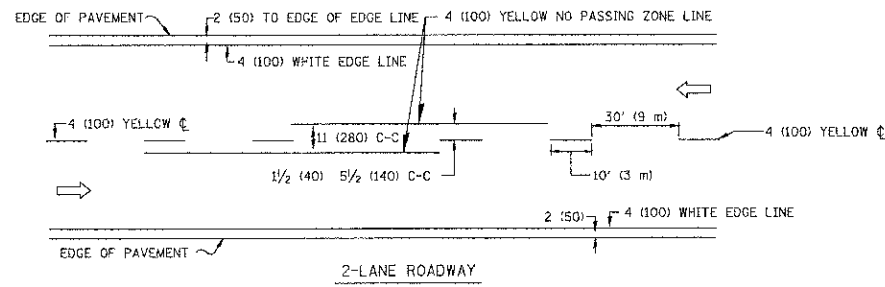

TYPICAL ISLAND MARKING

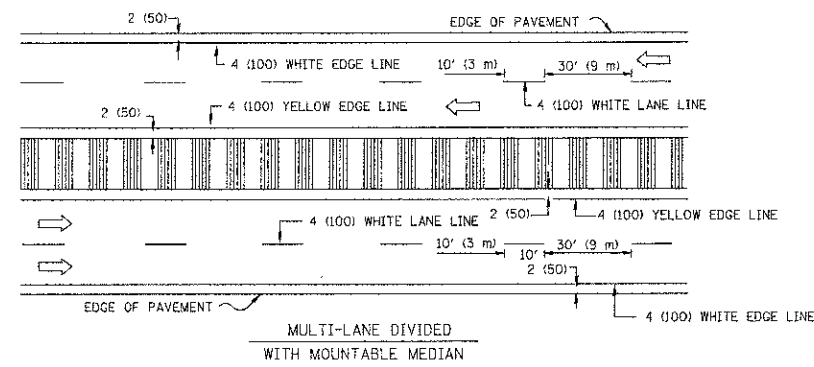
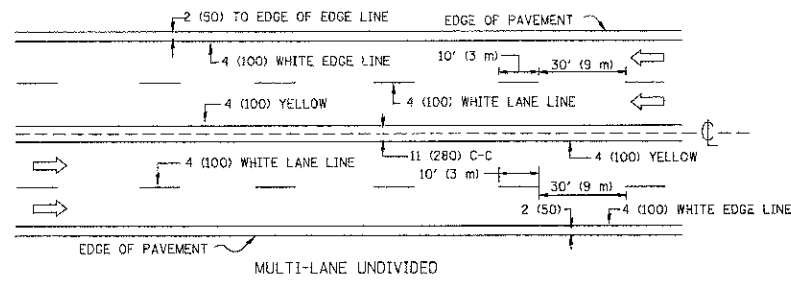

NOTE: MEDIANS WITH BARRIER CURB DO NOT REQUIRE AN EDGE LINE

TYPICAL LANE AND EDGE LINE MARKING

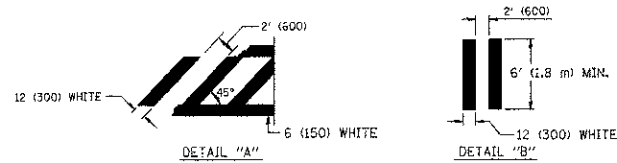
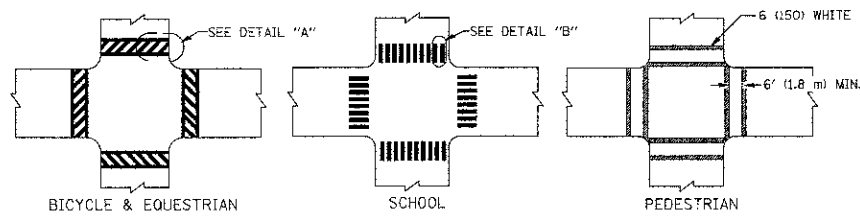

TYPICAL CROSSWALK MARKING

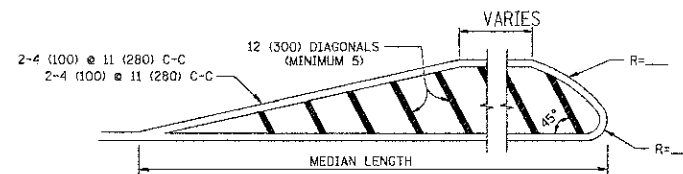

FOR MEDIAN LENGTHS WHERE DIAGONAL SPACING CANNOT BE ATTAINED, USE 5 (FIVE) EQUALLY SPACED DIAGONAL LINES.

DIAGONAL LINE SPACING: 50' (15 m) C-C (LESS THAN 30MPH (50 km/h))
75' (25 m) C-C 30MPH (50 km/h) TO 45MPH (70 km/h)
150' (45 m) C-C (MORE THAN 45MPH (70 km/h))

MEDIANS OVER 4' (1.2 m) WIDE

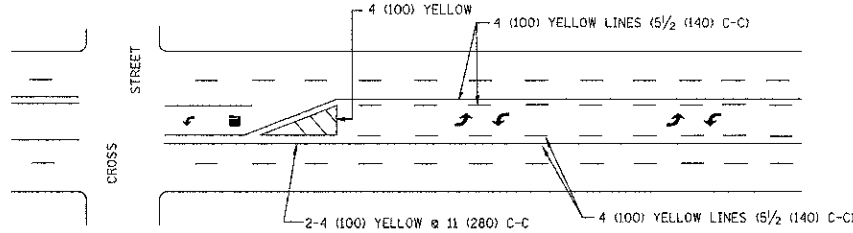

A MINIMUM OF TWO PAIRS OF TURN ARROWS SHALL BE USED, WHITE IN COLOR. ADDITIONAL PAIRS SHALL BE PLACED AT 200' (60 m) TO 300' (90 m) INTERVALS.

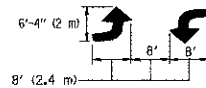

MEDIAN WITH TWO-WAY LEFT TURN LANE

TYPICAL PAINTED MEDIAN MARKING

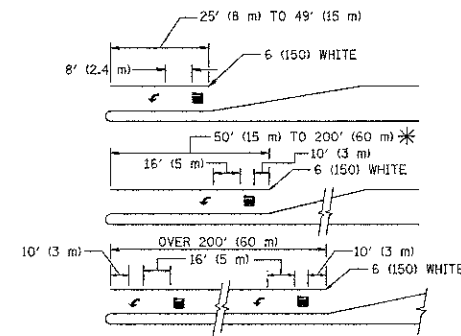

FULL SIZE LETTERS 8' (2.4 m) AND ARROWS SHALL BE USED.
AREA = 15.6 SQ. FT. (1.5 m²) ONLY AREA = 20.6 SQ. FT. (1.9 m²)

* TURN LANES IN EXCESS OF 400' (120 m) IN LENGTH MAY HAVE AN ADDITIONAL SET OF ARROW - "ONLY" INSTALLED MIDWAY BETWEEN THE OTHER TWO SETS OF ARROW - "ONLY".

TYPICAL LEFT (OR RIGHT) TURN LANE

TYPICAL TURN LANE MARKING

TYPE OF MARKING	WIDTH OF LINE	PATTERN	COLOR	SPACING / REMARKS
CENTERLINE ON 2 LANE PAVEMENT	4 (100)	SKIP-DASH	YELLOW	10' (3 m) LINE WITH 30' (9 m) SPACE
CENTERLINE ON MULTI-LANE UNDIVIDED PAVEMENT	2 @ 4 (100)	SOLID	YELLOW	11 (280) C-C
NO PASSING ZONE LINES: FOR ONE DIRECTION FOR BOTH DIRECTIONS	4 (100) 2 @ 4 (100)	SOLID SOLID	YELLOW YELLOW	5/2 (140) C-C FROM SKIP-DASH CENTERLINE 11 (280) C-C OMIT SKIP-DASH CENTERLINE BETWEEN
LANE LINES	4 (100) 5 (125) ON FREEWAYS	SKIP-DASH SKIP-DASH	WHITE WHITE	10' (3 m) LINE WITH 30' (9 m) SPACE
DOTTED LINES (EXTENSIONS OF CENTER, LANE OR TURN LANE MARKINGS)	SAME AS LINE BEING EXTENDED	SKIP-DASH	SAME AS LINE BEING EXTENDED	2' (600) LINE WITH 6' (1.8 m) SPACE
EDGE LINES	4 (100)	SOLID	YELLOW-LEFT WHITE-RIGHT	OUTLINE MOUNTABLE MEDIANS IN YELLOW; EDGE LINES ARE NOT USED NEXT TO BARRIER CURB
TURN LANE MARKINGS	6 (150) LINE; FULL SIZE LETTERS & SYMBOLS (8' (2.4m))	SOLID	WHITE	SEE TYPICAL TURN LANE MARKING DETAIL
TWO WAY LEFT TURN MARKING	2 @ 4 (100) EACH DIRECTION 8' (2.4m) LEFT ARROW	SKIP-DASH AND SOLID IN PAIRS	YELLOW WHITE	10' (3 m) LINE WITH 30' (9 m) SPACE FOR SKIP-DASH; 5/2 (140) C-C BETWEEN SOLID LINE AND SKIP-DASH LINE SEE TYPICAL TWO-WAY LEFT TURN MARKING DETAIL
CROSSWALK LINES (PEDESTRIAN) A. DIAGONALS (BIKE & EQUESTRIAN) B. LONGITUDINAL BARS (SCHOOL)	2 @ 6 (150) 12 (300) @ 45° 12 (300) @ 90°	SOLID SOLID SOLID	WHITE WHITE WHITE	NOT LESS THAN 6' (1.8 m) APART 2' (600) APART 2' (600) APART SEE TYPICAL CROSSWALK MARKING DETAILS.
STOP LINES	24 (600)	SOLID	WHITE	PLACE 4' (1.2 m) IN ADVANCE OF AND PARALLEL TO CROSSWALK, IF PRESENT. OTHERWISE, PLACE AT DESIRED STOPPING POINT, PARALLEL TO CROSSROAD CENTERLINE, WHERE POSSIBLE
PAINTED MEDIANS	2 @ 4 (100) WITH 12 (300) DIAGONALS @ 45° NO DIAGONALS USED FOR 4' (1.2 m) WIDE MEDIANS	SOLID	YELLOW; TWO WAY TRAFFIC WHITE; ONE WAY TRAFFIC	11 (280) C-C FOR THE DOUBLE LINE SEE TYPICAL PAINTED MEDIAN MARKING.
CORE MARKING AND CHANNELIZING LINES	8 (200) WITH 12 (300) DIAGONALS @ 45°	SOLID	WHITE	DIAGONALS: 15' (4.5 m) C-C (LESS THAN 30MPH (50 km/h)) 20' (6 m) C-C 30MPH (50 km/h) TO 45MPH (70 km/h) 30' (9 m) C-C (OVER 45MPH (70 km/h))
RAILROAD CROSSING	24 (600) TRANSVERSE LINES; "RR" IS 6' (1.8 m) LETTERS; 16 (400) LINE FOR "X"	SOLID	WHITE	SEE STATE STANDARD 780001 AREA OF: "R"=3.6 SQ. FT. (0.33 m ²) EACH "X"=54.0 SQ. FT. (5.0 m ²)
SHOULDER DIAGONALS	12 (300) @ 45°	SOLID	WHITE - RIGHT YELLOW - LEFT	50' (15 m) C-C (LESS THAN 30MPH (50 km/h)) 75' (25 m) C-C (30 MPH (50 km/h) TO 45MPH (70 km/h)) 150' (45 m) C-C (OVER 45MPH (70 km/h))

FOR FURTHER DETAILS ON PAVEMENT MARKING REFER TO STANDARD SPECIFICATIONS FOR ROAD AND BRIDGE CONSTRUCTION AND STATE STANDARD 780001.

All dimensions are in inches (millimeters) unless otherwise shown.

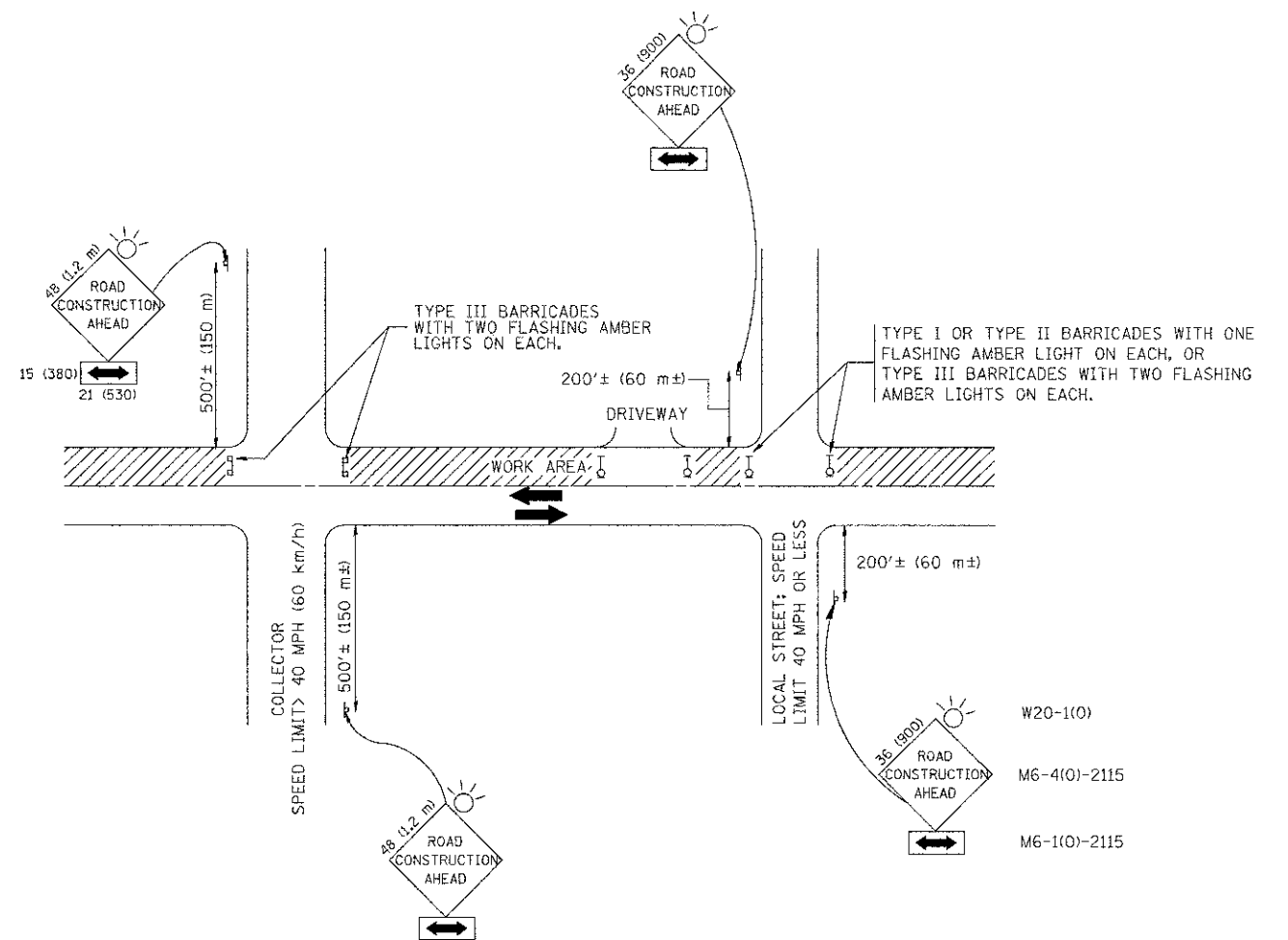

W20-1(0)
M6-4(0)-2115
M6-1(0)-2115

TRAFFIC CONTROL AND PROTECTION FOR SIDE ROADS, INTERSECTIONS, AND DRIVEWAYS

NOTES:

- A. FOR NO LANE RESTRICTION ON THE SIDE ROAD OR DRIVEWAYS
- SIDE ROAD WITH A SPEED LIMIT OF 40 MPH (60 km/h) OR LESS AS SHOWN ON THE DRAWING AND AS DIRECTED BY THE ENGINEER:
 - ONE **ROAD CONSTRUCTION AHEAD** SIGN 36 x 36 (900x900) WITH A FLASHER AND FLAG MOUNTED ON IT APPROXIMATELY 200' (60 m) IN ADVANCE OF THE MAIN ROUTE.
 - THE CLOSED PORTION OF THE MAIN ROUTE SHALL BE PROTECTED BY BLOCKING WITH TYPE I, TYPE II OR TYPE III BARRICADES, 1/3 OF THE CROSS SECTION OF THE CLOSED PORTION.
 - SIDE ROAD WITH A SPEED LIMIT GREATER THAN 40 MPH (60 km/h) AS SHOWN ON THE DRAWING AND AS DIRECTED BY THE ENGINEER:
 - ONE **ROAD CONSTRUCTION AHEAD** SIGN 48 x 48 (1.2 m x 1.2 m) WITH A FLASHER MOUNTED ON IT APPROXIMATELY 500' (150 m) IN ADVANCE OF THE MAIN ROUTE.
 - THE CLOSED PORTION OF THE MAIN ROUTE SHALL BE PROTECTED BY BLOCKING WITH TYPE III BARRICADES, 1/2 OF THE CROSS SECTION OF THE CLOSED PORTION.
 - WHEN THE SIDE ROAD LIES BETWEEN THE BEGINNING OF THE MAINLINE SIGNING AND THE WORK ZONE, A SINGLE HEADED ARROW (M6-1) SHALL BE USED IN LIEU OF THE DOUBLE HEADED ARROW (M6-4).
- B. FOR A LANE CLOSURE ON A SIDE ROAD OR DRIVEWAY:
- USE APPLICABLE PORTIONS OF THE TYPICAL APPLICATION OF TRAFFIC CONTROL DEVICES (STD. 701501, STD. 701606 OR THE APPROPRIATE STANDARD). THE SPACING OF SIGNS AND BARRICADES SHALL BE ADJUSTED FOR FIELD CONDITIONS AS DIRECTED BY THE ENGINEER. THE DIRECTIONAL ARROW SHALL BE COVERED OR REMOVED WHEN NO LONGER CONSISTENT WITH THE SIDE ROAD LANE CLOSURE.
- C. ADVANCE WARNING SIGNS ARE TO BE OMITTED ON DRIVEWAY UNLESS OTHERWISE NOTED.
- D. THE TRAFFIC CONTROL AND PROTECTION FOR SIDE ROADS, INTERSECTIONS, AND DRIVEWAYS SHALL BE INCIDENTAL TO THE COST OF SPECIFIED TRAFFIC CONTROL STANDARDS OR ITEMS.

All dimensions are in millimeters (inches) unless otherwise shown.

FILE NAME = 11599-DTLS-02-TC10 - TC-10	USER NAME = gaglianobt	DESIGNED = LHA	REVISED = J. OBERLE 10-18-95
		CHECKED =	REVISED = A. HOUSEH 03-06-96
	PLOT SCALE = 50,000 "/ IN.	DRAWN =	REVISED = A. HOUSEH 10-15-96
	PLOT DATE = 1/4/2008	CHECKED = 06-89	REVISED = T. RAMMACHER 01-06-00

STATE OF ILLINOIS
DEPARTMENT OF TRANSPORTATION

TRAFFIC CONTROL AND PROTECTION FOR
SIDE ROADS, INTERSECTIONS, AND DRIVEWAYS

FAU RTE.	SECTION	COUNTY	TOTAL SHEETS	SHEET NO.
1041	11-00030-00-RS	COOK	10	7
TC-10			CONTRACT NO. 63739	
FED. ROAD DIST. NO. 1 ILLINOIS FED. AID PROJECT M-9003 (914)				

SCALE: SHEET NO. 7 OF 10 SHEETS STA. TO STA.

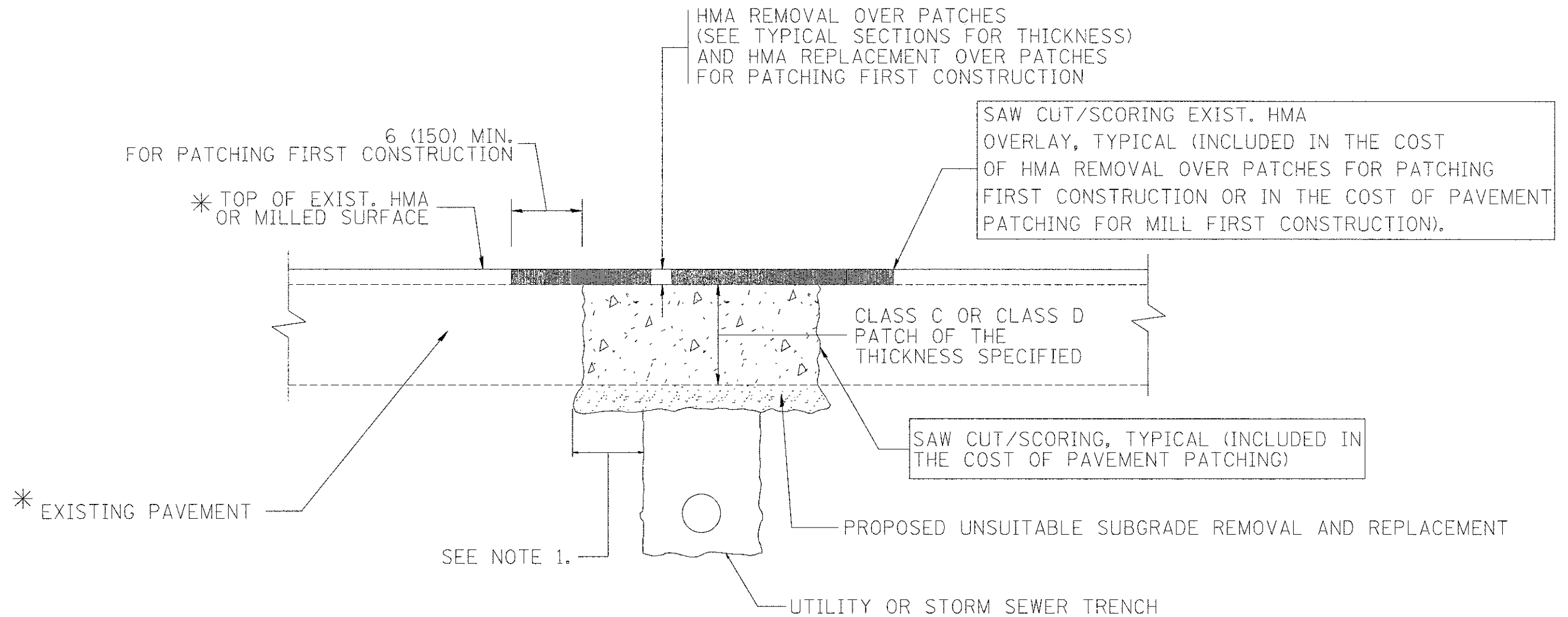

* SEE TYPICAL SECTIONS FOR THICKNESS AND MATERIALS

NOTES:

1. THE WIDTH OF THE FULL DEPTH PATCH OVER A TRENCH SHALL BE 12 (300) WIDER ON EACH SIDE OF THE TRENCH.
2. FOR METHOD OF MEASUREMENT AND BASIS OF PAYMENT, SEE RECURRING SPECIAL PROVISION "PATCHING WITH HOT-MIX ASPHALT OVERLAY REMOVAL".

SEQUENCE OF CONSTRUCTION (PATCHING FIRST)

1. REMOVE THE EXISTING HMA MATERIAL OVER THE AREA TO BE PATCHED.
2. REMOVE AND REPLACE WITH CLASS C OR D PATCH.
3. REPLACE HMA MATERIAL OVER THE AREA TO BE PATCHED.

SEQUENCE OF CONSTRUCTION (MILLING FIRST)

1. MILL HMA FIRST IF THERE IS AT LEAST 4 1/2 INCHES OR MORE OF HMA MATERIAL ON TOP OF THE EXISTING PAVEMENT OR IF THE PAVEMENT IS FULL DEPTH HMA. A MINIMUM OF 2 INCHES OF HMA MATERIAL SHALL BE IN PLACE AFTER MILLING.
2. REMOVE AND REPLACE WITH FULL DEPTH CLASS D PATCHES TO TOP OF MILLED SURFACE.

ALL DIMENSIONS ARE IN INCHES (MILLIMETERS) UNLESS OTHERWISE SHOWN.

FILE NAME = 11589-DTLS-04-8D22 - BD-22	USER NAME = baue-dl	DESIGNED -- R. SHAH	REVISED -- A. ABBAS 04-27-98
		CHECKED --	REVISED -- R. BORO 01-01-07
	PLOT SCALE = 50.000' / IN.	DRAWN --	REVISED -- R. SCRO 09-04-07
	PLOT DATE = 10/27/2008	CHECKED -- 10-25-94	REVISED -- K. ENG 10-27-06

STATE OF ILLINOIS
DEPARTMENT OF TRANSPORTATION

PAVEMENT PATCHING FOR HMA SURFACED PAVEMENT			
SCALE:	SHEET NO. 8	OF 10 SHEETS	STA. TO STA.

F.A.U. RTE.	SECTION	COUNTY	TOTAL SHEETS	SHEET NO.
1041	11-00030-00-RS	COOK	10	8
BD400-04 (8D-22)		CONTRACT NO. 63739		
FED. ROAD DIST. NO. 1 ILLINOIS FED. AID PROJECT M-9003 (914)				

VARIABLE - TO MEET EXISTING DIMENSIONS AND FIELD CONDITIONS (SEE NOTE ②)

PROP. CONC. CURB OR CURB AND GUTTER REPLACEMENT IN ACCORDANCE WITH STATE STANDARD 606001. (SEE NOTE ②)

SAW CUT FULL DEPTH - INCLUDED IN THE COST OF SIDEWALK, DRIVEWAY OR MEDIAN SURFACE REMOVAL PAY ITEM.

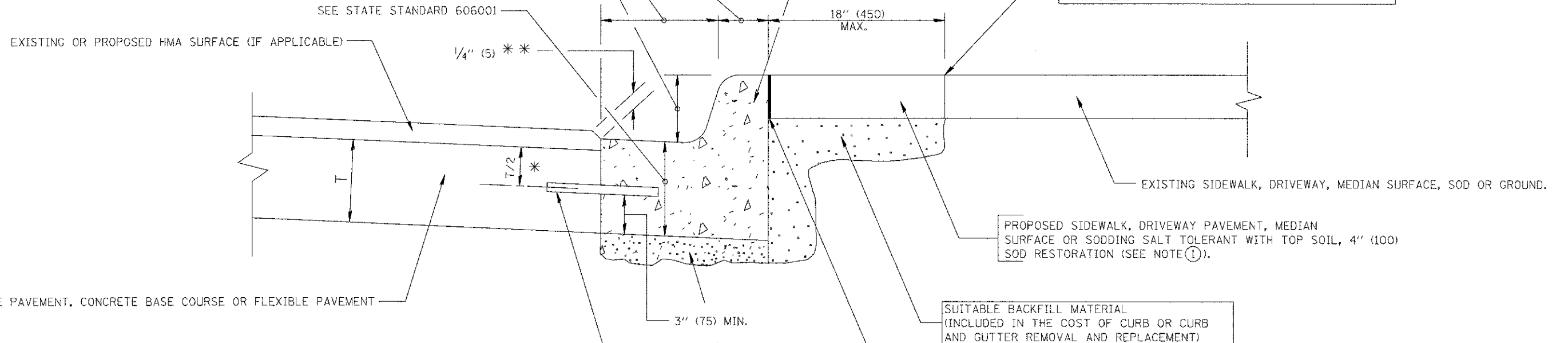

* 3" (75) MINIMUM FROM TOP AND BOTTOM OF THE CONCRETE PAVEMENT OR BASE COURSE.

** IF THE FINAL SURFACE OF THE PAVEMENT IS CONCRETE, THE GUTTER IS TO BE FLUSH WITH THE PAVEMENT.

NOTE: ① SIDEWALK, DRIVEWAY PAVEMENT OR MEDIAN SURFACE SHALL BE SIMILAR TO THE MATERIAL BEING REMOVED AND WILL BE PAID FOR SEPARATELY.

SODDING, SALT TOLERANT AND TOP SOIL, FURNISH AND PLACE 4" WILL BE PAID FOR SEPARATELY,

② FERTILIZER FOR THE PLACEMENT OF THE SOD IS NOT REQUIRED

③ CURB OR CURB AND GUTTER REPLACEMENT SHALL MATCH THE SHAPE OF THE EXISTING CURB OR CURB AND GUTTER UNLESS OTHERWISE SPECIFIED.

④ FOR CURB OR CURB AND GUTTER REMOVAL AND REPLACEMENT ADJACENT TO FLEXIBLE PAVEMENT DELETE EPOXY COATED TIE BARS.

⑤ LONGITUDINAL BARS, IF ENCOUNTERED IN THE EXISTING CURB OR CURB AND GUTTER, ARE NOT TO BE REPLACED. CUTTING AND REMOVING LONGITUDINAL BARS SHALL BE INCLUDED IN THE COST OF CURB OR CURB AND GUTTER REMOVAL AND REPLACEMENT.

⑥ THE COST OF HMA SURFACE REMOVAL IN THE EXISTING GUTTER FLAG SHALL BE INCLUDED IN THE COST OF THE CURB AND GUTTER REMOVAL AND REPLACEMENT.

⑦ THE REMOVAL AND REPLACEMENT OF THE EXISTING CURB OR CURB AND GUTTER SHALL BE DONE IN ACCORDANCE WITH THE APPLICABLE PORTIONS OF SECTION 440 AND 606 OF THE STANDARD SPECIFICATIONS.

⑧ THE LOCATIONS OF REMOVAL AND REPLACEMENT OF EXISTING CURB OR CURB AND GUTTER SHALL BE DETERMINED BY THE RESIDENT ENGINEER AT THE TIME OF CONSTRUCTION.

SUITABLE BACKFILL MATERIAL (INCLUDED IN THE COST OF CURB OR CURB AND GUTTER REMOVAL AND REPLACEMENT)

PROPOSED 3/4" (20) PREFORMED EXPANSION JOINT AT CONCRETE SIDEWALKS, DRIVEWAYS, AND MEDIANS. (INCLUDED IN THE COST OF CURB OR CURB AND GUTTER REMOVAL AND REPLACEMENT.)

UNSUITABLE SUB-BASE MATERIAL TO BE REMOVED, IF DIRECTED BY THE ENGINEER, SHALL BE REPLACED WITH EITHER SUB-BASE GRANULAR MATERIAL, TYPE B OR ADDITIONAL THICKNESS OF CONCRETE.

REMOVAL AND REPLACEMENT 4" (100) OR LESS IS INCLUDED IN THE COST OF CURB OR CURB AND GUTTER REMOVAL AND REPLACEMENT.

REMOVAL AND REPLACEMENT IN EXCESS OF 4" (100) WILL BE PAID FOR IN ACCORDANCE WITH ARTICLE 109.04 OF THE STANDARD SPECIFICATIONS.

PROPOSED #6 (20) EPOXY COATED TIE BARS 24" (600) LONG AT 24" (600) CENTERS WILL NOT BE PAID FOR SEPARATELY. DELETE EPOXY COATED TIE BARS IF EXISTING TIE BARS ARE USUABLE AS DETERMINED BY THE ENGINEER. (SEE NOTE ③).

BASIS OF PAYMENT:

THIS WORK WILL BE PAID FOR AT THE CONTRACT UNIT PRICE PER FOOT (METER) FOR "CURB REMOVAL AND REPLACEMENT" OR "COMBINATION CONCRETE CURB AND GUTTER REMOVAL AND REPLACEMENT".

CURB OR CURB AND GUTTER REMOVAL AND REPLACEMENT

ALL DIMENSIONS ARE IN INCHES (MILLIMETERS) UNLESS OTHERWISE SHOWN.

FILE NAME = 11589-DTLS-04-B024 - B0-24	USER NAME = drivekaegn	DESIGNED -- A. HOUSEH	REVISED -- R. SHAH 10-03-96	STATE OF ILLINOIS DEPARTMENT OF TRANSPORTATION	CURB OR CURB AND GUTTER REMOVAL AND REPLACEMENT	FAU RTE.	SECTION	COUNTY	TOTAL SHEETS	SHEET NO.
	CHECKED --	REVISED -- A. ABBAS 03-21-97	1041			11-00030-00-RS	COOK	10	9	
	PLOT SCALE = 50,000' / IN.	DRAWN --	REVISED -- M. GOMEZ 01-22-01			BD600-06 (BD-24)		CONTRACT NO. 63739		
	PLOT DATE = 12/15/2009	CHECKED -- 03-11-94	REVISED -- R. BORO 12-15-09			SCALE: SHEET NO. 9 OF 10 SHEETS STA. TO STA.		FED. ROAD DIST. NO. 1 ILLINOIS FED. AID PROJECT M-9003 (914)		

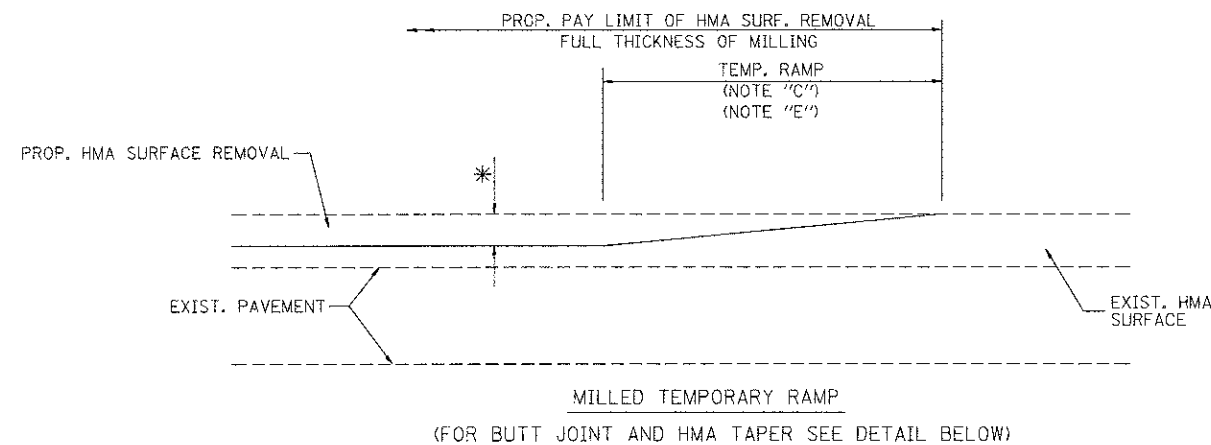

OPTION 1

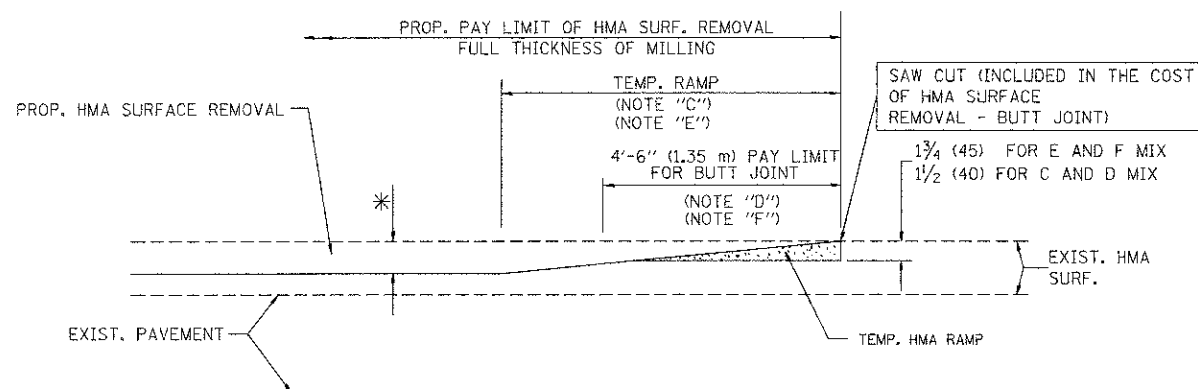

OPTION 2

TYPICAL TEMPORARY RAMP

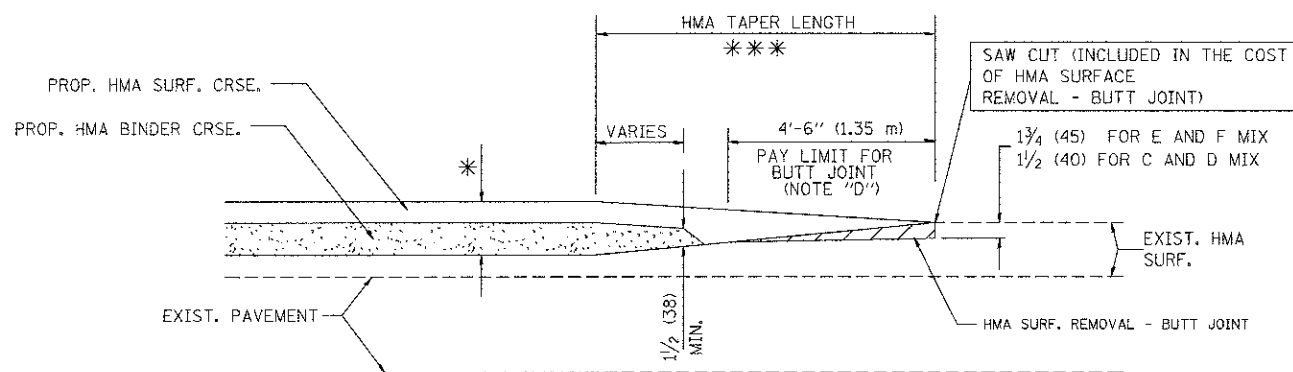

TYPICAL BUTT JOINT AND HMA TAPER FOR MILLING AND RESURFACING

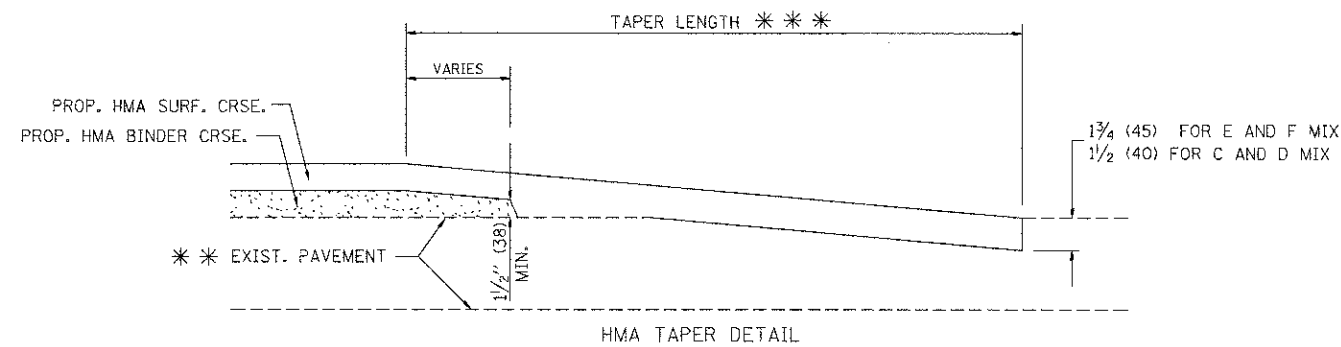
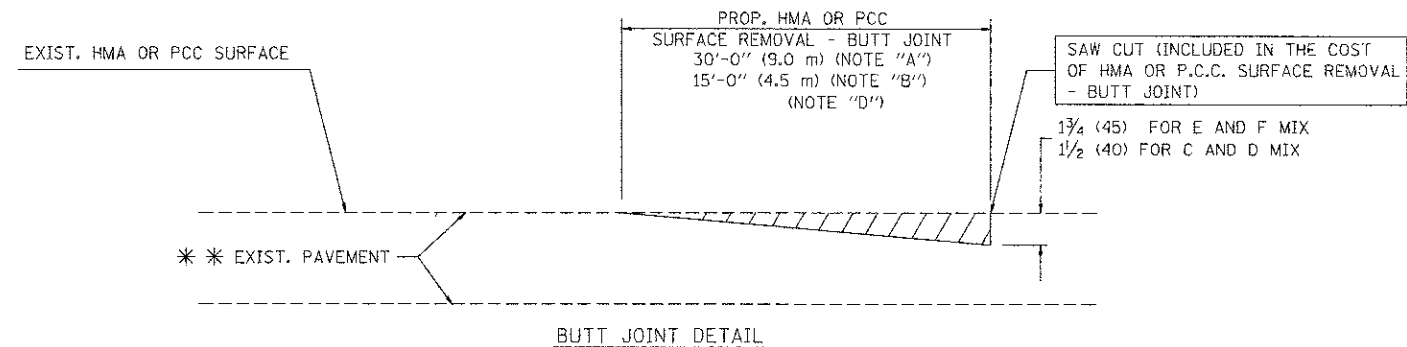

TYPICAL BUTT JOINT AND HMA TAPER FOR RESURFACING ONLY

*** PC CONCRETE, HMA OR HMA RESURFACED PAVEMENT.

NOTES

- A: MAINLINE ROADWAYS AND MAJOR SIDE ROADS.
- B: MINOR SIDE ROADS.
- C: THE TEMP. RAMP SHALL BE CONSTRUCTED IMMEDIATELY UPON REMOVAL OF THE EXISTING HMA SURFACE.
- D: THE BUTT JOINT SHALL BE CONSTRUCTED IMMEDIATELY PRIOR TO PLACING THE PROPOSED HMA COURSES.
- E: TAPER THE TEMP. RAMP AT A RATE OF 3'-0" (900 mm) PER 1 INCH (25 mm) OF MILLING THICKNESS.
- F: INSTALLATION AND REMOVAL OF THE 4'-6" (1.35 m) TEMP. RAMP IS INCLUDED IN COST OF HMA SURFACE REMOVAL - BUTT JOINT
- G: SEE ARTICLE 406.08 AND 406.14 OF THE STANDARD SPECIFICATIONS FOR "HMA AND/OR PCC SURFACE REMOVAL, BUTT JOINT".
- * SEE TYPICAL SECTIONS FOR MILLING THICKNESS.
- *** 20'-0" (6.1 m) PER 1 (25) RESURFACING (NOTE "A")
10'-0" (3.0 m) PER 1 (25) RESURFACING (NOTE "B")

BASIS OF PAYMENT:

THE BUTT JOINT WILL BE PAID FOR AT THE CONTRACT UNIT PRICE PER SQUARE YARD (SQUARE METER) FOR "HOT-MIX ASPHALT SURFACE REMOVAL - BUTT JOINT" OR FOR "PORTLAND CEMENT CONCRETE SURFACE REMOVAL - BUTT JOINT".

ALL DIMENSIONS ARE IN INCHES (MILLIMETERS) UNLESS OTHERWISE SHOWN.

FILE NAME = 11589-DTLS-05-BD32 - BD-32

USER NAME = geglanobt	DESIGNED — M. DE YONG	REVISED — R. SHAH 10-25-94
PLOT SCALE = 50.0000' / IN.	CHECKED —	REVISED — A. ABBAS 03-21-97
PLOT DATE = 1/4/2008	DRAWN —	REVISED — M. GOMEZ 04-06-01
	CHECKED — 06-13-90	REVISED — R. BORO 01-01-07

STATE OF ILLINOIS
DEPARTMENT OF TRANSPORTATION

BUTT JOINT AND
HMA TAPER DETAILS

SCALE: SHEET NO. 10 OF 10 SHEETS STA. TO STA.

F.A.U. RTE.	SECTION	COUNTY	TOTAL SHEETS	SHEET NO.
1041	11-00030-00-RS	COOK	10	10
BD400-05 BD32			CONTRACT NO. 63739	
FED. ROAD DIST. NO. 1 ILLINOIS FED. AID PROJECT M-9003 (B14)				