

McDONALD ROAD

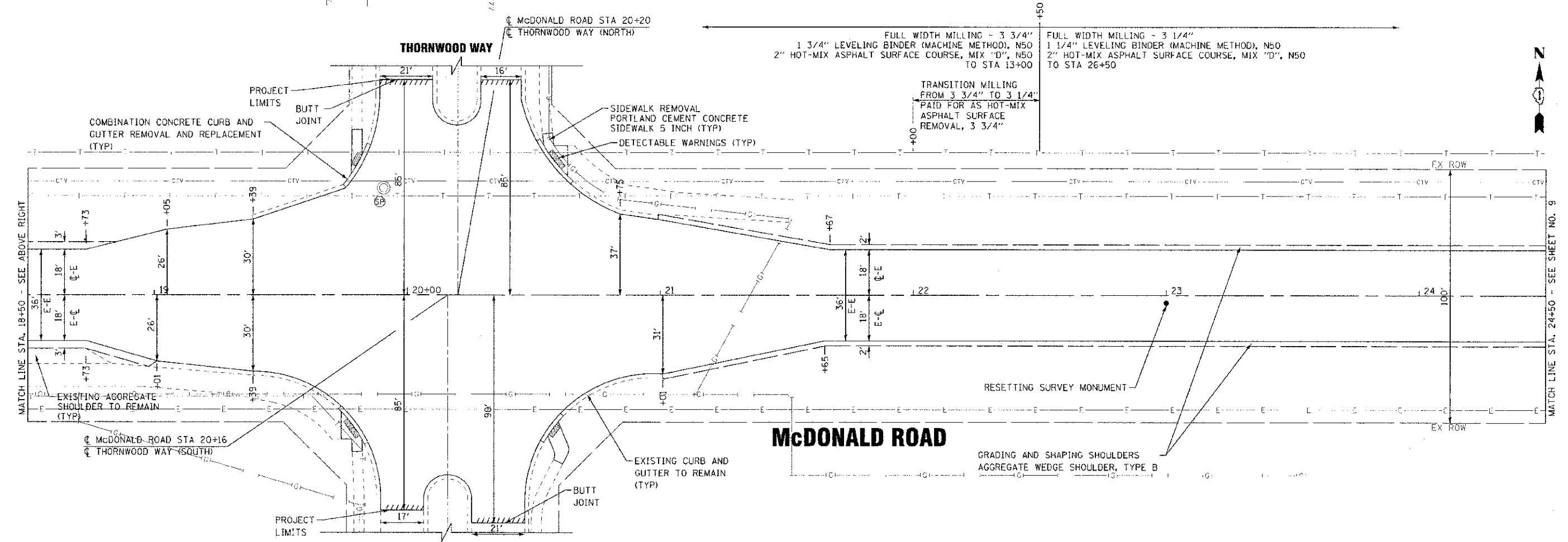

McDONALD ROAD

DESIGNED BY: BAXTER & WOODMAN, INC.
 DRAWN BY: KAR
 CHECKED BY: MWP
 DATE: 06-22-12
 PROJECT NO.: 110783
 SHEET NO.: 8
 CONTRACT NO.: 63741

DESIGNED	MWP	REVISED	DOT REVIEW 08-20-12
DRAWN	KAR	REVISED	
CHECKED	MWP	REVISED	
DATE	06-22-12	FILE	110783_McDonald_plan2.shx

**VILLAGE OF SOUTH ELGIN, ILLINOIS
McDONALD ROAD
STP IMPROVEMENTS**

PLAN - McDONALD ROAD

SCALE: 1" = 20'
STA. 13+50 TO STA. 24+50

F.A.P. RTE.	SECTION	COUNTY	TOTAL SHEETS	SHEET NO.
537	12-00040-00-RS	KANE	21	8
FED. ROAD DIST. NO.	CONTRACT NO.		63741	
C-91-296-12	ILLINOIS FED. AID PROJECT		N-9003975	