

# STAGE 1

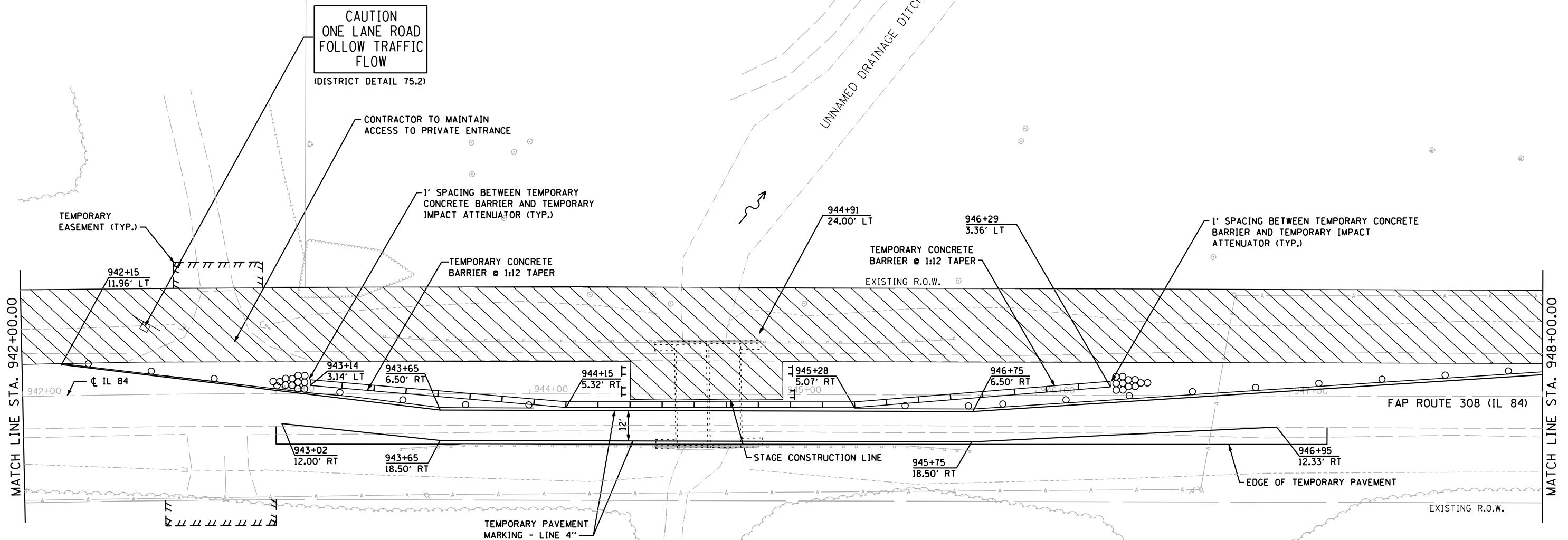

**STAGE 1 NOTES:**

1. INSTALL TRAFFIC CONTROL AND TEMPORARY SIGNALS ACCORDING TO STANDARD 701321.
2. DRIVE TEMPORARY SHEET PILING AS NECESSARY.
3. REMOVE THE WEST SIDE OF THE CULVERT.
4. CONSTRUCT THE WEST SIDE OF THE CULVERT INCLUDING RIP-RAP, EARTHWORK, AND CLASS C PATCH.
5. REMOVE AND CONSTRUCT HMA DRIVEWAY INCLUDING PROPOSED PIPE CULVERT.
6. INSTALL PROPOSED HMA SHOULDERS ON SOUTHBOUND LANE.
7. INSTALL THE PROPOSED GUARDRAIL ON THE WEST SIDE.

**LEGEND:**

	= WORK ZONE
	= TEMPORARY PAVEMENT
	= SIGN
	= TYPE III BARRICADE
	= DRUM WITH STEADY BURNING LIGHTS
	= TRAFFIC SIGNAL

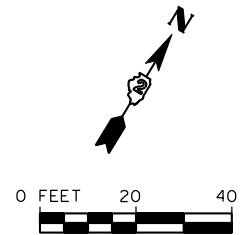

FILE NAME = s:\p1\6380--6395\6346\026\micro\cadd sheets\0264925-sh1-stage1.dgn

**SA STRAND ASSOCIATES**  
 1170 SOUTH HOUBOLT ROAD  
 JOLIET, ILLINOIS 60431  
 (815) 744-4200

USER NAME = brianf	DESIGNED -	REVISED -
PLOT SCALE = 40.0000' / IN.	DRAWN -	REVISED -
PLOT DATE = 8/8/2012	CHECKED -	REVISED -
	DATE -	REVISED -

**STATE OF ILLINOIS  
 DEPARTMENT OF TRANSPORTATION**

<b>SUGGESTED MAINTENANCE OF TRAFFIC</b>			
SCALE: AS SHOWN	SHEET NO.	OF SHEETS	STA. 942+00 TO STA. 948+00

F.A.P. RTE. 308	SECTION 110T	COUNTY ROCK ISLAND	TOTAL SHEETS 51	SHEET NO. 22
CONTRACT NO. 64925				
FED. ROAD DIST. NO. 2 ILLINOIS FED. AID PROJECT				