

ALABAMA	SEC.	COUNTY	TOTAL SHEETS	SHEET NO.
623	H-BR-1	LA SALLE	126	25
FED. ROAD DIST.		ILLINOIS PROJECT		

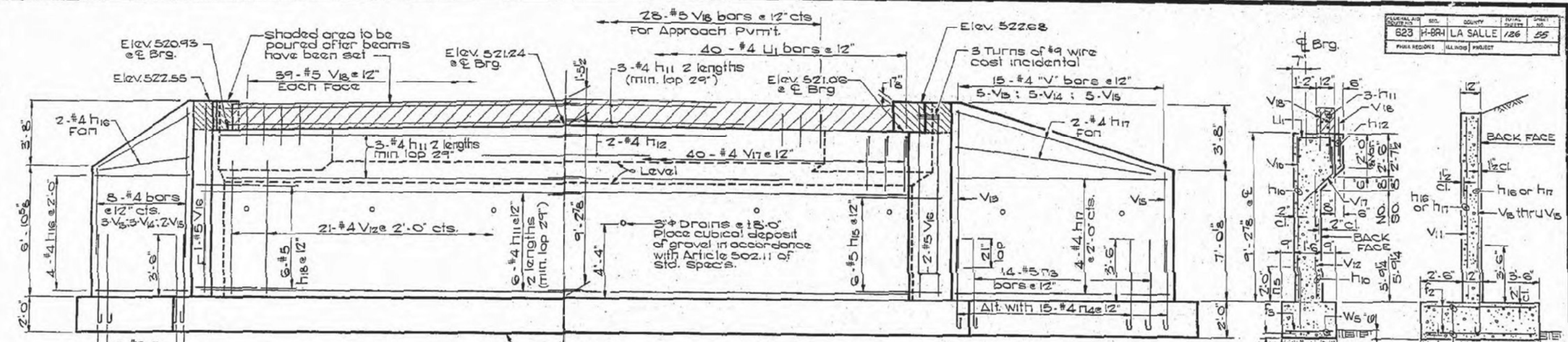

MAX. COMPUTED SOIL BEARING PRESSURE = 3930 LBS./SQ. FT.

ELEVATION SHOWING BACK FACE REINFORCEMENT

NOTE: Set footings a minimum of 6" into sound shale. Undercut footing elev. 6" and pour 6" concrete seal coat. See general notes.

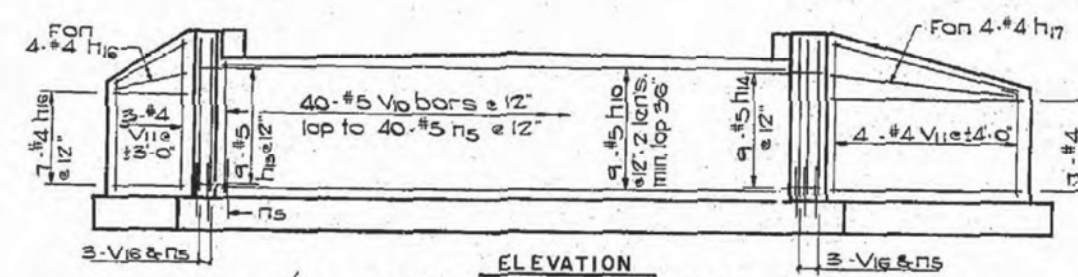
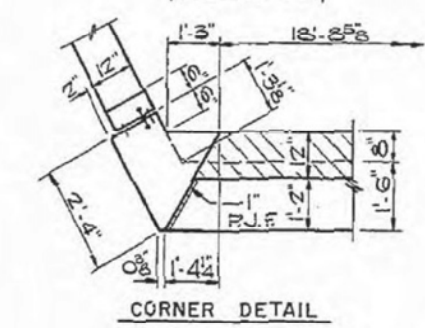
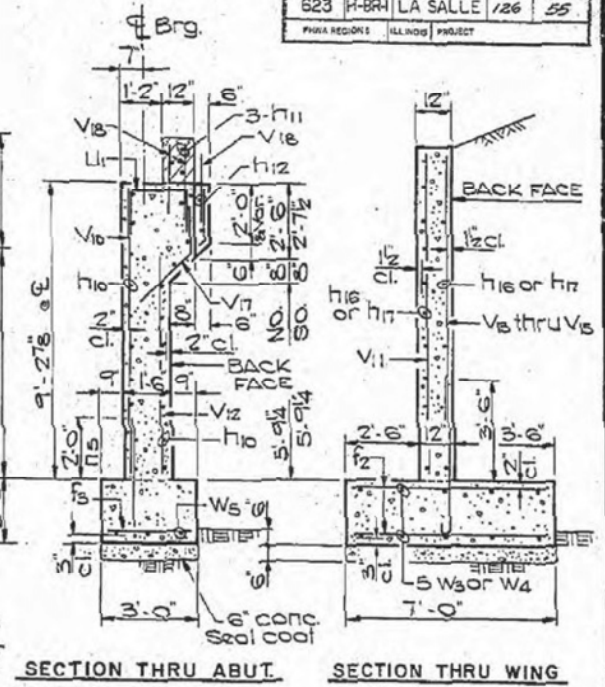

BAR NO.	SIZE	LENGTH	SHAPE
U1	#4	21'-0"	U
V10	#5	21'-0"	—
V12	#4	21'-0"	—
V14	#5	28'-0"	—
V15	#5	5'-6"	—
V16	#5	5'-6"	—
V17	#4	7'-0"	—
V18	#4	14'-0"	—
V19	#5	4'-9"	—
W3	#5	5'-10"	—
W4	#4	5'-9"	—
W5	#5	3'-9"	—
F2	#4	6'-8"	—
F3	#4	2'-8"	—
U1	#4	3'-10"	U
V10	#5	8'-9"	—
V11	#4	10'-3"	—
V12	#4	6'-6"	—
V13	#4	8'-9"	—
V14	#4	7'-6"	—
V15	#4	6'-3"	—
V16	#5	10'-3"	—
V17	#4	4'-0"	—
V18	#5	3'-0"	—
W3	#5	5'-0"	—
W4	#5	21'-0"	—
W5	#5	25'-6"	—

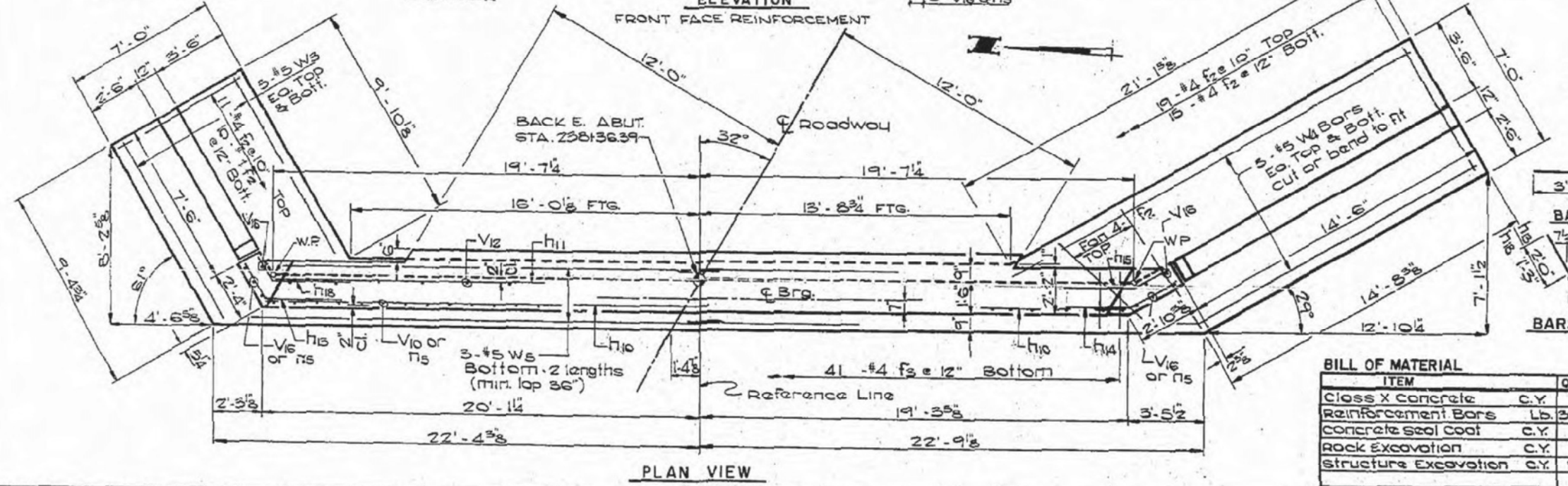

BILL OF MATERIAL

ITEM	QUANT.
Class X Concrete	C.Y. 58.1
Reinforcement Bars	Lb. 3630
Concrete Seal Coat	C.Y. 5.6
Rock Excavation	C.Y. 11.3
Structure Excavation	C.Y. 107

STA. 238+240
EAST ABUTMENT
SECTION H-BR-1
F.A. ROUTE 623
LA SALLE COUNTY

FILE NAME = ...04007-SN050-2054-005-ExistingPlans.dgn

ZROKA Engineering, P.C.
4216 North Hermitage
Chicago, IL 60613

USER NAME = SAW	DESIGNED - JLA	REVISED -
PLOT SCALE = 0:2.0000 ' / IN.	CHECKED - DAZ	REVISED -
PLOT DATE = 8/15/2012	DRAWN - SAW	REVISED -
	CHECKED - JLA	REVISED -

STATE OF ILLINOIS
DEPARTMENT OF TRANSPORTATION

EXISTING BRIDGE PLANS
FOR INFORMATION ONLY

F.A.P. RTE. 623	SECTION (H) BR-1	COUNTY LA SALLE	TOTAL SHEETS 32	SHEET NO. 23
CONTRACT NO. 66A13			ILLINOIS FED. AID PROJECT	

SHEET NO. 5 OF 7 SHEETS