

ELEVATION

GENERAL NOTES

PLAN DIMENSIONS AND DETAILS RELATIVE TO EXISTING PLANS ARE SUBJECT TO NOMINAL CONSTRUCTION VARIATIONS. THE CONTRACTOR SHALL FIELD VERIFY EXISTING DIMENSIONS AND DETAILS AFFECTING NEW CONSTRUCTION AND MAKE NECESSARY APPROVED ADJUSTMENTS PRIOR TO CONSTRUCTION OR ORDERING OF MATERIALS. SUCH VARIATIONS SHALL NOT BE CAUSE FOR ADDITIONAL COMPENSATION FOR A CHANGE IN SCOPE OF WORK; HOWEVER, THE CONTRACTOR WILL BE PAID FOR THE QUANTITY ACTUALLY FURNISHED AT THE UNIT PRICE BID FOR THE WORK.

NO FIELD WELDING IS PERMITTED EXCEPT AS SPECIFIED IN THE CONTRACT DOCUMENTS.

THE CONTRACTOR SHALL PROVIDE SUPPORT AND/OR SHORING SYSTEMS FOR THE SLAB AND BEAM IN THE AREA OF EXISTING BEARING REPLACEMENT. SEE SPECIAL PROVISIONS "JACK AND REMOVE BEARING".

COST OF REMOVAL AND RE-INSTALLATION OF ALL MEMBERS NECESSARY TO COMPLETE THE BEARING RE-ALIGNMENT WORK AS DETAILED ON THE PLANS AND AS SPECIFIED IN THE SPECIAL PROVISIONS SHALL BE INCLUDED WITH FURNISHING AND ERECTING STRUCTURAL STEEL.

TWO 1/8 IN. ADJUSTING SHIMS SHALL BE PROVIDED FOR EACH BEARING IN ADDITION TO ALL OTHER PLATES OR SHIMS AND PLACED AS SHOWN ON BEARING DETAILS.

ALL (EMBEDDED AND SEPARATE) BEARING PLATES, SIDE RETAINERS, ANCHOR BOLTS, NUTS, WASHERS AND PINTLES SHALL BE GALVANIZED ACCORDING TO AASHTO M111 OR M232 AS APPLICABLE.

H.S. BOLTS IN BEARING ASSEMBLY SHALL BE GALVANIZED ACCORDING TO AASHTO M298 CLASS 50.

THE STRUCTURAL STEEL PLATES OF THE BEARING ASSEMBLY AND STEEL EXTENSION SHALL CONFORM TO THE REQUIREMENTS OF AASHTO M 270 GRADE .50.

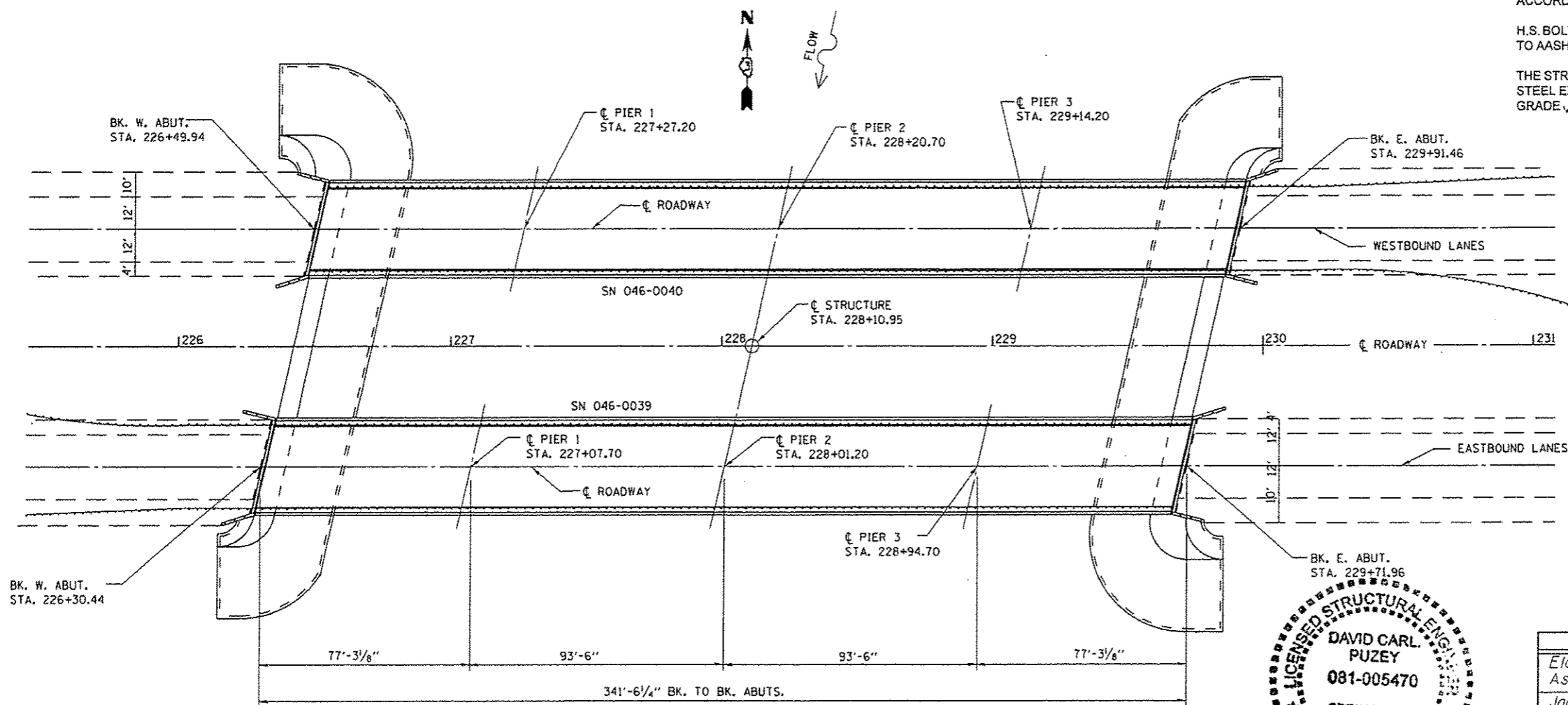

PLAN

TOTAL BILL OF MATERIAL

ITEM	UNIT	QUANTITY
Elastomeric Bearing Assembly, Type II	Each	24
Jack and Remove Existing Bearings	Each	24
Furnishing and Erecting Structural Steel	Pound	3235
Anchor Bolts 1"φ	Each	48



David Carl Puzey 9/29/12
Expires 11/30/14