

STA. 1289+95.67  
 EXISTING MEDIAN INLET BOX  
 EXISTING 18" PIPE LT (RCCP)  
 USFL 6' LT. = 644.65  
 DSFL 60' LT. = 645.02

SEC. 8, T19N, R13W, 2ND P.M.

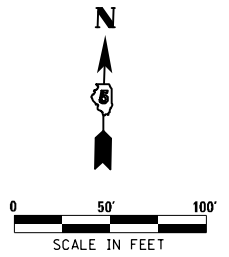

STA. 1299+97.05  
 EXISTING MEDIAN INLET BOX  
 EXISTING 18" PIPE RT (RCCP)  
 USFL 7' RT. = 646.45  
 DSFL 61' RT. = 646.80

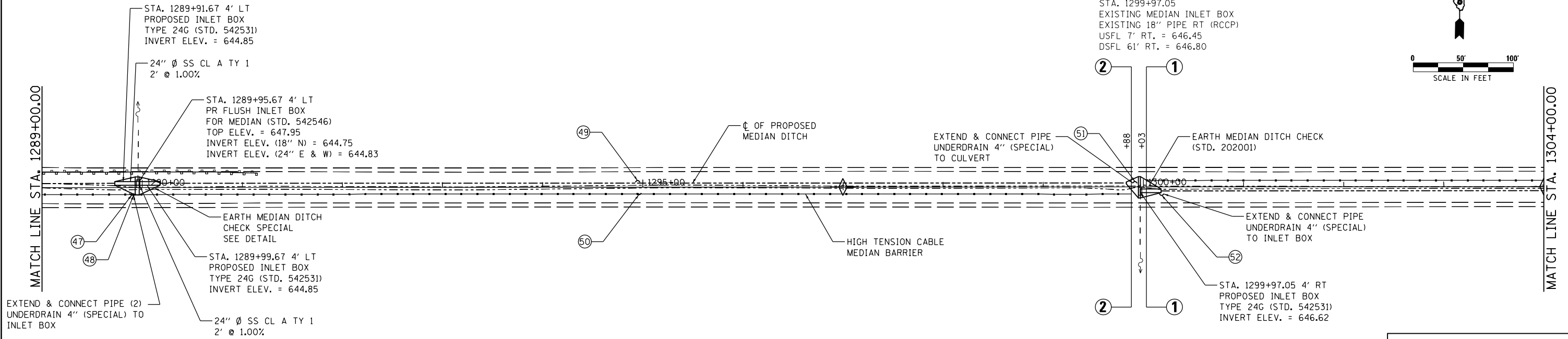

|      |  |
|------|--|
| DATE |  |
| BY   |  |
| PLAN |  |
| NO.  |  |
| NO.  |  |
| NO.  |  |
| NO.  |  |

**MEDIAN INLET BOX REMOVAL**  
 STATION 1289+95.67 - 1 EACH  
 (SEE SCHEDULE)

⊕ INDICATES PIPE UNDERDRAINS, 4" (SPECIAL)  
 SEE SCHEDULE

**MEDIAN INLET BOX REMOVAL**  
 STATION 1299+97.05 - 1 EACH  
 (SEE SCHEDULE)

**McDonough-Whitlow, P.C.**  
 Consulting Engineers & Land Surveyors  
 138 East Wood Street  
 Hillsboro, IL 62049  
 Phone: 217.532.7233  
 Fax: 217.532.6300  
 PROFESSIONAL DESIGN NO. 184-002754

|         |  |
|---------|--|
| DATE    |  |
| BY      |  |
| PROFILE |  |
| NO.     |  |
| NO.     |  |
| NO.     |  |
| NO.     |  |

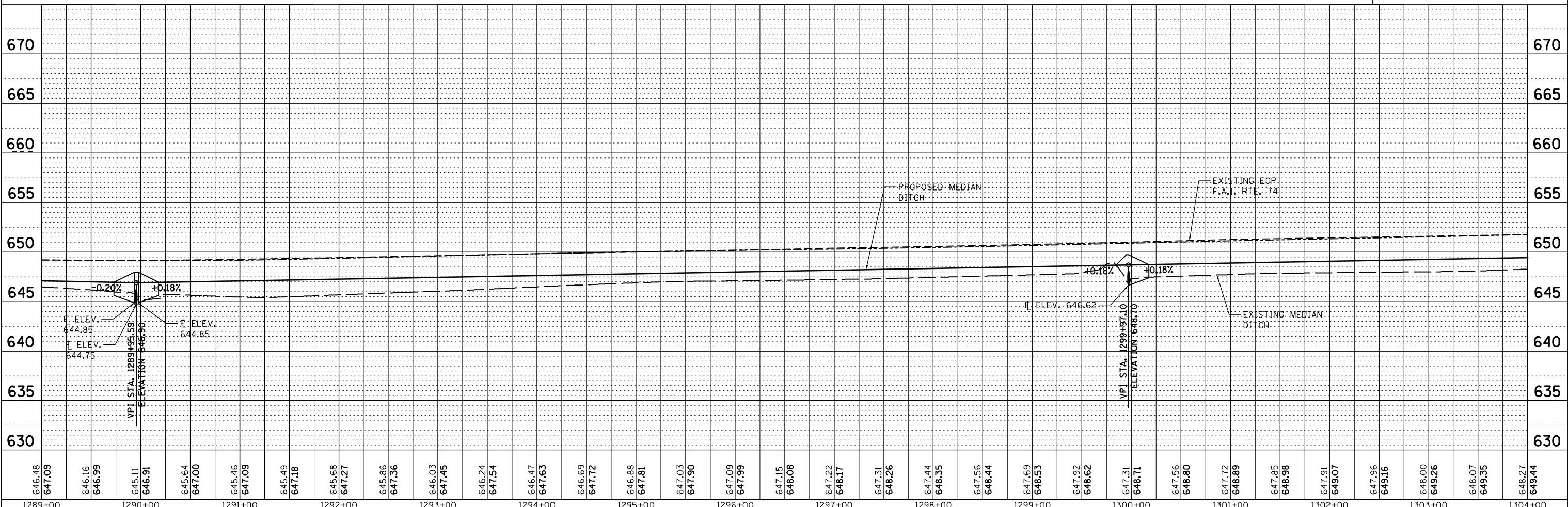

|         |         |         |         |         |         |         |         |         |         |         |         |         |         |         |         |
|---------|---------|---------|---------|---------|---------|---------|---------|---------|---------|---------|---------|---------|---------|---------|---------|
| 1289+00 | 1290+00 | 1291+00 | 1292+00 | 1293+00 | 1294+00 | 1295+00 | 1296+00 | 1297+00 | 1298+00 | 1299+00 | 1300+00 | 1301+00 | 1302+00 | 1303+00 | 1304+00 |
| 646.48  | 647.09  | 646.16  | 646.99  | 645.11  | 646.91  | 645.64  | 647.00  | 645.46  | 647.09  | 645.49  | 647.18  | 645.68  | 647.27  | 645.86  | 647.36  |
| 646.03  | 647.45  | 646.24  | 647.54  | 646.47  | 647.63  | 646.69  | 647.72  | 646.88  | 647.81  | 647.03  | 647.90  | 647.09  | 647.99  | 647.15  | 648.08  |
| 647.22  | 648.17  | 647.31  | 648.26  | 647.44  | 648.35  | 647.56  | 648.44  | 647.69  | 648.53  | 647.92  | 648.62  | 647.31  | 648.71  | 647.56  | 648.80  |
| 647.72  | 648.89  | 647.85  | 648.98  | 647.91  | 649.07  | 647.96  | 649.16  | 648.00  | 649.26  | 648.07  | 649.35  | 648.27  | 649.44  |         |         |

**STATE OF ILLINOIS**  
**DEPARTMENT OF TRANSPORTATION**

**PLAN & PROFILE**  
**F.A.I. 74**

SCALE: 1"=50' SHEET NO. 10 OF 28 SHEETS STA. 1289+00.00 TO STA. 1304+00.00

|                           |                     |           |              |                    |
|---------------------------|---------------------|-----------|--------------|--------------------|
| F.A.I. RTE.               | SECTION             | COUNTY    | TOTAL SHEETS | SHEET NO.          |
| 74                        | MEDIAN CABLE 2012-2 | VERMILION | 120          | 22                 |
|                           |                     |           |              | CONTRACT NO. 70967 |
| ILLINOIS FED. AID PROJECT |                     |           |              |                    |