

FINAL SURVEY NO.	SURVEYED PLOTTED TEMPLATE AREAS CHECKED	BY	DATE

ORIGINAL SURVEY NO.	SURVEYED PLOTTED TEMPLATE AREAS CHECKED	BY	DATE

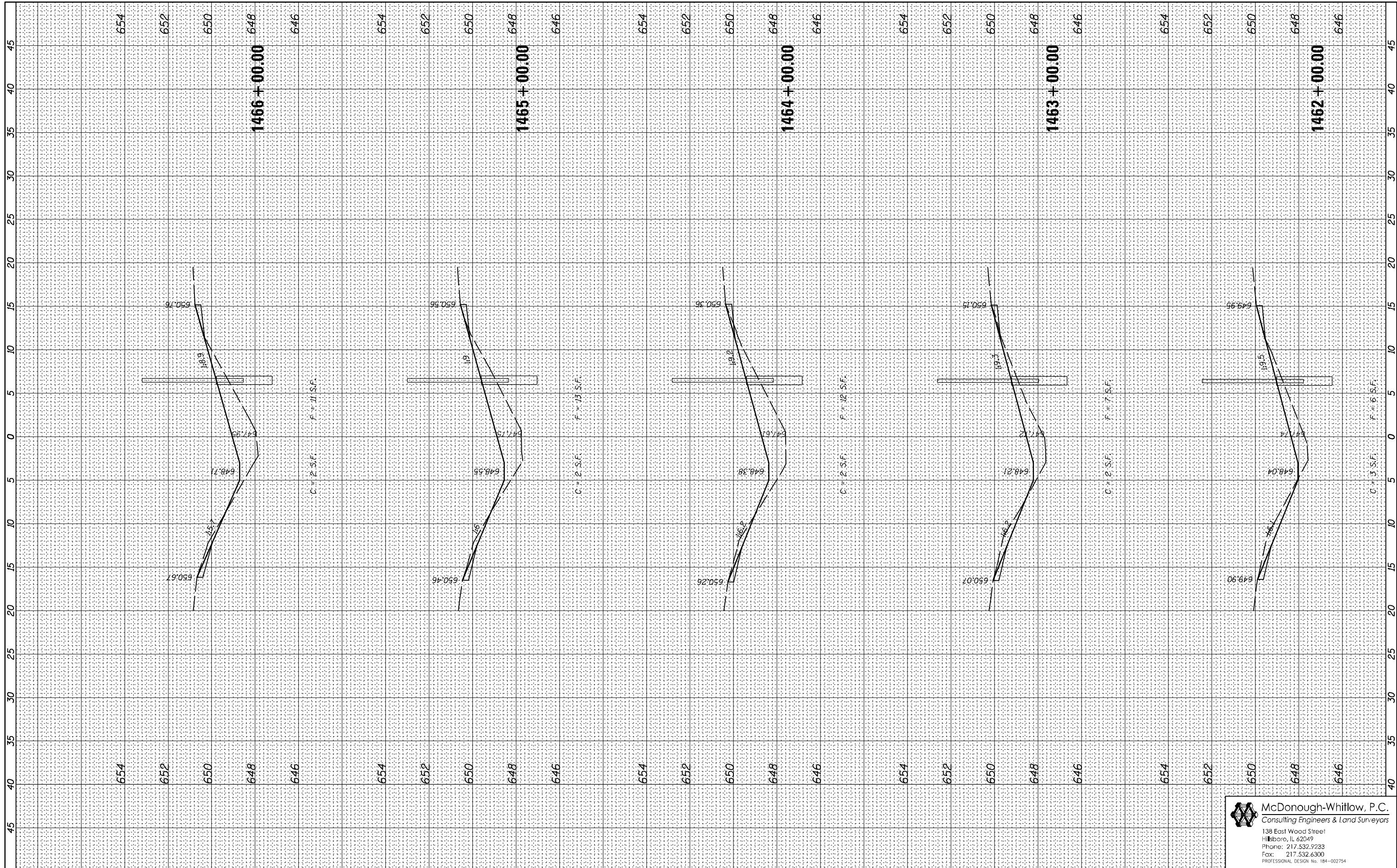

FILE NAME =	D570967-XXX-XXX-XSHT.dgn
-------------	--------------------------

USER NAME =	RNH
DESIGNED -	JAH
DRAWN -	RNH
CHECKED -	TMM
DATE -	

REVISED -	
REVISED -	
REVISED -	
REVISED -	

**STATE OF ILLINOIS
DEPARTMENT OF TRANSPORTATION**

**CROSS SECTIONS
F.A.I. 74**

SCALE: SHEET NO. 62 OF 71 SHEETS STA. 1462+00.00 TO STA. 1466+00.00

F.A.I. RTE.	SECTION	COUNTY	TOTAL SHEETS	SHEET NO.
74	MEDIAN CABLE 2012-2	VERMILION	120	111
CONTRACT NO. 70967				

McDonough-Whitlow, P.C.
Consulting Engineers & Land Surveyors
138 East Wood Street
Hillsboro, IL 62049
Phone: 217.532.9233
Fax: 217.532.6300
PROFESSIONAL DESIGN NO. 184-002754

ILLINOIS FED. AID PROJECT