

LEGEND

- PROPOSED TYPE IV CABINET, TRAFFIC SIGNAL CONTROLLER, HIGHWAY LIGHTING CONTROLLER, AND SERVICE INSTALLATION
- PROPOSED STEEL COMBINATION MAST ARM ASSEMBLY AND POLE WITH TENON FOR LUMINAIRE
- PROPOSED TRAFFIC SIGNAL POST AND SIGNAL HEAD
- PROPOSED SIGNAL HEAD WITH BACKPLATE, MAST ARM MOUNTED
- PROPOSED GULFBOX JUNCTION
- PROPOSED CONCRETE HANDHOLE
- PROPOSED PVC CONDUIT
- EXISTING CONDUIT
- EXISTING TRAFFIC SIGNAL CONTROLLER
- EXISTING SIGNAL HEAD
- EXISTING SIGNAL POST
- EXISTING LIGHT POLE AND LUMINAIRE
- CONDUIT IN TRENCH
- CONDUIT, PUSHED
- PVC SIZE OF CONDUIT
- LUMINAIRE, SODIUM VAPOR, MULTI-MOUNT, 250 WATT

REMOVE AND REINSTALL NEW CABLE IN EXISTING CONDUIT FOR SB ADV. LOOPS. INSTALL EXISTING CONDUIT IN NEW HANDHOLE. (NEW HANDHOLE INLINE WITH EXISTING CONDUIT.)

PROP CONCRETE HANDHOLE
STA 886+61, ELEV 450.91
67.3' LT (IL 13 WB)

PROP TRAFFIC SIGNAL POST, 16', 1 EACH
CONCRETE FOUNDATION TYPE A, 3 FT
STA 886+50, 66.3' LT,
ELEV 451.42 (IL 13 WB)

STEEL COMBINATION MAST ARM ASSEMBLY AND POLE, 55'
CONC FOUNDATION, TYPE E, 36-INCH DIA, 15'
STA 886+14, ELEV 449.58, 53.6' LT (IL 13 WB)

PROP TRAFFIC SIGNAL POST, 16', 1 EACH
CONCRETE FOUNDATION TYPE A, 3 FT
STA 886+31, 21.7' LT, (IL 13 EB)

PROP CONCRETE HANDHOLE
STA 886+42,
21.7' LT (IL 13 EB)

INSTALL NEW CONDUIT
IN EXISTING HANDHOLE

NOTES:

1. ALL LUMINAIRES ON MAST ARM ASSEMBLY AND POLE ARE LUMINAIRE, SODIUM VAPOR, MULTI-MOUNT, 250 WATT
2. EXISTING CABLES AND CONDUIT THAT DO NOT INTERFERE WITH PROPOSED WORK MAY BE ABANDONED IN PLACE.
3. RELOCATE EXISTING STREET NAME SIGNS ONTO NEW MAST ARMS PER STANDARD 720016-01.

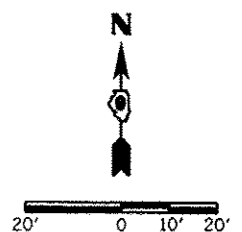
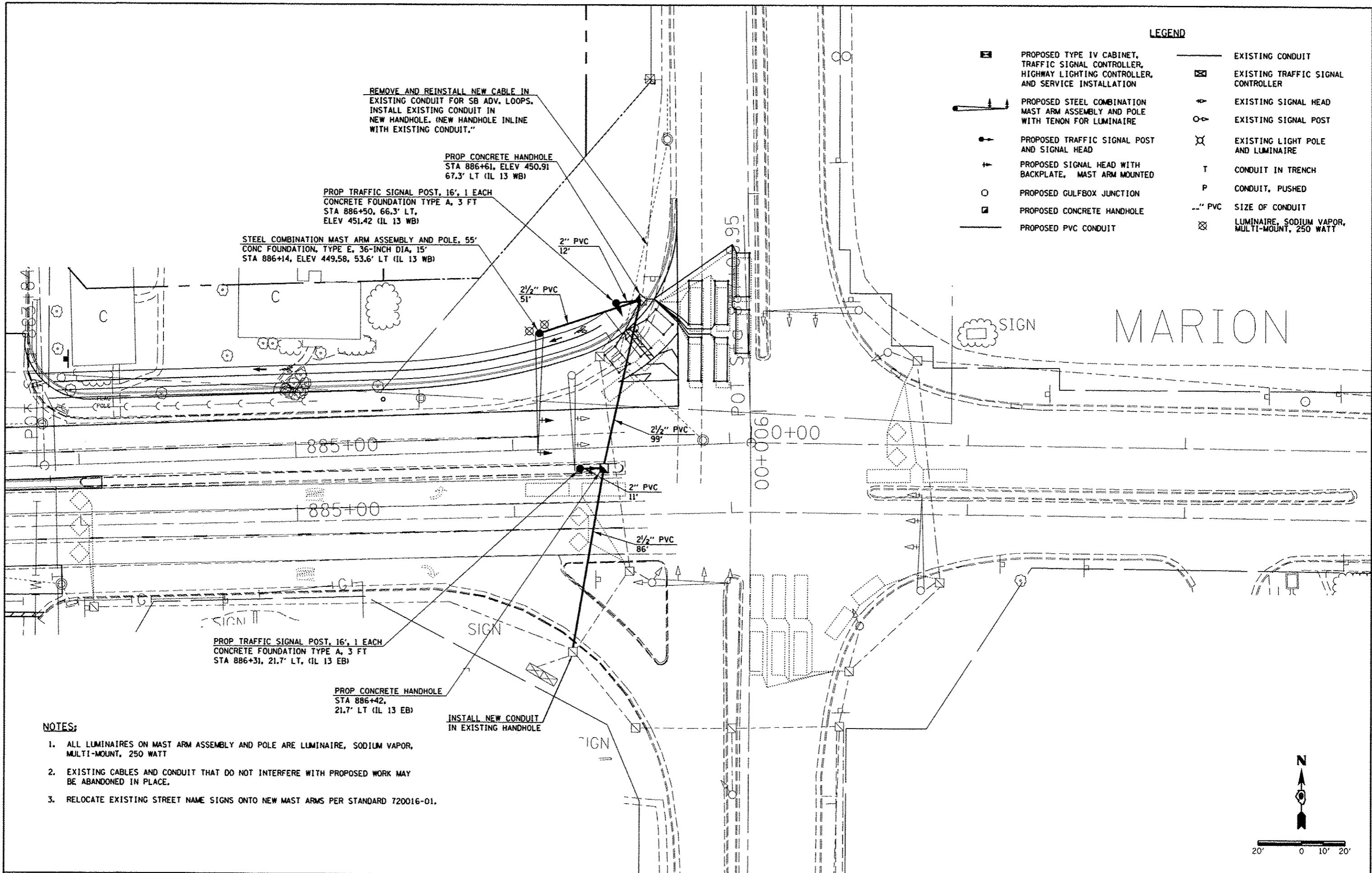

FILE NAME :	USER NAME : #USER#	DESIGNED -	REVISED -	STATE OF ILLINOIS DEPARTMENT OF TRANSPORTATION	PROPOSED TRAFFIC SIGNALS AND LIGHTING - IL 13 /IL 37	F.A. RTE.	SECTION	COUNTY	TOTAL SHEETS	SHEET NO.	
c:\pwork\pwork\skelley\d0810445\17820	draht-tsig.dgn	DRAWN -	REVISED -			331	(IX-1R-5,RS-3,N-5,TS-4	WILLIAMSON	288	137	
	PLOT SCALE = 40.0000' / in.	CHECKED -	REVISED -			CONTRACT NO. 78203					
	PLOT DATE = 5/11/2012	DATE -	REVISED -			ILLINOIS FED. AID PROJECT					
					SCALE:	SHEET NO. OF SHEETS STA. TO STA.					