

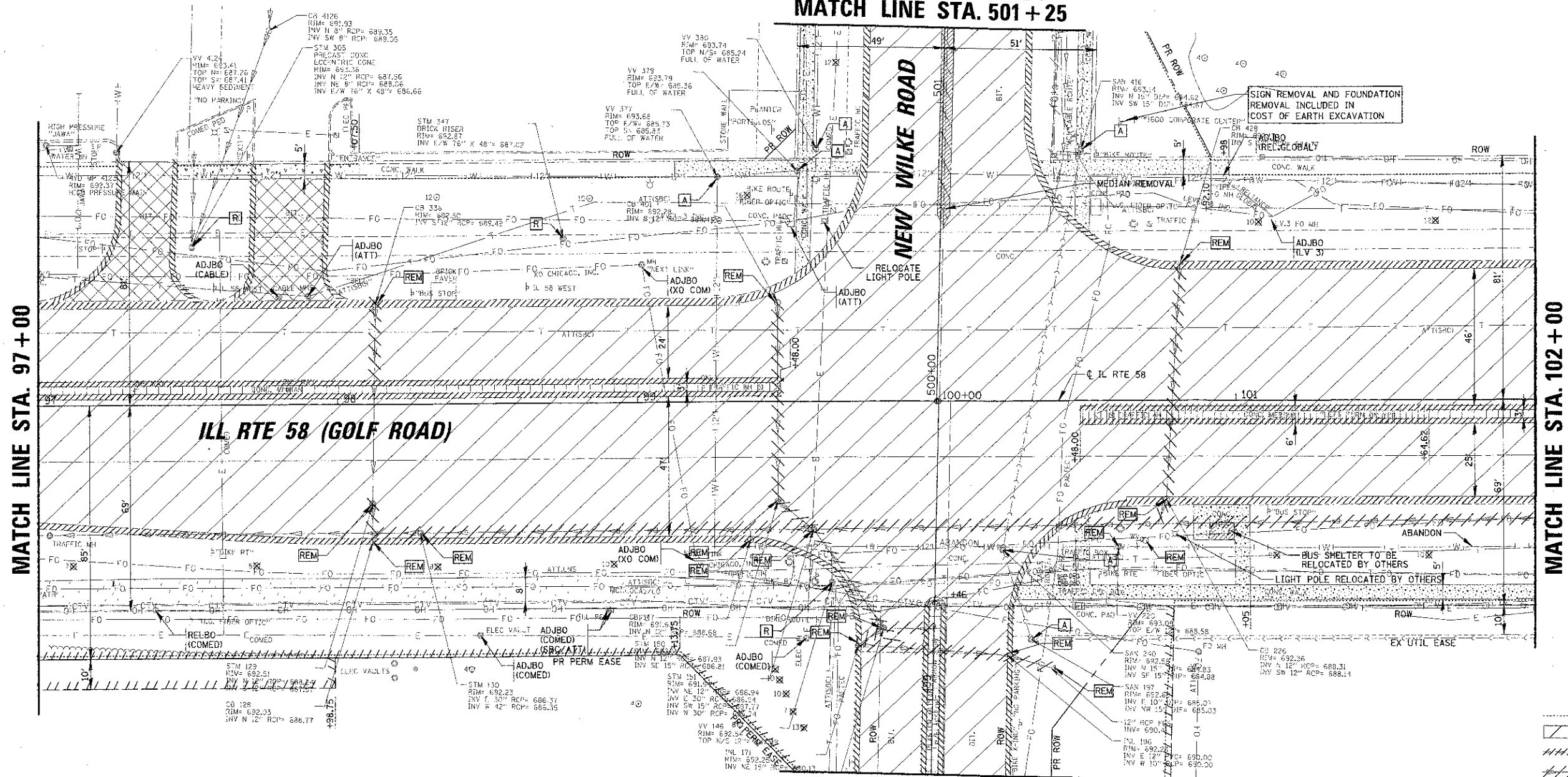

20 0 20
SCALE IN FEET

SEE SHEET NO. 24
MATCH LINE STA. 501 + 25



MATCH LINE STA. 498 + 75
SEE SHEET NO. 23

- LEGEND**
- PR CONSTRUCTION LIMITS
 - PAVEMENT REMOVAL
 - CURB AND GUTTER OR CURB REMOVAL
 - STORM SEWER REMOVAL
 - MEDIAN REMOVAL
 - MEDIAN SURFACE REMOVAL
 - REMOVE
 - RECONSTRUCT
 - ADJUST
 - DRIVEWAY REMOVAL
 - BITUMINOUS BIKE PATH REMOVAL (PAID AS EARTH EXCAVATION)
 - CONCRETE SIDEWALK REMOVAL
 - ADJUST BY OTHERS (UTILITY TYPE)
 - RELOCATE BY OTHERS (UTILITY TYPE)
 - TREE REMOVAL OF DIAMETER SHOWN

NOTE:
SEE SHEET 62 FOR TRAFFIC
SIGNAL RELATED REMOVAL ITEMS.

FILE NAME = M:\WORKING\98-0007\CONV\1\980320-498.BIT	USER NAME = mvdjara	DESIGNED - BLL	REVISED -	STATE OF ILLINOIS DEPARTMENT OF TRANSPORTATION	IL RTE 58 (GOLF ROAD) AND NEW WILKE ROAD IMPROVEMENTS EXISTING CONDITIONS AND REMOVAL PLAN IL RTE 58 (GOLF ROAD)	F.A.P. RTE.	SECTION	COUNTY	TOTAL SHEET SHEETS NO.	
PROT SCALE = 2"=100'	CHECKED - JGS	REVISED -	0559			00-00078-00-CH	COCK	116	19	
PLOT DATE = 4/17/2012	DATE - 8/06/12	REVISED -	SCALE: 20'			SHEET NO. 4 OF 9 SHEETS		STA. 97+00 TO STA. 102+00		
			FED. ROAD DIST. NO. ILLINOIS FED. AID PROJECT			CONTRACT NO. 83735				