

**JANE ADDAMS
MEMORIAL TOLLWAY
I-90**

BEGIN RECONSTRUCTION
STA. 496+32.80

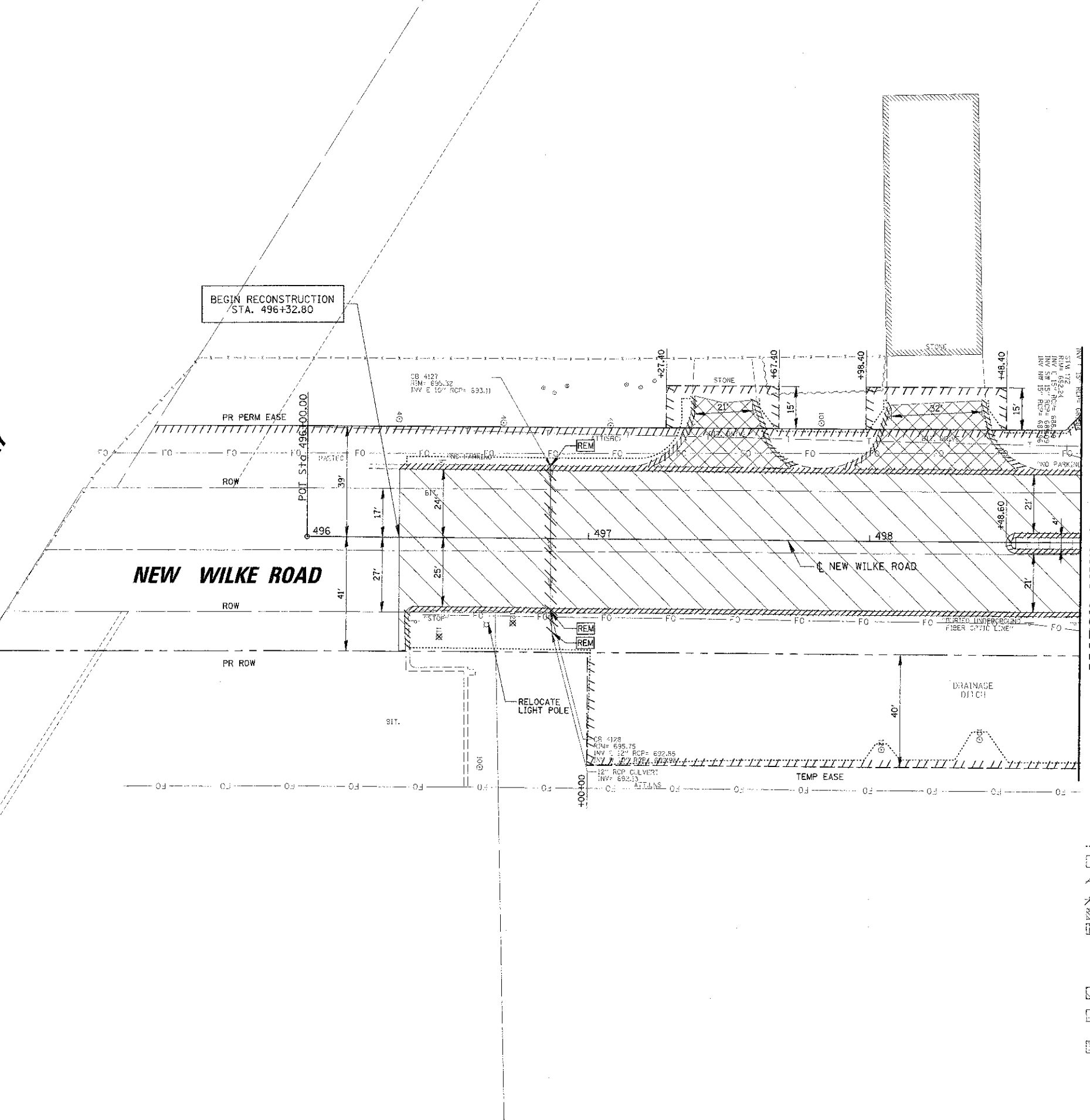

**MATCH LINE STA. 498+75
SEE SHEET NO. 19**

- LEGEND**
- PR CONSTRUCTION LIMITS
 - PAVEMENT REMOVAL
 - CURB AND GUTTER OR CURB REMOVAL
 - STORM SEWER REMOVAL
 - MEDIAN REMOVAL
 - MEDIAN SURFACE REMOVAL
 - REMOVE
 - RECONSTRUCT
 - ADJUST
 - DRIVEWAY REMOVAL
 - BITUMINOUS BIKE PATH REMOVAL (PAID AS EARTH EXCAVATION)
 - CONCRETE SIDEWALK REMOVAL
 - ADJBO (UTIL) ADJUST BY OTHERS (UTILITY TYPE)
 - RELBO (UTIL) RELOCATE BY OTHERS (UTILITY TYPE)
 - 12" TREE REMOVAL OF DIAMETER SHOWN

FILE NAME: =	USER NAME: = mvdurand	DESIGNED: = BLL	REVISED: =	STATE OF ILLINOIS DEPARTMENT OF TRANSPORTATION	IL RTE 58 (GOLF ROAD) AND NEW WILKE ROAD IMPROVEMENTS EXISTING CONDITIONS AND REMOVAL PLAN NEW WILKE ROAD			F.A.P. RATE: 0559	SECTION: 00-00078-00-CH	COUNTY: COOK	TOTAL SHEETS: 116	SHEET NO.: 23
AVG2\KING\W\063077\GOLF\I-90\8338823-191.SW		DRAWN: = PNM	REVISED: =		SCALE: 20'	SHEET NO. 8 OF 9 SHEETS	STA. 496+35.30 TO STA. 498+75	FED. ROAD DIST. NO. ILLINOIS	FED. AID PROJECT	CONTRACT NO. 83735		
		CHECKED: = JGS	REVISED: =									
		DATE: = 8/06/12	REVISED: =									