

F.A.P. RTE.	SECTION	COUNTY	TOTAL SHEETS	SHEET NO.
729		VERMILION	298	58
STA. 93+951.420		TO STA. 95+420		
FED. ROAD DIST. NO.		ILLINOIS FED. AID PROJECT		
• 36(W,RS-1) & 34Z-2(W,RS) CONTRACT #90939				

STAGE 2

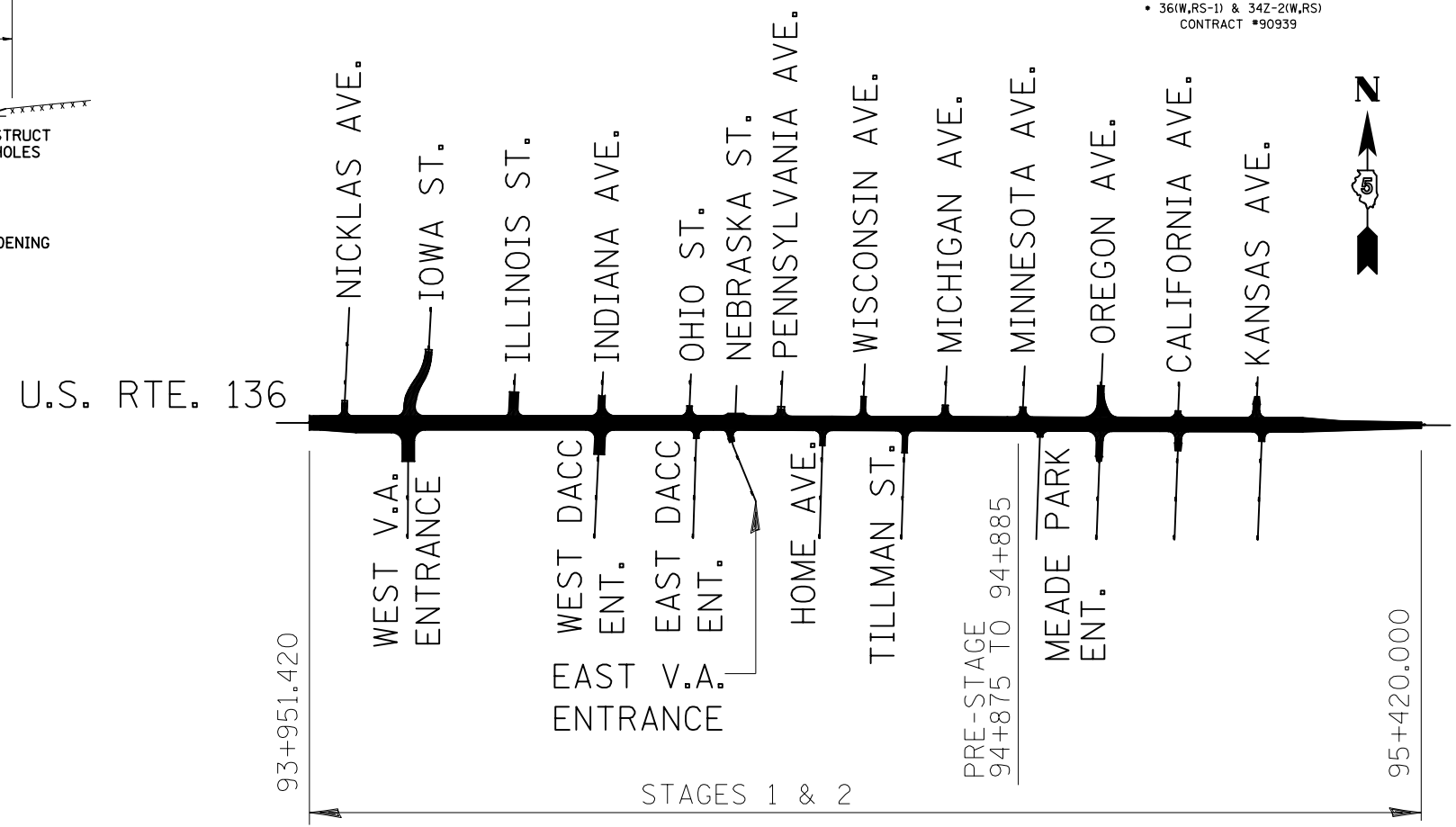
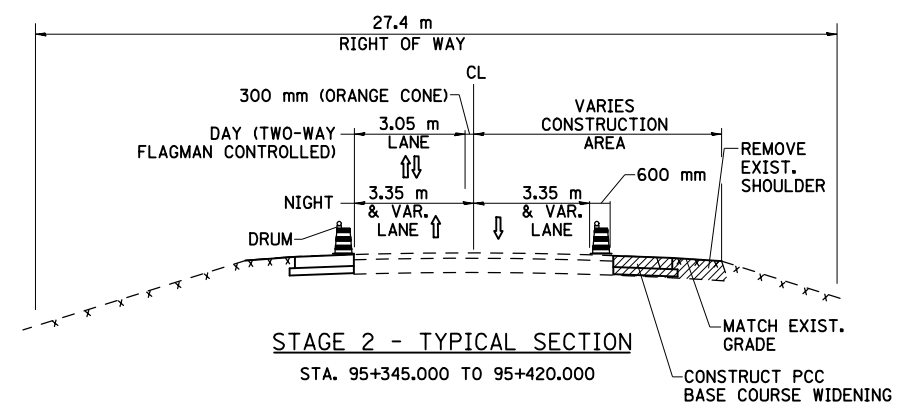
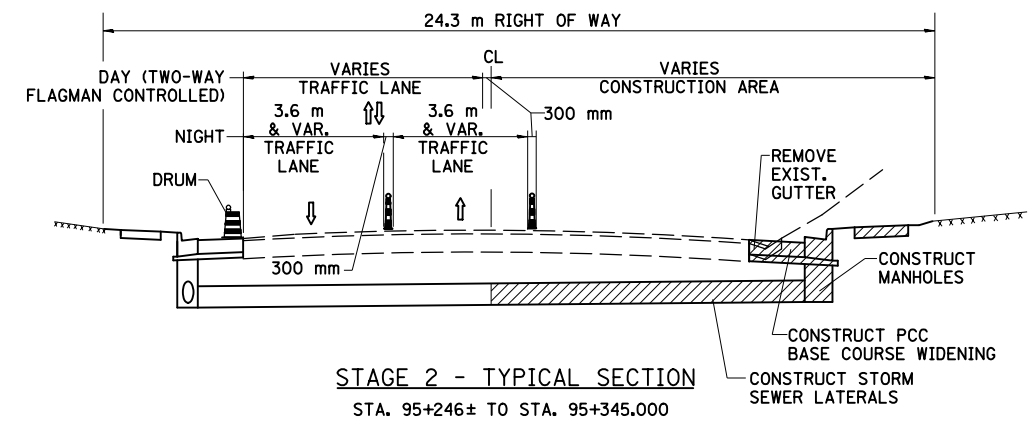
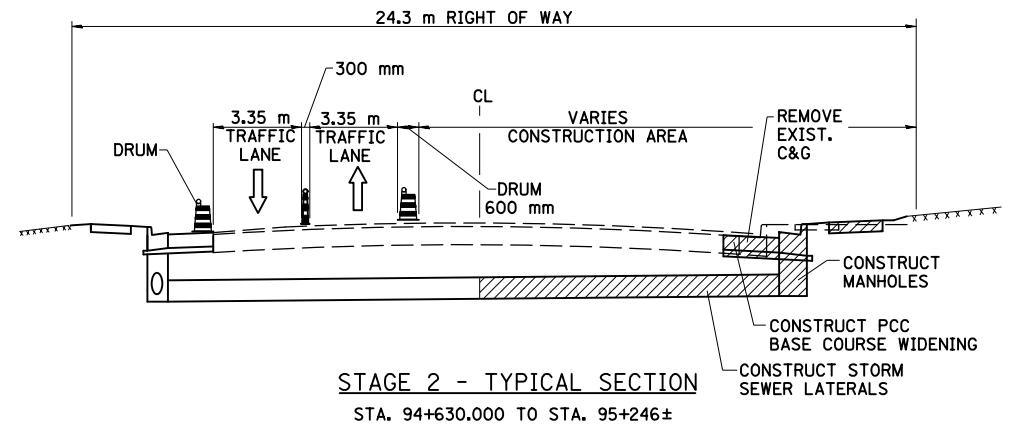
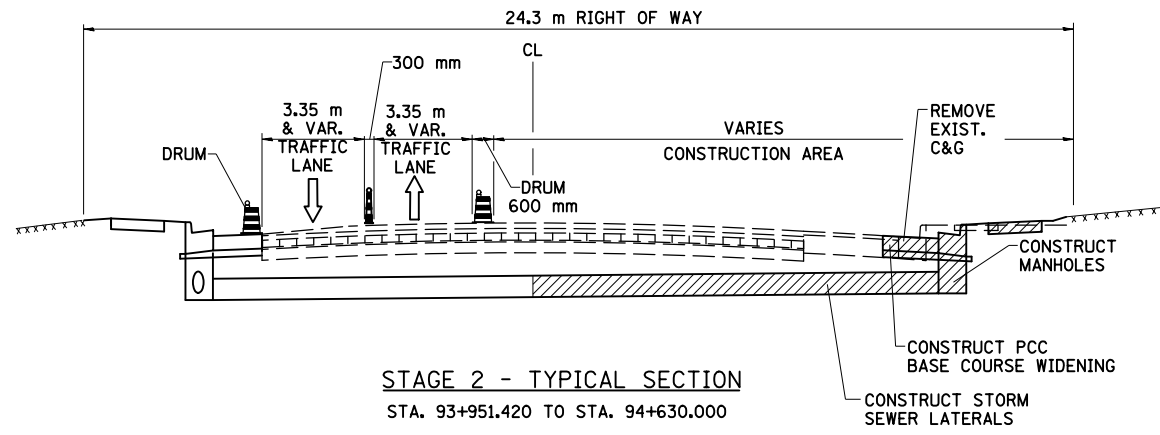

PLAN

GENERAL NOTES:
CLOSE ONLY THE OUTSIDE LANE WHEN CONSTRUCTION DOES NOT ENCOACH ON THE INSIDE LANE.

- NOTE:**
1. ORANGE CONES, 1.07 m TALL, SHALL BE USED TO SEPARATE TRAFFIC IN THE LOCATIONS SHOWN INSTEAD OF BARRICADES OR LIGHTED DRUMS. THE DEVICES SHALL BE EQUIPPED WITH TWO 100-150 mm WHITE AND TWO 100-150 ORANGE HI-INTENSITY REFLECTIVE STRIPES. THE STRIPES SHALL BE SPACED AS SHOWN FOR DRUMS ON HIGHWAY STANDARD 702001.
 2. EACH OF THESE DEVICES SHALL BE EQUIPPED WITH A RUBBER BALLAST WEIGHING NO LESS THAN 13.6 KG.
 3. SPACING FOR THE 1.07 m TALL CONES SHALL BE AT 8 m CENTERS.

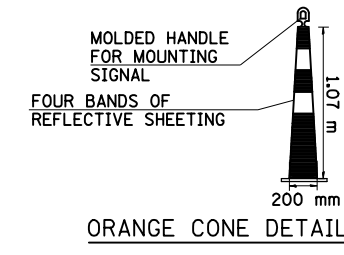

LEGEND	
	DIRECTION OF TRAFFIC FLOW
	PROPOSED CONSTRUCTION

REVISIONS	
NAME	DATE

ILLINOIS DEPARTMENT OF TRANSPORTATION
MAINTENANCE OF TRAFFIC PLANS
U.S. ROUTE 136
 SCALE 1:500 DRAWN BY FML
 DATE 8/03 CHECKED BY IYL

ct:\pw\work\pwidot\ceer\lock\j\d0313241\sscc2.dgn
 8/17/2012