

# TRAFFIC SIGNAL MODERNIZATION FAP 729 (MAIN ST.)

## & INDIANA AVENUE



### SIGNAL LAYOUT



F.A.P. RTE.	SECTION	COUNTY	TOTAL SHEETS	SHEET NO.
729		VERMILION	298	120
* 36(W,RS-1) & 34Z-(W,RS) CONTRACT #90939				

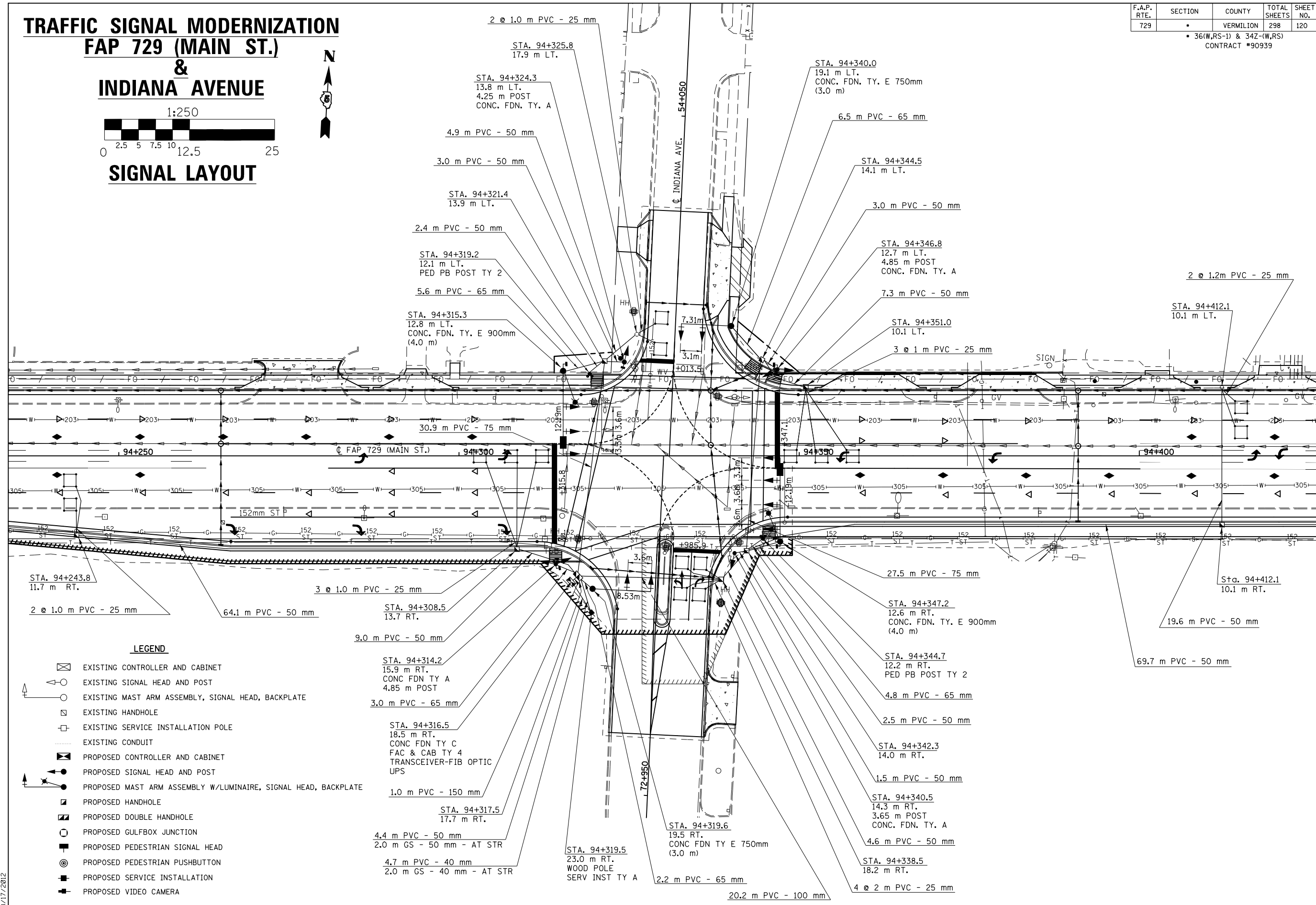

#### LEGEND

- EXISTING CONTROLLER AND CABINET
- EXISTING SIGNAL HEAD AND POST
- EXISTING MAST ARM ASSEMBLY, SIGNAL HEAD, BACKPLATE
- EXISTING HANDHOLE
- EXISTING SERVICE INSTALLATION POLE
- EXISTING CONDUIT
- PROPOSED CONTROLLER AND CABINET
- PROPOSED SIGNAL HEAD AND POST
- PROPOSED MAST ARM ASSEMBLY W/LUMINAIRE, SIGNAL HEAD, BACKPLATE
- PROPOSED HANDHOLE
- PROPOSED DOUBLE HANDHOLE
- PROPOSED GULFBOX JUNCTION
- PROPOSED PEDESTRIAN SIGNAL HEAD
- PROPOSED PEDESTRIAN PUSHBUTTON
- PROPOSED SERVICE INSTALLATION
- PROPOSED VIDEO CAMERA

8/17/2012