



T 3 N, R 1 W, 4TH PM  
SECTION 15

**LEGEND**

-  PERIMETER EROSION BARRIER
-  TEMPORARY DITCH CHECK
-  SPECIAL DITCH - FLOW LINE AND DIRECTION
-  PROPOSED RIPRAP/AGGREGATE DITCH PLACEMENT

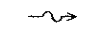
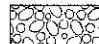
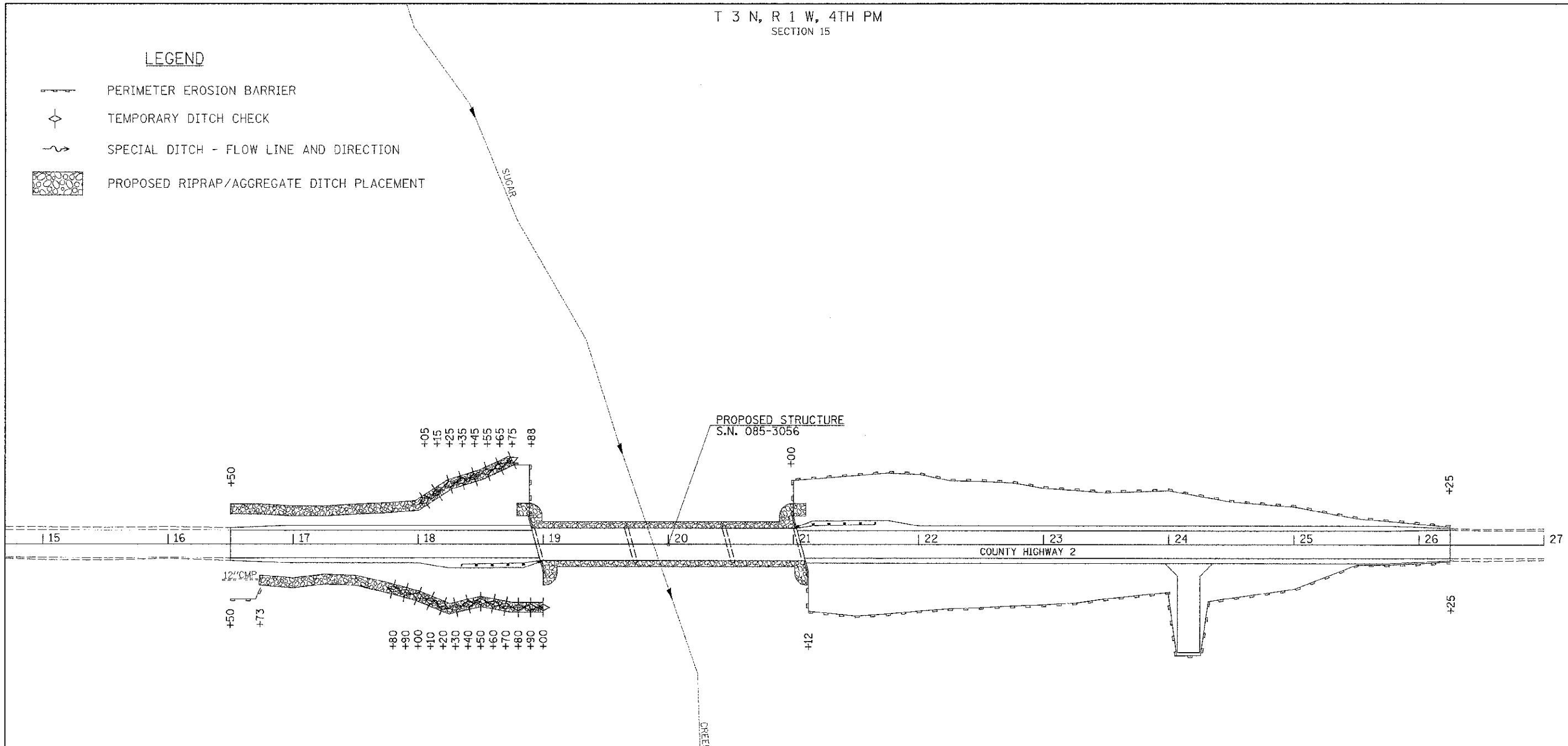

NOTE: TEMPORARY EROSION CONTROL SEEDING SHALL BE DONE IN ACCORDANCE WITH ARTICLE 280.04 OF THE STANDARD SPECIFICATIONS.

T 3 N, R 1 W, 4TH PM  
SECTION 15

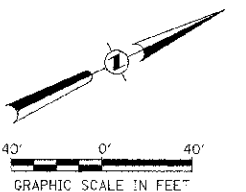

FILE NAME = V:\Bridge\2990 - Schuyler\2990\000.dgn	USER NAME = cthomas	DESIGNED -	REVISED -	<b>SCHUYLER COUNTY COUNTY HIGHWAY 2 OVER SUGAR CREEK</b>	<b>STORM WATER POLLUTION PREVENTION PLAN</b>			F.A.S. RTE. 455	SECTION 07-00073-00-BR	COUNTY SCHUYLER	TOTAL SHEETS 35	SHEET NO. 5
PLOT SCALE - 40,0000' / in.		CHECKED -	REVISED -		SCALE: 1" = 40'    SHEET NO. 1 OF 1 SHEETS    STA. 16+50.00 TO STA. 26+25.00			CONTRACT NO. 93584				
PLOT DATE = 7/24/2017		DATE -	REVISED -		FED. ROAD DIST. NO. 7 ILLINOIS    FED. AID PROJECT BR5-0455(07)							