

LOCATION B

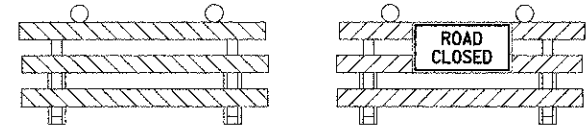

LOCATION A

- LEGEND**
- T POST MOUNTED SIGN
 - FLASHING LIGHT
 - INDICATES 200' TYPICAL TO FIRST SIGN OR TO MEET FIELD CONDITIONS.

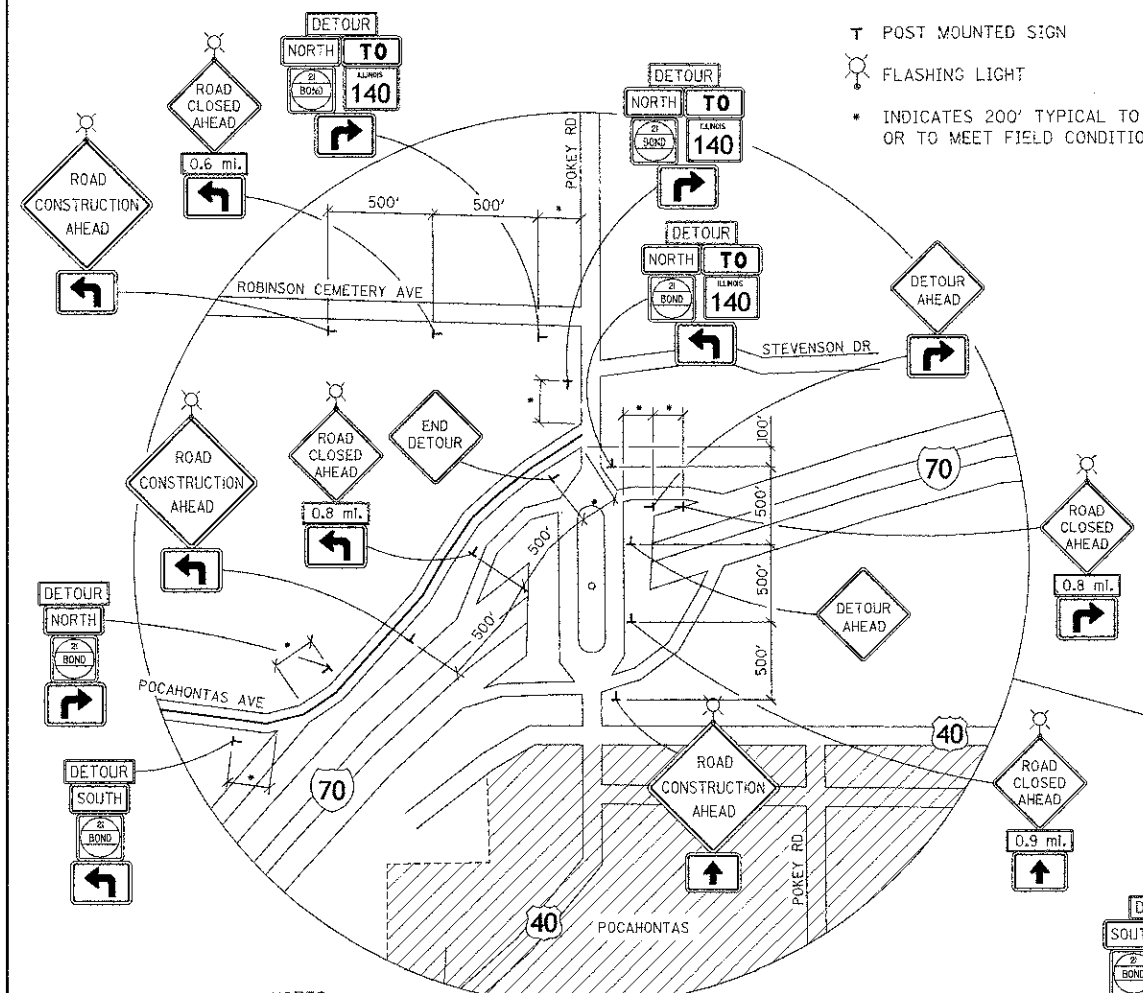

NOTES:

1. ENGINEER MAY MODIFY SIGN PLACEMENT TO MEET FIELD CONDITIONS.
2. ALL ADVANCED WARNING SIGNS SHALL BE 48" x 48" AND HAVE A BLACK LEGEND ON A FLUORESCENT ORANGE REFLECTORIZED BACKGROUND.
3. ALL ADVANCED WARNING SIGNS SHALL INCLUDE LOW INTENSITY FLASHING LIGHTS.
4. DETOUR SIGNING ASSEMBLY SHALL MAINTAIN THE HEIGHT TO THE BOTTOM OF THE LOWEST SIGN NO LESS THAN 5 FEET ABOVE THE EDGE OF PAVEMENT.
5. ALL TYPE III BARRICADES SHALL REQUIRE A MINIMUM OF FOUR SANDBAGS PER BARRICADE FOR STABILIZATION.
6. AT LOCATIONS WHERE TYPE III BARRICADES ARE STAGGERED THE "ROAD CLOSED TO THRU TRAFFIC" SIGN SHALL BE PLACED ON THE FRONT BARRICADE.
7. ALL ITEMS OF WORK INVOLVED WITH THE ROAD CLOSURE WILL BE PAID FOR AT THE CONTRACT UNIT PRICE PER LUMP SUM FOR TRAFFIC CONTROL AND PROTECTION, (SPECIAL).
8. THE CONTRACTOR SHALL NOTIFY THE RESIDENT ENGINEER 72 HOURS PRIOR TO CLOSURE.

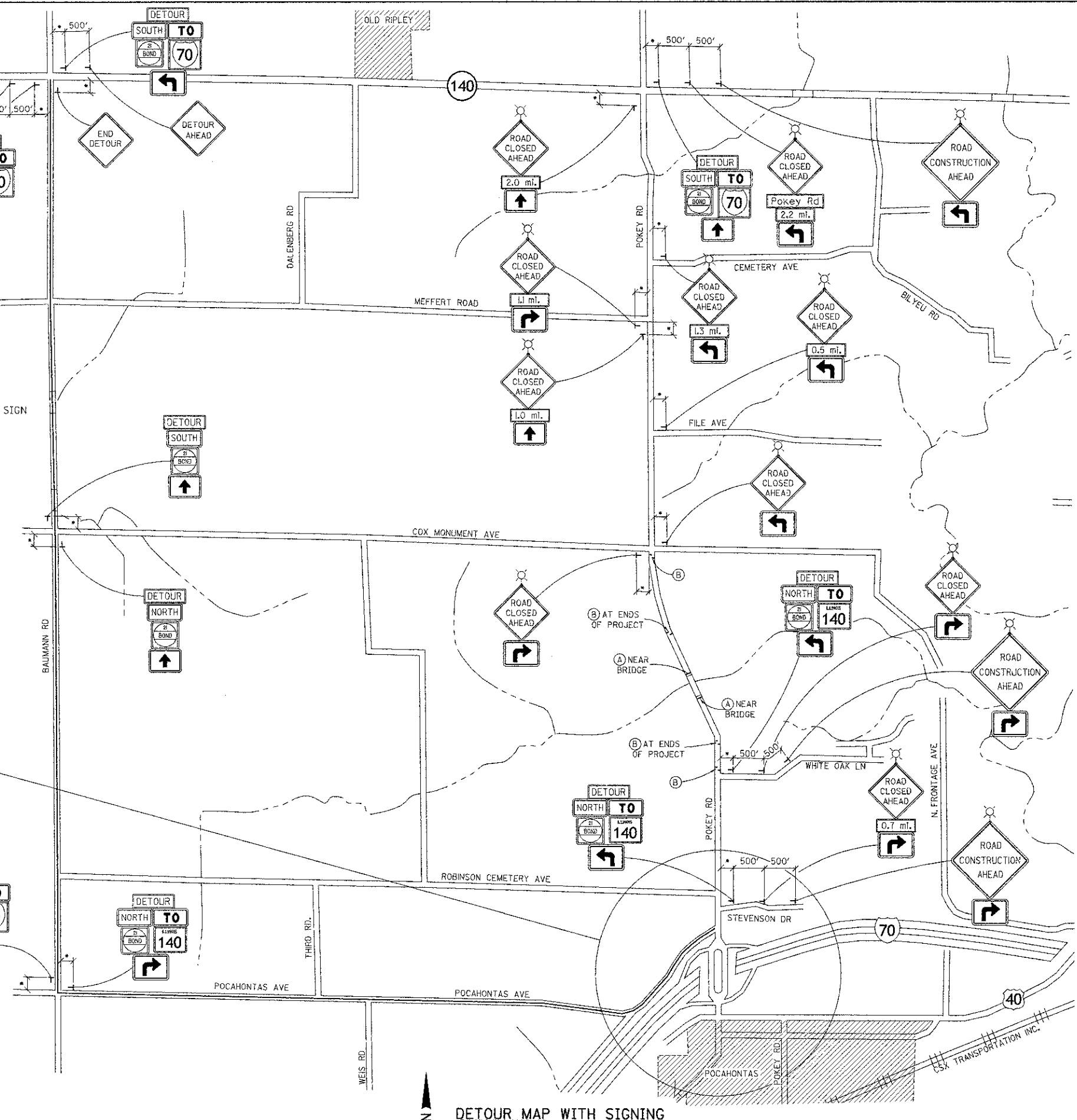

DETOUR MAP WITH SIGNING

FILE NAME = H:\15798\C_14_DetourMap_5798.dgn	USER NAME = JUSERDESCR	DESIGNED - K.M.M.	REVISED -	STATE OF ILLINOIS DEPARTMENT OF TRANSPORTATION	DETOUR MAP	FAS RTE = 779	SECTION = 07-00085-00-BR	COUNTY = BOND	TOTAL SHEETS = 41	SHEET NO. = 14	
PLT SCALE = 240.00000 / 1	CHECKED - L.D.G.	DATE = 9/7/2012	REVISED -			SCALE =	SHEET NO. 1 OF 1 SHEETS	STA. TO STA.	SN 003-3053	CONTRACT NO. 97508	[ILLINOIS] FEDERAL AID PROJECT
HMG ENGINEERS, INC. LAKE RD., P.O. BOX 70 CARLYLE, IL 62231 (618) 594-3711 WWW.HMGENGINEERS.COM											
						HMG INC. 15798					