

FAP NO.	SECTION	COUNTY	TOTAL SHEETS	SHEET NO.
338	114 BY-R-1	WILL	139	14
STA. 3194+00		TO STA. 3245+00		
FED. ROAD DIST. NO.		ILLINOIS FAP 338 (IL RTE. 59)		

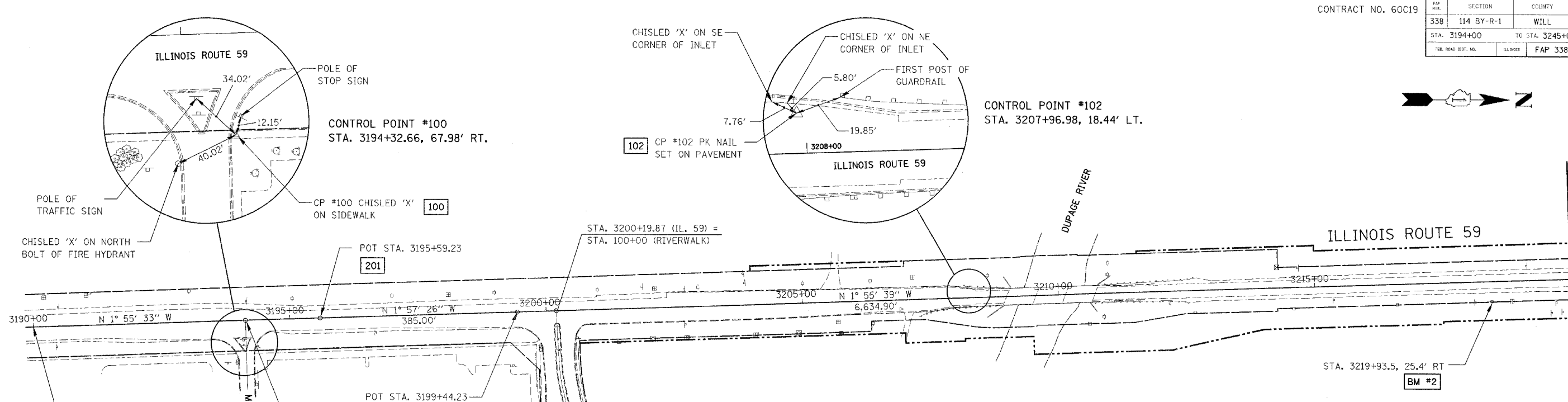

CONTROL POINTS DATA

100	N 1,784,768.127 E 1,020,678.918
102	N 1,786,128.925 E 1,020,551.459
103	N 1,787,428.313 E 1,020,551.450
104	N 1,788,309.441 E 1,020,474.975
105	N 1,789,189.158 E 1,020,488.943

ALIGNMENT DATA

200	N 1,784,333.593 E 1,020,630.512
201	N 1,784,892.502 E 1,020,611.719
202	N 1,785,277.278 E 1,020,598.570

BENCHMARKS

BM #2 2 1/2 NAIL IN SOUTH FACE OF THE SECOND POWER POLE SOUTH OF ROLF ROAD AND IL. ROUTE 59 ELEV. 594.24	BM #15 SQUARE CUT IN SE CORNER OF TRAFFIC SIGNAL HANDHOLE IN NE CORNER IL. ROUTE 59 AND CATON FARM ROAD ELEV. 602.35
BM #3 CHISELED 'X' ON THE WEST BOLT OF THE FIRST FIRE HYDRANT TO THE NORTH OF DAYFIELD ROAD AND IL. ROUTE 59 ACROSS FROM FOUNDERS BANK ELEV. 604.15	

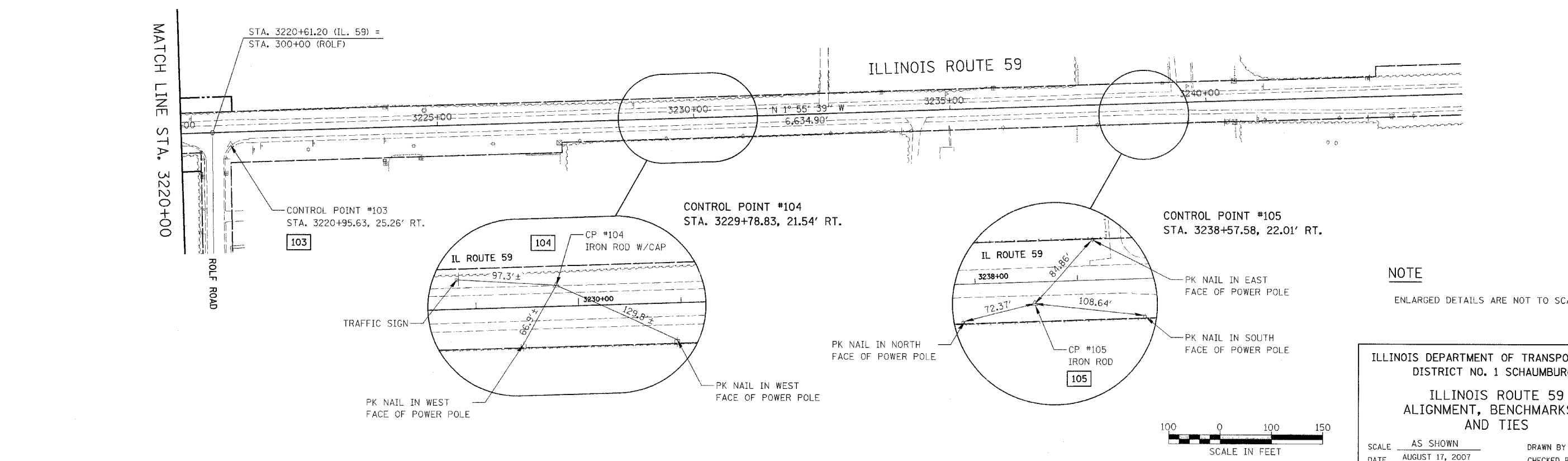

NOTE
ENLARGED DETAILS ARE NOT TO SCALE.

ILLINOIS DEPARTMENT OF TRANSPORTATION
DISTRICT NO. 1 SCHAUMBURG

**ILLINOIS ROUTE 59
ALIGNMENT, BENCHMARKS,
AND TIES**

SCALE AS SHOWN
DATE AUGUST 17, 2007

DRAWN BY REW
CHECKED BY JCM

