

CONTRACT NO. 60C19

F/R	SECTION	COUNTY	TOTAL SHEETS	SHEET NO.
338	114 BY-R-1	WILL	139	23
STA. 3204+00		TO STA. 3218+00		
FED. ROAD DIST. NO.		ILLINOIS	FAP 338 (IL RTE. 59)	

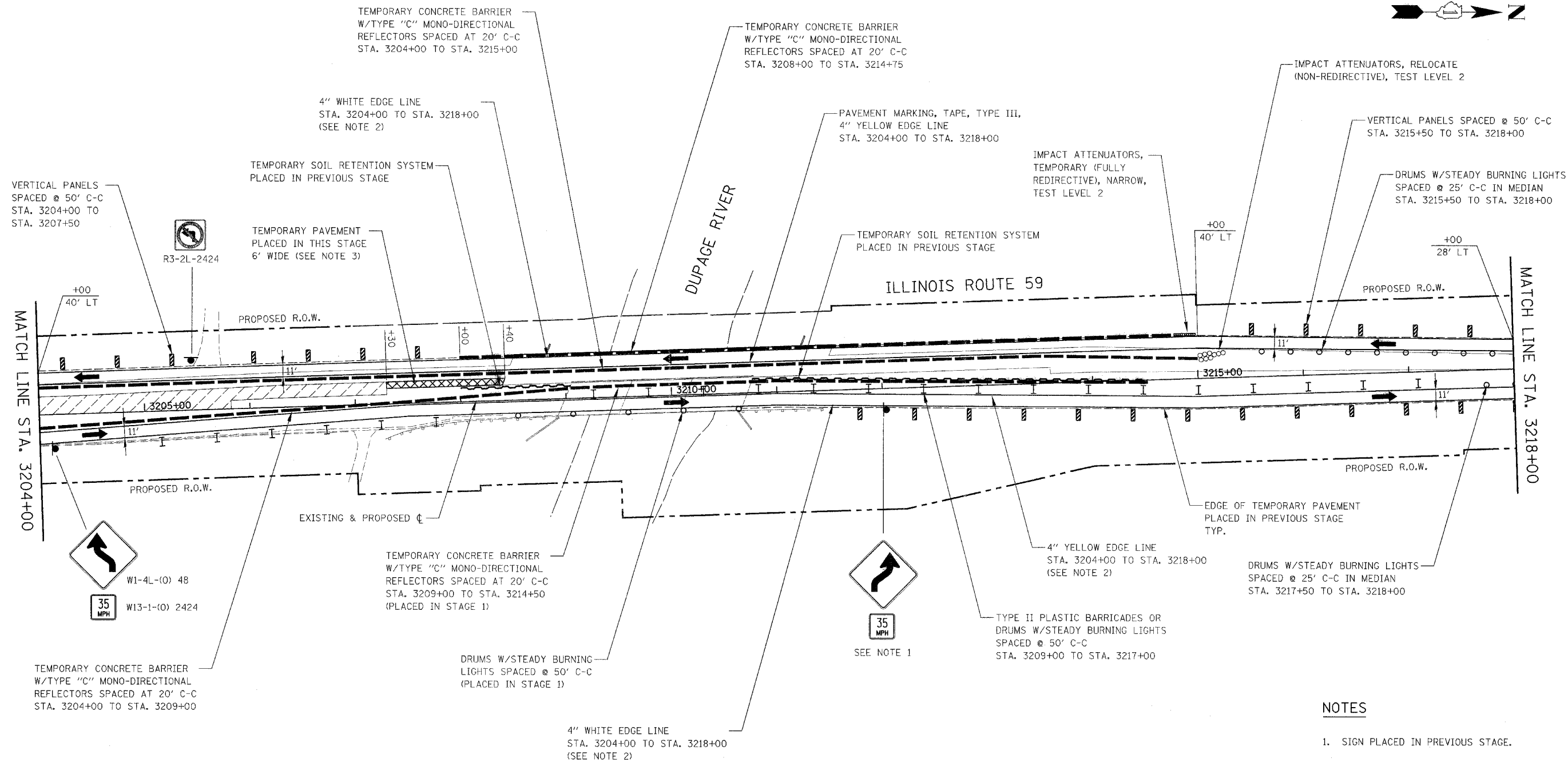

**NOTES**

1. SIGN PLACED IN PREVIOUS STAGE.
2. PAVEMENT MARKING PLACED IN PREVIOUS STAGE.
3. TEMPORARY PAVEMENT SHALL BE CONSTRUCTED IN ACCORDANCE WITH DETAIL ON SHEET NO. 102. THIS WORK SHALL BE PAID FOR AT THE CONTRACT UNIT PRICE FOR TEMPORARY PAVEMENT.

ILLINOIS DEPARTMENT OF TRANSPORTATION  
 DISTRICT NO. 1 SCHAUMBURG  
 STAGING PLANS  
 ILLINOIS ROUTE 59  
 STAGE 2



SCALE AS SHOWN  
 DATE AUGUST 17, 2007

DRAWN BY REW  
 CHECKED BY JCM