

F.A.U. RTE.	SECTION	COUNTY	TOTAL SHEETS	SHEET NO.
2678	N-7-5-I-1	COOK	18	1
STA.		TO STA.		
FED. ROAD DIST. NO.		ILLINOIS	FED. AID PROJECT	

**CONTRACT NO. 60C45**

**D-91-214-07**



LOCATION OF SECTION INDICATED THIS: - [Black Rectangle] -

**STATE OF ILLINOIS  
DEPARTMENT OF TRANSPORTATION  
DIVISION OF HIGHWAYS**

**PROPOSED  
HIGHWAY PLANS**

**F.A.U. RTE. 2678 / ELMHURST ROAD  
SECTION: N-7-5-I-1  
ELMHURST ROAD OVER I-90  
S.N. 016-0678**

**BRIDGE DECK REPAIRS AND OVERLAY  
COOK COUNTY  
C-91-214-07**

**FOR INDEX OF SHEETS, SEE SHEET NO. 2**

**FUNCTIONAL CLASSIFICATION: MINOR ARTERIAL (URBAN)  
ADT: 35,600 (2006), 50,490 (2021)  
DESIGN SPEED LIMIT: 40 MPH  
POSTED SPEED LIMIT: 40 MPH**

**SCOPE OF WORK**

**THE BRIDGE SUPERSTRUCTURE WILL HAVE REPAIRS TO THE DECK AND TO THE JOINTS AND THE OVERLAY WILL BE REMOVED AND REPLACED**

**IMPROVEMENTS LOCATED IN THE VILLAGE OF DES PLAINES,  
COOK COUNTY**

**LOCATION OF WORK  
ELMHURST RD./ N.W. TOLLWAY  
S.N. 016-0678**

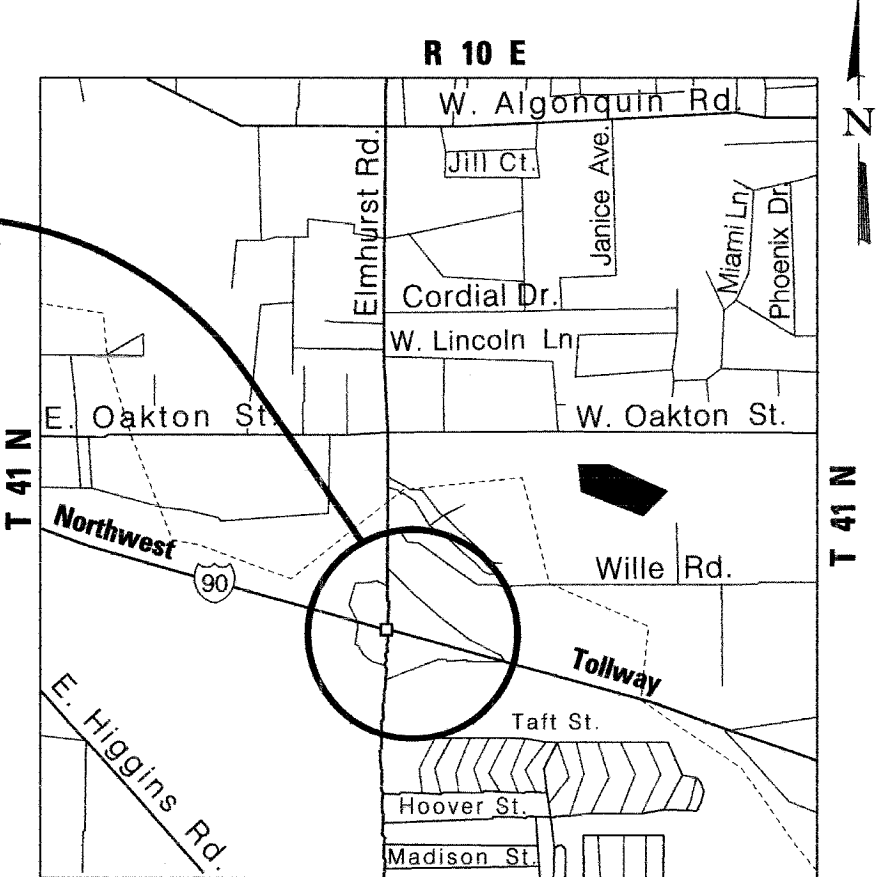

**R 10 E  
LOCATION MAP  
NOT TO SCALE**

**GROSS & NET LENGTH = 258 FT. = 0.05 MILES**

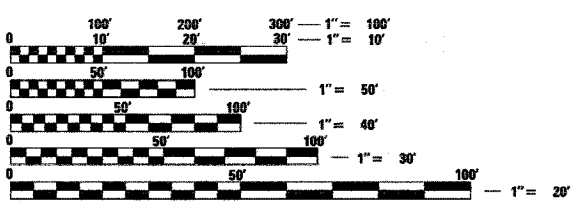

**FULL SIZE PLANS HAVE BEEN PREPARED USING STANDARD ENGINEERING SCALES. REDUCED SIZED PLANS WILL NOT CONFORM TO STANDARD SCALES. IN MAKING MEASUREMENTS ON REDUCED PLANS, THE ABOVE SCALES MAY BE USED.**

**J.U.L.I.E.  
JOINT UTILITY LOCATION INFORMATION FOR EXCAVATION  
1-800-892-0123**

**C.U.A.N.  
CHICAGO UTILITY ALERT NETWORK  
1-312-744-7000**



*Bhadresh N. Shah*  
BHADRESH N. SHAH JULY 25, 2007  
LICENSED STRUCTURAL ENGINEER  
STATE OF ILLINOIS LIC. No. 081-004476  
EXPIRES: 11-30-08



**CHRISTIAN-ROGE & ASSOCIATES, INC.**  
ENGINEERS / PLANNERS / SURVEYORS  
211 W. WACKER DRIVE CHICAGO, IL. 60606  
TELEPHONE: 312-372-2023

**STATE OF ILLINOIS  
DEPARTMENT OF TRANSPORTATION  
DIVISION OF HIGHWAYS**

SUBMITTED July 25, 2007

*Diane O'Keefe/CD*  
DEPUTY DIRECTOR OF HIGHWAYS, REGION ENGINEER

October 12, 2007

*Eric E. Harman/CD*  
ENGINEER OF DESIGN AND ENVIRONMENT

October 12, 2007

*Melvin R. Seay, P.E./CD*  
DIRECTOR OF HIGHWAYS, CHIEF ENGINEER

**PRINTED BY THE AUTHORITY  
OF THE STATE OF ILLINOIS**

**DISTRICT ONE - DESIGN PLAN PREPARATION ENGINEER:  
J. DOMINGUEZ / RAGHUPATI SINHA (847) 705-4209**

**CONTRACT NO. 60C45**

F.A.U. RTE.	SECTION	COUNTY	TOTAL SHEETS	SHEET NO.
2678	N-7-5-I-1	COOK	18	2
STA.		TO STA.		
FED. ROAD DIST. NO.		ILLINOIS	FED. AID PROJECT	

**CONTRACT NO. 60C45**

INDEX OF SHEETS

SHEET NO.	DESCRIPTION	STANDARD NO.
1	COVER SHEET	701411-03
2	INDEX OF SHEETS, LIST OF STATE STANDARDS AND GENERAL NOTES	701601-04
3	SUMMARY OF QUANTITIES	
4	TRAFFIC CONTROL AND PROTECTION STAGE I	702001-06
5	TRAFFIC CONTROL AND PROTECTION STAGE II	
<b>S.N. 016-0678</b>		
6	GENERAL PLAN & ELEVATION	
7	CONSTRUCTION STAGING TYPICAL SECTIONS	
8	CROSS SECTION	
9	DECK CONCRETE PATCHING	
10	SILICONE SEAL JOINT REPAIR	
11	TYPICAL APPLICATIONS RAISED REFLECTIVE PAVEMENT MARKERS (SNOW-PLOW RESISTANT) (TC11)	
12	DISTRICT ONE TYPICAL PAVEMENT MARKINGS (TC13)	
13	ISTHA STANDARD: CONSTRUCTION SIGNS (E1-00)	
14	ISTHA STANDARD: CONSTRUCTION SIGNS (E1-00)	
15	ISTHA STANDARD: LANE CLOSURE DETAILS (E2-00)	
16	ISTHA STANDARD: LANE CLOSURE DETAILS (E2-00)	
17	ISTHA STANDARD: LANE CLOSURE DETAILS (E2-00)	
18	ISTHA STANDARD: TEMPORARY GORE DETAILS AND SHOULDER CLOSURE DETAILS (E3-00)	

LIST OF STATE STANDARDS

STANDARD NO.	DESCRIPTION
701411-03	LANE CLOSURE, MULTILANE AT ENTRANCE OR EXIT RAMP FOR SPEED $\geq$ 45 MPH
701601-04	URBAN LANE CLOSURE, MULTILANE, 1W OR 2W WITH NONTRAVERSABLE MEDIAN
702001-06	TRAFFIC CONTROL DEVICES

GENERAL NOTES:

1. THESE PLANS HAVE BEEN PREPARED FROM NOTES RECEIVED FROM I.D.O.T. FIELD MAINTENANCE ENGINEERS.
2. ALL PAVEMENT MARKINGS AND RAISED REFLECTORS AFFECTED BY THE BRIDGE REPAIRS SHALL BE REPLACED. NOMINAL QUANTITIES HAVE BEEN INCLUDED IN THE CONTRACT FOR THIS WORK.
3. THE COST OF THE TOLLWAY PERMIT AND BOND AND THE COST OF THE TRAFFIC CONTROL AND PROTECTION ON THE NORTHWEST TOLLWAY TO INSTALL AND REMOVE THE PROTECTIVE SHIELDING SHALL BE INCLUDED IN THE BID PRICE FOR TRAFFIC CONTROL AND PROTECTION (SPECIAL).
4. PLAN DIMENSIONS AND DETAILS RELATIVE TO EXISTING PLANS ARE SUBJECT TO ROUTINE VARIATIONS. THE CONTRACTOR SHALL FIELD VERIFY EXISTING DIMENSIONS AND DETAILS AFFECTING NEW CONSTRUCTION AND MAKE NECESSARY APPROVED ADJUSTMENTS PRIOR TO CONSTRUCTION OR ORDERING OF MATERIALS. SUCH VARIATIONS SHALL NOT BE CAUSE FOR ADDITIONAL COMPENSATION FOR A CHANGE IN THE SCOPE OF WORK, HOWEVER, THE CONTRACTOR WILL BE PAID FOR THE QUANTITY ACTUALLY FURNISHED BASED UPON THE UNIT BID PRICE FOR THE WORK.
5. ALL TRAFFIC CONTROL DEVICES AND MEASURES DEEMED NECESSARY AND PLACED IN ACCORDANCE WITH THE APPLICABLE PORTIONS OF THE VARIOUS STANDARDS SHOWN ON THE TITLE SHEET WILL NOT BE PAID FOR SEPARATELY BUT SHALL BE INCLUDED IN THE PAY ITEM "TRAFFIC CONTROL AND PROTECTION".
6. THE RESIDENT ENGINEER SHALL CONTACT THE TRAFFIC CONTROL SUPERVISOR AT (847)705-4470 AT LEAST 72 HOURS PRIOR TO INSTALLATION OF THE TEMPORARY TRAFFIC CONTROL DEVICES.
7. THE CONTRACTOR WILL NOT BE ALLOWED TO SET UP A YARD OR FIELD OFFICE ON STATE PROPERTY WITHOUT WRITTEN PERMISSION FROM THE DEPARTMENT.
8. DO NOT SCALE THESE PLANS FOR CONSTRUCTION PURPOSES
9. WHEN ARTIFICIAL LIGHTING IS UTILIZED IN NIGHT OPERATIONS, THE CONTRACTOR MUST EXERCISE THE UTMOST PRECAUTIONS IN PREVENTING ADVERSE VISIBILITY TO THE MOTORING PUBLIC AND TO THE ADJOINING RESIDENTIAL AREAS.

SCOPE OF WORK:

1. REMOVE THE EXISTING 2" HOT-MIX ASPHALT SURFACE & HYDRO-SCARIFY 1/2" OF THE CONCRETE SURFACE
2. MARK AREAS OF FULL DEPTH REPAIRS
3. PERFORM DECK SLAB REPAIRS
4. REPAIR SILICONE JOINT SEAL
5. PLACE A 2 1/2" LATEX CONCRETE OVERLAY

REVISIONS	
NAME	DATE

ILLINOIS DEPARTMENT OF TRANSPORTATION

INDEX OF SHEETS,  
LIST OF STATE STANDARDS  
AND GENERAL NOTES  
F.A.U. RTE. 2678 / ELMHURST ROAD

SCALE: NONE  
DATE: JULY 25, 2007

DRAWN BY: F.M.  
CHECKED BY: B.N.S.

**CHRISTIAN-ROGE & ASSOC., INC.**  
CHICAGO ILLINOIS

F.A.U. RTE.	SECTION	COUNTY	TOTAL SHEETS	SHEET NO.
2678	N-7-5-I-1	COOK	18	3
STA.		TO STA.		
FED. ROAD DIST. NO.	ILLINOIS	FED. AID PROJECT		

**CONTRACT NO. 60C45**

**SUMMARY OF QUANTITIES**

*URBAN  
100% STATE*

SUMMARY OF QUANTITIES			TOTAL QUANTITIES	CONSTRUCTION TYPE CODE
CODE NO.	ITEM	UNIT		S.N. 016-0678 FUNDS
				SFTY-2A
44000915	HOT-MIX ASPHALT SURFACE REMOVAL (DECK)	SQ. YD.	1,893	1,893
50157300	PROTECTIVE SHIELD	SQ. YD.	1,460	1,460
50300260	BRIDGE DECK GROOVING	SQ. YD.	1,776	1,776
67100100	MOBILIZATION	L. SUM	1	1
70101800	TRAFFIC CONTROL AND PROTECTION (SPECIAL)	L. SUM	1	1
70300520	PAVEMENT MARKING TAPE, TYPE III 4"	FOOT	6,830	6,830
70301000	WORK ZONE PAVEMENT MARKING REMOVAL	SQ. FT.	2,254	2,254
*78005110	EPOXY PAVEMENT MARKING-LINE 4"	FOOT	2,585	2,585
*78005140	EPOXY PAVEMENT MARKING-LINE 8"	FOOT	400	400
*78005150	EPOXY PAVEMENT MARKING-LINE 12"	FOOT	120	120
*78100105	RAISED REFLECTIVE PAVEMENT MARKER (BRIDGE)	EACH	16	16
78300100	PAVEMENT MARKING REMOVAL	SQ. FT.	777	777
78300200	RAISED REFLECTIVE PAVEMENT MARKING REMOVAL	EACH	16	16
X0320887	POLYMER CONCRETE	CU. FT.	4.0	4.0
X0322933	SILICONE JOINT SEALER, 2.5"	FOOT	44	44
X0322489	BRIDGE DECK LATEX CONCRETE OVERLAY, 2 1/2 INCHES	SQ. YD.	1,893	1,893
X0322467	TEMPORARY INFORMATION SIGNING FOR LANE CLOSURE	SQ. FT.	48.0	48.0
X7011015	TRAFFIC CONTROL AND PROTECTION (EXPRESSWAYS)	L. SUM	1	1
Z0006204	BRIDGE DECK HYDRO-SCARIFICATION 1/2"	SQ. YD.	1,893	1,893
Z0016002	DECK SLAB REPAIR (FULL DEPTH, TYPE II)	SQ. YD.	11	11

\*SPECIALTY ITEMS

REVISIONS	
NAME	DATE

ILLINOIS DEPARTMENT OF TRANSPORTATION

SUMMARY OF QUANTITIES  
F.A.U. RTE. 2678 / ELMHURST ROAD

SCALE: NONE  
DATE: JULY 25, 2007

DRAWN BY: F.M.  
CHECKED BY: B.N.S.

**CHRISTIAN-ROGE & ASSOC., INC.**  
CHICAGO ILLINOIS

F.A.U. RTE.	SECTION	COUNTY	TOTAL SHEETS	SHEET NO.
2678	N-7-5-I-1	COOK	18	4
STA.		TO STA.		
FED. ROAD DIST. NO.		ILLINOIS		FED. AID PROJECT

**CONTRACT NO. 60C45**

**STAGE I  
SCHEDULE OF QUANTITIES**

ITEM	UNIT	QUANTITY
* PAVEMENT MARKING REMOVAL	SQ. FT.	611
RAISED REFLECTIVE PAVEMENT MARKER REMOVAL (BRIDGE ONLY)	EACH	16
PAVEMENT MARKING TAPE TYPE III, 4"	FOOT	4,020

\* REMOVE SKIP DASH:  
N.B. STA. 13+50 TO STA. 25+90  
S.B. STA. 6+60 TO STA. 22+00

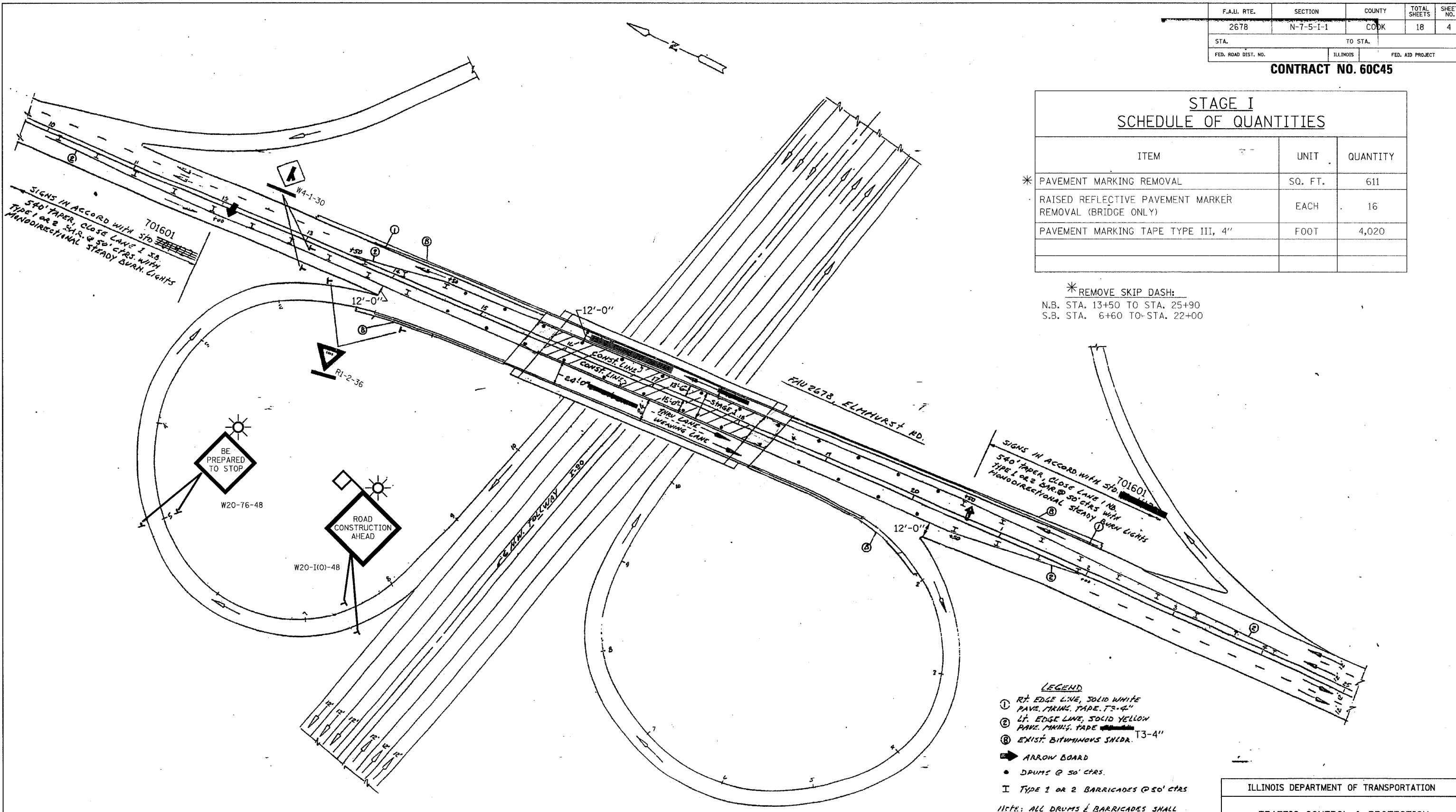

- LEGEND**
- ① RT. EDGE LINE, SOLID WHITE PAVE. MARK. TAPE T3-4"
  - ② LT. EDGE LINE, SOLID YELLOW PAVE. MARK. TAPE T3-4"
  - ③ EXIST. BITUMINOUS SHDR. T3-4"
  - ➡ ARROW BOARD
  - DRUMS @ 50' CTRS.
  - I TYPE 1 OR 2 BARRICADES @ 50' CTRS.

**NOTE:** ALL DRUMS & BARRICADES SHALL HAVE MONODIRECTIONAL STEADY BURN LIGHTS

REVISIONS	
NAME	DATE

ILLINOIS DEPARTMENT OF TRANSPORTATION

**TRAFFIC CONTROL & PROTECTION  
STAGE I**

F.A.U. RTE. 2678 / ELMHURST ROAD

SCALE: NONE  
DATE: JULY 25, 2007

DRAWN BY: F.M.  
CHECKED BY: B.N.S.

**CHRISTIAN-ROGE & ASSOC., INC.**  
CHICAGO ILLINOIS

F.A.U. RTE.	SECTION	COUNTY	TOTAL SHEETS	SHEET NO.
2678	N-7-5-I-1	COOK	18	5
STA.		TO STA.		
FED. ROAD DIST. NO.		ILLINOIS	FED. AID PROJECT	

**CONTRACT NO. 60C45**

**STAGE II & FINAL PAVEMENT MARKING SCHEDULE OF QUANTITIES**

ITEM	UNIT	QUANTITY
PAVEMENT MARKING REMOVAL	SQ. FT.	166
RAISED REFLECTIVE PAVEMENT MARKER REMOVAL (BRIDGE ONLY)	EACH	16
PAVEMENT MARKING TAPE TYPE III, 4"	FOOT	2,810
WORK ZONE PAVEMENT MARKING REMOVAL	SQ. FT.	2,254
EPOXY PAVEMENT MARKING, 4"		
4" SKIP DASHES	FOOT	860
4" WHITE	FOOT	1,275
4" YELLOW	FOOT	450
EPOXY PAVEMENT MARKING, 8"	FOOT	400
EPOXY PAVEMENT MARKING, 12"	FOOT	120

\* QUANTITIES FOR REMOVAL AND REPLACEMENT OF RAMP GORE PAVEMENT MARKING

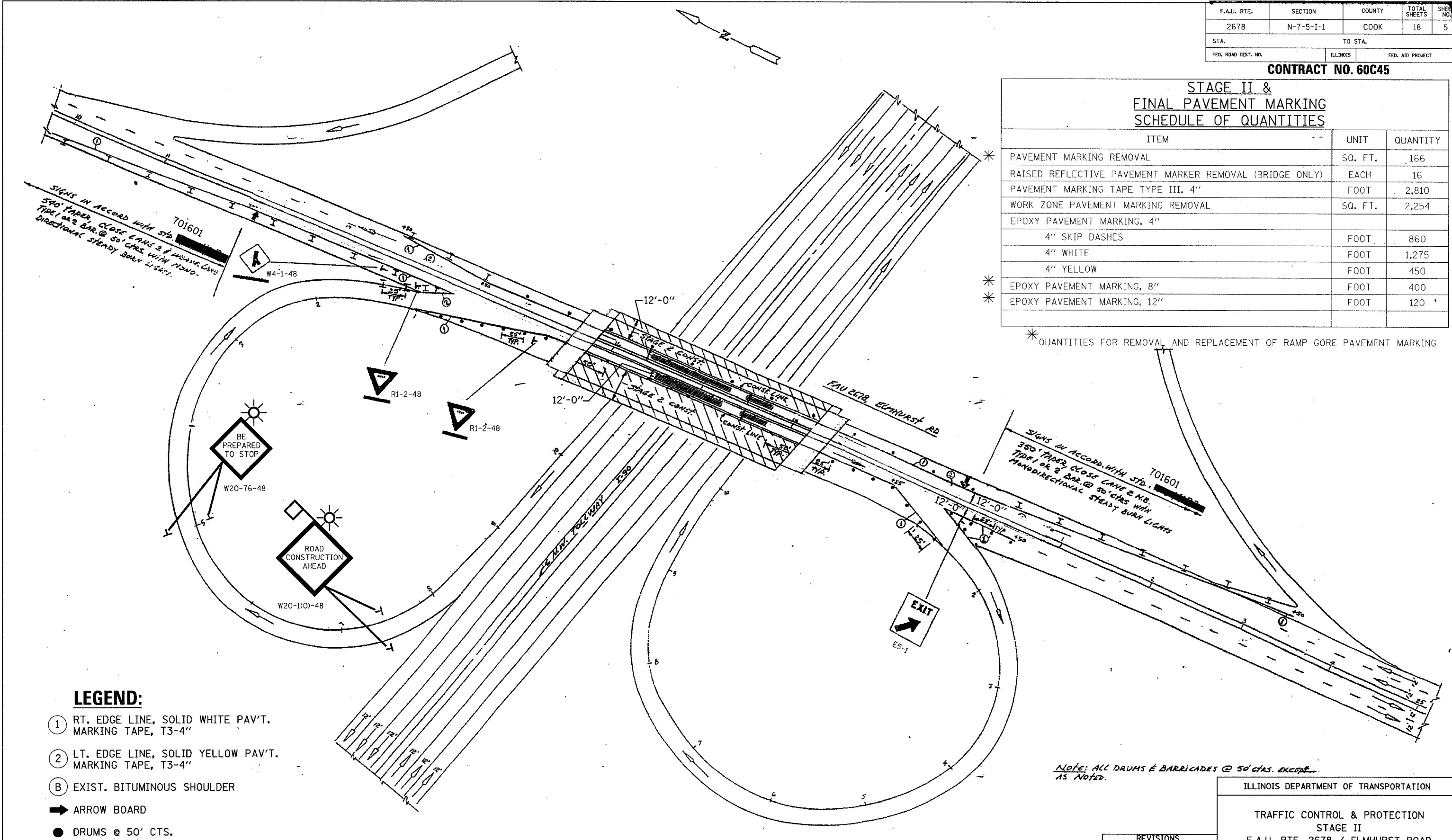

**LEGEND:**

- ① RT. EDGE LINE, SOLID WHITE PAV'T. MARKING TAPE, T3-4"
- ② LT. EDGE LINE, SOLID YELLOW PAV'T. MARKING TAPE, T3-4"
- (B) EXIST. BITUMINOUS SHOULDER
- ➔ ARROW BOARD
- DRUMS @ 50' CTS.
- I TYPE 1 OR TYPE 2 BARRICADES @ 50' CTS.

PLAN:

REVISIONS	
NAME	DATE

ILLINOIS DEPARTMENT OF TRANSPORTATION

TRAFFIC CONTROL & PROTECTION  
STAGE II  
F.A.U. RTE. 2678 / ELMHURST ROAD

SCALE: NONE  
DATE: JULY 25, 2007

DRAWN BY: F.M.  
CHECKED BY: B.N.S.

**CHRISTIAN-ROGE & ASSOC., INC.**  
CHICAGO ILLINOIS

VERIFY CORRECT STAGE II SHEET 9/26/2007 1:20:23 PM

F.A.U. RTE.	SECTION	COUNTY	TOTAL SHEETS	SHEET NO.
2678	N-7-5-I-1	COOK	18	6
STA.		TO STA.		
FED. ROAD DIST. NO.		ILLINOIS	FED. AID PROJECT	

CONTRACT NO. 60C45

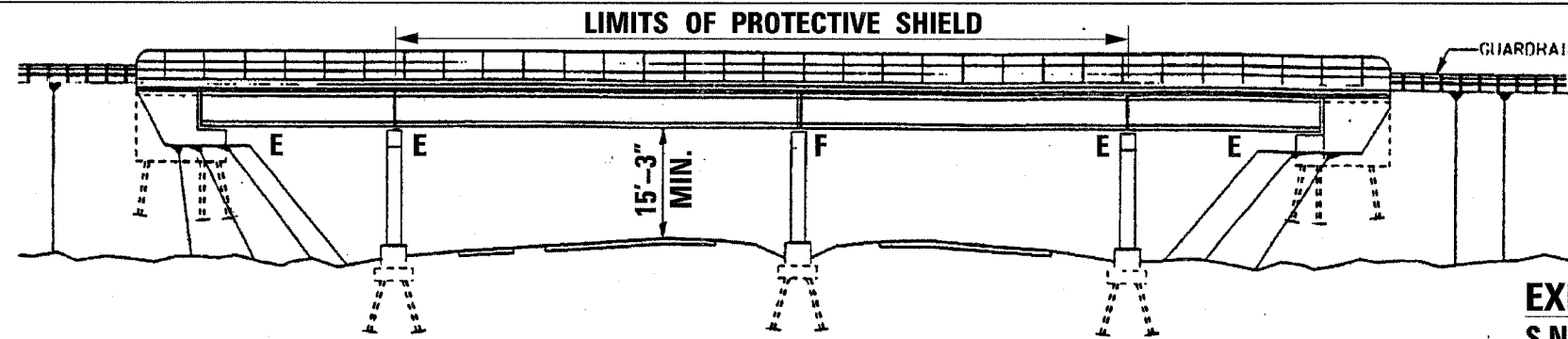

ELEVATION

**EXISTING STRUCTURE:**

S.N. 016-0678 BUILT AS F.A.P. 344 IN 1956. THE SUPERSTRUCTURE IS REINFORCED CONCRETE DECK WITH SPAN OF 255'-7 3/8" LONG. THE WIDTH OF THE BRIDGE INCLUDES 39'-0" SOUTHBOUND AND 27'-0" NORTHBOUND, TWO SIDEWALKS AT 6'-0" AND A MEDIAN OF 4'-0" SUPPORTED ON 4 SPAN PRECAST PRESTRESSED I-BEAMS.

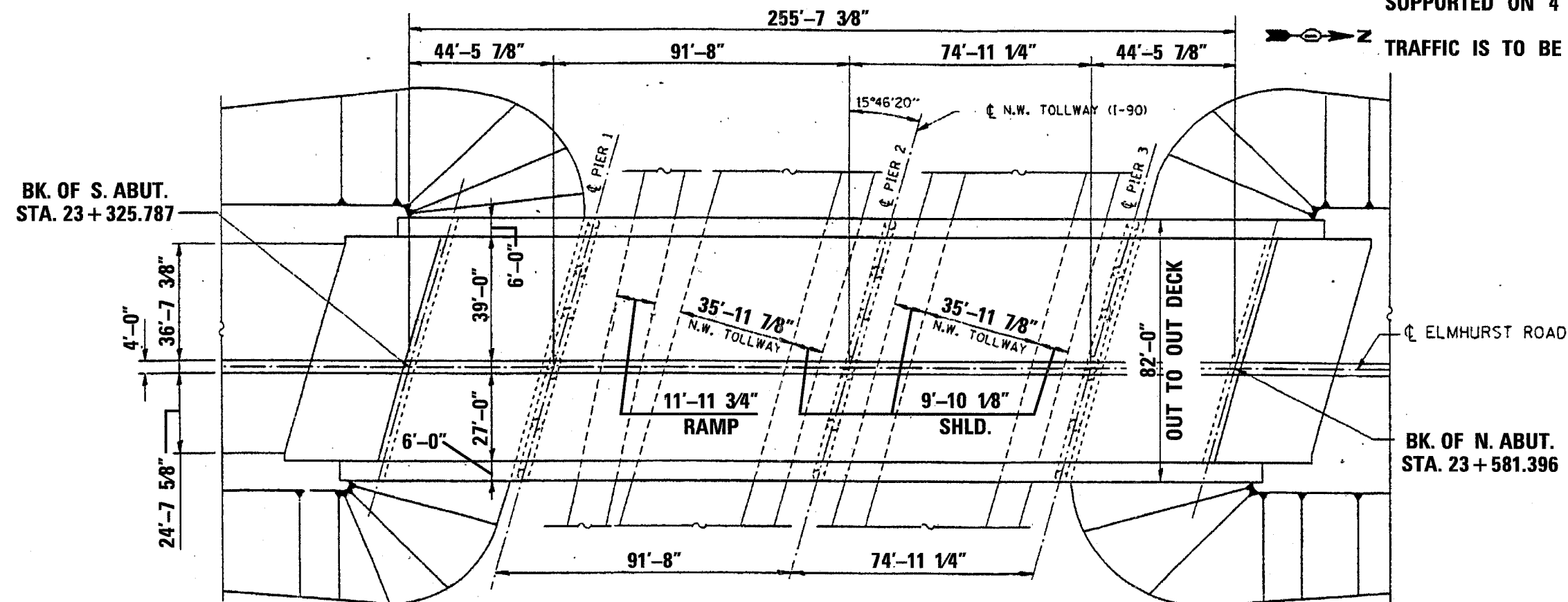

PLAN

BK. OF S. ABUT.  
STA. 23+325.787

BK. OF N. ABUT.  
STA. 23+581.396

**BILL OF MATERIAL**

ITEM	UNIT	QUANTITY
PROTECTIVE SHIELD	SQ. YD.	1,460

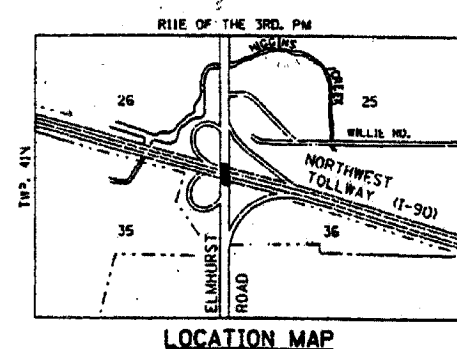

LOCATION MAP



REVISIONS	
NAME	DATE

ILLINOIS DEPARTMENT OF TRANSPORTATION

GENERAL PLAN & ELEVATION  
F.A.U. RTE. 2678/ELMHURST ROAD  
OVER  
NORTHWEST TOLLWAY (I-90)  
STRUCTURE NO. 016-0678

SCALE: NONE  
DATE: JULY 25, 2007

DRAWN BY: F.M.  
CHECKED BY: B.N.S.

CHRISTIAN-ROGE & ASSOC., INC.  
CHICAGO ILLINOIS

F.A.U. RTE.	SECTION	COUNTY	TOTAL SHEETS	SHEET NO.
2678	N-7-5-I-1	COOK	18	7
STA.		TO STA.		
FED. ROAD DIST. NO.		ILLINOIS	FED. AID PROJECT	

**CONTRACT NO. 60C45**

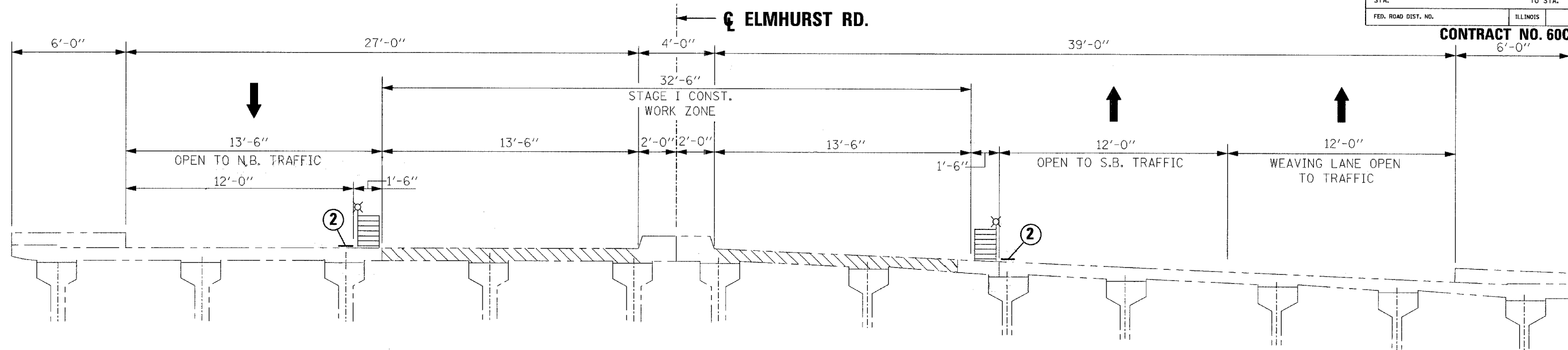

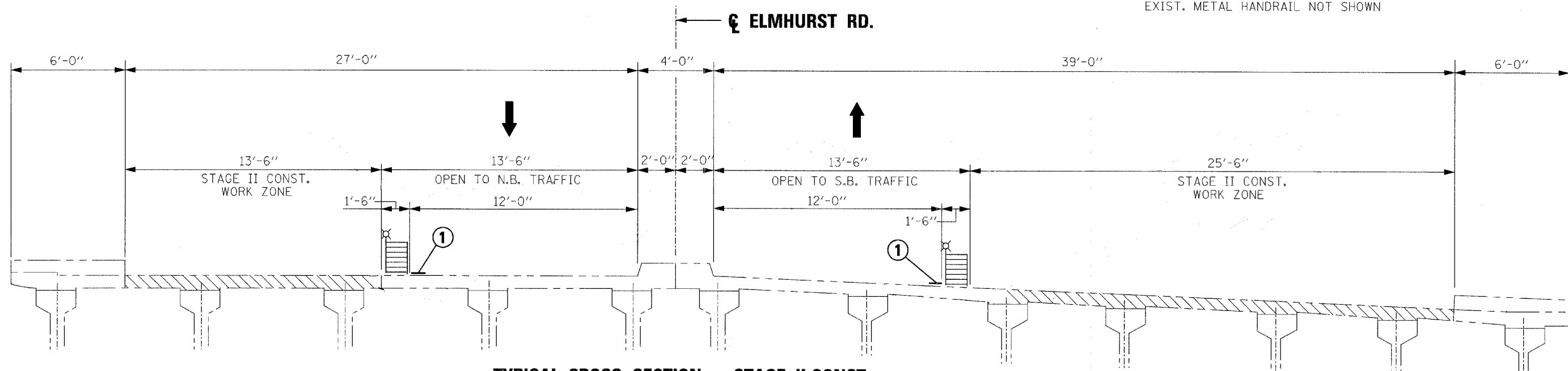

**TYPICAL CROSS SECTION - STAGE I CONST.  
(LOOKING SOUTH)**

NOTE:  
EXIST. METAL HANDRAIL NOT SHOWN



**TYPICAL CROSS SECTION - STAGE II CONST.  
(LOOKING SOUTH)**

**LEGEND:**

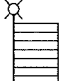
-  **WORK ZONE**
-  **RT. EDGE LINE-SOLID WHITE**
-  **LT. EDGE LINE-SOLID YELLOW**
-  **NON-METALLIC DRUMS WITH MONO-DIRECTIONAL STEADY BURNING LIGHTS @ 50 FT. CTS.**

REVISIONS	
NAME	DATE

ILLINOIS DEPARTMENT OF TRANSPORTATION

CONSTRUCTION STAGING  
TYPICAL SECTIONS  
F.A.U. RTE. 2678 / ELMHURST ROAD

SCALE: NONE  
DATE: JULY 25, 2007

DRAWN BY: F.M.  
CHECKED BY: B.N.S.

CHRISTIAN-ROGE & ASSOC., INC.  
CHICAGO ILLINOIS

F.A.U. RTE.	SECTION	COUNTY	TOTAL SHEETS	SHEET NO.
2678	N-7-5-1-1	COOK	18	8
STA.		TO STA.		
FED. ROAD DIST. NO.		ILLINOIS	FED. AID PROJECT	

**CONTRACT NO. 60C45**

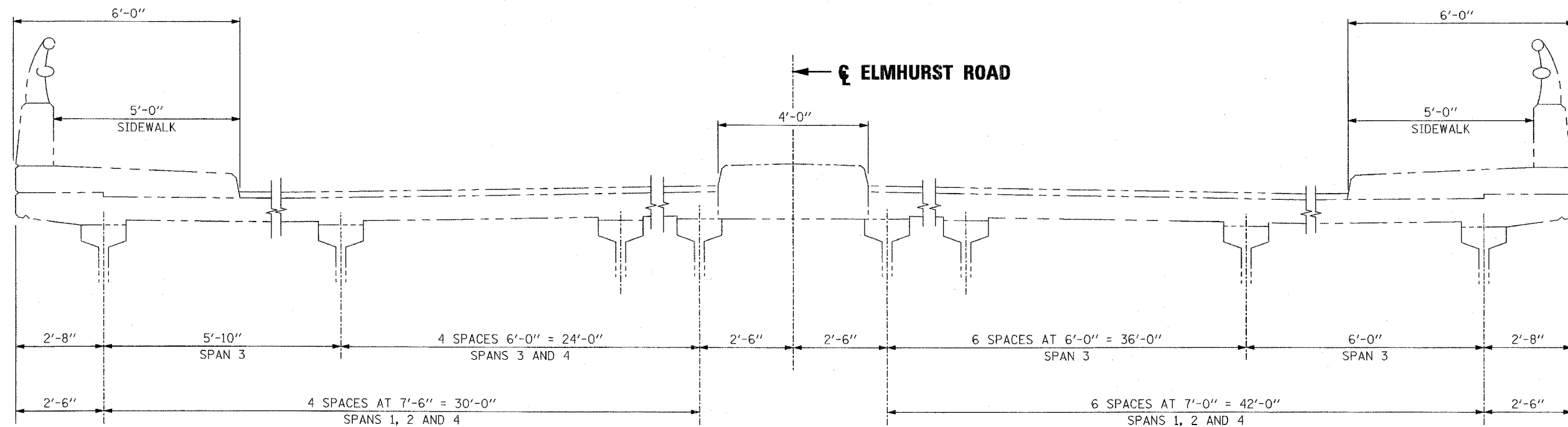

**EXISTING TYPICAL CROSS SECTION**

**FOR INFORMATION ONLY**

REVISIONS	
NAME	DATE

ILLINOIS DEPARTMENT OF TRANSPORTATION  
 DECK CROSS SECTION  
 F.A.U. RTE. 2678/ELMHURST ROAD  
 OVER  
 NORTHWEST TOLLWAY (I-90)  
 STRUCTURE NO. 016-0678

SCALE: NONE  
 DATE: JULY 25, 2007  
 DRAWN BY: F.M.  
 CHECKED BY: B.N.S.

**CHRISTIAN-ROGE & ASSOC., INC.**  
 CHICAGO ILLINOIS

7/25/2007 12:52:11 PM



F.A.U. RTE.	SECTION	COUNTY	TOTAL SHEETS	SHEET NO.
2678	N-7-5-I-1	COOK	18	9
STA.	TO STA.			
FED. ROAD DIST. NO.	ILLINOIS	FED. AID PROJECT		

**CONTRACT NO. 60C45**

PROPOSED HOT-MIX ASPHALT SURFACE REMOVAL (DECK)  
 PROPOSED BRIDGE DECK HYDRO SCARIFICATION 1/2"  
 PROPOSED BRIDGE DECK LATEX CONCRETE OVERLAY 2 1/2"

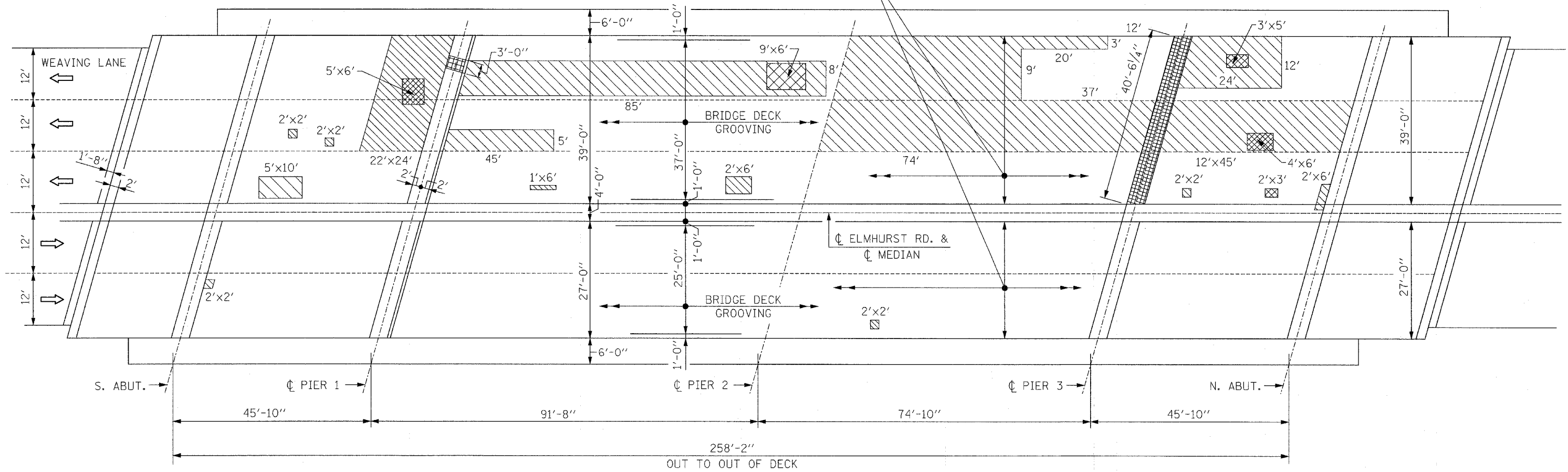
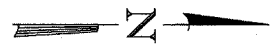

**PLAN**

**SCOPE OF WORK**

LEGEND	QUANTITY
* [Diagonal Hatching] PARTIAL DEPTH	416 SQ. YD.
[Cross-hatching] DECK SLAB REPAIR (FULL DEPTH, TYPE II)	11 SQ. YD.
[Grid Pattern] SILICONE SEAL JOINT REPAIR	44 L.F.
REMOVE EXISTING 2" HOT-MIX ASPHALT OVERLAY	1,893 SQ. YD.
BRIDGE DECK HYDRO SCARIFICATION 1/2"	1,893 SQ. YD.
TRAFFIC CONTROL AND PROTECTION	LUM SUM
BRIDGE LATEX CONCRETE OVERLAY 2 1/2"	1,893 SQ. YD.
BRIDGE DECK GROOVING	1,776 SQ. YD.

\* DECK SLAB PARTIAL DEPTH REPAIR PATCHES ARE SHOWN FOR INFORMATION ONLY

REVISIONS	
NAME	DATE

ILLINOIS DEPARTMENT OF TRANSPORTATION

DECK CONCRETE PATCHING  
 F.A.U. RTE. 2678/ELMHURST ROAD  
 OVER  
 NORTHWEST TOLLWAY (I-90)  
 STRUCTURE NO. 016-0678

SCALE: NONE  
 DATE: JULY 25, 2007

DRAWN BY: F.M.  
 CHECKED BY: B.N.S.

**CHRISTIAN-ROGE & ASSOC., INC.**  
 CHICAGO ILLINOIS

F.A.U. RTE.	SECTION	COUNTY	TOTAL SHEETS	SHEET NO.
2678	N-7-5-I-1	COOK	18	10
STA.		TO STA.		
FED. ROAD DIST. NO.	ILLINOIS	FED. AID PROJECT		

**CONTRACT NO. 60C45**

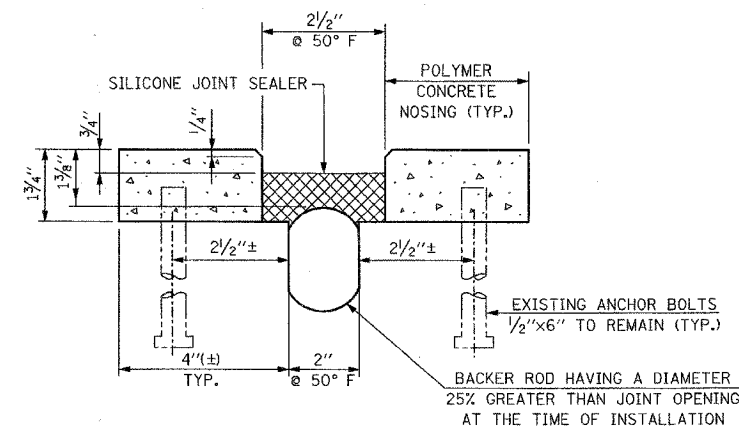

**NOTES:**

1. PLAN DIMENSIONS AND DETAILS RELATIVE TO EXISTING PLANS ARE SUBJECT TO ROUTINE VARIATIONS. THE CONTRACTOR SHALL FIELD VERIFY EXISTING DIMENSIONS AND DETAILS AFFECTING NEW CONSTRUCTION AND MAKE NECESSARY APPROVED ADJUSTMENTS PRIOR TO CONSTRUCTION OR ORDERING OF MATERIALS. SUCH VARIATIONS SHALL NOT BE CAUSE FOR ADDITIONAL COMPENSATION FOR A CHANGE IN SCOPE OF THE WORK, HOWEVER, THE CONTRACTOR WILL BE PAID FOR THE QUANTITY ACTUALLY FURNISHED BASED UPON THE UNIT PRICE BID FOR THE WORK.
2. COST FOR REMOVAL OF EXISTING JOINT IS INCLUDED IN THE COST OF SILICONE JOINT SEALER.

**SECTION AT PIER 1 = 40'-6 1/4"**

**SECTION AT PIER 3 = 3'-0"**

(EXISTING NEOPRENE TRANSVERSE EXPANSION JOINT)  
FOR LOCATION SEE DECK CONCRETE PATCHING ON SHEET NO. 4

**BILL OF MATERIAL**

DESCRIPTION	UNIT	QUANTITY
POLYMER CONCRETE	CU. FT.	4.0
SILICONE JOINT SEALER, 2 1/2"	FT.	44

REVISIONS	
NAME	DATE

ILLINOIS DEPARTMENT OF TRANSPORTATION

SILICONE SEAL JOINT REPAIR  
F.A.U. RTE. 2678/ELMHURST ROAD  
OVER  
NORTHWEST TOLLWAY (I-90)  
STRUCTURE NO. 016-0678

SCALE: NONE  
DATE: JULY 25, 2007

DRAWN BY: F.M.  
CHECKED BY: B.N.S.

**CHRISTIAN-ROGE & ASSOC., INC.**  
CHICAGO ILLINOIS

F.A.P. RYE	SECTION	COUNTY	TOTAL SHEETS	SHEET NO.
2678	N-7-5-1-1	COOK	18	11
STA.		TO STA.		
FED. ROAD DIST. NO.		ILLINOIS FED. AID PROJECT		

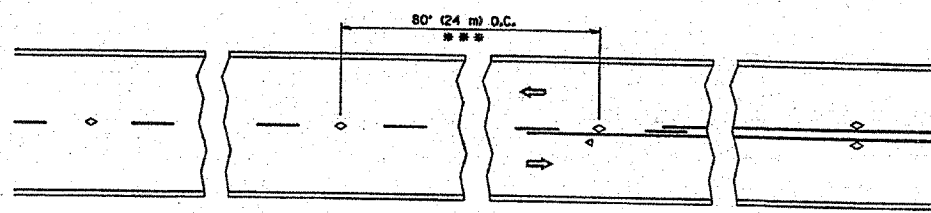

\*\*\* REDUCE TO 40' (12 m) O.C. ON CURVES WITH POSTED OR ADVISORY SPEED 45 M.P.H. (70 km/h) OR LESS.

TWO-LANE/TWO-WAY

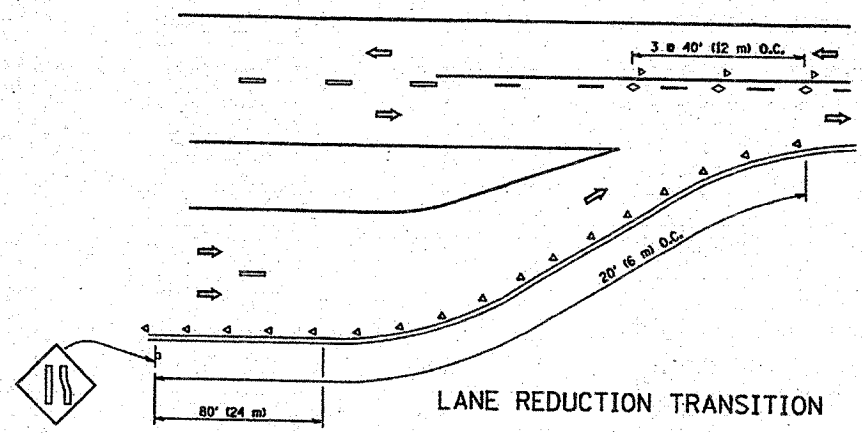

LANE REDUCTION TRANSITION

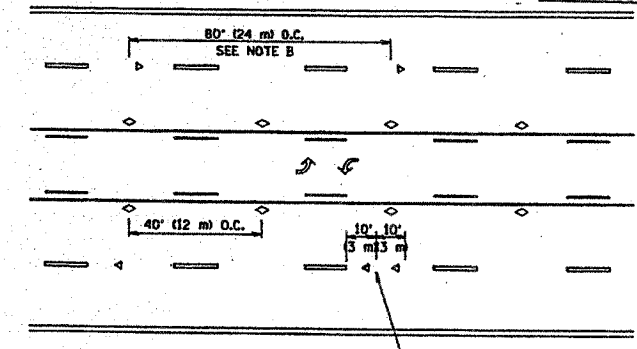

TWO-WAY LEFT TURN

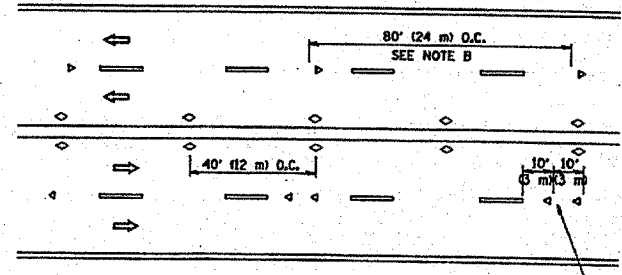

MULTI-LANE/UNDIVIDED

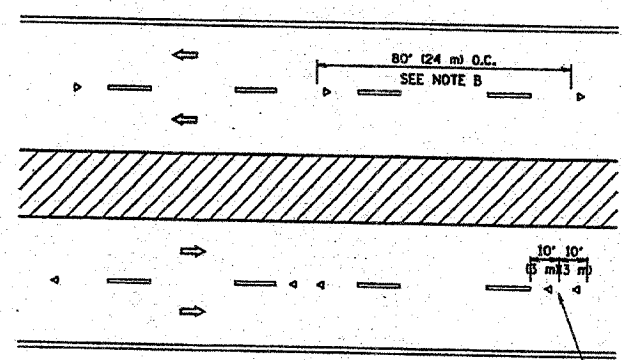

MULTI-LANE/DIVIDED

GENERAL NOTES

1. MARKERS USED WITH DASHED LINES SHALL BE CENTERED IN THE GAP BETWEEN SEGMENTS.
2. MARKERS USED ADJACENT TO SOLID LINES SHALL BE OFFSET 2 TO 3 (50 TO 75) TOWARD TRAFFIC AS SHOWN.
3. MARKERS THROUGH TANGENTS LESS THAN 500' (150 m) IN LENGTH BETWEEN CURVES SHALL BE INSTALLED AT THE LESSER OF THE TWO CURVE SPACINGS.

SYMBOLS

- YELLOW STRIPE
- WHITE STRIPE
- ◁ ONE-WAY AMBER MARKER
- ◁ ONE-WAY CRYSTAL MARKER (W/O)
- ◇ TWO-WAY AMBER MARKER

LANE MARKER NOTES

- A. USE DOUBLE LANE LINE MARKERS SPACED AS SHOWN.
- B. REDUCE TO 40' (12 m) O.C. ON CURVES WHERE ADVISORY SPEEDS ARE 10 M.P.H (20 km/h) LOWER THAN POSTED SPEEDS.

DESIGN NOTES

1. DOUBLE LANE LINE MARKERS SHALL BE USED UNLESS SPECIFIED OTHERWISE.
2. EXCEPT AS SHOWN ON THE LANE REDUCTION TRANSITION AND FREEWAY EXIT RAMP DETAIL, MARKERS ARE NOT TO BE SPECIFIED ON RIGHT EDGE LINES.
3. THE EXACT MARKER LIMITS, SPACING, AND COLOR SHOULD BE INCLUDED IN THE PLANS.
4. MARKERS SHOULD NOT BE USED ALONGSIDE CURBS EXCEPT FOR EXTREMELY SHORT SECTIONS OF CURBS WHERE NOT MORE THAN TWO MARKERS WOULD BE INVOLVED.

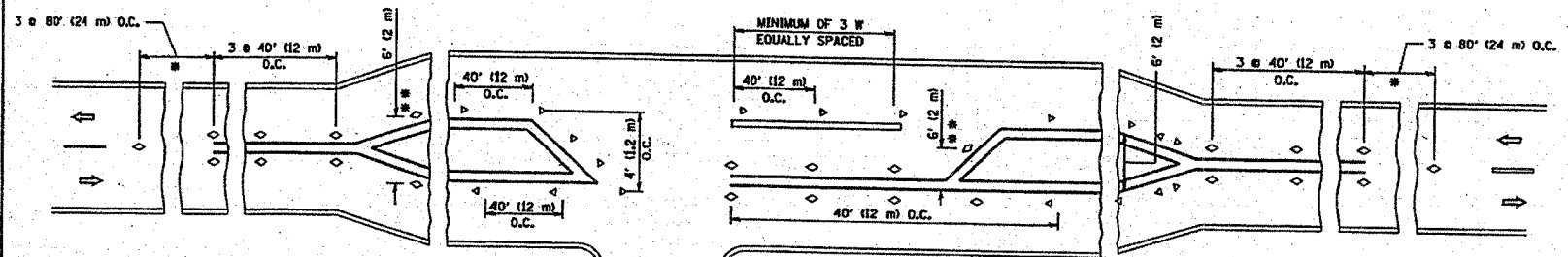

LEFT TURN

\* SEE TWO-LANE/TWO-WAY WHERE MARKERS CONTINUE  
 \*\* WHERE THE MEDIAN WIDTH IS 6' (2 m) OR LESS USE TWO-WAY MARKERS.

All dimensions are in millimeters (inches) unless otherwise shown.

PLOT DATE: 1/17/2007  
 FILE NAME: H:\projects\60c45\plan.dwg  
 PLOT SCALE: 1/8" = 1'-0"  
 USER NAME: J. Rammacher

REVISIONS	
NAME	DATE
T. RAMMACHER	09-19-94
T. RAMMACHER	03-12-99
T. RAMMACHER	01-06-00

ILLINOIS DEPARTMENT OF TRANSPORTATION  
 TYPICAL APPLICATIONS  
 RAISED REFLECTIVE PAVEMENT  
 MARKERS (SNOW-PLOW RESISTANT)

SCALE: NONE  
 DATE: 1/17/2007  
 DRAWN BY: CADD  
 CHECKED BY: TC-11  
 REVISION DATE: 01/06/00

F.P.	SECTION	COUNTY	TOTAL SHEETS	SHEET NO.
2678	N-7-5-1	COOK	18	12
STA.		TO STA.		
FED. ROAD DIST. NO.		ILLINOIS FED. AID PROJECT		

CONTRACT NO. 60C45

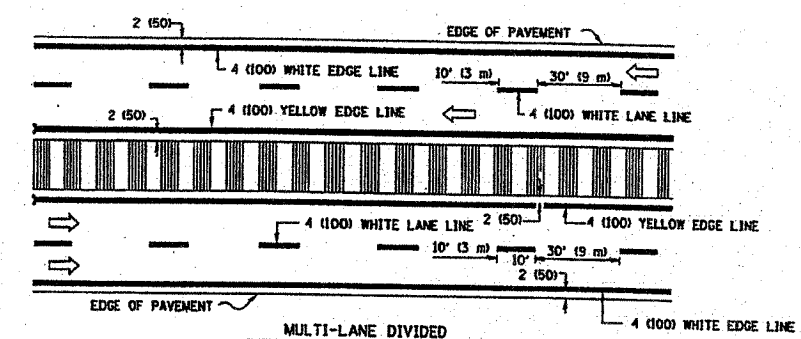
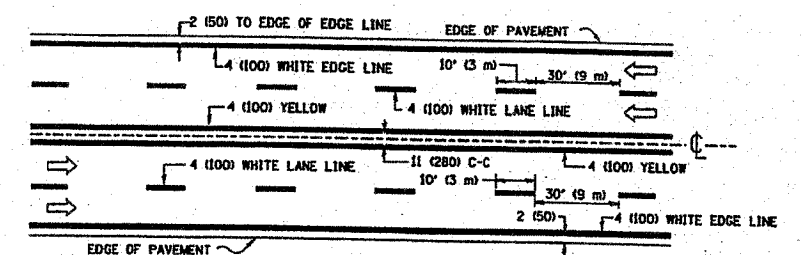
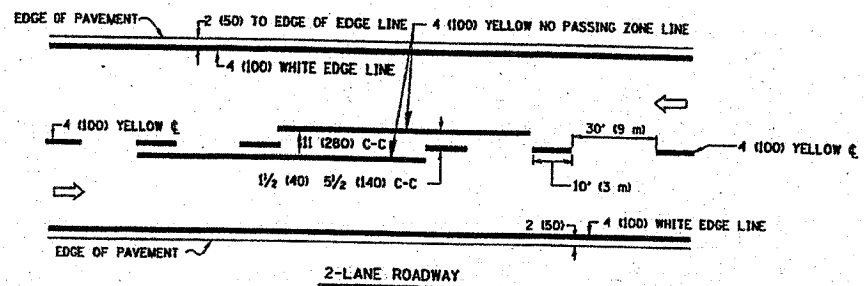

NOTE: MEDIANS WITH BARRIER CURB DO NOT REQUIRE AN EDGE LINE

TYPICAL LANE AND EDGE LINE MARKING

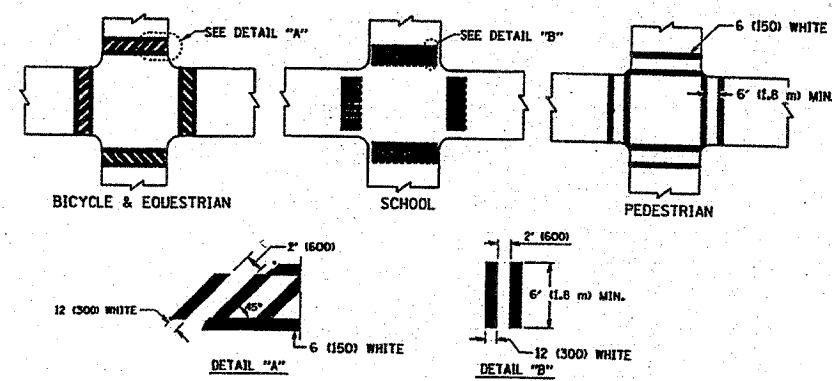

TYPICAL CROSSWALK MARKING

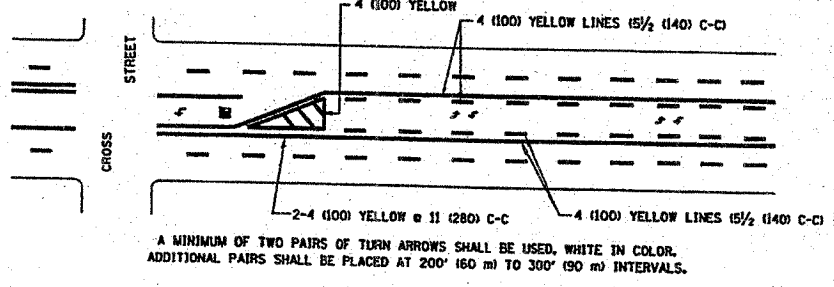
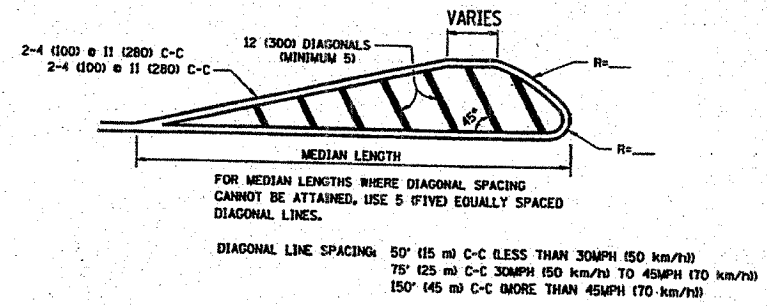
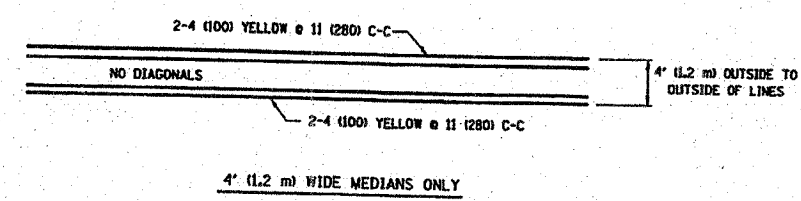

TYPICAL PAINTED MEDIAN MARKING

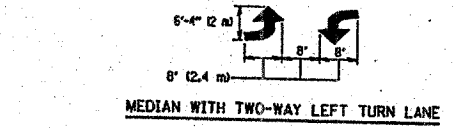

TYPICAL LEFT (OR RIGHT) TURN LANE

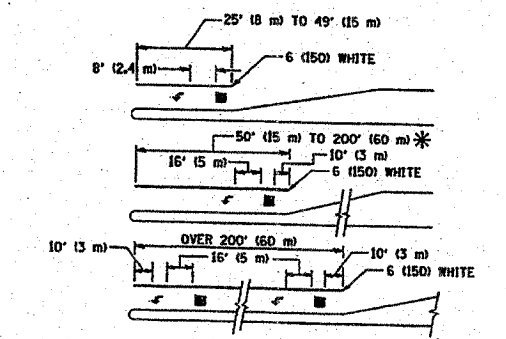

FULL SIZE LETTERS 8" (2.4 m) AND ARROWS SHALL BE USED.  
 \* TURN LANES IN EXCESS OF 400' (120 m) IN LENGTH MAY HAVE AN ADDITIONAL SET OF ARROW - "ONLY" INSTALLED MIDWAY BETWEEN THE OTHER TWO SETS OF ARROW - "ONLY".

TYPICAL TURN LANE MARKING

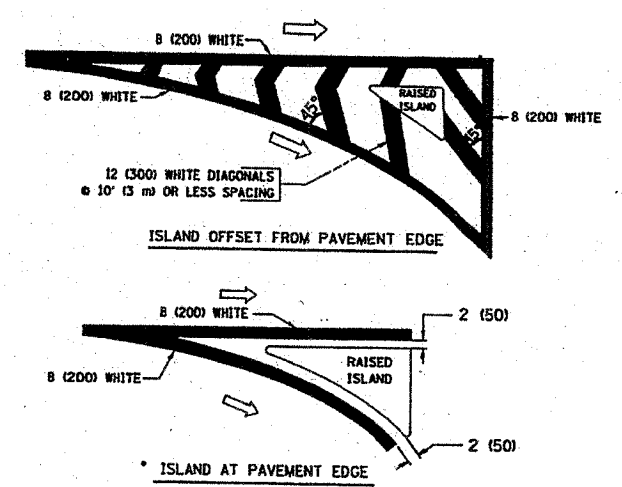

TYPICAL ISLAND MARKING

TYPE OF MARKING	WIDTH OF LINE	PATTERN	COLOR	SPACING / REMARKS
CENTERLINE ON 2 LANE PAVEMENT	4 (100)	SKIP-DASH	YELLOW	10' (3 m) LINE WITH 30' (9 m) SPACE
CENTERLINE ON MULTI-LANE UNDIVIDED PAVEMENT	2 @ 4 (100)	SOLID	YELLOW	11 (280) C-C
NO PASSING ZONE LINES FOR ONE DIRECTION FOR BOTH DIRECTIONS	4 (100) 2 @ 4 (100)	SOLID SOLID	YELLOW YELLOW	5/2 (140) C-C FROM SKIP-DASH CENTERLINE 11 (280) C-C OMIT SKIP-DASH CENTERLINE BETWEEN
LANE LINES	4 (100) 5 (125) ON FREEWAYS	SKIP-DASH SKIP-DASH	WHITE WHITE	10' (3 m) LINE WITH 30' (9 m) SPACE
DOTTED LINES (EXTENSIONS OF CENTER, LANE OR TURN LANE MARKINGS)	SAME AS LINE BEING EXTENDED	SKIP-DASH	SAME AS LINE BEING EXTENDED	2' (600) LINE WITH 6' (1.8 m) SPACE
EDGE LINES	4 (100)	SOLID	YELLOW-LEFT WHITE-RIGHT	OUTLINE MOUNTABLE MEDIANS IN YELLOW; EDGE LINES ARE NOT USED NEXT TO BARRIER CURB
TURN LANE MARKINGS	6 (150) LINE; FULL SIZE LETTERS & SYMBOLS (8" (2.4 m))	SOLID	WHITE	SEE TYPICAL TURN LANE MARKING DETAIL
TWO WAY LEFT TURN MARKING	2 @ 4 (100) EACH DIRECTION 8' (2.4 m) LEFT ARROW	SKIP-DASH AND SOLID IN PAIRS	YELLOW WHITE	10' (3 m) LINE WITH 30' (9 m) SPACE FOR SKIP-DASH; 5/2 (140) C-C BETWEEN SOLID LINE AND SKIP-DASH LINE SEE TYPICAL TWO-WAY LEFT TURN MARKING DETAIL
CROSSWALK LINES (PEDESTRIAN) A. DIAGONALS (BIKE & EQUESTRIAN) B. LONGITUDINAL BARS (SCHOOL)	2 @ 6 (150) 12 (300) @ 45° 12 (300) @ 90°	SOLID SOLID SOLID	WHITE WHITE WHITE	NOT LESS THAN 6' (1.8 m) APART 2' (600) APART 2' (600) APART SEE TYPICAL CROSSWALK MARKING DETAILS.
STOP LINES	24 (600)	SOLID	WHITE	PLACE 4' (1.2 m) IN ADVANCE OF AND PARALLEL TO CROSSWALK, IF PRESENT. OTHERWISE, PLACE AT DESIRED STOPPING POINT, PARALLEL TO CROSSROAD CENTERLINE, WHERE POSSIBLE
PAINTED MEDIANS	2 @ 4 (100) WITH 12 (300) DIAGONALS @ 45° NO DIAGONALS USED FOR 4' (1.2 m) WIDE MEDIANS	SOLID	YELLOW; TWO WAY TRAFFIC WHITE; ONE WAY TRAFFIC	11 (280) C-C FOR THE DOUBLE LINE SEE TYPICAL PAINTED MEDIAN MARKING.
GORE MARKING AND CHANNELIZING LINES	8 (200) WITH 12 (300) DIAGONALS @ 45°	SOLID	WHITE	DIAGONALS: 15' (4.5 m) C-C (LESS THAN 30MPH (50 km/h)) 20' (6 m) C-C (30MPH (50 km/h) TO 45MPH (70 km/h)) 30' (9 m) C-C (OVER 45MPH (70 km/h))
RAILROAD CROSSING	24 (600) TRANSVERSE LINES; "RR" 15 6" (1.8 m) LETTERS; 16 (400) LINE FOR "X"	SOLID	WHITE	SEE STATE STANDARD 780001 AREA OF: "R"=3.6 SQ. FT. (0.33 m²) EACH "X"=54.0 SQ. FT. (5.0 m²)
SHOULDER DIAGONALS	12 (300) @ 45°	SOLID	WHITE - RIGHT YELLOW - LEFT	50' (15 m) C-C (LESS THAN 30MPH (50 km/h)) 75' (25 m) C-C (30 MPH (50 km/h) TO 45MPH (70 km/h)) 150' (45 m) C-C (OVER 45MPH (70 km/h))

FOR FURTHER DETAILS ON PAVEMENT MARKING REFER TO STANDARD SPECIFICATIONS FOR ROAD AND BRIDGE CONSTRUCTION AND STATE STANDARD 780001.

All dimensions are in millimeters (inches) unless otherwise shown.

REVISIONS	
NAME	DATE
EVERS	03-19-90
T. RAMMACHER	10-27-94
ALEX HOUSEH	10-09-98
ALEX HOUSEH	10-17-98
T. RAMMACHER	01-06-00

ILLINOIS DEPARTMENT OF TRANSPORTATION  
 DISTRICT ONE  
 TYPICAL PAVEMENT MARKINGS

SCALE: NONE  
 DATE: 1/17/2007  
 DRAWN BY CADD  
 CHECKED BY  
 TC-13  
 REVISION DATE: 01/06/00

PLT DATE: 1/17/2007  
 FILE NAME: N0141001.dwg  
 PLOT SCALE: ENGLISH 1/16"  
 USER NAME: TAYLOR

CONTRACT NO. 60C45

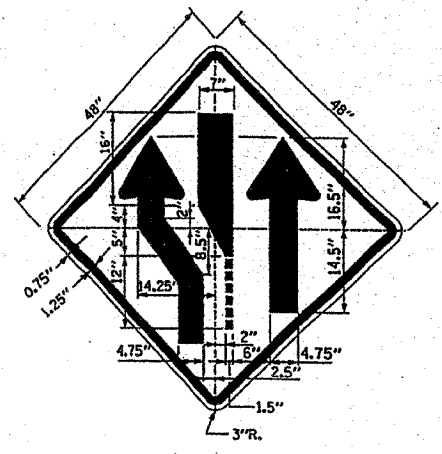

SIGN TS-1

COLOR: BACKGROUND - \*  
 BORDER AND SYMBOL - BLACK  
 SIZE: 48"x48"  
 MOUNTING HOLES: SAME AS SHOWN FOR SIGN W1-1  
 NOTE: SIGN TS-1L IS SHOWN; REVERSE SYMBOL FOR SIGN TS-1R

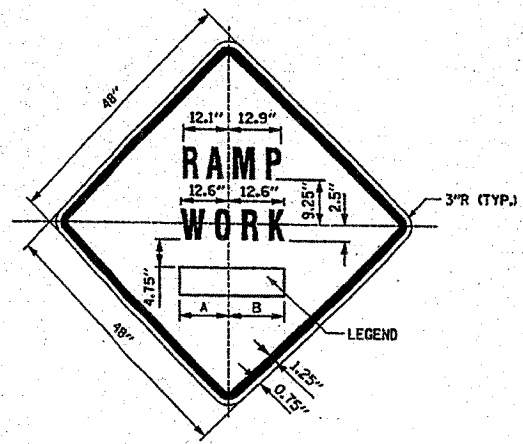

SIGN TS-2

COLOR: BACKGROUND - \*  
 BORDER AND SYMBOL - BLACK  
 SIZE: 48"x48"  
 LETTERING: 7" FEDERAL SERIES D  
 MOUNTING HOLES: SAME AS SHOWN FOR SIGN W1-1

SIGN NO.	LEGEND	A	B
TS-2A	AHEAD	15.50"	15.50"
TS-2B	500 FT	14.25"	15.13"
TS-2C	1000 FT	14.88" L2	15.75" L2
TS-2D	1500 FT	14.88" L2	15.75" L2
TS-2E	1/2 MILE	15.75" L3	15.75" L3
TS-2F	1 MILE	13.06"	13.06"

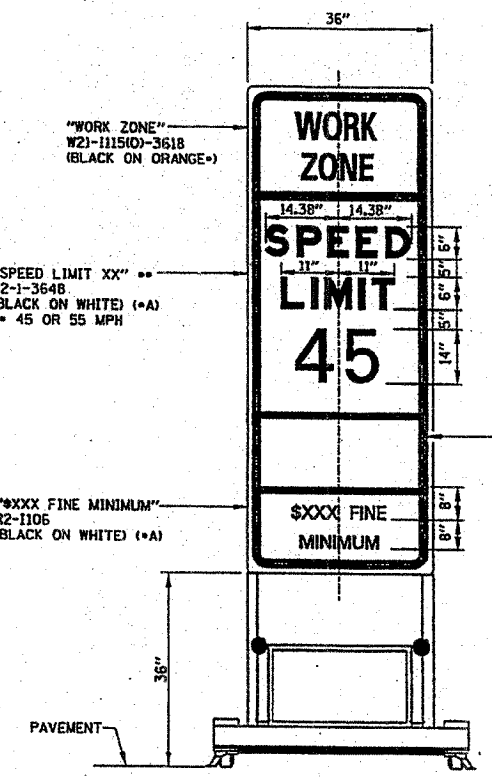

WORK ZONE SPEED LIMIT SIGN ASSEMBLY

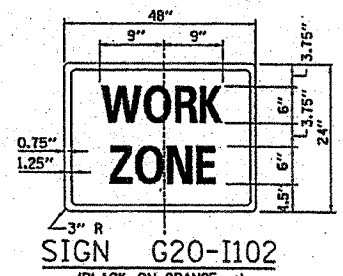

SIGN G20-I102  
 (BLACK ON ORANGE ->)  
 COLOR: BACKGROUND - ORANGE  
 BORDER AND LETTERS - BLACK  
 SIZE: 48"x24"  
 LETTERING: 6" FEDERAL SERIES C  
 MOUNTING HOLES: 7/8" DIA., 4 HOLES SPACED AS SHOWN ON SIGN G20-2A

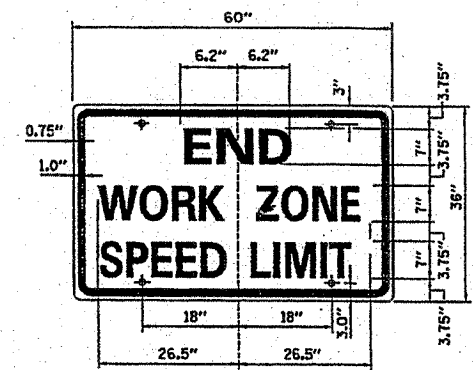

SIGN G20-I103  
 (BLACK ON ORANGE ->)  
 COLOR: BACKGROUND - ORANGE  
 BORDER AND LETTERS - BLACK  
 SIZE: 60"x36"  
 LETTERING: 6" FEDERAL SERIES C  
 MOUNTING HOLES: 7/8" DIA., 4 HOLES SPACED AS SHOWN

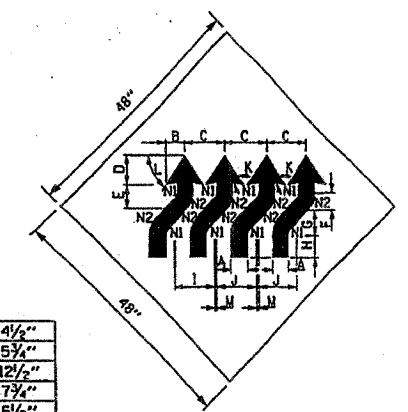

SIGN WI-4dR

COLOR: BACKGROUND FLUORESCENT ORANGE TYPE A REFLECTIVE SHEETING PER STANDARD SPECIFICATIONS  
 BORDER AND LETTERS - BLACK  
 SIZE: 48"x48"

A	4 1/2"
B	5 1/4"
C	12 1/2"
D	7 3/4"
E	6 1/2"
F	4 1/2"
G	6 1/2"
H	6"
J	12 1/2"
K	45"
L	55"
M	0 3/4"
N1	2"
N2	6 1/2"

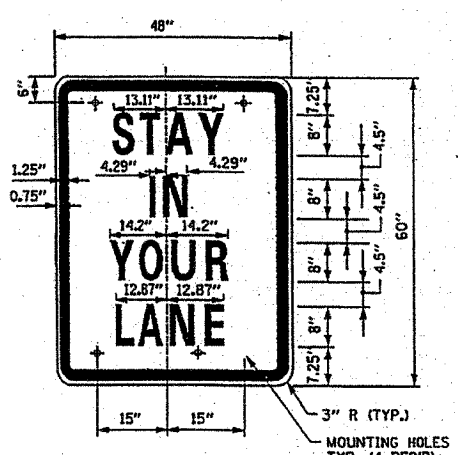

SIGN TS-3

COLOR: BACKGROUND - WHITE (REFLECTORIZED)(A)  
 BORDER AND LETTERS - BLACK  
 SIZE: 48"x60"  
 LETTERING: LEGEND - 8" FEDERAL SERIES D  
 MOUNTING HOLES: 7/8" DIA., 4 HOLES, SPACED AS SHOWN

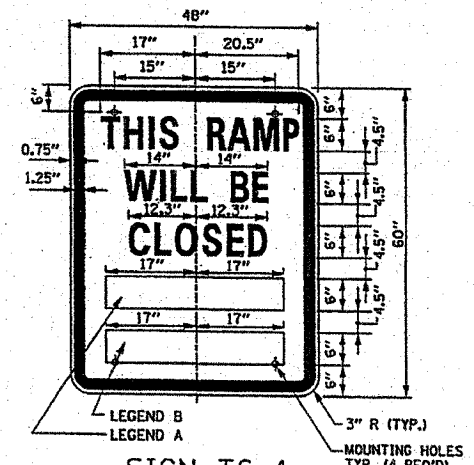

SIGN TS-4

COLOR: BACKGROUND - WHITE (REFLECTORIZED)(A)  
 BORDER AND LETTERS - BLACK  
 SIZE: 48"x60"  
 LETTERING: LEGEND - 6" FEDERAL SERIES C  
 MOUNTING HOLES: 7/8" DIA., 4 HOLES, SPACED AS SHOWN

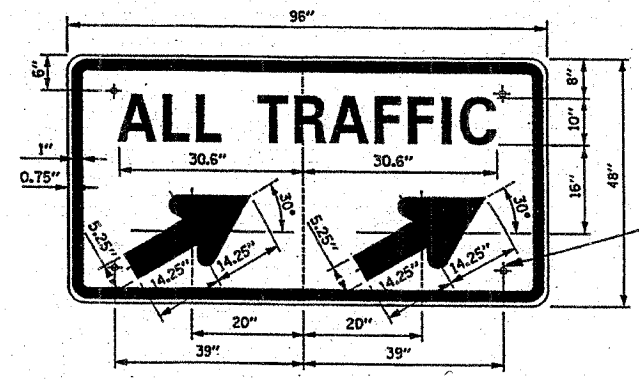

SIGN TS-5a & TS-5b

COLOR: BACKGROUND - WHITE (REFLECTORIZED)(A)  
 BORDER AND LETTERS - BLACK  
 ARROW - BLACK  
 SIZE: 96"x48"  
 LETTERING: 10" FEDERAL SERIES D  
 MOUNTING HOLES: 7/8" DIA., 4 HOLES, SPACED AS SHOWN  
 NOTE: SIGN TS-5a IS SHOWN, SUBSTITUTE LEGEND " " FOR " " FOR SIGN TS-5b

NOTES:

- ALL LETTERING IS DESIGNATED BY SIZE AND SERIES IN ACCORDANCE WITH THE LATEST EDITION OF "STANDARD ALPHABETS FOR HIGHWAY SIGNS AND PAVEMENT MARKINGS" AS PUBLISHED BY THE U.S. DEPARTMENT OF TRANSPORTATION. LETTERING SPACING SHALL BE IN ACCORDANCE WITH THIS GUIDE EXCEPT WHERE NOTED.
- SYMBOLS AND ARROWS SHALL CONFORM TO THE DETAILS SHOWN IN THE LATEST EDITION OF "STANDARD HIGHWAY SIGNS" AS PUBLISHED BY THE U.S. DEPARTMENT OF TRANSPORTATION.
- SEE THE CONTRACT REQUIREMENTS FOR ADDITIONAL NOTES AND SPECIFICATIONS. \* - FLUORESCENT ORANGE REFLECTIVE SHEETING PER THE STANDARD SPECIFICATIONS. (A) - REFLECTIVE SHEETING PER THE STANDARD SPECIFICATIONS.
- DIMENSIONS INDICATED THUS L ARE BASED ON A REDUCTION IN STANDARD LETTERING SPACING AS SHOWN BELOW:  
 L1 SPACING REDUCED BY 25%  
 L2 SPACING REDUCED BY 40%  
 L3 SPACING REDUCED BY 50%

RAMP CLOSURE ADVANCE INFORMATION SIGN

THE VARIABLE MESSAGE WITH DATES FOR THE BOTTOM TWO LINES SHALL BE DETERMINED BY THE ENGINEER AND GIVEN TO THE CONTRACTOR BEFORE THE REQUIRED FIELD ERECTION DATE.

APPROVED: *Jeff Haley* DATE 1-1-2007  
 CHIEF ENGINEER



DATE	REVISIONS

CONSTRUCTION SIGNS

STANDARD E1-00

F.A.U. RTE.	SECTION	COUNTY	TOTAL SHEETS	SHEET NO.
267B	N-7-5-1-1	COOK	18	14

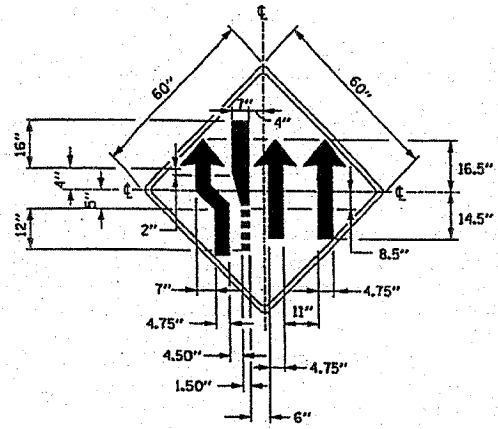

SIGN TS-1CL

COLOR: COLOR - BLACK (NON - REFLECTORIZED)  
 COLOR: BACKGROUND YELLOW (REFLECTORIZED) PERMANENT USAGE  
 \* FLUORESCENT ORANGE CONSTRUCTION USAGE

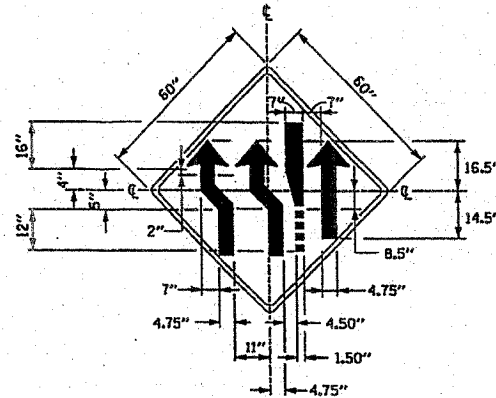

SIGN TS-1CR

COLOR: COLOR - BLACK (NON - REFLECTORIZED)  
 COLOR: BACKGROUND YELLOW (REFLECTORIZED) PERMANENT USAGE  
 \* FLUORESCENT ORANGE CONSTRUCTION USAGE

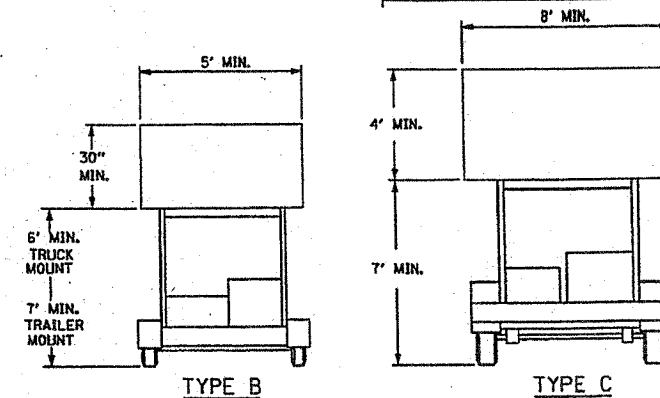

TYPE B TRUCK OR TRAILER MOUNTED  
 TYPE C TRAILER MOUNTED

ARROW BOARDS SHALL BE IN ACCORDANCE WITH THE STANDARD SPECIFICATIONS. TYPE C UNITS ARE TO BE USED FOR ALL OPERATIONS 24 HOURS OR MORE IN DURATION AND TYPE B UNITS MAY BE USED FOR OPERATIONS LESS THAN 24 HOURS IN DURATION. ARROW BOARDS SHALL NOT BE USED TO DIRECT PASSING MOVES INTO LANES USED BY OPPOSING TRAFFIC.

FLASHING ARROW BOARDS  
 SIGN TS-8

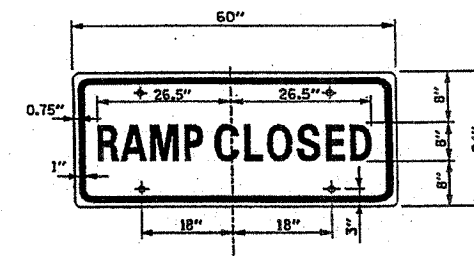

SIGN TS-6

COLOR: BACKGROUND - WHITE (REFLECTORIZED)  
 BORDER AND LETTERS - BLACK  
 SIZE: 60"x24"  
 LETTERING: 8" FEDERAL SERIES C  
 MOUNTING HOLES: 1/8" DIA., 4 HOLES SPACED AS SHOWN

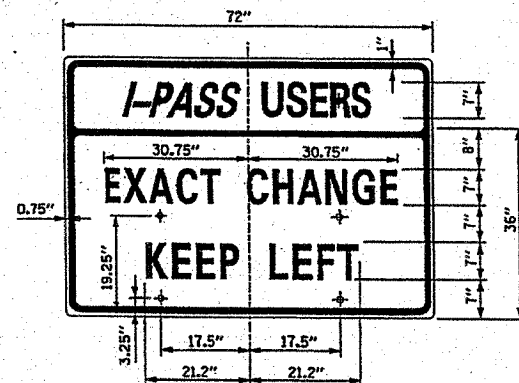

SIGN TS-7

COLOR: BACKGROUND - WHITE (REFLECTORIZED) (A)  
 BORDER AND LETTERS - BLACK  
 SIZE: 72"x36"  
 LETTERING: 7" FEDERAL SERIES C  
 MOUNTING HOLES: 1/8" DIA., 4 HOLES SPACED AS SHOWN

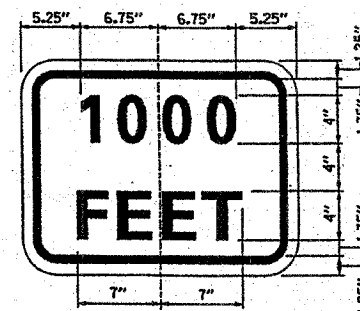

SUPPLEMENTAL PLATE

COLOR: BACKGROUND - FLUORESCENT ORANGE  
 BORDER AND LETTERS - BLACK  
 SIZE: 24"x18"  
 LETTERING: 4" FEDERAL SERIES D  
 MOUNTING HOLES: 1/8" DIA.

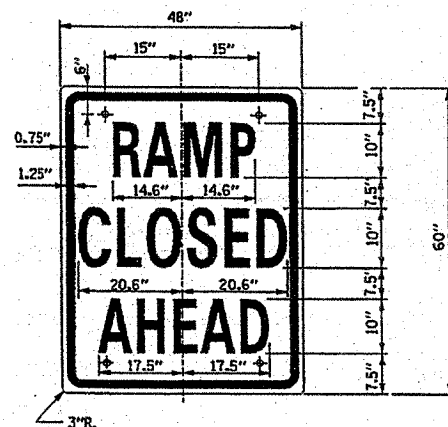

SIGN TS-9

COLOR: BACKGROUND - WHITE (REFLECTORIZED)  
 BORDER AND LETTERS - BLACK  
 SIZE: 48"x60"  
 LETTERING: 10" FEDERAL SERIES C  
 MOUNTING HOLES: 1/8" DIA., 4 HOLES SPACED AS SHOWN

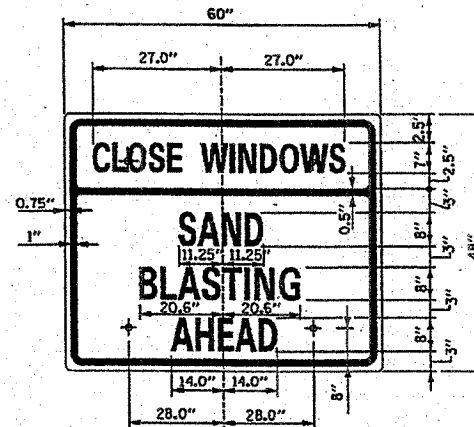

SIGN TS-10

COLOR: BACKGROUND - FLUORESCENT ORANGE  
 BORDER AND LETTERS - BLACK  
 SIZE: 60"x48"  
 LETTERING: 8" FEDERAL SERIES C, 7" FEDERAL SERIES B  
 MOUNTING HOLES: 1/8" DIA., 4 HOLES SPACED AS SHOWN

GENERAL NOTES:

- ALL LETTERING IS DESIGNATED BY SIZE AND SERIES IN ACCORDANCE WITH THE LATEST EDITION OF "STANDARD ALPHABETS FOR HIGHWAY SIGNS AND PAVEMENT MARKINGS" AS PUBLISHED BY THE U.S. DEPARTMENT OF TRANSPORTATION. LETTERING SPACING SHALL BE IN ACCORDANCE WITH THE GUIDE EXCEPT WHERE NOTED.
  - SYMBOLS AND ARROWS SHALL CONFORM TO THE DETAILS SHOWN IN THE LATEST EDITION OF "STANDARD HIGHWAY SIGNS" AS PUBLISHED BY THE U.S. DEPARTMENT OF TRANSPORTATION.
  - SEE THE CONTRACT REQUIREMENTS FOR ADDITIONAL NOTES AND SPECIFICATIONS.
  - FLUORESCENT ORANGE REFLECTIVE SHEETING PER THE STANDARD SPECIFICATIONS.
- (A) REFLECTIVE SHEETING PER THE STANDARD SPECIFICATIONS.



DATE	REVISIONS

CONSTRUCTION SIGNS

STANDARD E1-00

APPROVED: *Jeff Daly*  
 CHIEF ENGINEER  
 DATE 1-1-2007

F.A.J.L. RTE.	SECTION	COUNTY	TOTAL SHEETS	SHEET NO.
2678	N-7-5-1-1	COOK	18	15
STA.		TO STA.		
FED. ROAD DIST. NO.	ILLINOIS	FED. AID PROJECT		

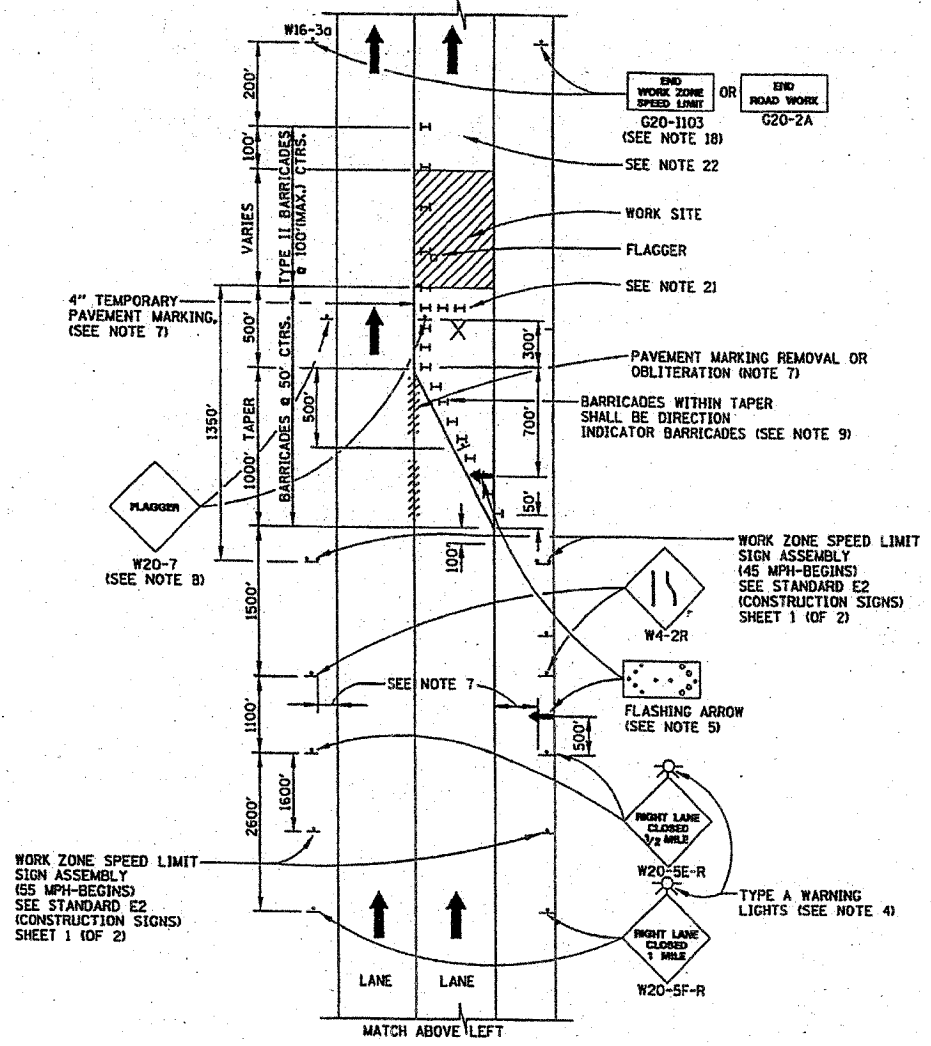
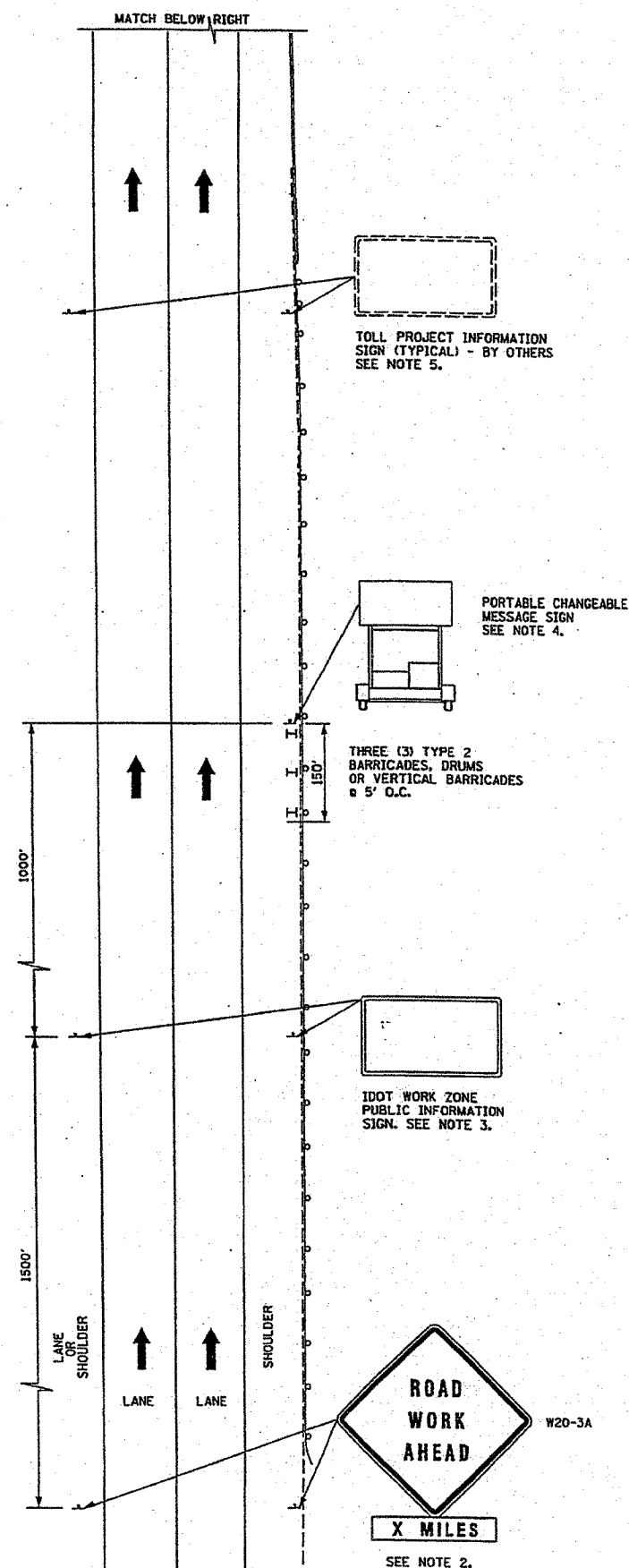

ONE-LANE CLOSURE

LANE CLOSURE NOTES:

- IF CLOSURES ARE EXPECTED TO PRODUCE TRAFFIC BACKUPS EXTENDING BEYOND THE FIRST WARNING SIGN SHOWN ON THE DETAILS, ADDITIONAL UPSTREAM SIGNS SHALL BE PLACED SO THAT THE TRAFFIC CONTROL ZONE ENCOMPASSES THE ANTICIPATED BACKUP ZONE.
- LONGITUDINAL DIMENSIONS MAY BE ADJUSTED SLIGHTLY TO FIT FIELD CONDITIONS.
- THESE DETAILS ALSO APPLY TO OPPOSITE HAND LANE CLOSURES BY CHANGING SIGN LEGENDS AND ARROW DIRECTIONS TO INDICATE THE APPROPRIATE CLOSURE.
- FOR NIGHT TIME CLOSURES, ONE TYPE A WARNING LIGHT SHALL BE INSTALLED ABOVE EACH OF THE 1 MILE AND 1/2 MILE ADVANCE WARNING SIGNS. FOR DAYLIGHT-ONLY CLOSURES, THE LIGHTS MAY BE OMITTED AND A MINIMUM OF 18" X 18" ORANGE WARNING FLAG AFFIXED TO THE FIRST SIGN ONLY.
- FOR ANY LANE CLOSURE, FLASHING ARROW BOARDS SHALL BE REQUIRED AND IN OPERATION AT ALL TIMES. THE FLASHING ARROW BOARD IN ADVANCE OF THE TAPER SHALL BE PROTECTED WITH THREE TYPE II BARRICADES AT 50' O.C.
- CONSTRUCTION SIGNS SHALL GENERALLY BE POST-MOUNTED OR ATTACHED TO PORTABLE SUPPORTS AND SHALL BE INSTALLED 8' TO 12' FROM ADJACENT TRAVEL LANE WHEREVER POSSIBLE. IN NO CASE SHALL SIGNS BE LOCATED TO PROVIDE LESS THAN 2' CLEARANCE BETWEEN EDGE OF SIGN AND ADJACENT TRAVEL LANE.
- PAVEMENT MARKING TAPE AND REMOVAL OR OBLITERATION OF EXISTING MARKINGS SHALL BE REQUIRED WHEN THE CLOSURE TIME EXCEEDS FOUR DAYS. THIS WORK SHALL BE MEASURED AND PAID FOR SEPARATELY.
- WHEN A FLAGGER IS NOT ON STATION, THE FLAGGER-AHEAD SIGN SHALL BE PROMPTLY REMOVED, COVERED OR TURNED TO FACE AWAY FROM TRAFFIC. SEE NOTE 12 REGARDING MOVING OPERATIONS.
- DIRECTION INDICATOR BARRICADES SHALL BE USED IN LANE TAPERS.
- FOR CLOSURES OTHER THAN SHORT TERM (SUNRISE TO ONE HOUR BEFORE SUNSET), THE MINIMUM HEIGHT OF THE SIGN FROM SHOULDER ELEVATION SHALL BE 7'-0".
- CONES MAY BE USED IN LIEU OF BARRICADES IN THE BUFFER AND WORK AREAS, WHEN THE CLOSURE IS FOR MAINTENANCE OPERATIONS.
- WHENEVER WORKERS ARE PRESENT, ONE WORK ZONE SPEED LIMIT SIGN ASSEMBLY WITH A 45 MPH POSTED SPEED SHALL BE PLACED ADJACENT TO THE OPEN LANE AT A DISTANCE OF 1000' MINIMUM TO 2,500' MAXIMUM IN ADVANCE OF WORKERS THROUGHOUT THE LANE CLOSURE. MOVING OPERATIONS WILL REQUIRE CONTINUOUS ADJUSTMENT OF THE SIGN ASSEMBLY LOCATION TO MAINTAIN THE ABOVE INTERVAL.
- AN ADDITIONAL SIGN ASSEMBLY SHALL BE PLACED 500' BEYOND THE LAST ENTRANCE RAMP FOR EACH INTERCHANGE THAT FALLS WITHIN THE 2,500'.
- THE SIGN ASSEMBLY SHALL BE PLACED NO CLOSER THAN 500' TO ANY OTHER SIGN.
- THE SIGN ASSEMBLY SHALL NOT BE UTILIZED WHEN WORKERS ARE BEHIND A TEMPORARY (MOVABLE BARRIER) WALL.
- THE SIGN ASSEMBLY SHALL BE PROMPTLY REMOVED OR COVERED WHEN WORKERS ARE NOT PRESENT.
- ALL CONFLICTING SPEED LIMIT SIGNS SHALL BE COVERED OR REMOVED.
- SIGNS WITH G20-2A, OR AND G20-1103 SHALL BE IN PLACE WHEN THE SIGN ASSEMBLY (WORK ZONE SPEED LIMIT SIGN) IS UP. THESE SIGNS SHALL ALSO BE REMOVED OR COVERED WHEN THE SIGN ASSEMBLY IS REMOVED OR COVERED, UNLESS STILL REQUIRED BY THE MAINTENANCE OF TRAFFIC PLAN.
- BARRICADES ARE TO BE LOCATED AT JOINT LINE WHEN WORK AREA EXTENDS UP TO JOINT UNLESS OTHERWISE SHOWN ON THE PLANS.
- SEE MAINTENANCE OF TRAFFIC DRAWINGS FOR ADDITIONAL SIGNING IN THIS AREA.
- PLACE CHECK BARRICADES IN ACCORDANCE WITH THE STANDARD SPECIFICATIONS.
- WHEN THE CLOSURE EXTENDS A MINIMUM 2000 FEET PAST THE LAST WORKER, AND THE WIDTH OF THE OPEN LANES HAVE NOT BEEN ALTERED, A WORK ZONE SPEED LIMIT SIGN ASSEMBLY (55-RESUMES) SHALL BE PLACED AT 1/2 MILE INTERVALS UNTIL THE END OF THE CLOSURE, OR THE NEXT WORK OPERATION.

ADVANCE SIGNAGE NOTES:

- THE ADVANCE SIGNAGE SHOWN ON THIS STANDARD SHALL APPLY ANY TIME THE CONTRACTOR CLOSES ONE OR MORE LANES, OR IS REQUIRED TO SHIFT THE LANE ALIGNMENT. THE 'ROAD WORK AHEAD' SIGNS, WORK ZONE PUBLIC INFORMATION SIGNS AND PORTABLE CHANGEABLE MESSAGE ARE STATIONARY.
- THE ROAD CONSTRUCTION AHEAD SIGN (W20-1A, WITH W16-3a SUPPLEMENTAL PLATE) SHALL BE LOCATED UP TO 5 MILES IN ADVANCE OF THE PROJECT LIMITS, WITH THE LOCATION BEING DETERMINED BY THE ENGINEER.
- THE WORK ZONE INFORMATION SIGN IS 60" WIDE BY 48" HIGH. THE CONTRACTOR SHALL OBTAIN THE CAMERA-READY ARTWORK REQUIRED FOR THE SIGN MESSAGE BY CONTACTING IDOT'S CENTRAL BUREAU OF OPERATIONS (217-782-2076).
- THE PORTABLE CHANGEABLE MESSAGE SIGN SHALL BE USED TO DISPLAY THE STATUS OF LANE WITHIN THE CONTRACT LIMITS. THE PRIMARY MESSAGES SHALL BE: "RIGHT LANE(S) CLOSED" / "X MILES AHEAD", "LEFT LANE(S) CLOSED" / "X MILES AHEAD", "LANE(S) SHIFT" / "X MILES AHEAD", "ALL LANES OPEN". THE PORTABLE CHANGEABLE MESSAGE SIGN MAY BE MOVED TO THE MEDIAN SHOULDER WHEN THE LANE CLOSURES ARE ON THE LEFT, PROVIDED THE EXISTING SHOULDER WIDTH IS ADEQUATE.
- THE TOLLWAY WILL FURNISH AND INSTALL STATIC PROJECT INFORMATION SIGNS IN ADVANCE, THROUGH AND AT THE END OF THE WORK ZONE. THESE SIGNS WILL BE INSTALLED ALONG THE OUTSIDE SHOULDER WITH THE ADVANCE SIGNS LOCATED BETWEEN THE PORTABLE CHANGEABLE MESSAGE SIGN AND THE "ROAD WORK - 1 MILE AHEAD" SIGN. THE ENGINEER AND CONTRACTOR SHALL COORDINATE WITH THE AUTHORITY REGARDING THE LOCATION OF THESE SIGNS AND NOTIFY THE AUTHORITY OF ANY DAMAGE TO THE SIGNS OR SUPPORTS.



DATE	REVISIONS

LANE CLOSURE DETAILS

STANDARD E2-00

APPROVED: *Jeff Dady*  
 CHIEF ENGINEER DATE 1-1-2007

F.A.J. RTE.	SECTION	COUNTY	TOTAL SHEETS	SHEET NO.
2678	N-7-5-1-1	COOK	18	16
STA.		TO STA.		
FED. ROAD DIST. NO.		ILLINOIS	FED. AID PROJECT	

**CONTRACT NO. 60C45**

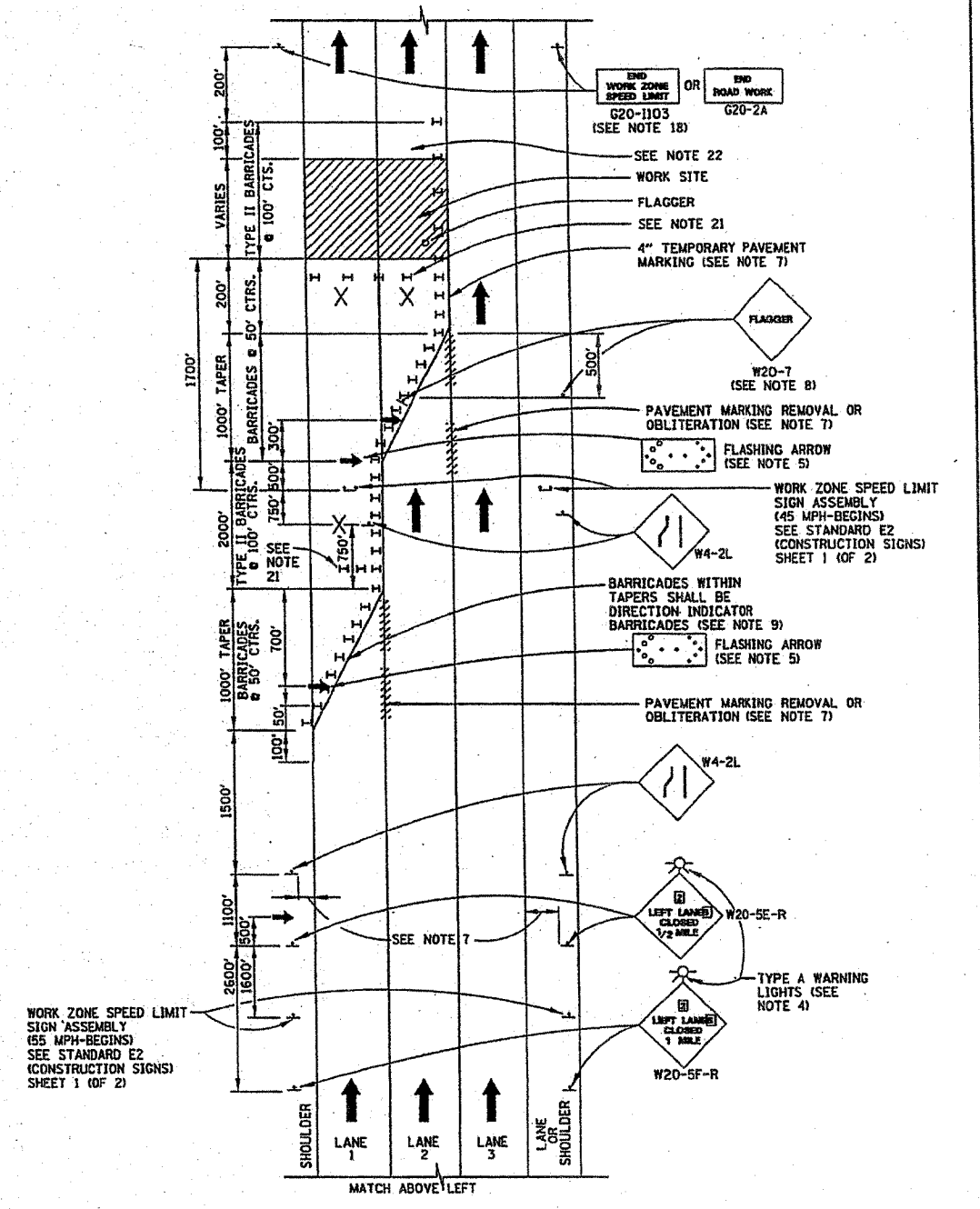
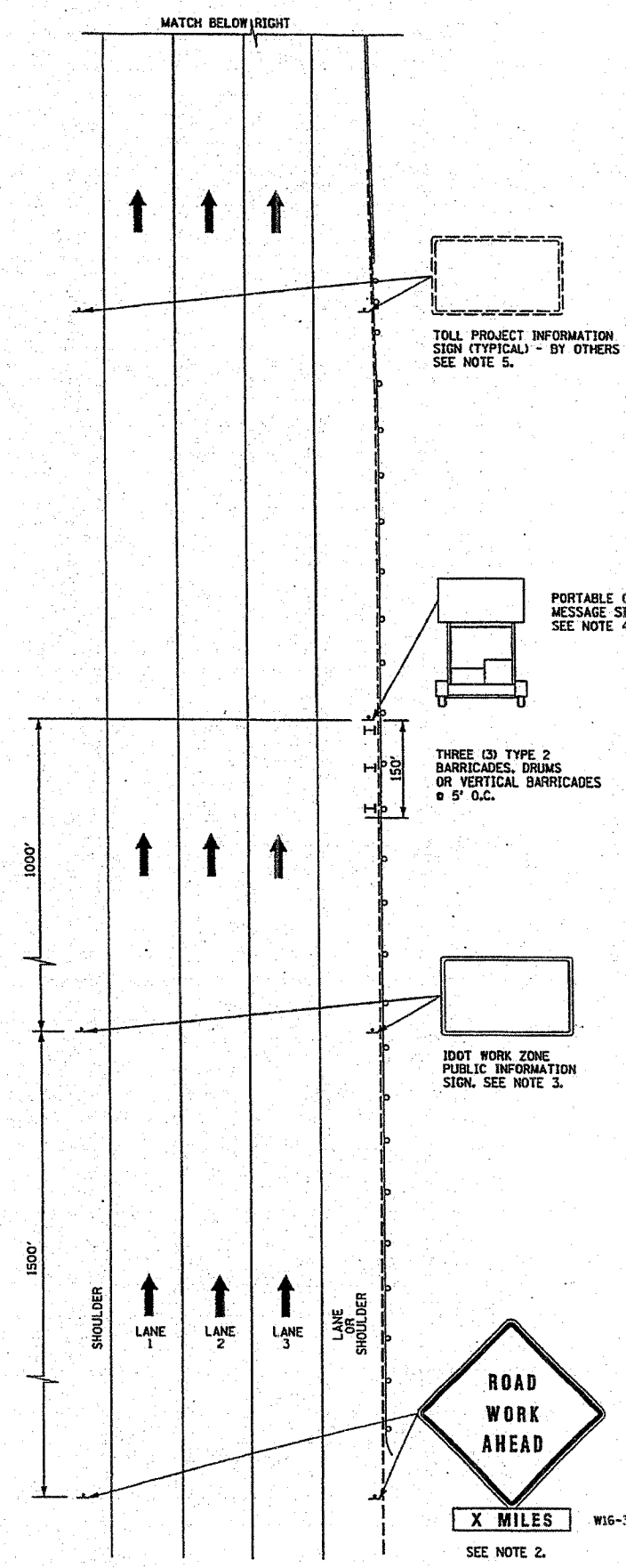

**TWO-LANE CLOSURE**



DATE	REVISIONS

LANE CLOSURE DETAILS

STANDARD E2-00

APPROVED *Jeff Balg* DATE 1-1-2007...  
Chief Engineer

SEE SHEET 1 (OF 3) IN THIS SERIES FOR GENERAL NOTES



F.A.I.L. RTE.	SECTION	COUNTY	TOTAL SHEETS	SHEET NO.
2678	N-7-5-1-1	COOK	18	17
STA.		TO STA.		
FED. ROAD DIST. NO.		ILLINOIS	FED. AID PROJECT	

**CONTRACT NO. 60C45**

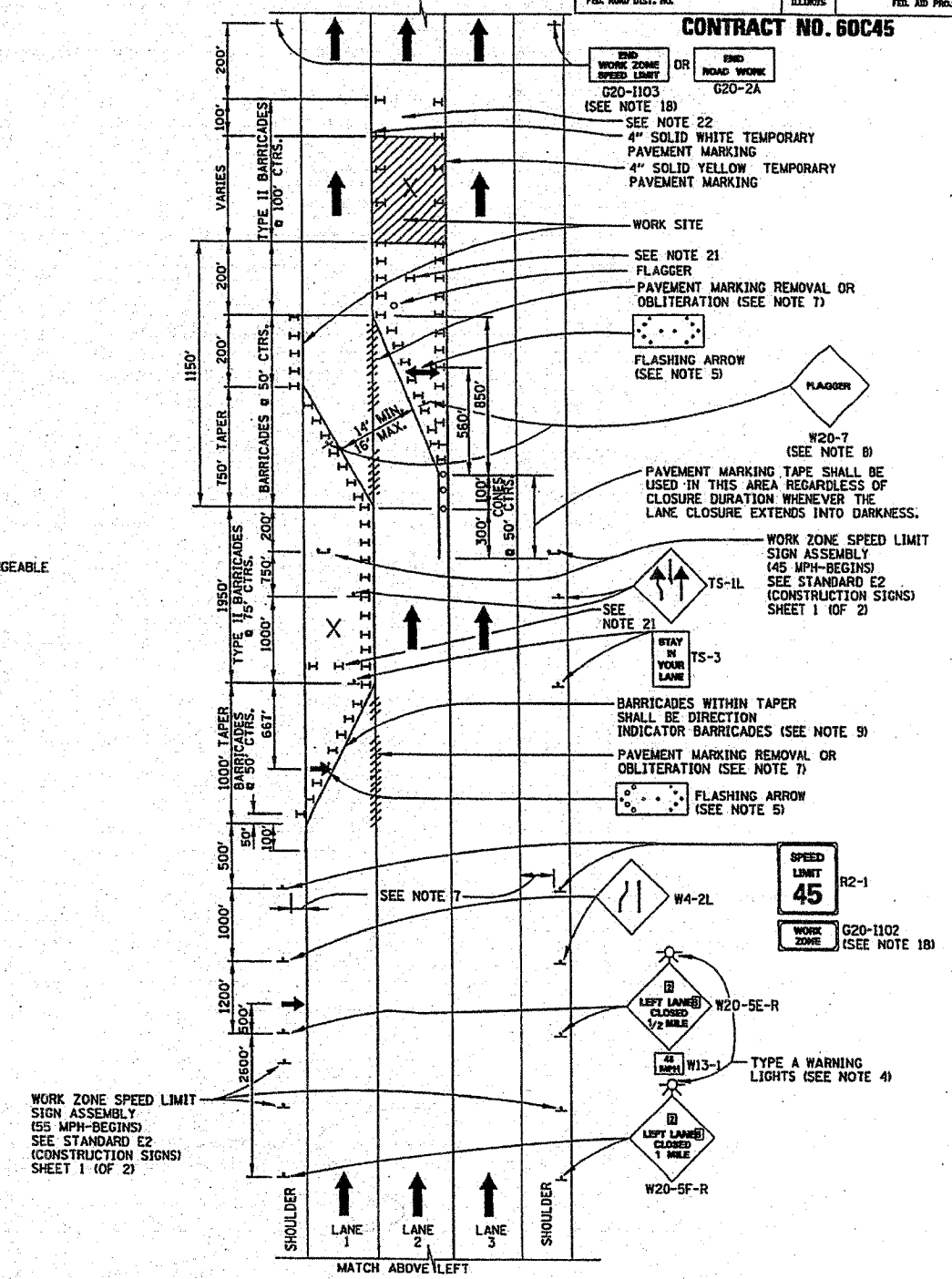
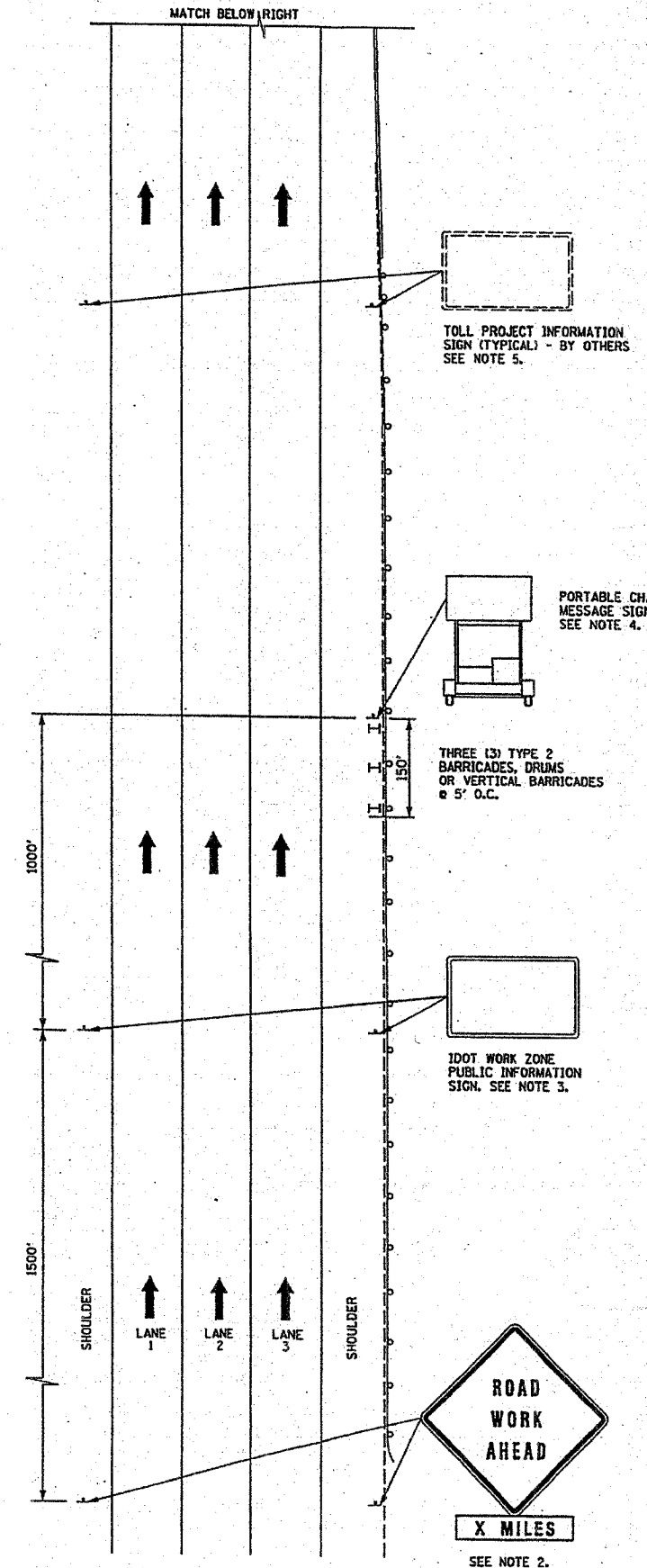

**CENTER-LANE CLOSURE**

SHEET 3 OF 3



LANE CLOSURE DETAILS

STANDARD E2-00

DATE	REVISIONS

SEE SHEET 1 (OF 3) IN THIS SERIES FOR GENERAL NOTES

APPROVED: *Jeff Staley*  
 CHIEF ENGINEER  
 DATE: 1-1-2007

F.A.U. RTE.	SECTION	COUNTY	TOTAL SHEETS	SHEET NO.
2678	N-7-5-1-1	COOK	18	18
STA.		TO STA.		
FED. ROAD DIST. NO.		ALIGNMENT	FED. AID PROJECT	

CONTRACT NO. 60C45

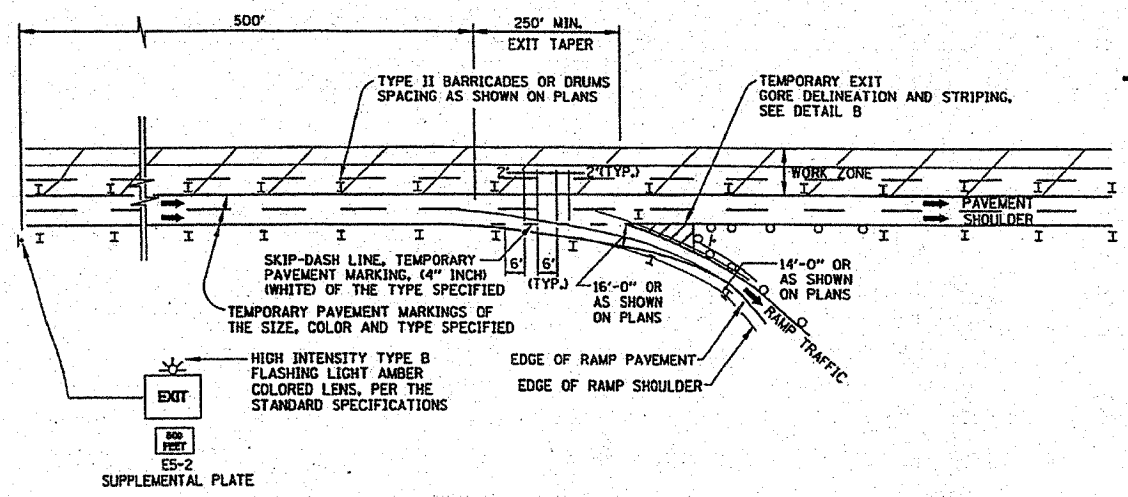

TYPICAL APPLICATION OF TEMPORARY EXIT GORE DELINEATION AND SIGNING

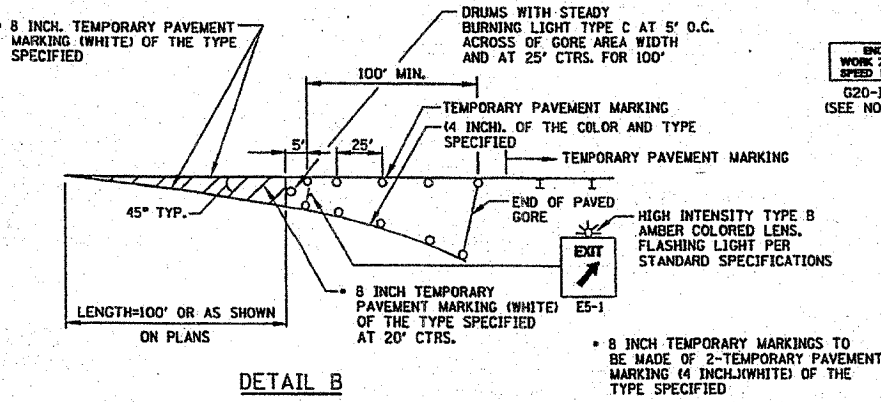

DETAIL B  
TEMPORARY EXIT GORE DELINEATION AND SIGNING

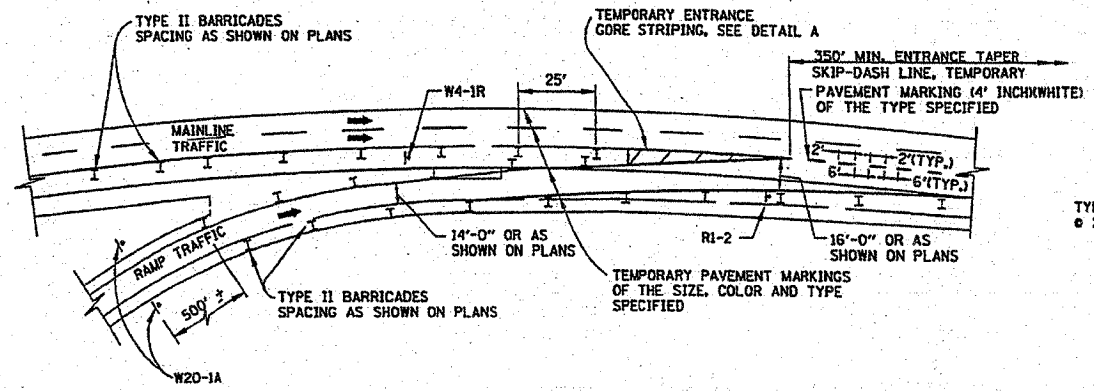

TYPICAL APPLICATION OF TEMPORARY ENTRANCE GORE DELINEATION AND SIGNING

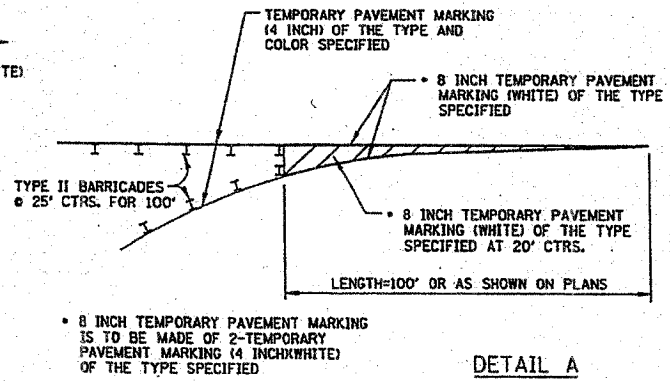

DETAIL A  
TEMPORARY ENTRANCE GORE STRIPING

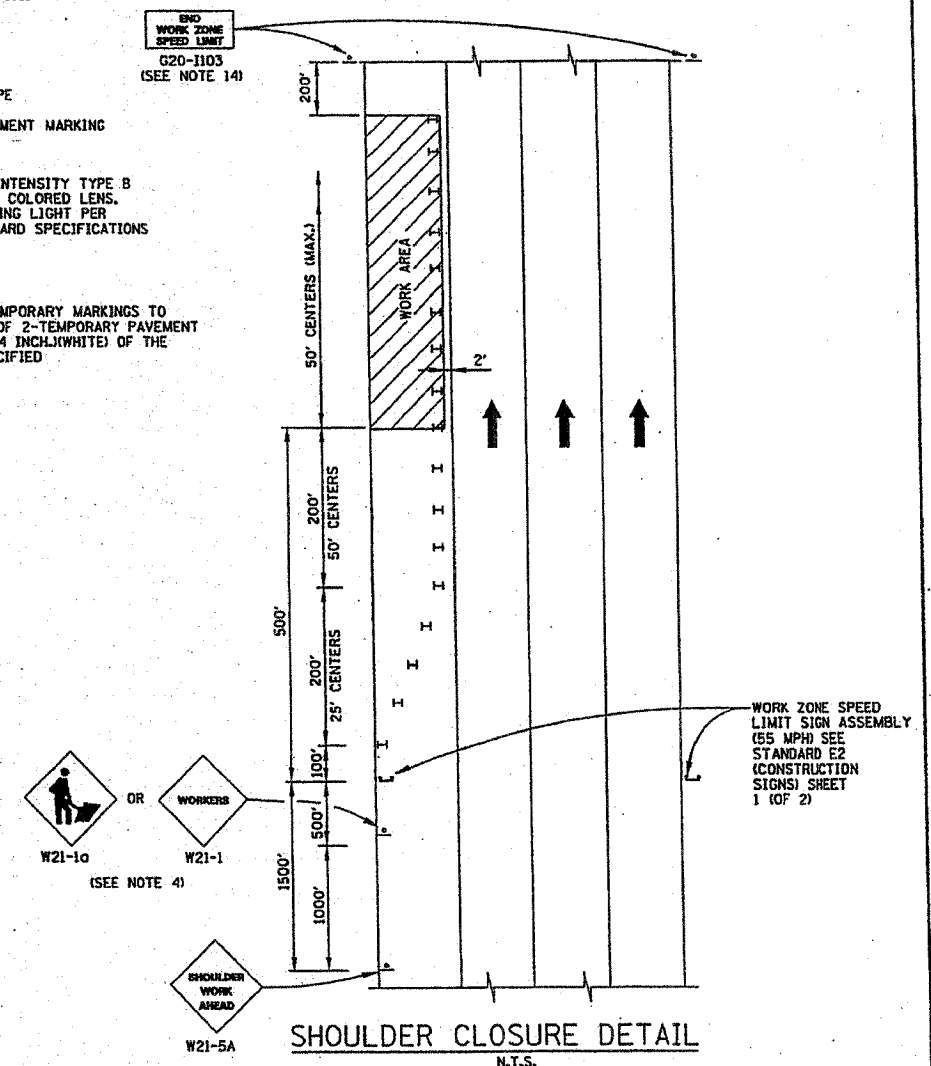

SHOULDER CLOSURE DETAIL  
N.T.S.

GENERAL NOTES:

1. THE SHOULDER SHALL BE CLOSED WHEN A WORK ACTIVITY REQUIRING 15 OR MORE MINUTES IS PERFORMED AT A DISTANCE WHICH IS LESS THAN 15 FEET BUT NO CLOSER THAN 2 FEET THE EDGE OF PAVEMENT.
2. THE ADJACENT EXTERIOR LANE SHALL BE CLOSED WHEN WORK IS PERFORMED WITHIN 2 FEET FROM THE EDGE OF PAVEMENT.
3. THE CHANNELIZING DEVICES WHICH SEPARATE THE WORK SPACE FROM THE ADJACENT TRAVEL LANE SHALL BE SPACED AT 25' FOR THE NINE DEVICES (200 FEET) AND AT A MAXIMUM OF 50' FOR ALL ADDITIONAL DEVICES.
4. WHEN THE WORKSITE IS UNATTENDED, SUBSTITUTE - "SHOULDER WORK AHEAD" SIGN FOR THE SECOND SIGN.
5. WORKER SIGNS OR SHOULDER WORK SIGNS AND CHANNELIZATION DEVICES ARE PLACED ONLY ON THE SIDE OF THE ROADWAY ON WHICH THE ACTIVITY IS PERFORMED.
6. FOR SHOULDER CLOSURE EXTENDING OVERNIGHT, BARRICADE TYPE II WITH STEADY BURNING LIGHT, TYPE C SHALL BE USED.
7. FOR SHORT TERM CLOSURE (SUNRISE TO ONE HOUR BEFORE SUNSET) NOT EXTENDING INTO DARKNESS, CONES MAY BE USED.
8. ONE WORK ZONE SPEED LIMIT SIGN ASSEMBLY (55 MPH - BEGINS) SHALL BE PLACED AT A DISTANCE OF 500' TO 2,500' MAXIMUM IN ADVANCE OF WORKERS THROUGHOUT THE SHOULDER CLOSURE. MOVING OPERATIONS MAY REQUIRE CONTINUOUS ADJUSTMENT OF THE SIGN ASSEMBLY LOCATION TO MAINTAIN THE ABOVE INTERVAL.
9. AN ADDITIONAL SIGN ASSEMBLY SHALL BE PLACED 500' BEYOND THE LAST ENTRANCE RAMP FOR EACH INTERCHANGE THAT FALLS WITHIN THE 2,500'.
10. THE SIGN ASSEMBLY SHALL BE PLACED NO CLOSER THAN 500' TO ANY OTHER SIGN.
11. THE SIGN ASSEMBLY SHALL NOT BE UTILIZED WHEN WORKERS ARE BEHIND A TEMPORARY (MOVABLE BARRIER) WALL.
12. THE WORK ZONE SPEED LIMIT SIGNS AND SIGN ASSEMBLY SHALL BE PROMPTLY REMOVED OR COVERED WHEN WORKERS ARE NOT PRESENT OR CLOSE TO MOVING TRAFFIC.
13. ALL CONFLICTING SPEED LIMIT SIGNS SHALL BE COVERED OR REMOVED.
14. "END WORK ZONE SPEED LIMIT" SIGNS SHALL BE IN PLACE ONLY WHEN THE EXISTING POSTED SPEED > 55MPH.
15. FOR SHOULDER REPAIRS OR REPLACEMENT THE CHANNELIZING DEVICES SHALL BE PLACED AT THE EDGE OF PAVEMENT WHENEVER THE WORK ACTIVITIES RESULT IN A DROPOFF AT THE EDGE OF PAVEMENT.

APPROVED: *Jeff Haly* DATE 1-1-2007  
CHIEF ENGINEER



DATE	REVISIONS

TEMPORARY GORE DETAILS AND SHOULDER CLOSURE DETAILS  
STANDARD E3-00