

F.A.P. RTE.	SECTION	COUNTY	TOTAL SHEETS	SHEET NO.
374	G-B-1-1	COOK	15	12
STA.		TO STA.		
FED. ROAD DIST. NO.	ILLINOIS	FED. AID PROJECT		

CONTRACT NO. 60D59

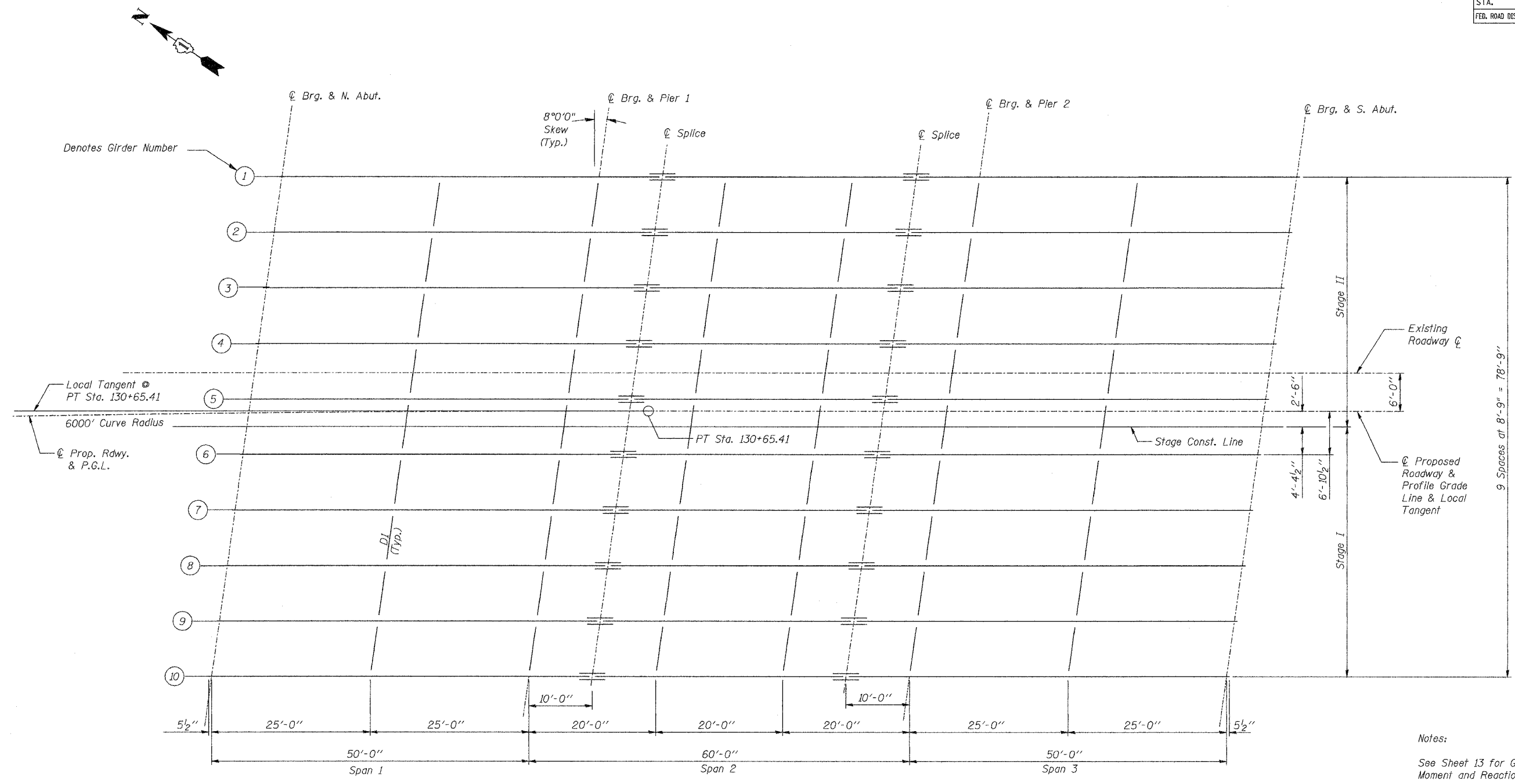

FRAMING PLAN

Notes:
 See Sheet 13 for Girder Moment and Reaction Tables.
 See Sheet 14 for Diaphragm and Splice Details.

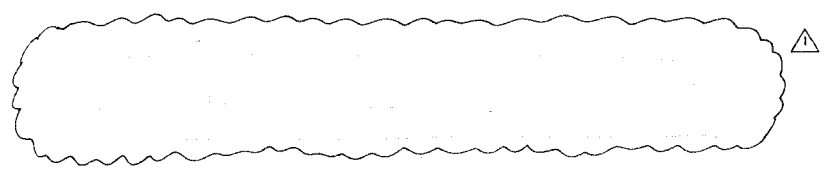

Rev. 10-30-07

STV Incorporated
 Engineers/Architects/Planners/Construction Managers
 200 W. Monroe Street, Suite 1650
 Chicago, IL 60606-5015
 312/553-6655, FAX 312/553-0661

REVISIONS	
NAME	DATE

ILLINOIS DEPARTMENT OF TRANSPORTATION
 ILLINOIS ROUTE 21
 MILWAUKEE AVE. OVER DES PLAINES RIVER
 F.A.P. ROUTE 374 SECTION G-B-1-1
 COOK COUNTY, SN 016-6566

FRAMING PLAN

DESIGN BY: BTO DRAWN BY: BTO
 DATE: 8/29/07 CHECKED BY: JAN CHECKED BY: JAN

SHEET PATH: 1008_SHEET_12.dwg 8/29/07 10:06:07 AM