

STATE OF ILLINOIS  
DEPARTMENT OF TRANSPORTATION

ROUTE NO.	SECTION	QUANTITY	DATE	SHEET	SHEET NO. 8 10 SHEETS
1 AP 370	01031-2	COOK		16	
Contract # 62362					

All steel rail elements shall be galvanized according to Article 509.05 of the Standard Specifications.

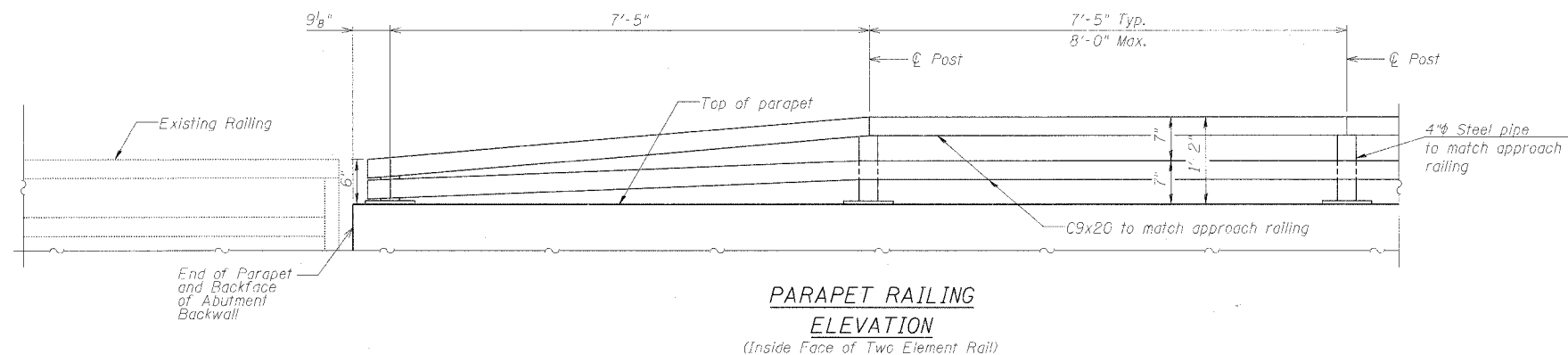

BILL OF MATERIAL

Bar	No.	Size	Length	Shape
d <sub>1</sub> (E)	335	#5	3'-10"	L
e <sub>1</sub> (E)	60	#4	15'-4"	—
Parapet Railing (Special)			Foot	162
Reinforcement Bars, Epoxy Coated			Pound	2050
Concrete Superstructure			Cu. Yd.	14.3

Reinforcement Bars designated (E) shall be epoxy coated

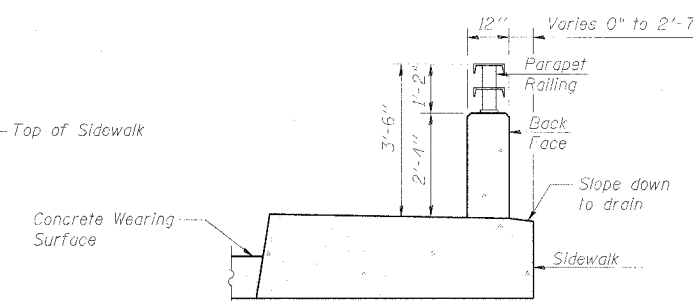
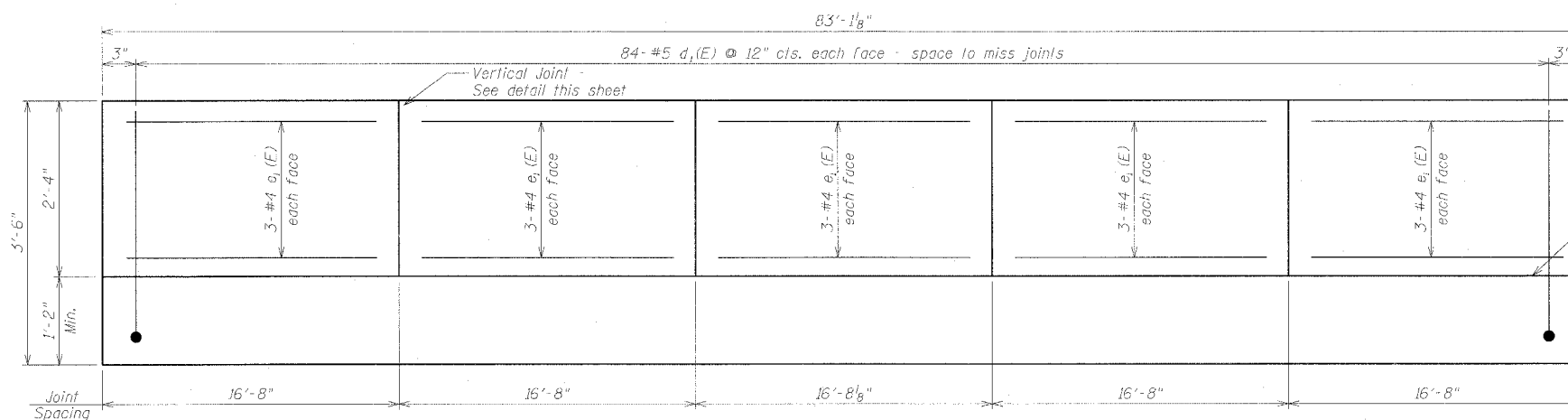

PARAPET ELEVATION  
(Railing not shown)

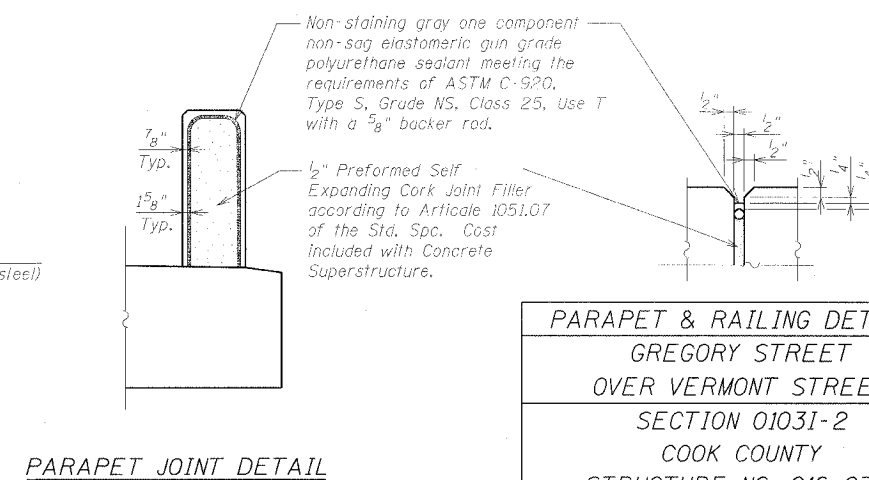
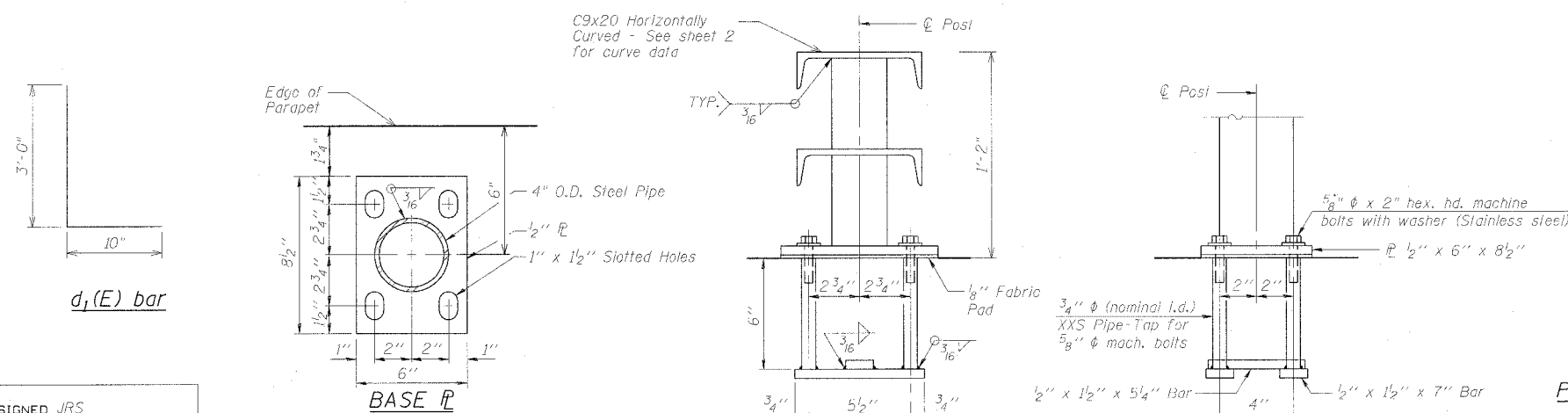

ANCHOR BOLT DETAILS

In lieu of the cast-in-place anchor device shown, the Contractor has the option of drilling and setting 5/8"  $\phi$  anchor rods according to Article 509.06 of the Standard Specifications. Embedment shall be according to the manufacturer's specifications.

PARAPET & RAILING DETAILS  
GREGORY STREET  
OVER VERMONT STREET  
SECTION 01031-2  
COOK COUNTY  
STRUCTURE NO. 016-0776  
STATION 42+37.22

GRAEF, ANHALT, SCHLOEMER & ASSOCIATES, INC.  
CONSULTING ENGINEERS AND LAND SURVEYORS  
8501 W. Higgins Road, Suite 280  
Chicago, Illinois 60631  
(773) 399-0112

DESIGNED	JRS
CHECKED	AML
DRAWN	RBH
CHECKED	AML