

F.A.P. RTE.	SECTION	COUNTY	TOTAL SHEETS	SHEET NO.
34B	2005-007 TS	COOK	26	8
STA.		TO STA.		
FED. ROAD DIST. NO. 1		ILLINOIS FED. AID PROJECT		
CONTRACT NO. 62887				

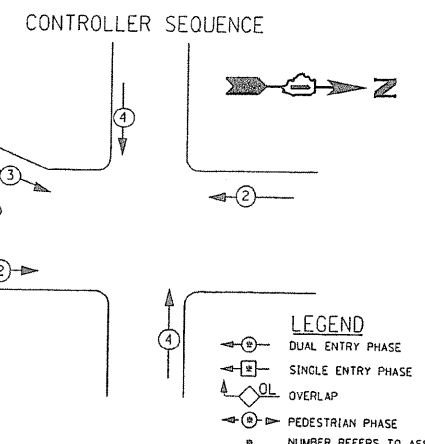

- CONSTRUCTION NOTES:**
- REMOVE EXISTING CONTROLLER AND CABINET. INSTALL A NEW CONTROLLER TYPE IV CABINET AND UPS. RE-USE EXISTING FOUNDATION.
 - REMOVE EXISTING SERVICE CABLE AND SERVICE. INSTALL NEW SERVICE, SERVICE CABLES, AND GROUND CABLES.
 - INSTALL NEW ELECTRIC CABLE IN CONDUIT, LEAD-IN NO. 14 1 PAIR.

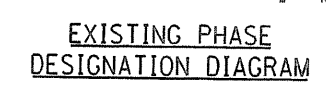
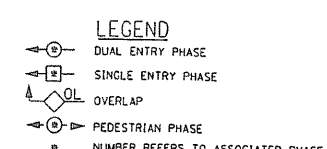

CABLE PLAN LEGEND

- | | | | |
|-----------------|-----------------|-----------------|-----------------|
| EXISTING | PROPOSED | EXISTING | PROPOSED |
| | | | |
| | | | |
| | | | |
| | | | |
| | | | |
| | | | |
| | | | |
| | | | |
| | | | |
| | | | |
| | | | |

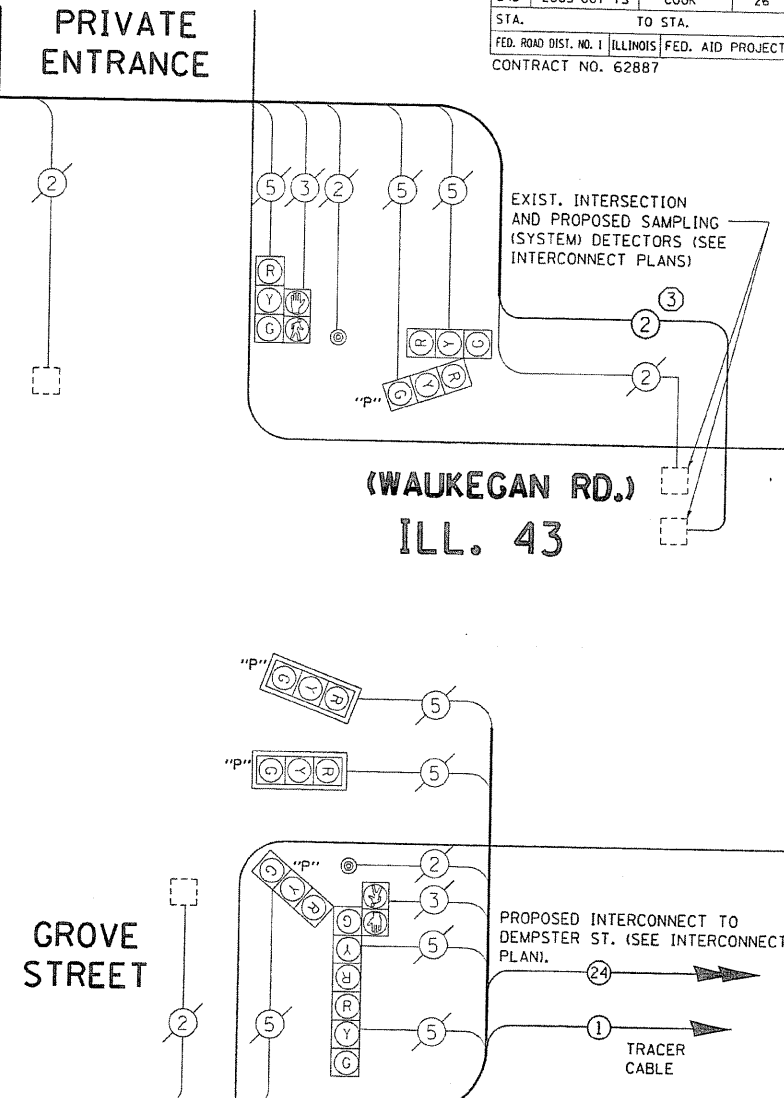
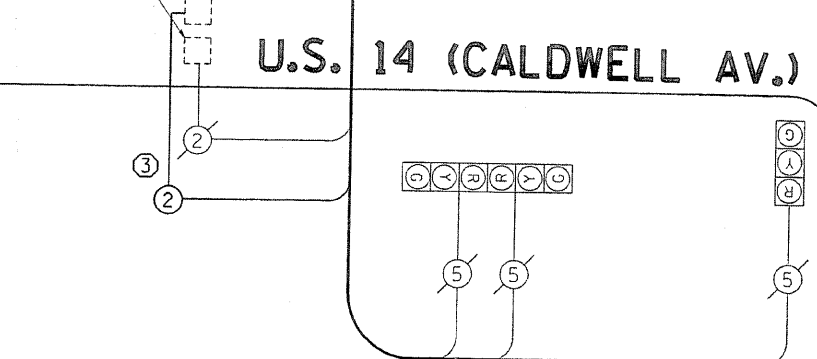
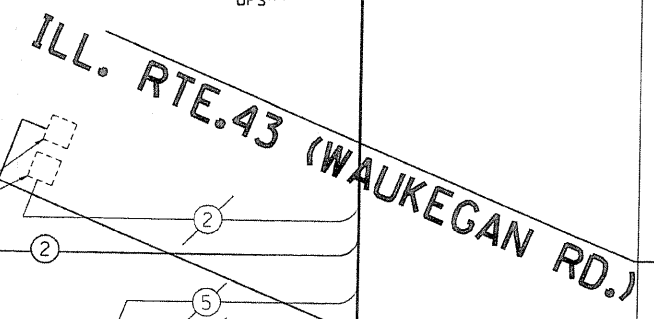

SCHEDULE OF QUANTITIES

- ITEM**
- TRAFFIC CONTROL AND PROTECTION, STANDARD 701701
 - TRAFFIC CONTROL AND PROTECTION, STANDARD 701801
 - MAINTENANCE OF EXISTING TRAFFIC SIGNAL INSTALLATION
 - FULL-ACTUATED CONTROLLER AND TYPE IV CABINET (SPECIAL)
 - TRANSCEIVER-FIBER OPTIC
 - ELECTRIC CABLE IN CONDUIT, LEAD-IN NO. 14 1 PAIR
 - ELECTRIC CABLE IN CONDUIT, SERVICE NO. 6 2 C
 - ELECTRIC CABLE IN CONDUIT, GROUNDING NO. 6 1 C
 - INDUCTIVE LOOP DETECTOR
 - REMOVE ELECTRIC CABLE FROM CONDUIT
 - REMOVE EXISTING TRAFFIC SIGNAL EQUIPMENT
 - SERVICE INSTALLATION, POLE MOUNT
 - UNINTERRUPTABLE POWER SUPPLY (UPS)

UNIT	QUANTITY
L SUM	0.11
L SUM	0.11
EACH	1
EACH	1
EACH	1
FOOT	1398
FOOT	118
FOOT	118
EACH	8
FOOT	94
EACH	1
EACH	1
EACH	1

NOTE:
THE TRAFFIC SIGNAL CONTROL EQUIPMENT FOR THIS PROJECT SHALL BE "ECONOLITE" TO MATCH THE EXISTING ADJACENT SYSTEM.

I.D.O.T. TRAFFIC SIGNAL INSTALLATION ELECTRICAL SERVICE REQUIREMENTS					TOTAL WATTAGE
TYPE	NO. LAMPS	WATTAGE (INCAND.)	LED	% OPERATION	
SIGNAL (RED)	17	135	17	0.50	144.50
(YELLOW)	17	135	25	0.25	106.25
(GREEN)	17	135	15	0.25	63.75
ARROW		135	12	0.10	
PED. SIGNAL	2	90	25	1.00	50.00
CONTROLLER	1	100	100	1.00	100.00
ILLUM. SIGN		84		0.05	
FLASHER				0.50	
TOTAL =					464.50

FOUNDATION (DEPTH)	FT. (m)	CABLE SLACK	FT. (m)	VERTICAL	FT. (m)
TYPE A - POST	4 (1.2)	HANDHOLE	6.5 (2.0)	ALL FOUNDATIONS	3.5 (1.0)
D - CONTROLLER	4 (1.2)	DOUBLE HANDHOLE	13 (4.0)	MAST ARM (L) POLE	20' HL-2=
E - M. ARM POLE		SIGNAL POST	2 (1.0)	(6m HL-0.6m)=	
24" (600mm)	10 (3.0)	CONTROLLER CAB.	1 (0.5)	BRACKET MOUNTED	13 (4.0)
30" (750mm)	15 (4.6)	FIBER OPTIC	13 (4.0)	PED. PUSHBUTTON	4 (1.2)
36" (900mm)	15 (4.6)	ELECTRIC SERVICE	1 (0.5)	ELECTRIC SERVICE	13.5 (4.1)
		GROUND CABLE	1 (0.5)	SERVICE TO GROUND	13.5 (4.1)
				POST MOUNTED	6 (1.8)

REVISIONS	
NAME	DATE

ILLINOIS DEPARTMENT OF TRANSPORTATION
CABLE PLAN, PHASE DESIGNATION DIAGRAM, AND SCHEDULE OF QUANTITIES
ILL. RTE. 43 (WAUKEGAN RD.) AT
U.S. RTE. 14 (CALDWELL AVE.)

SCALE: 1"=20'
DATE: 8/17/2007
DRAWN BY: BCK
DESIGN BY: BCK
CHECKED BY: DAD