

F.A.S. RTE.	SECTION	COUNTY	TOTAL SHEETS	SHEET NO.
2079	...	CARROLL & OGLE	232	62
STA.	TO STA.			
FED. ROAD DIST. NO.	ILLINOIS	FED. AID PROJECT		
• (US 52)	•• (16.17, 181RS-3 & (16BRM-1)			

DARRYL JACK BOTT

**EMERSON G. & HELEN ISKE**

Drainage Area = 10.8 acres  
 Existing Low Grade Elevation: 839.87 ft. @ 122+75  
 Proposed Low Grade Elevation: 840.55 ft. @ 122+00

Flood Year	Frequency	Discharge cfs	Headwater Existing Elev. (ft)	Proposed Elev. (ft)
Ten-Year	10	21	838.18	835.86
Design	50	29	838.95	836.63
Base	100	33	839.64	837.04
EX Overtopping	100	33	839.87	
Max Calc	500	46		838.73

10-Year Velocity through Existing Culvert = 9.6 fps  
 10-Year Velocity through Proposed Culvert = 6.4 fps

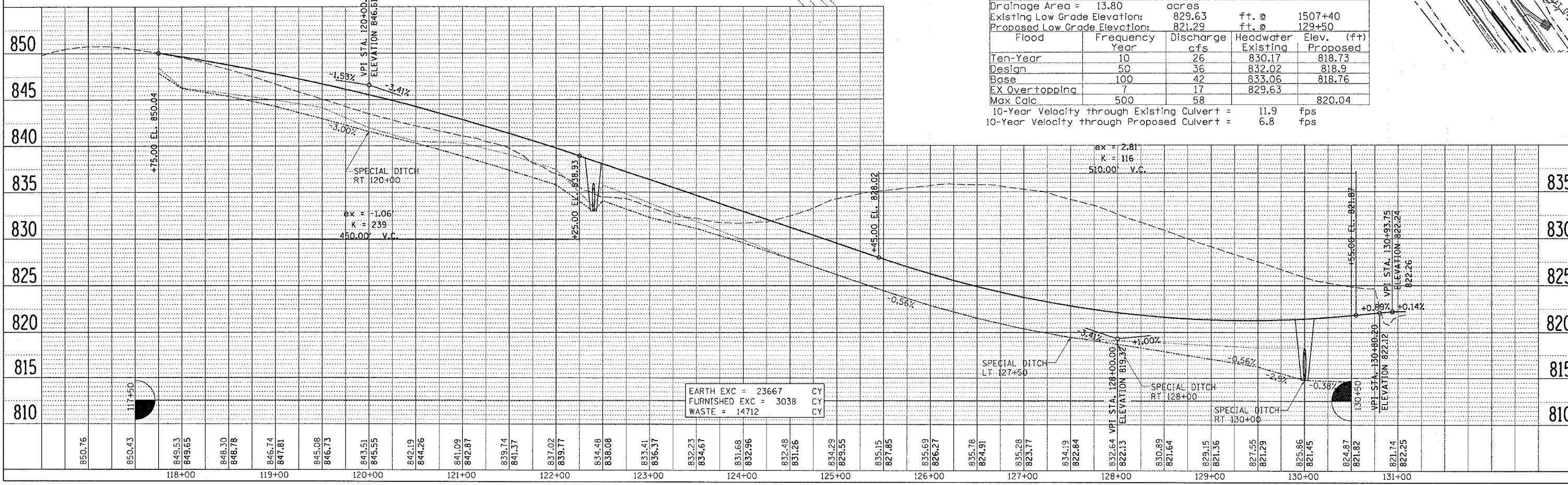
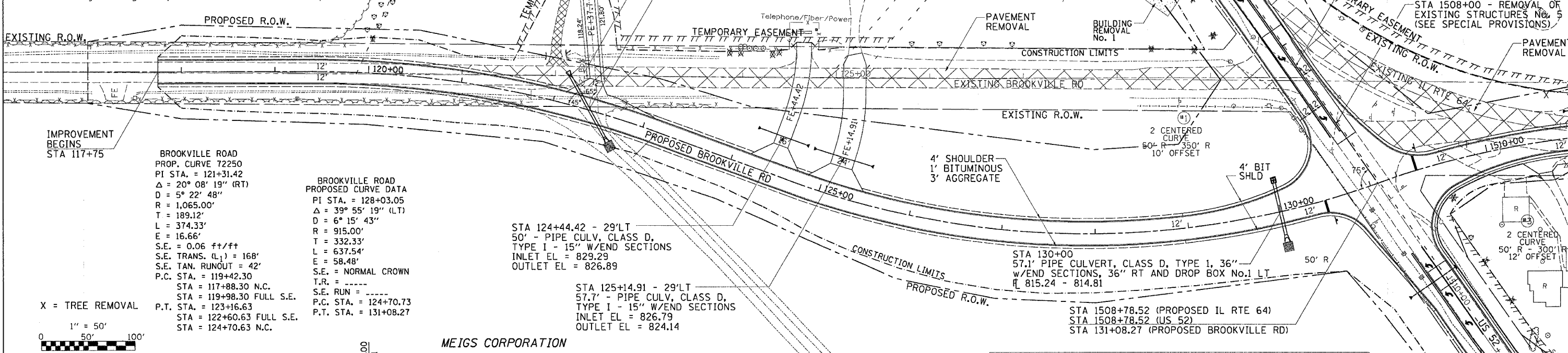

**MEIGS CORPORATION**

Drainage Area = 13.80 acres  
 Existing Low Grade Elevation: 829.63 ft. @ 1507+40  
 Proposed Low Grade Elevation: 821.29 ft. @ 129+50

Flood Year	Frequency	Discharge cfs	Headwater Existing Elev. (ft)	Proposed Elev. (ft)
Ten-Year	10	26	830.17	818.73
Design	50	36	832.02	818.9
Base	100	42	833.06	818.76
EX Overtopping	7	17	829.63	
Max Calc	500	58		820.04

10-Year Velocity through Existing Culvert = 11.9 fps  
 10-Year Velocity through Proposed Culvert = 6.8 fps