

F.A.S. RTE.	SECTION	COUNTY	TOTAL SHEETS	SHEET NO.
2079	**	CARROLL & OGLE	232	66
STA. 156+00		TO STA. 162+90.35		
FED. ROAD DIST. NO.		ILLINOIS FED. AID PROJECT		
*(US 52)		** (16.17, 18RS-3 & 116BRM-1)		

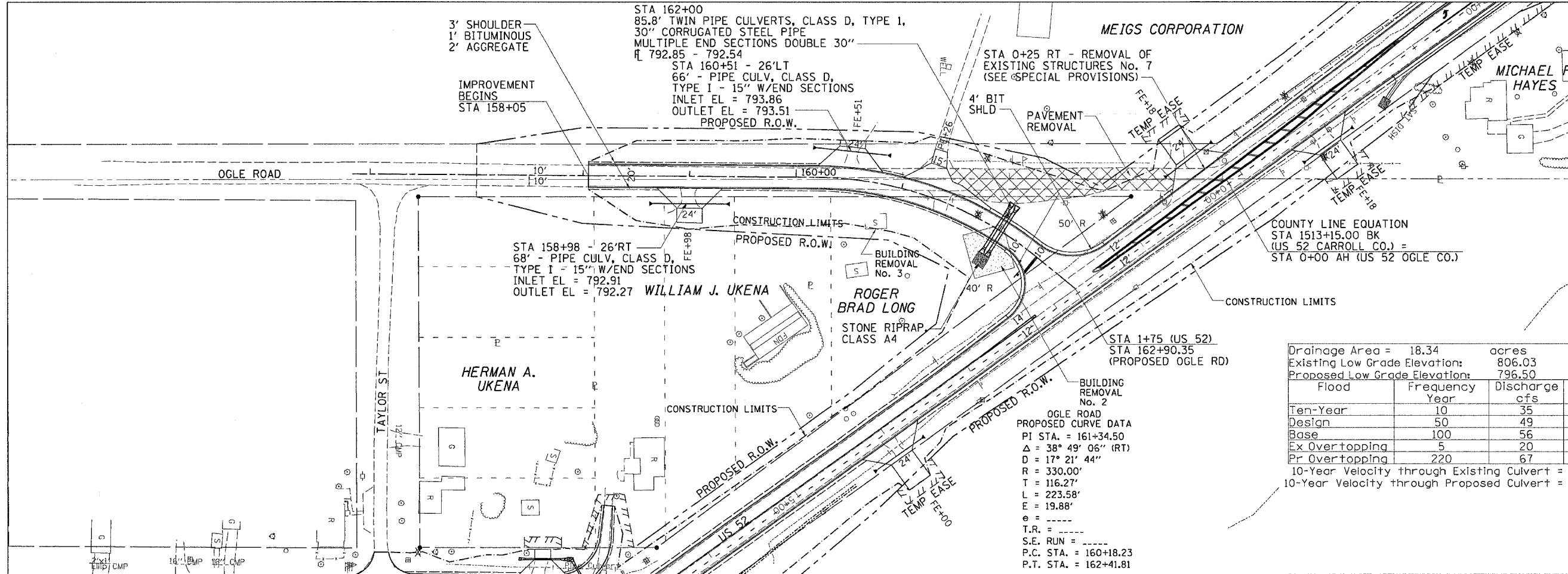

Drainage Area = 18.34 acres		Existing Low Grade Elevation: 806.03 ft. @ 0+00 (US 52)	
Proposed Low Grade Elevation: 796.50 ft. @ 161+25 (Ogle)			
Flood Year	Frequency	Discharge cfs	Headwater Existing Elev. (ft)
Ten-Year	10	35	807.34
Design	50	49	810.23
Base	100	56	812.21
Ex Overtopping	5	20	806.03
Pr Overtopping	220	67	796.50
10-Year Velocity through Existing Culvert = 10.3 fps			
10-Year Velocity through Proposed Culvert = 6.3 fps			

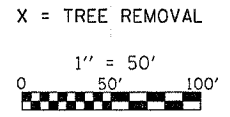

PLAN	DATE
REVISIONS	
NO. 1	
NO. 2	
NO. 3	
NO. 4	
NO. 5	

PROFILE	DATE
REVISIONS	
NO. 1	
NO. 2	
NO. 3	
NO. 4	
NO. 5	

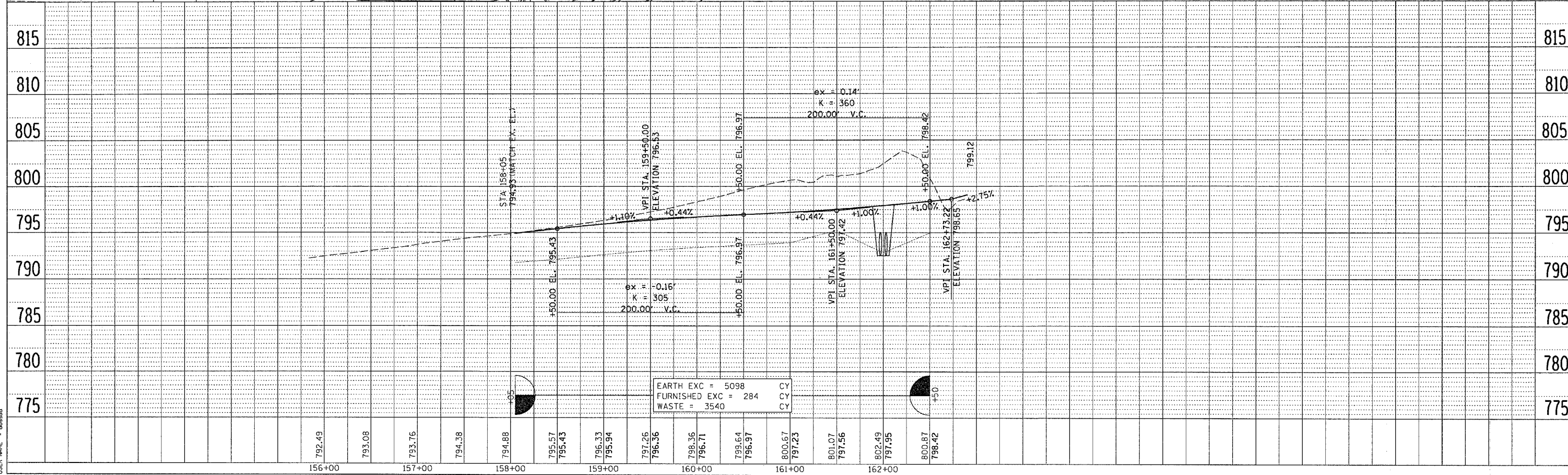

PLOT DATE = Thu, Mar 88 09:32:53 2887
 PLOT SCALE = 50.0000 1/4 IN.
 USER NAME = dmsadd