

F.A.P. RTE.	SECTION	COUNTY	TOTAL SHEETS	SHEET NO.
595	5HBR	ROCK ISLAND	139	30
STA.		TO STA.		
FED. ROAD DIST. NO.		ILLINOIS	FED. AID PROJECT	
• (IL5/IL92)				

IL RTE 5 REMOVAL

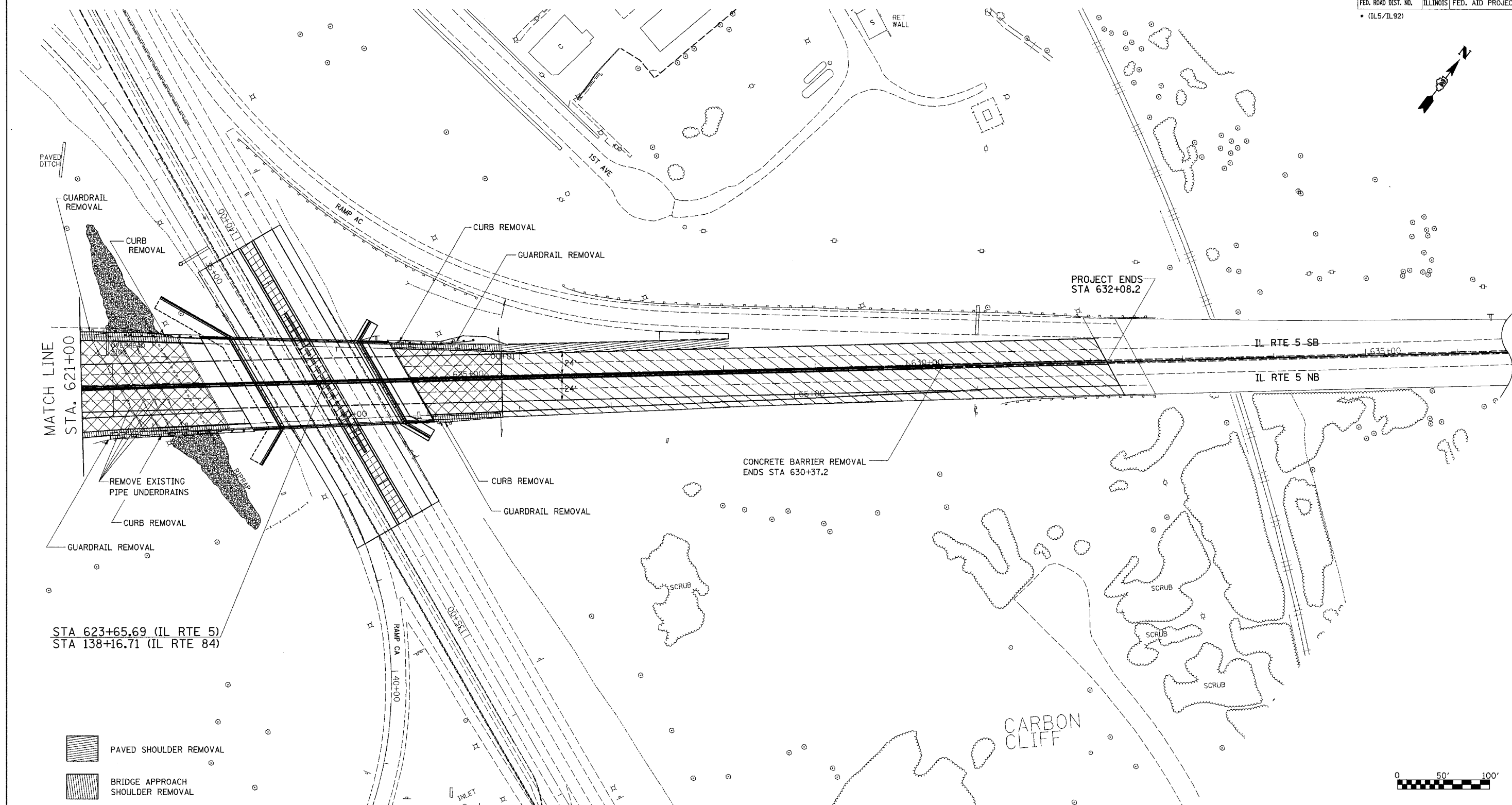

MATCH LINE
STA. 621+00





PROJECT ENDS
STA 632+08.2

IL RTE 5 SB
IL RTE 5 NB

STA 623+65.69 (IL RTE 5)
STA 138+16.71 (IL RTE 84)

CONCRETE BARRIER REMOVAL
ENDS STA 630+37.2

CARBON CLIFF

-  PAVED SHOULDER REMOVAL
-  BRIDGE APPROACH SHOULDER REMOVAL
-  PAVEMENT REMOVAL
-  COMBINATION CURB & GUTTER REMOVAL
CONCRETE MEDIAN SURFACE REMOVAL
-  HOT-MIX ASPHALT SURFACE REMOVAL, 2"



REVISIONS	
NAME	DATE

ILLINOIS DEPARTMENT OF TRANSPORTATION
FAP ROUTE 595 (IL5/IL92)
SECTION 5HBR
ROCK ISLAND COUNTY

SCALE: VERT. _____
 HORIZ. _____
 DATE _____

DRAWN BY _____
 CHECKED BY _____

IL RTE 5 REMOVAL

PLOT DATE = Wed Aug 22 13:47:13 2007
 FILE NAME = c:\puro\puro\595\20070823\680203-rem.dgn
 USER = gcr
 USER NAME = gcr