

TRAFFIC CONTROL DETAIL

CONTRACT NO. 64931			
F.A.P. RTE.	SECTION	COUNTY	TOTAL SHEET NO.
595	SHBR	ROCK ISLAND	139 97
STA.		TO STA.	
FED. ROAD DIST. NO.		ILLINOIS FED. AID PROJECT	

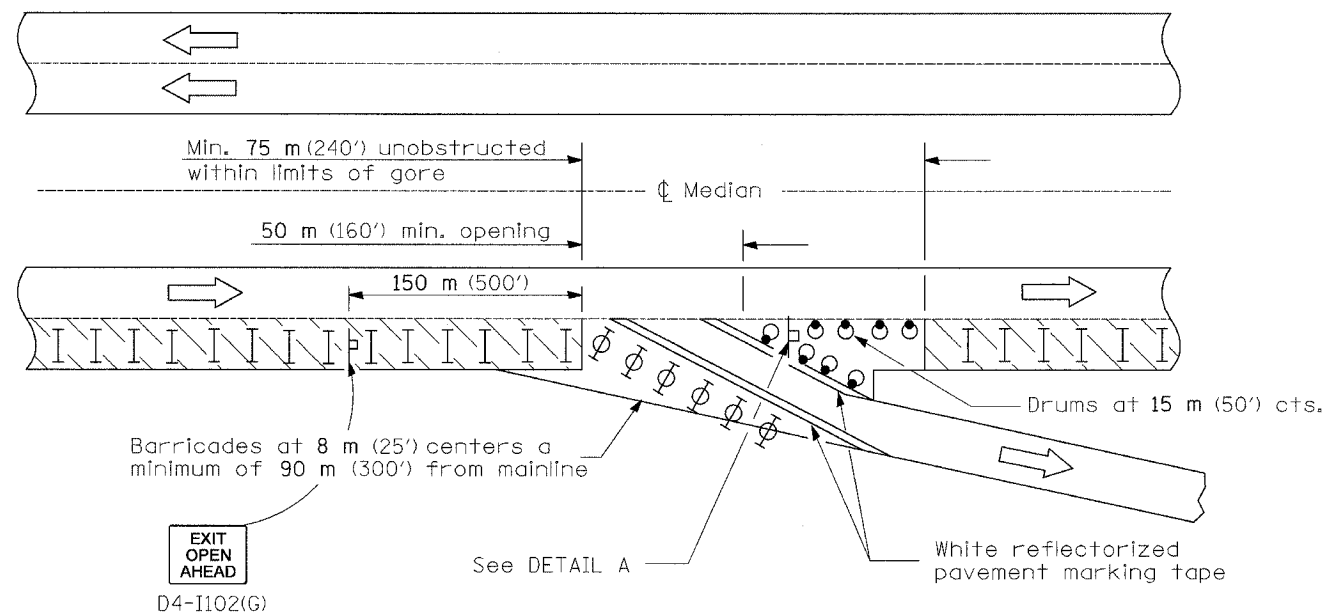

APPLICATION NO. 3

Application No. 3 depicts a modified exit ramp. The channelizing devices shall provide a clearly defined path for the exiting motorists. The minimum dimensions shown shall be increased as soon as the progress of the work will permit. The open portion of the ramp may be shifted, with the approval of the Engineer, to perform work in stages on the area adjacent to the ramp exit. Application No. 4 shall be put into effect as soon as possible.

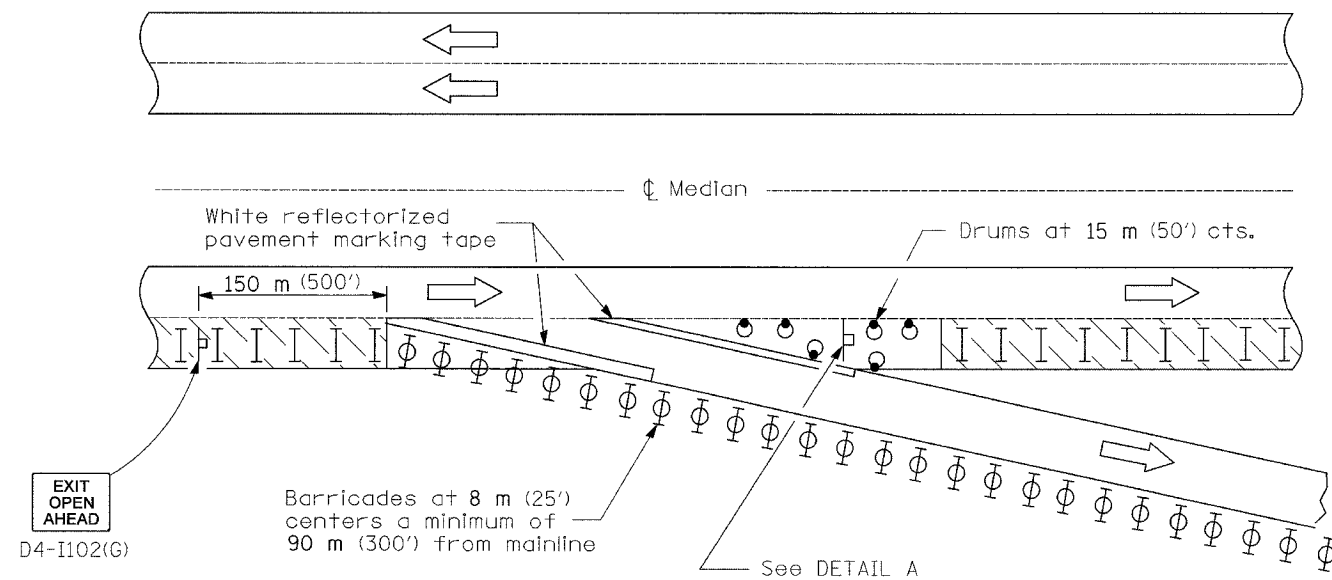

APPLICATION NO. 4

Application No. 4 depicts an extension of the normal exit ramp. This method shall be used whenever existing geometrics can be retained. Consideration should be given to the exiting motorist's line of sight through, between or over the delineation devices.

All dimensions are in millimeters (inches) unless otherwise shown.

LANE CLOSURE, MULTILANE,
AT ENTRANCE OR EXIT RAMP,
FOR SPEEDS \geq 45 MPH

(Sheet 2 of 2)