

STAGE 1

F.A.P. RTE.	SECTION	COUNTY	TOTAL SHEETS	SHEET NO.
553	120T-2	OGLE	59	21
STA.		TO STA.		
FED. ROAD DIST. NO.		ILLINOIS	FED. AID PROJECT	

PROPOSED STRUCTURE (SN 071-1160)
 STA 2109+64.78
 96' PRECAST CONCRETE BOX CULVERT
 DOUBLE CELL 6'x5', 27° SKEW
 2 EA. GRATED CULVERT EXTENSION NO. 1
 U/S ELEV = 798.50
 D/S ELEV = 797.60

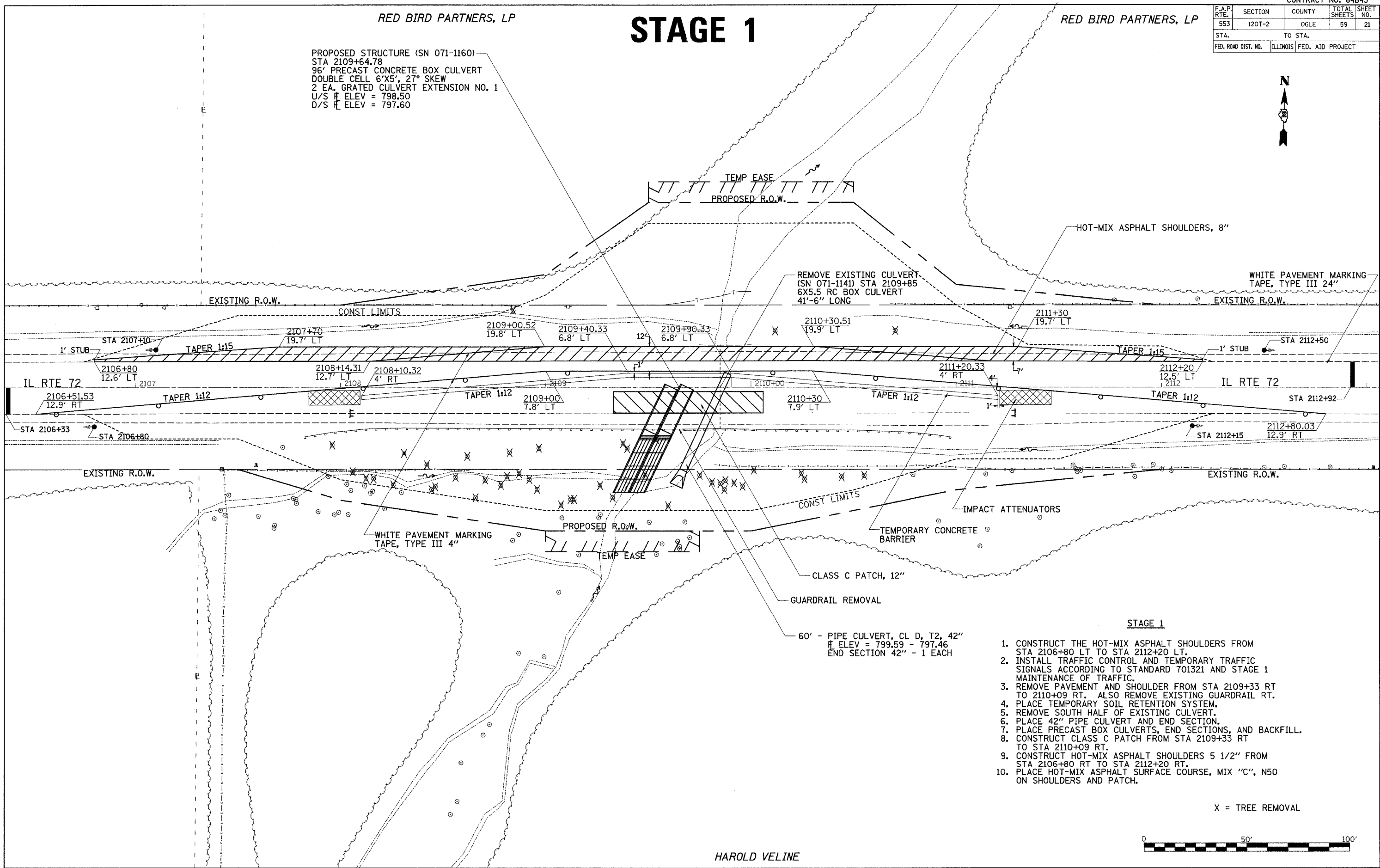

- STAGE 1**
1. CONSTRUCT THE HOT-MIX ASPHALT SHOULDERS FROM STA 2106+80 LT TO STA 2112+20 LT.
 2. INSTALL TRAFFIC CONTROL AND TEMPORARY TRAFFIC SIGNALS ACCORDING TO STANDARD 701321 AND STAGE 1 MAINTENANCE OF TRAFFIC.
 3. REMOVE PAVEMENT AND SHOULDER FROM STA 2109+33 RT TO 2110+09 RT. ALSO REMOVE EXISTING GUARDRAIL RT.
 4. PLACE TEMPORARY SOIL RETENTION SYSTEM.
 5. REMOVE SOUTH HALF OF EXISTING CULVERT.
 6. PLACE 42" PIPE CULVERT AND END SECTION.
 7. PLACE PRECAST BOX CULVERTS, END SECTIONS, AND BACKFILL.
 8. CONSTRUCT CLASS C PATCH FROM STA 2109+33 RT TO STA 2110+09 RT.
 9. CONSTRUCT HOT-MIX ASPHALT SHOULDERS 5 1/2" FROM STA 2106+80 RT TO STA 2112+20 RT.
 10. PLACE HOT-MIX ASPHALT SURFACE COURSE, MIX "C", N50 ON SHOULDERS AND PATCH.

X = TREE REMOVAL

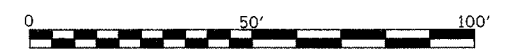

HAROLD VELINE

PLOT DATE = Tue Aug 07 09:28:55 2007
 USER = j...
 PLOT SCALE = 20.0000 / IN
 USER NAME = d...