

F.A.I. RYE.	SECTION	COUNTY	TOTAL SHEETS	SHEET NO.
80	06-BHBR	BUREAU	165	40
STA. 232+00		TO STA. 238+00		
FED. ROAD DIST. NO. 3 ILLINOIS FED. AID PROJECT				

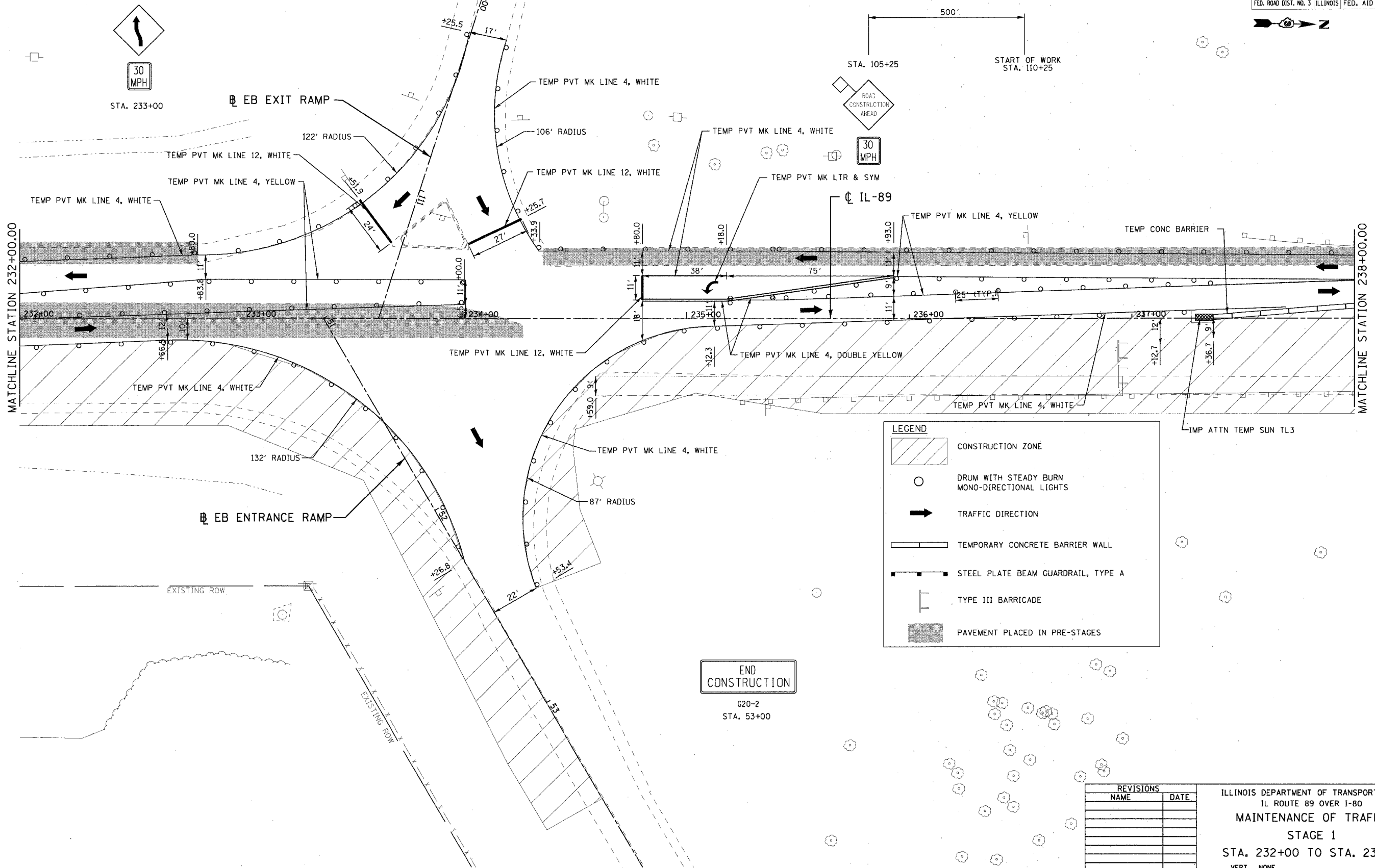

LEGEND

- CONSTRUCTION ZONE
- DRUM WITH STEADY BURN MONO-DIRECTIONAL LIGHTS
- TRAFFIC DIRECTION
- TEMPORARY CONCRETE BARRIER WALL
- STEEL PLATE BEAM GUARDRAIL, TYPE A
- TYPE III BARRICADE
- PAVEMENT PLACED IN PRE-STAGES

END
CONSTRUCTION
020-2
STA. 53+00

REVISIONS	
NAME	DATE

ILLINOIS DEPARTMENT OF TRANSPORTATION
IL ROUTE 89 OVER I-80
MAINTENANCE OF TRAFFIC
STAGE 1
STA. 232+00 TO STA. 238+00
SCALE: VERT. NONE
HORIZ. 1" = 20'
DATE: 08/10/07
DRAWN BY ACE/CAD
CHECKED BY TMH

PLOT DATE = 8/1/2007
FILE NAME = s:\projects\20648891_882\cadd\gsm1182r.dwg
PLOT SCALE = 28.000 / IN.
USER NAME = sbrund

