

F.A.I. RTE.	SECTION	COUNTY	TOTAL SHEETS	SHEET NO.
80	06-8HBR	BUREAU	165	42
STA. 244+00		TO STA. 248+50		
FEB. ROAD DIST. NO. 3 ILLINOIS FED. AID PROJECT				

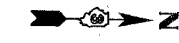

LEGEND

- CONSTRUCTION ZONE
- DRUM WITH STEADY BURN MONO-DIRECTIONAL LIGHTS
- TRAFFIC DIRECTION
- TEMPORARY CONCRETE BARRIER WALL
- STEEL PLATE BEAM GUARDRAIL, TYPE A
- TYPE III BARRICADE
- PAVEMENT PLACED IN PRE-STAGES

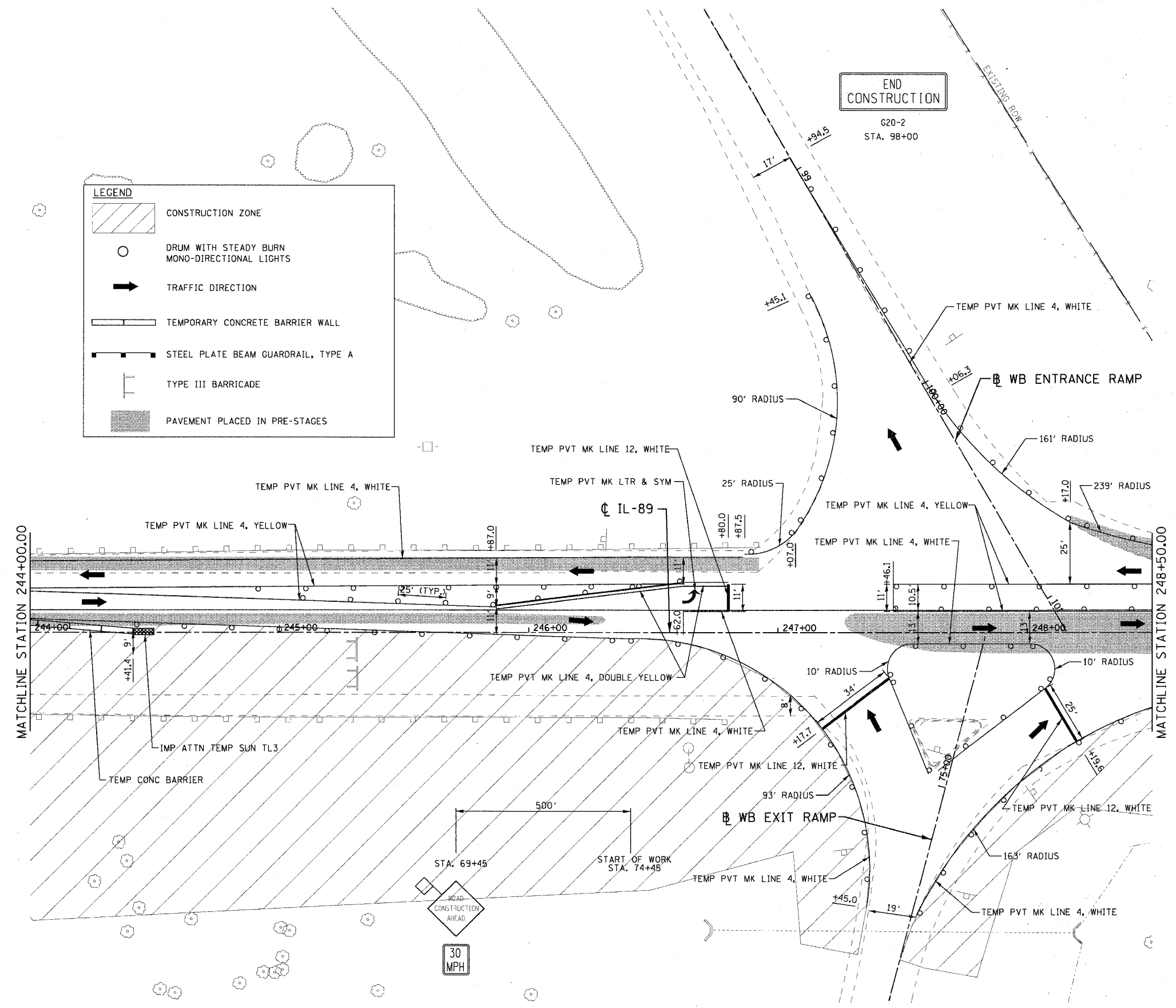

REVISIONS	
NAME	DATE

ILLINOIS DEPARTMENT OF TRANSPORTATION
 IL ROUTE 89 OVER I-80
MAINTENANCE OF TRAFFIC
STAGE 1
 STA. 244+00 TO STA. 248+50

SCALE: VERT. NONE
 HORIZ. 1" = 20'
 DATE: 08/10/07

DRAWN BY ACE/CAD
 CHECKED BY TMH

PLOT DATE: 8/17/2007
 FILE NAME: S:\projects\12854889_082\adda\9m\1184.rds
 PLOT SCALE: 28.266 / IN.
 USER NAME: ephind

