

F.A.P. RTE.	SECTION	COUNTY	TOTAL SHEETS	SHEET NO.
681	115 BR	LIVINGSTON	32	12
STA.		TO STA.		
FED. ROAD DIST. NO.	ILLINOIS	FED. AID PROJECT		

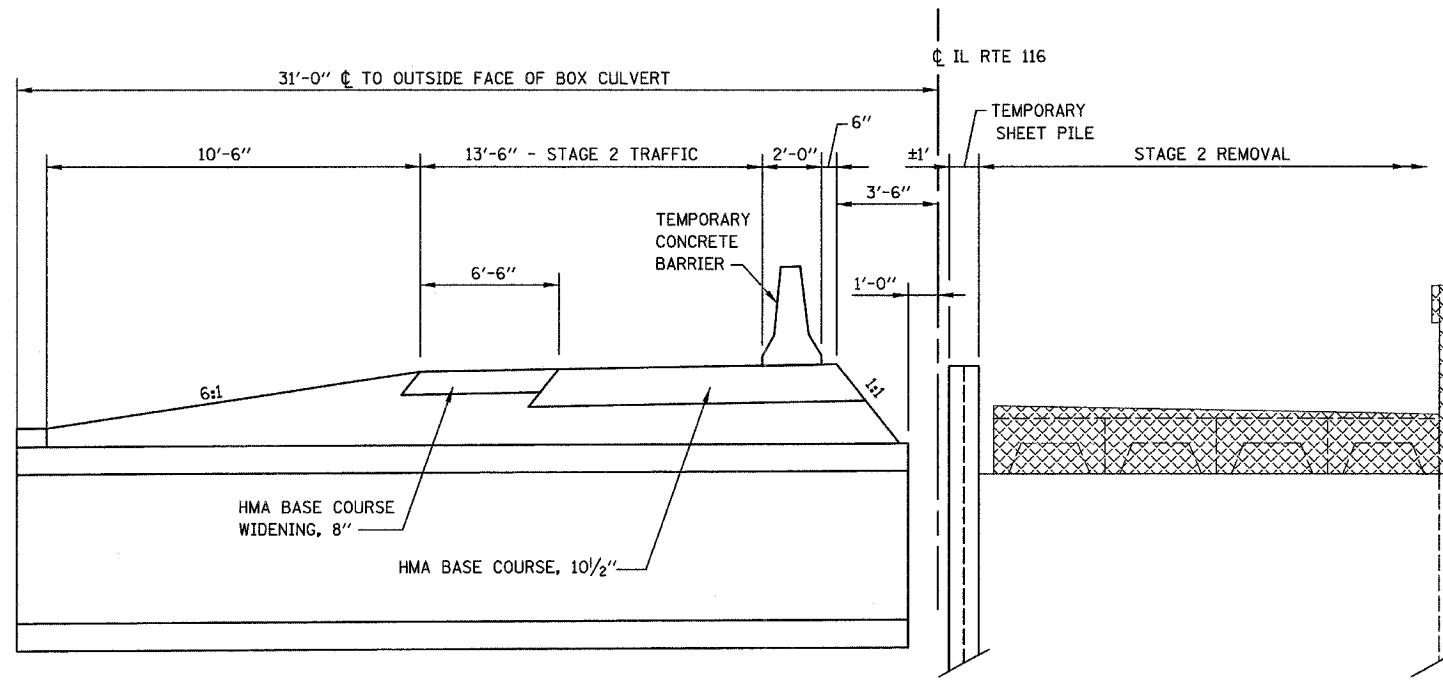

STAGE 2 CONSTRUCTION TYPICAL SECTION
(LOOKING WEST @ STRUCTURE)

NOTES

- ① THE TEMPORARY WIDENING SHALL REMAIN IN PLACE BENEATH THE PROPOSED PAVEMENT AS REQUIRED. THE TEMPORARY WIDENING BEYOND THE PROPOSED EDGE OF PAVEMENT THAT IS IN CONFLICT WITH THE AGGREGATE SHOULDER SHALL BE REMOVED. THE COST OF WHICH WILL BE PAID FOR AS "TEMPORARY PAVEMENT REMOVAL."

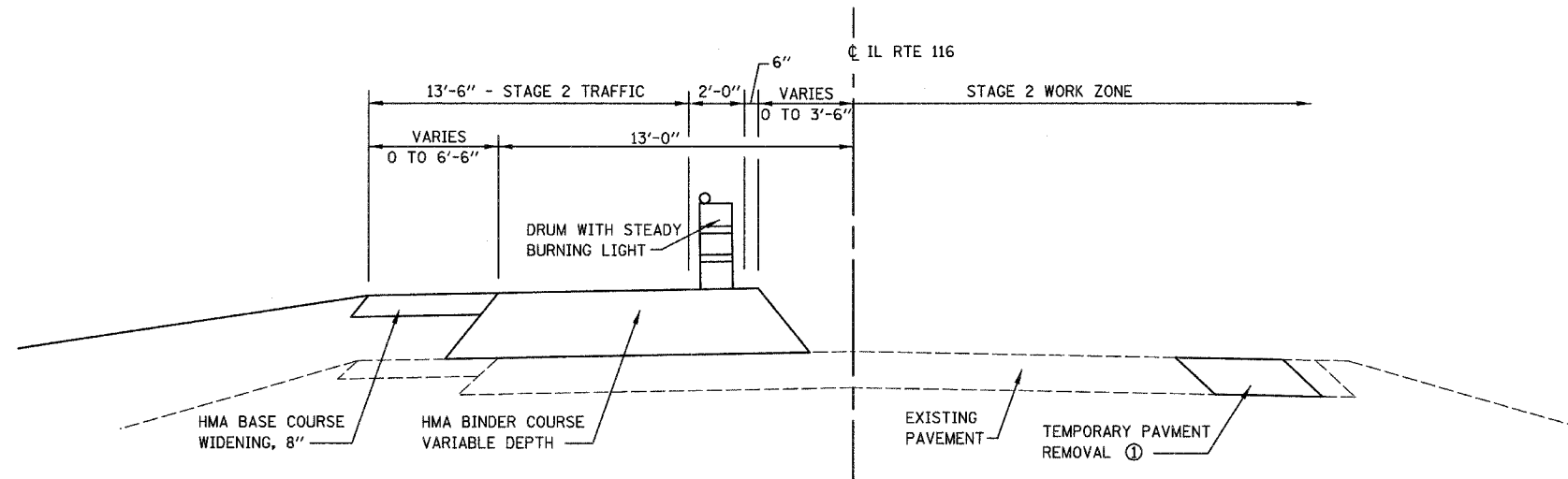

STAGE 2 CONSTRUCTION TYPICAL SECTION
(LOOKING WEST @ APPROACH)

REVISIONS	
NAME	DATE

ILLINOIS DEPARTMENT OF TRANSPORTATION

STAGE CONSTRUCTION & TRAFFIC CONTROL

FAP ROUTE 681
SECTION 115 BR
LIVINGSTON COUNTY

PLOT DATE = 8/28/2007
 FILE NAME = H:\P\66690\F115\Stage2.dgn
 PLOT SCALE = 28.0000 / IN.
 USER NAME = MUSER