

F.A.P. RTE.	SECTION	COUNTY	TOTAL SHEETS	SHEET NO.
573	(115,116,117)	DEKALB	10	1

STATE OF ILLINOIS  
DEPARTMENT OF TRANSPORTATION  
DIVISION OF HIGHWAYS

**PROPOSED  
HIGHWAY PLANS**

FAP ROUTE 573 (US ROUTE 30)

SECTION (115,116,117)

PROJECT ACHSIP-0573(098)

DEKALB COUNTY

C-93-081-07

AGGREGATE SHOULDERS

INDEX OF SHEETS

1. COVER SHEET
2. GENERAL NOTES
3. SUMMARY OF QUANTITIES
4. TYPICAL SECTIONS
- 5 - 6. AGGREGATE SCHEDULE - EASTBOUND
- 7 - 8. AGGREGATE SCHEDULE - WESTBOUND
9. AGGREGATE SHOULDER DETAILS
10. AGGREGATE SHOULDER (SPECIAL) DETAILS

STANDARDS

- 701001-01 OFF-ROAD OPERATIONS 2L, 2W, MORE THAN 4.5 m (15') AWAY
- 701006-02 OFF-ROAD OPERATIONS 2L, 2W, 4.5 m (15') TO 600 mm (24") FROM PAVEMENT EDGE
- 701011-01 OFF-ROAD MOVING OPERATIONS 2L, 2W, DAY ONLY
- 701301-02 LANE CLOSURE, 2L, 2W, SHORT TIME OPERATIONS
- 701306-01 LANE CLOSURE, 2L, 2W, SLOW MOVING OPERATIONS DAY ONLY, FOR SPEEDS ≥ 45 MPH
- 702001-06 TRAFFIC CONTROL DEVICES

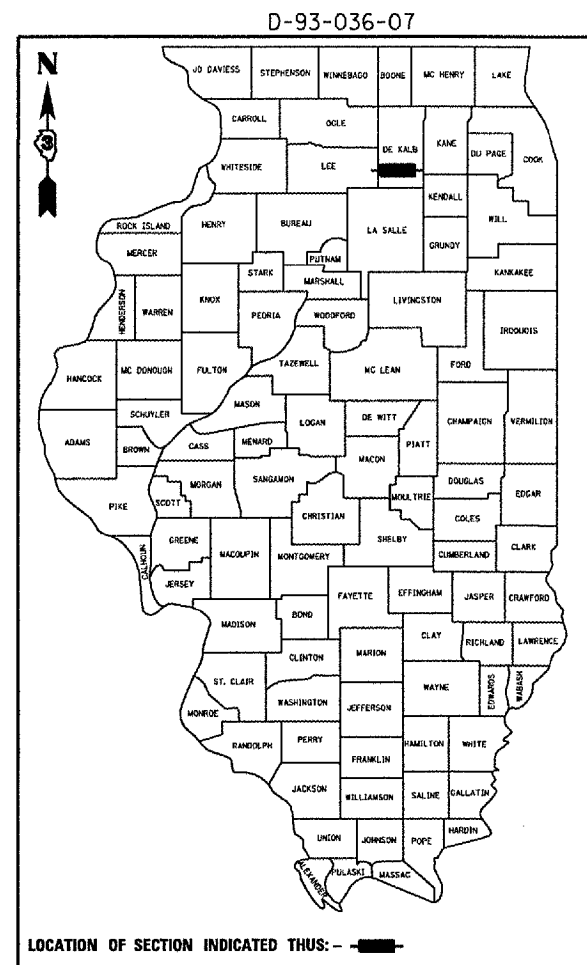

FUNCTIONAL CLASSIFICATION  
RURAL - MINOR ARTERIAL  
F.A.P. ROUTE 573 (U.S. 30)  
2005 ADT = 4850  
P.V = 78.3% M.U. = 14.8% S.U. = 6.9%

STATE OF ILLINOIS  
DEPARTMENT OF TRANSPORTATION  
DIVISION OF HIGHWAYS

SUBMITTED 8/27/07

*James E. Blum*  
DEPUTY DIRECTOR OF HIGHWAYS, REGION ENGINEER

October 12, 2007  
*Eric E. Harrell*  
ENGINEER OF DESIGN AND ENVIRONMENT

October 12, 2007  
*Michael L. Sees, P.E.*  
DIRECTOR OF HIGHWAYS, CHIEF ENGINEER

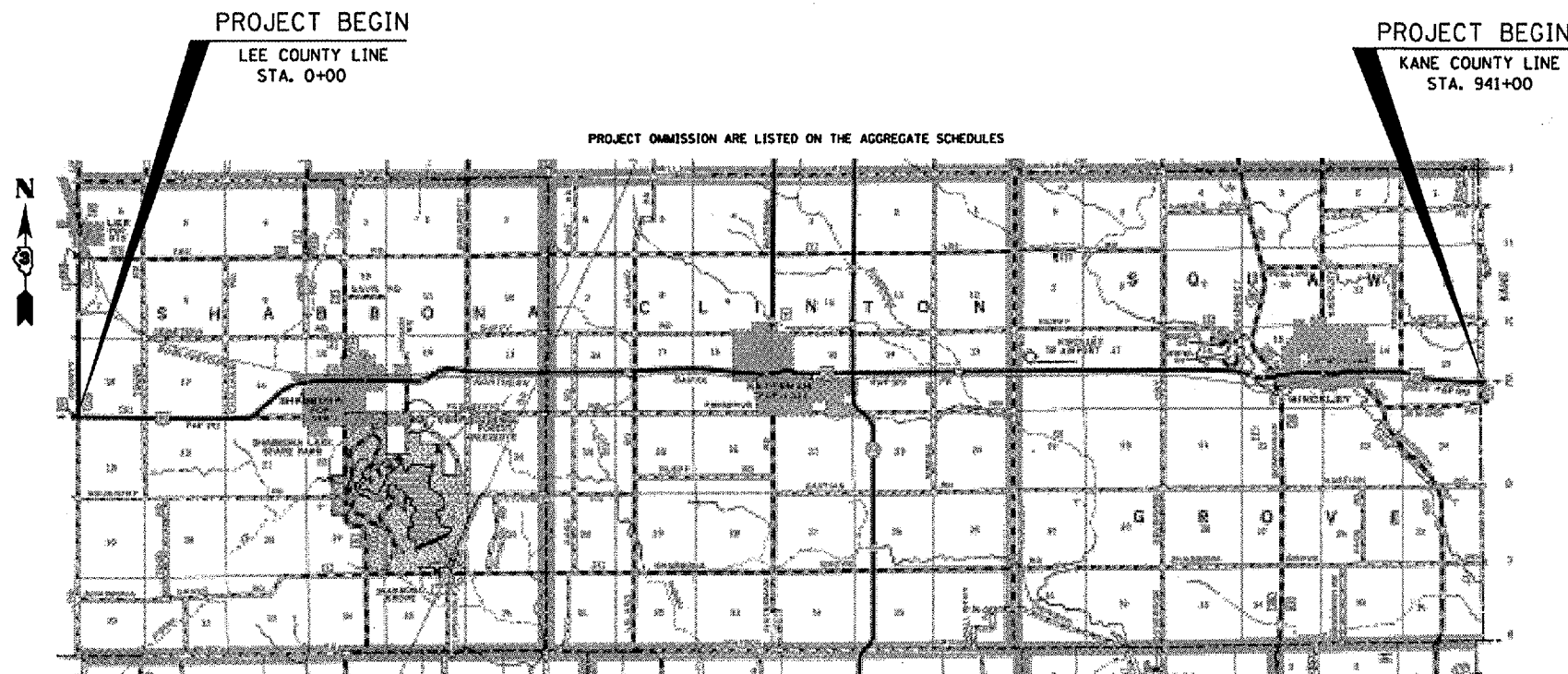

LOCATION MAP

NOT TO SCALE  
GROSS LENGTH = 94100 FT. = 17.82 MI.  
NET LENGTH = 69960 FT. = 13.25 MI

MICROFILMED \_\_\_\_\_  
REEL NUMBER \_\_\_\_\_  
AWARDED \_\_\_\_\_  
RESIDENT ENGINEER \_\_\_\_\_  
AS BUILT CHANGES WERE MADE  
ON THE FOLLOWING SHEETS

DISTRICT NO. 815-434-6131  
JULIE 1-800-892-0123  
PROJECT ENGINEER : JOE KANNEL  
UNIT CHIEF : RON WOODSHANK  
TOWNSHIPS: SHABBONA, CLINTON, SQUAW GROVE

CONTRACT NO. 66725

PRINTED BY THE AUTHORITY  
OF THE STATE OF ILLINOIS