

ROUTE NO.	SECTION	COUNTY	SHEET NO.	SHEET NO.
F.A.P. 310 U.S. 67	(40BY)BR, (41-A)BR-1	McDonough	66	22
FED. ROAD DIST. NO. 4			FED. AID PROJECT-	

Contract #68677  
 98-#5 d<sub>3</sub>(E) bars at 12" cts. Outside Face  
 101-#5 d<sub>1</sub>(E) bars at 11" cts. Inside Face  
 3-#5 d<sub>4</sub>(E) bars at 11" cts., Ea. Corner  
 \*14-#5 a<sub>1</sub>(E) bars at 7 1/2" cts. Top  
 \*11-#5 a<sub>1</sub>(E) bars at 10" cts. Bolt.

\*Order a<sub>1</sub>(E), a<sub>2</sub>(E), a<sub>3</sub>(E), & a<sub>4</sub>(E) Bars Full Length. Cut to Fit Skew and Use Remainder in Opposite End

3 x 2-#5 b<sub>1</sub>(E) bars Top of slab Ea. side

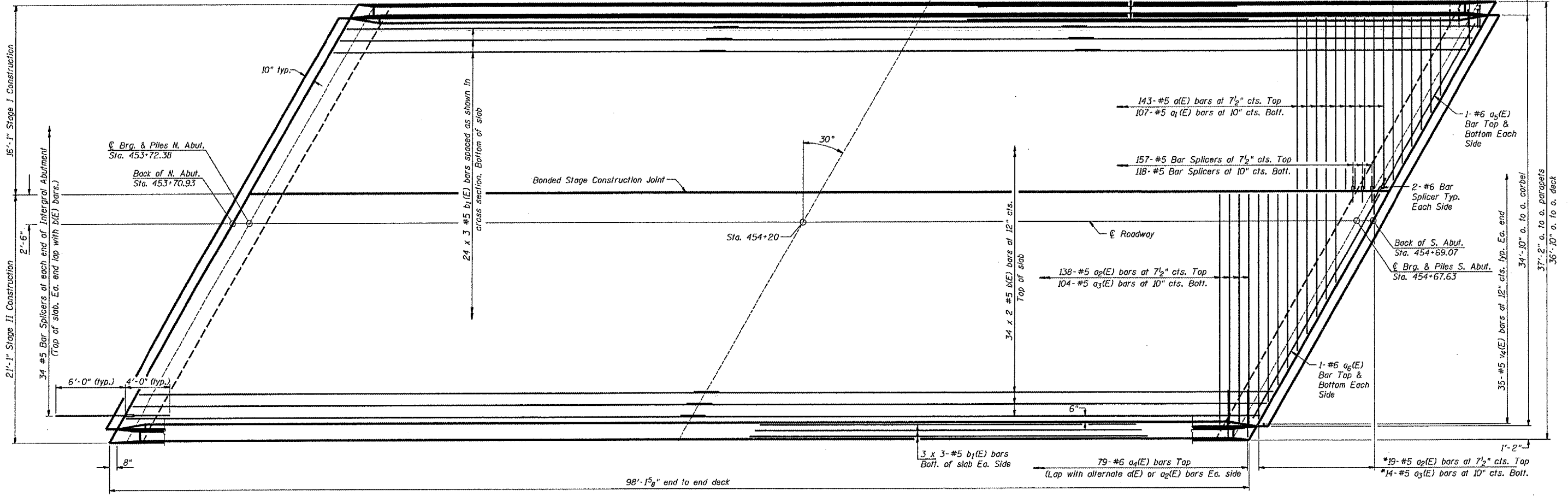

PLAN VIEW

BAR	LAP
#4	1'-8"
#5	2'-2"
#6	2'-7"
#7	3'-5"
#8	4'-6"

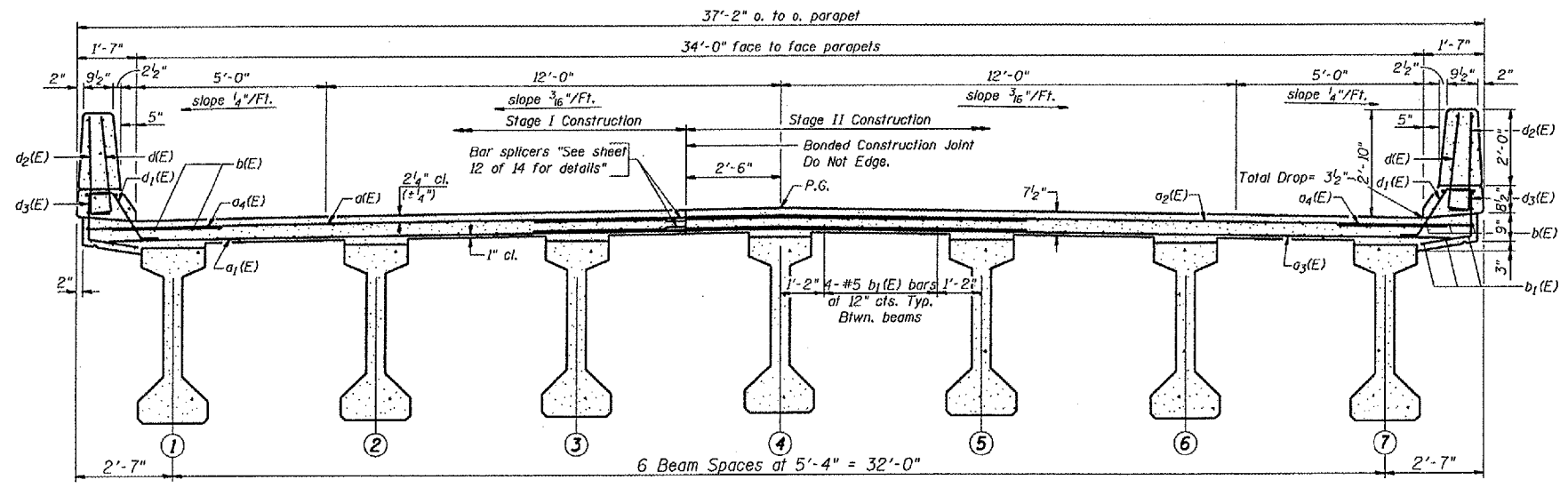

CROSS SECTION  
(Looking Upstation)

Notes: See sheet 7 of 14 for parapet details and Bill of Material.  
 See sheet 6 of 14 for sections at Abutments.  
 Reinforcement bars designated (E) shall be epoxy coated.  
 Bars indicated thus 34 x 2-#5 etc. indicates 34 lines of bars with 2 lengths per line.

**SUPERSTRUCTURE**  
 F.A.P. 310, SECTION (41A)BR-1  
 U.S. ROUTE 67 OVER GRINDSTONE CREEK  
 McDONOUGH COUNTY  
 STA. 454+20 (S.N. 055-0049)  
 WHA # 105003