

F.A.P. RTE.	SECTION	COUNTY	TOTAL SHEETS	SHEET NO.
721	(113BRIBR	DEWITT	81	25
STA.		TO STA.		
FED. ROAD DIST. NO.		ILLINOIS FED. AID PROJECT		

EROSION CONTROL PLAN

SHEET 2 OF 2

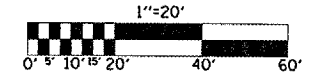

TEMPORARY DITCH CHECKS

STATION	OFFSET	EACH	
245+06.00	RT 58.74	1	
245+15.32	LT 57.03	1	
246+50.00	LT 54.01	1	
TOTAL			3

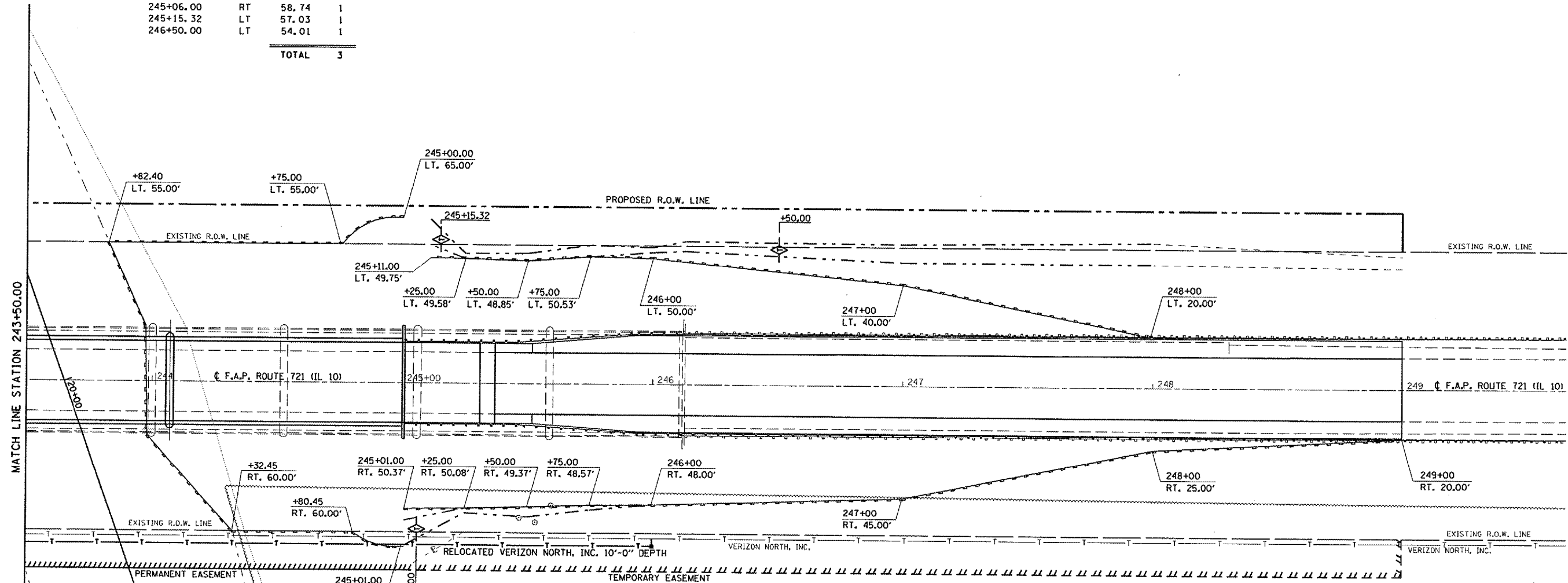

PERIMETER EROSION BARRIER

STATION	OFFSET	STATION	OFFSET	FOOT
243+82.40	55.00 LT	244+32.45	60.00 RT	132.00
243+82.40	55.00 LT	244+75.00	55.00 LT	93.00
244+32.45	60.00 RT	244+80.45	60.00 RT	48.00
244+75.00	55.00 LT	245+00.00	65.00 LT	29.00
244+80.45	60.00 RT	245+01.00	65.00 RT	22.00
245+11.00	49.75 LT	245+25.00	49.58 LT	15.00
245+01.00	50.37 RT	245+25.00	50.08 RT	25.00
245+25.00	49.58 LT	245+50.00	48.85 LT	26.00
245+25.00	50.08 RT	245+50.00	49.37 RT	26.00
245+50.00	48.85 LT	245+75.00	50.53 LT	26.00
245+50.00	49.37 RT	245+75.00	48.57 RT	26.00

PERIMETER EROSION BARRIER

STATION	OFFSET	STATION	OFFSET	FOOT
245+75.00	50.53 LT	246+00.00	50.00 LT	26.00
245+75.00	48.57 RT	246+00.00	48.00 RT	26.00
246+00.00	50.00 LT	247+00.00	40.00 LT	101.00
246+00.00	48.00 RT	247+00.00	45.00 RT	101.00
247+00.00	40.00 LT	248+00.00	20.00 LT	102.00
247+00.00	45.00 RT	248+00.00	25.00 RT	102.00
248+00.00	25.00 RT	249+00.00	20.00 RT	101.00
TOTAL				1,027.00

PLOT DATE = 10/12/2007
 FILE NAME = c:\p\projects\0503002\08\70232\er-rosion.dgn
 PLOT SCALE = 42.0529 / IN.
 USER NAME = collierb

1 -REVISED SHEET 10/15/07

ILLINOIS DEPARTMENT OF TRANSPORTATION
EROSION CONTROL PLAN
 F.A.P. ROUTE 721 (IL 10)
 SECTION (113BRIBR
 DEWITT COUNTY
 Sheet 2 of 2

SCALE: 1" = 20'
 DATE: 07/03/07

DRAWN BY: B.B.P.
 CHECKED BY: R.M.N.