

STATE OF ILLINOIS  
DEPARTMENT OF TRANSPORTATION

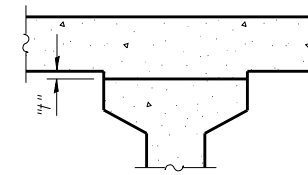

ROUTE NO.	SECTION	COUNTY	TOTAL SHEETS	SHEET NO.
F.A.P. 721	(113BR) BR	DEWITT	81	27
FED. ROAD DIST. NO. 7	ILLINOIS	FED. AID PROJECT		

SHEET NO. 2  
18 SHEETS

Contract #70232

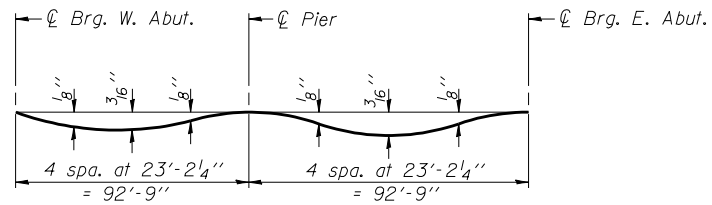

**DEAD LOAD DEFLECTION DIAGRAM**

(Includes weight of concrete only.)

Note:  
The above deflections are not to be used in the field if the engineer is working from the grade elevations adjusted for dead load deflections and grinding as shown on sheet 3 of 18.

To determine "t": After all precast prestressed beams have been erected, elevations of the top flanges of the beams shall be taken at intervals shown below. These elevations subtracted from the "Theoretical Grade Elevations Adjusted for Dead Load Deflections and grinding" shown on sheet 3 of 18, minus the \*7<sup>3</sup>/<sub>4</sub>" deck thickness, equals the fillet heights "t" above top flanges of beams. The slab is to be ground after curing to achieve smoothness, but the slab is not to be ground to elevations below the "Theoretical Grade Elevations" shown on sheet 3 of 18. For grinding the deck, See Special Provisions.

**FILLET HEIGHTS**

\*Prior to Grinding

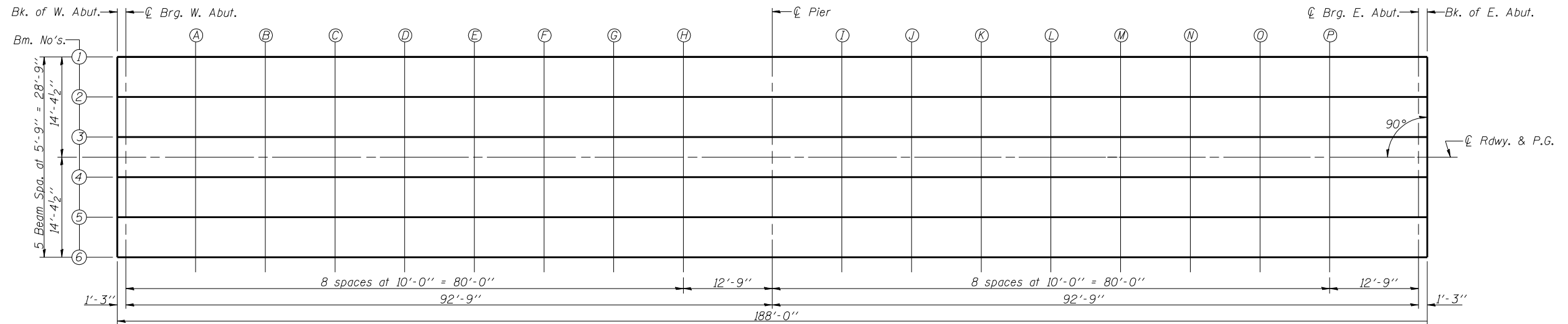

**PLAN**

DESIGNED	Phillip R. Litchfield
CHECKED	Nick R. Barnett
DRAWN	R. Sommer
CHECKED	P.R.L./N.R.B.

September 6, 2007	EXAMINED	Thomas J. Domagala
	PASSED	Ralph E. Anderson
		ENGINEER OF BRIDGES AND STRUCTURES

**TOP OF SLAB ELEVATIONS**  
F.A.P. ROUTE 721 - SECTION (113BR)BR  
DEWITT COUNTY  
STATION 244+07.00  
STRUCTURE NO. 020-0062