

STATE OF ILLINOIS
DEPARTMENT OF TRANSPORTATION

SHEET 4
OF 12

F.A.P. RTE.	SECTION	COUNTY	TOTAL SHEETS	SHEET NO.
693	120B	MCLEAN	31	15
FED. ROAD DIST. NO.		ILLINOIS	FED. AID PROJECT	
CONTRACT NO. 70518				

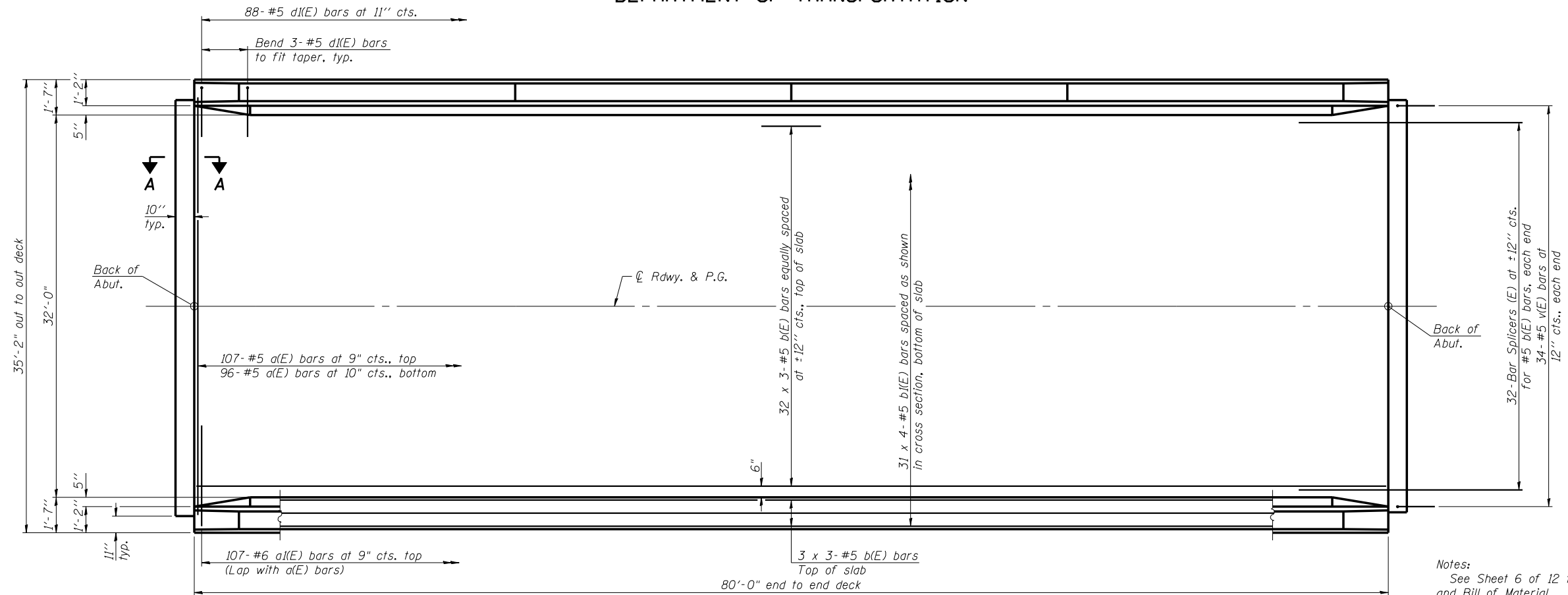

MIN. BAR LAP
#5 Bar = 2'-2"

Notes:
See Sheet 6 of 12 for superstructure details and Bill of Material.
Bars indicated thus 20 x 3-#5 etc. indicates 20 lines of bars with 3 lengths per line.
See Sheet 6 of 12 for parapet reinforcement.

PLAN

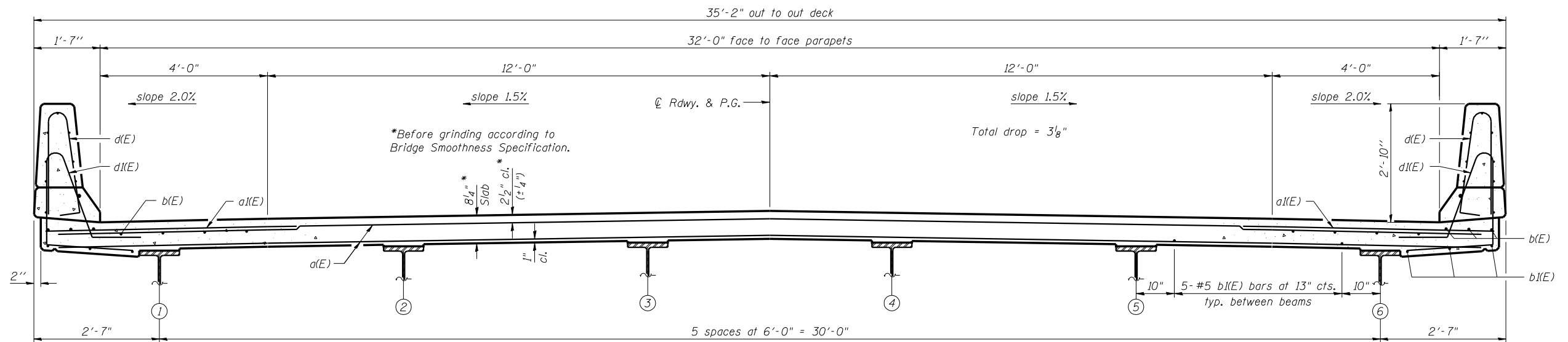

CROSS SECTION
(Looking East)

SUPERSTRUCTURE
FAP 693 (IL 9) OVER
WEST FORK SUGAR CREEK
FAP ROUTE 693 SECTION 120B
MCLEAN COUNTY
STATION 1209+03.00
STRUCTURE NO. 057-0242

JD Johnson, Depp & Quisenberry
CONSULTING ENGINEERS
Springfield, Illinois

DESIGNED: CDB	DRAWN: SJS
CHECKED: DCD	CHECKED: CDB/DCD

SI-1-0

11-1-06

DATE: 8/13/2007 - \$TIME\$ FILE: \$FILE\$ USER: collierbw