

F.A.P. RTE.	SECTION	COUNTY	TOTAL SHEETS	SHEET NO.
304	2(B-5,B-6)	PIKE	112	1

+4
116

STATE OF ILLINOIS
DEPARTMENT OF TRANSPORTATION
DIVISION OF HIGHWAYS

**PROPOSED
HIGHWAY PLANS**

FAP ROUTE 304 (ILL RTE 96)
SECTION 2(B-5,B-6)
PROJECT: ACF-0304 (033)
PIKE COUNTY
BREWSTER CREEK AND BROWN CREEK
BRIDGE REPLACEMENTS

FOR INDEX OF SHEETS, SEE SHEET NO. 2

LIST OF STANDARDS

- 000001-04
- 280001-03
- 420401-05
- 442201-02
- 515001-02
- 542301-01
- 601101
- 602301-01
- 602401-01
- 602601-01
- 602701-01
- 604036-01
- 606201-01
- 630001-07
- 630301-04
- 631031-06
- 635006-02
- 635011-01
- 666001
- 701001-01
- 701006-02
- 701011-01
- 701201-02
- 701301-02
- 701306-01
- 701321-08
- 701326-02
- 702001-06
- 704001-03
- 780001-01
- 781001-02
- 886001
- BLR 21-6

886001

DESIGN STANDARDS

ROADWAY CLASSIFICATION - STATE HIGHWAY
2005 ADT - 1,100
2025 ADT - 1,260
DESIGN SPEED - 60 MPH
POSTED SPEED - 55 MPH
DESIGN GUIDELINES - RURAL

UTILITY COMPANIES

ELECTRIC - AMERENCIPS
GAS - NICOR
WATER - PIKE COUNTY
WATER DISTRICT
TELEPHONE - VERIZON

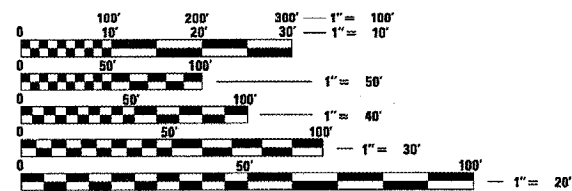

FULL SIZE PLANS HAVE BEEN PREPARED USING STANDARD ENGINEERING SCALES. REDUCED SIZED PLANS WILL NOT CONFORM TO STANDARD SCALES. IN MAKING MEASUREMENTS ON REDUCED PLANS, THE ABOVE SCALES MAY BE USED.

J. U. L. I. E.
JOINT UTILITY LOCATION INFORMATION FOR EXCAVATION
1-800-892-0123

CONTRACT NO. 72891

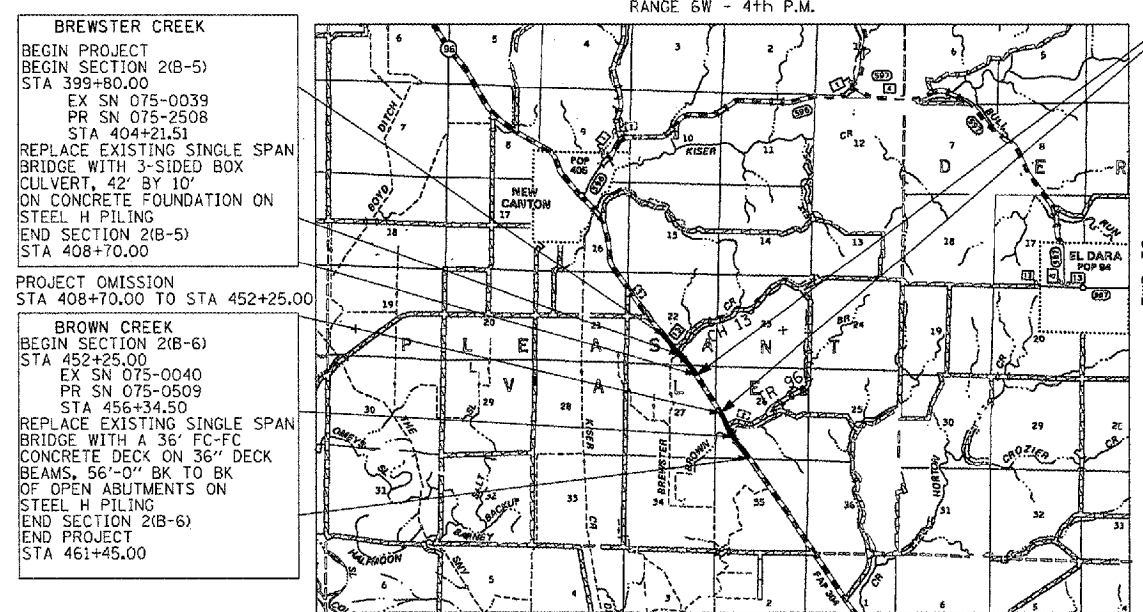
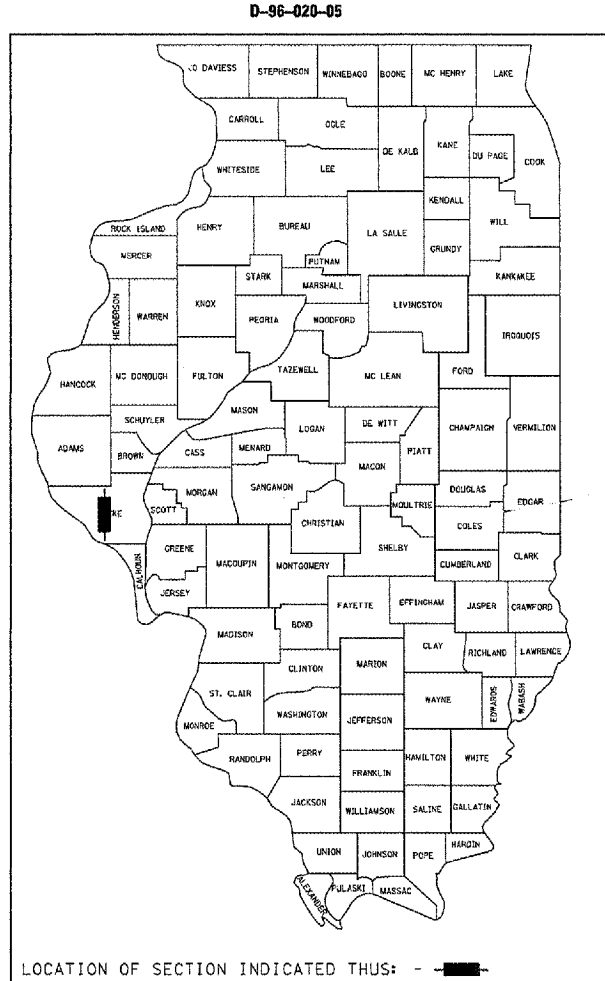

BREWSTER CREEK
BEGIN PROJECT
BEGIN SECTION 2(B-5)
STA 399+80.00
EX SN 075-0039
PR SN 075-2508
STA 404+21.51
REPLACE EXISTING SINGLE SPAN
BRIDGE WITH 3-SIDED BOX
CULVERT, 42' BY 10'
ON CONCRETE FOUNDATION ON
STEEL H PILING
END SECTION 2(B-5)
STA 408+70.00

PROJECT OMISSION
STA 408+70.00 TO STA 452+25.00

BROWN CREEK
BEGIN SECTION 2(B-6)
STA 452+25.00
EX SN 075-0040
PR SN 075-0509
STA 456+34.50
REPLACE EXISTING SINGLE SPAN
BRIDGE WITH A 36' FC-FC
CONCRETE DECK ON 36" DECK
BEAMS, 56'-0" BK TO BK
OF OPEN ABUTMENTS ON
STEEL H PILING
END SECTION 2(B-6)
END PROJECT
STA 461+45.00

LENGTH OF PROJECT

TOTAL LENGTH = 6,165.00 FEET = 1.168 MILES OF PROJECT
LENGTH OF SECTION 2(B-5) = 890.00 FEET = 0.169 MILES
LENGTH OF OMISSION = 4355.00 FEET = 0.825 MILES
LENGTH OF SECTION 2(B-6) = 920.00 FEET = 0.174 MILES
NET LENGTH OF IMPROVEMENT = 1,810.00 FEET = 0.343 MILES

LOCATION MAP

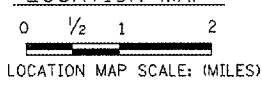

THIS SEAL COVERS SHEETS 1-49 AND 75-112

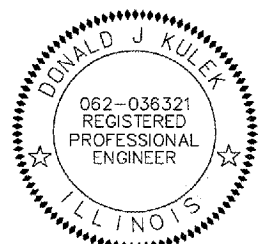

THIS SEAL COVERS SHEETS 50-74

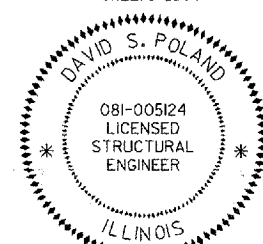

DONALD J. KULEK
LICENSED PROFESSIONAL ENGINEER
QUINCY, ILLINOIS
EXPIRES: 11/30/07
DAVID S. POLAND
LICENSED STRUCTURAL ENGINEER
QUINCY, ILLINOIS
EXPIRES: 11/30/08

Paul Kulek 9/26/07 DATE
David Poland 9-26-07 DATE

STATE OF ILLINOIS
DEPARTMENT OF TRANSPORTATION
DIVISION OF HIGHWAYS

SUBMITTED Sept 28, 2007
Eric E. Harau
Deputy Director of Highways, Region 4 Engineer
October 12, 2007
Eric E. Harau
Interim Engineer of Design and Environment
October 12, 2007
Milton R. Seep, P.E.
Director of Highways, Chief Engineer

PRINTED BY THE AUTHORITY OF THE STATE OF ILLINOIS

Rev.

PROJECT ENGINEER: JOHN NEGANGARD (217) 782-6990
SENIOR SQUAD LEADER: MIKE HIRSCH (217) 782-8693