

F.A.P. RTE.	SECTION	COUNTY	TOTAL SHEETS	SHEET NO.
304	2(B-5,B-6)	PIKE	112	26
STA. 452+00		TO STA.460+00		
FED. ROAD DIST. NO.	ILLINOIS	FED. AID PROJECT		

PROP. CURVE S001  
 PI STA. = 10+53.96  
 $\Delta = 14^\circ 28' 24''$  (RT)  
 D = 52' 06" 08"  
 R = 109.97'  
 T = 13.96'  
 L = 27.78'  
 E = 0.88'  
 P.C. STA. = 10+40.00  
 P.T. STA. = 10+67.78

EXIST. CURVE 1  
 PI STA. = 466+00.00  
 $\Delta = 13^\circ 44' 00''$  (LT)  
 D = 1' 21' 00"  
 R = 4,244.23'  
 T = 511.10'  
 L = 1,017.31'  
 e = 30.66'  
 e = 0.025 ft/ft  
 S.E. RUN = 80  
 P.C. STA. = 460+88.90  
 P.T. STA. = 471+06.21

BM-CHISLED SQUARE ON  
 SOUTHWEST WINGWALL  
 OF BRIDGE 075-0040  
 ELEV 494.80

PROP. CURVE CUR.STREAM1  
 PI STA. = 9+64.96  
 $\Delta = 23^\circ 54' 03''$  (RT)  
 D = 57' 35' 05"  
 R = 99.50'  
 T = 21.06'  
 L = 41.51'  
 E = 2.20'  
 P.C. STA. = 9+43.90  
 P.T. STA. = 9+85.41

PROP. CURVE S002-2  
 PI STA. = 9+49.95  
 $\Delta = 71^\circ 01' 03''$  (RT)  
 D = 127' 19' 26"  
 R = 45.00'  
 T = 32.11'  
 L = 55.78'  
 E = 10.28'  
 P.C. STA. = 9+17.85  
 P.T. STA. = 9+73.62

PROP. CURVE S002-1  
 PI STA. = 8+86.50  
 $\Delta = 53^\circ 25' 44''$  (LT)  
 D = 81' 51' 04"  
 R = 70.00'  
 T = 35.23'  
 L = 65.28'  
 E = 8.36'  
 P.C. STA. = 8+51.27  
 P.T. STA. = 9+16.55

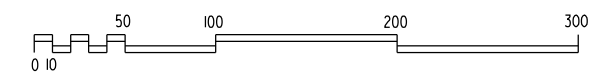
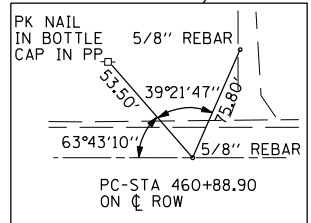
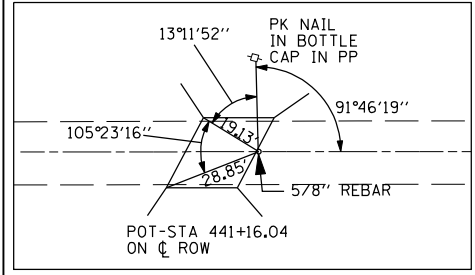

BROWN CREEK

REVISIONS	
NAME	DATE

ILLINOIS DEPARTMENT OF TRANSPORTATION  
 HORIZONTAL AND VERTICAL CONTROL  
 BROWN CREEK  
 SCALE: VERT. / HORIZ.  
 DATE: / / DRAWN BY: / CHECKED BY: /

PLOT DATE = 7/31/2007  
 FILE NAME = c:\p\projects\652484\paba\_r\m01\m075-8048\control\br-cm.dgn  
 PLOT SCALE = 1/85,8824 / IN.  
 USER NAME = laughlin-1