

STATE OF ILLINOIS  
DEPARTMENT OF TRANSPORTATION

ROUTE NO.	SECTION	COUNTY	TOTAL SHEETS	SHEET NO.	SHEET NO. 5 14 SHEETS
F.A.P. 751	101B-2	PIKE	48	30	
FED. ROAD DIST. NO. 7	ILLINOIS	FED. AID PROJECT			

Contract #72928

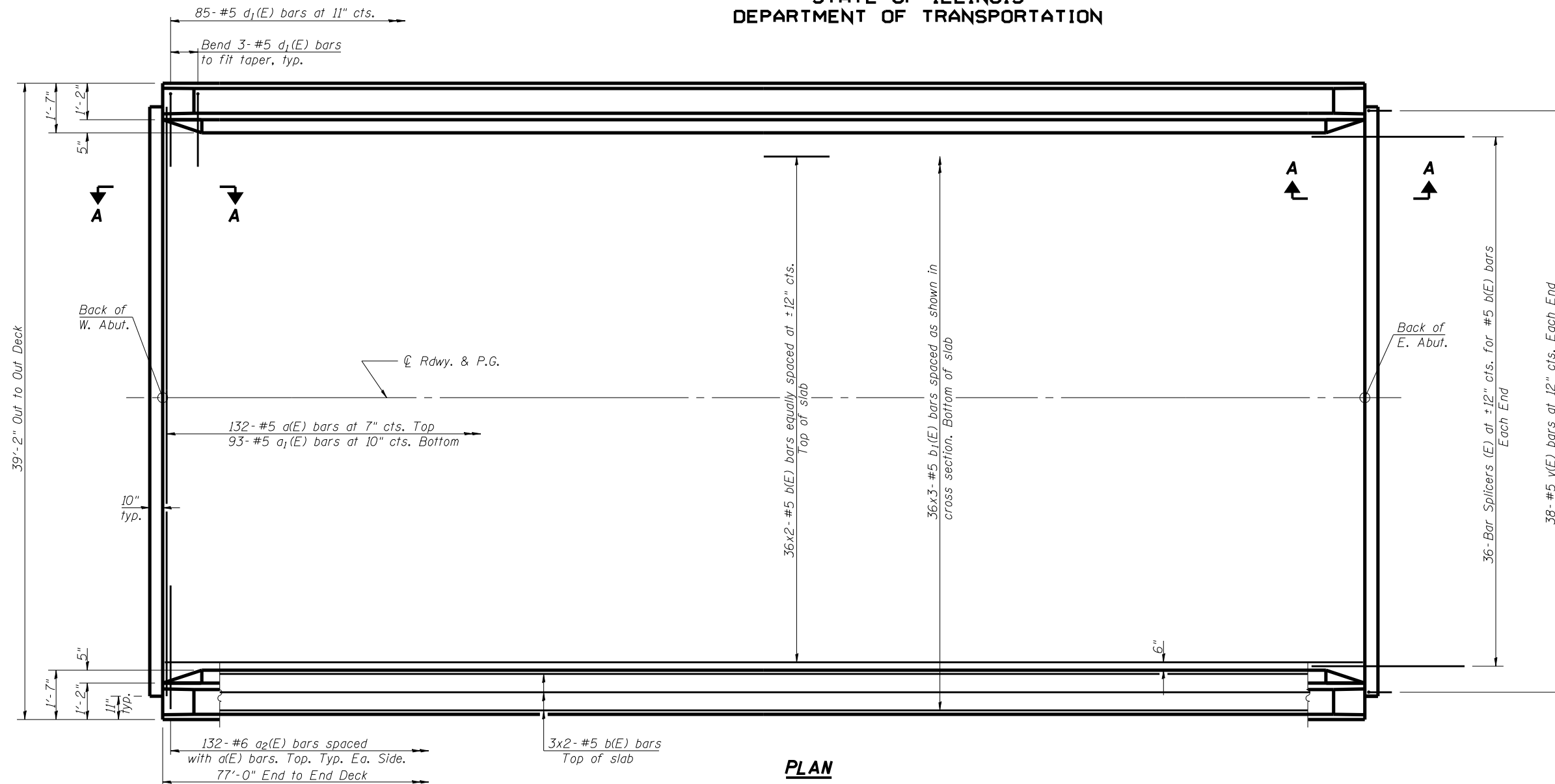

**PLAN**

Notes:  
See Sheet 6 of 14 for superstructure details and Bill of Material.  
Bars indicated thus 3 x 2-#5 etc. indicates 3 lines of bars with 2 lengths per line.  
See Sheet 6 of 14 for parapet reinforcement.  
See Sheet 7 of 14 for Sec. A-A

**MIN. BAR LAP**  
#5 bar = 2'-2"

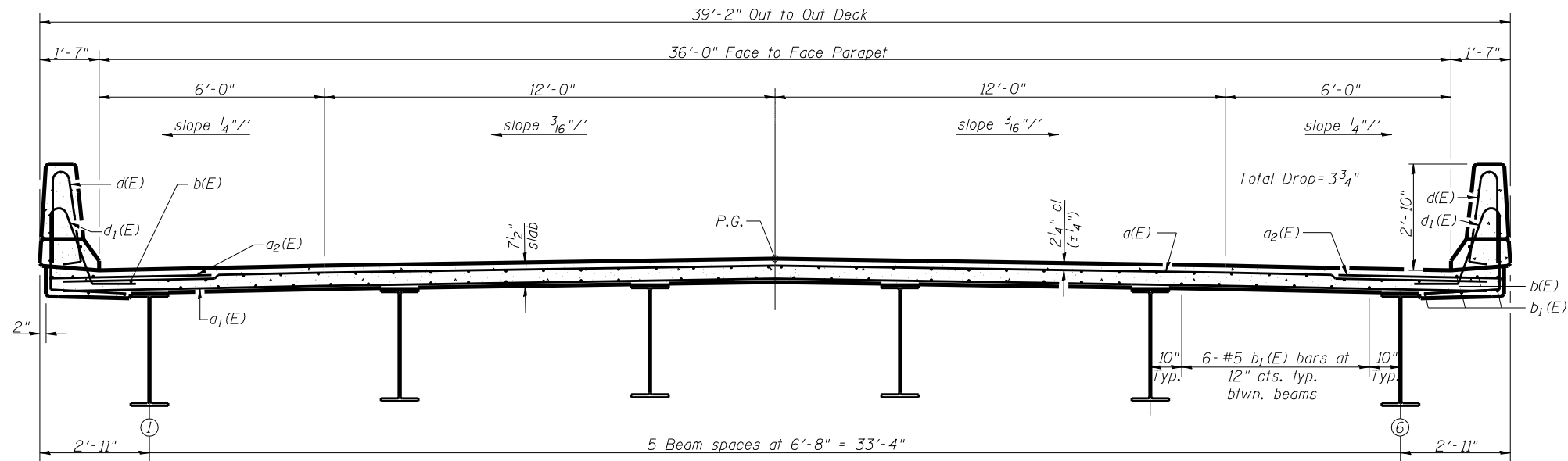

**CROSS SECTION**  
(Looking East)

DESIGNED Nicholas R. Barnett  
CHECKED Phillip R. Litchfield  
DRAWN Greg D. Farmer  
CHECKED NRB/PRL

August 30, 2007  
EXAMINED Thomas J. Damagalli  
PASSED Ralph E. Anderson  
ENGINEER OF BRIDGE DESIGN  
ENGINEER OF BRIDGES AND STRUCTURES

**SUPERSTRUCTURE**  
F.A.P. RT. 751 SEC. 101B-2  
PIKE COUNTY  
STATION 381+00.00  
STRUCTURE NO. 075-0507