

F.A.P. RTE.	SECTION	COUNTY	TOTAL SHEETS	SHEET NO.
753	142BR-4	SANGAMON	24	13
FED. ROAD DIST. NO. ILLINOIS FED. AID PROJECT				

STEEL PLATE BEAM GUARDRAIL,
SHORT RADIUS TYPICAL DETAIL

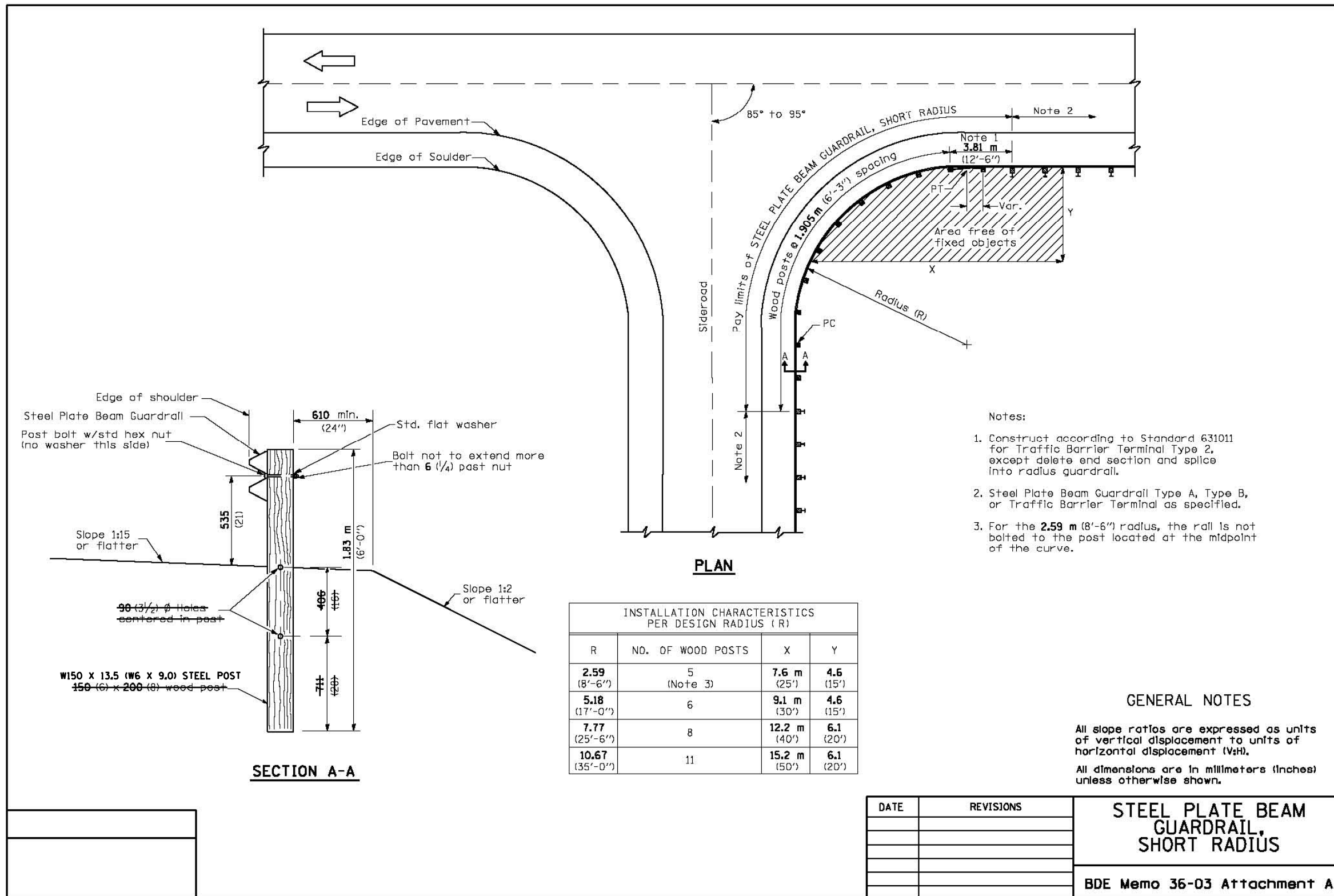

DATE	
BY	
PLAN	
SURVEYED	
ALIGNED	
CHECKED	
RT. OF WAY CHECKED	
NO. OF WAY CHECKED	
NO.	
FILE NAME	

DATE	
BY	
PROFILE	
SURVEYED	
GRADES	
CHECKED	
B.M. NOTED	
STRUCTURE NOTATIONS	
NO.	
FILE NAME	

PLOT DATE = Aug-18-2007 07:50:08AM
 FILE NAME = c:\p\projects\0651007\kpluseng_fme\13.gr_dtaht
 PLOT SCALE = 41.8823 / IN.
 USER NAME = laughtlin1

K+ K-Plus Engineering, Ltd.
 753 WINDSOR ROAD
 CHARLESTON, IL 61920
 (217) 348-1900
 WWW.K-PLUSENGINEERING.LTD.COM
 ILLINOIS DEPARTMENT OF PROFESSIONAL REGULATION REGISTRATION #184-003685

ILLINOIS DEPARTMENT OF TRANSPORTATION
**STEEL PLATE BEAM GUARDRAIL,
 SHORT RADIUS
 TYPICAL DETAIL**
 FAP 753 (IL RTE. 104)
 OVER HORSE CREEK
 SECTION 142BR-4
 SANGAMON COUNTY

DATE: 08-01-07
 DRAWN BY: ADG
 CHECKED BY: DC