

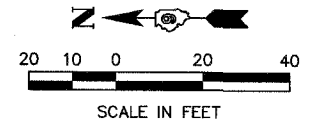

CONTRACT NO. 78010

FAP RTE	SECTION	COUNTY	TOTAL SHEETS	SHEET NO.
132	1BR-1	SALINE	114	12
STA. 99+35		TO STA. 105+64		
FED. ROAD DIST. NO.		ILLINOIS FED. AID PROJECT		

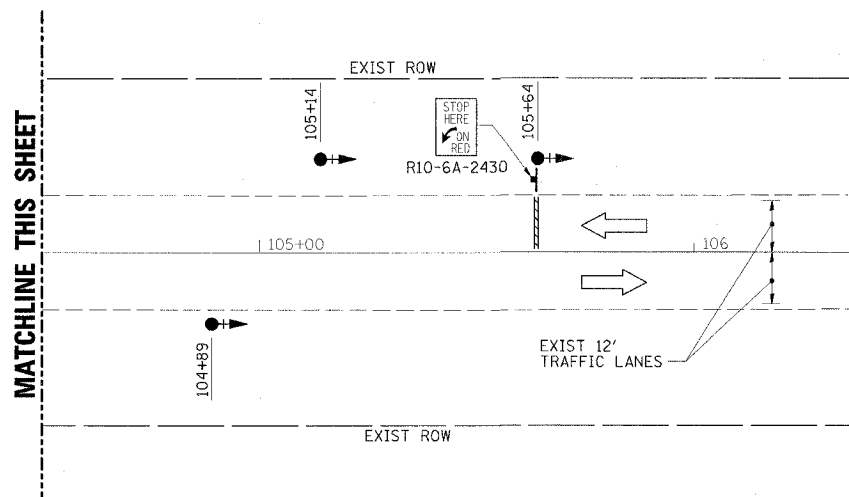
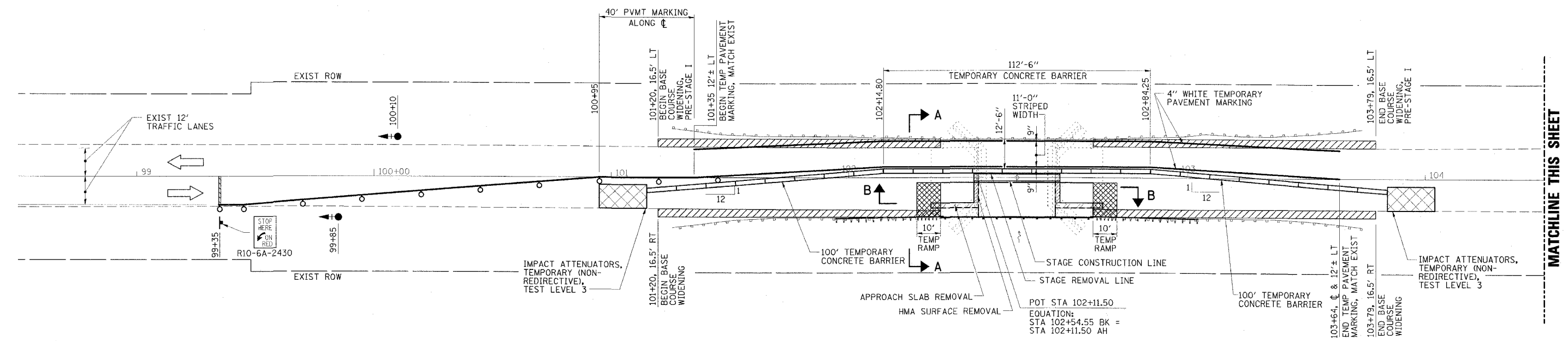

- LEGEND**
- TRAFFIC SIGNAL WITH BACKPLATE SIGNAL DIRECTION INDICATED
 - BASE COURSE WIDENING, 10"
 - TEMPORARY RAMP
 - HMA SURFACE REMOVAL, SPECIAL
 - APPROACH SLAB REMOVAL

SCHEDULE OF QUANTITIES

TEMPORARY CONCRETE BARRIER	STATION TO	STATION	FEET
	101+15	103+84	312.5
			TOTAL 312.5

- TEMPORARY BRIDGE TRAFFIC SIGNALS - 1 EACH
- TEMPORARY RUMBLE STRIPS - 6 EACH
- IMPACT ATTENUATORS, TEMPORARY (NON-REDIRECTIVE), TEST LEVEL 3 - 2 EACH

GENERAL NOTES

1. TRAFFIC CONTROL SHALL BE ERECTED AS SHOWN AND ACCORDING TO "TRAFFIC CONTROL AND PROTECTION, STANDARD 701321."
2. SEE SPECIAL PROVISIONS FOR ADDITIONAL TRAFFIC CONTROL REQUIREMENTS.
3. COORDINATE LOCATION OF SIGNALS WITH FINAL WORK AS DIRECTED BY THE ENGINEER.
4. CONSTRUCT TEMPORARY RUMBLE STRIPS AT LOCATIONS SHOWN ON STANDARD 701321.

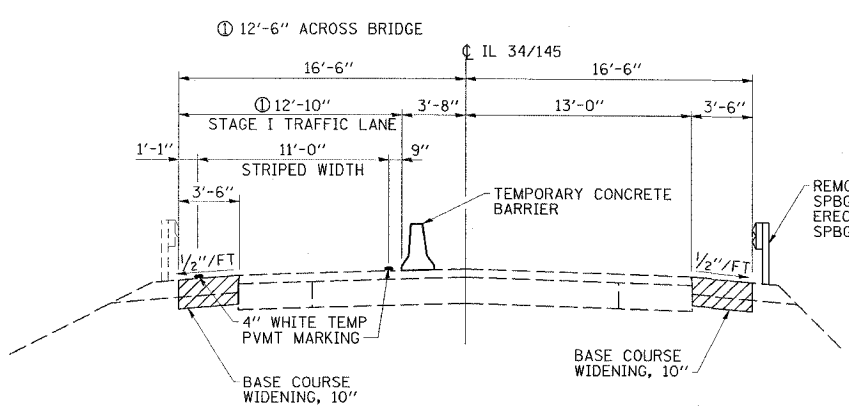

SECTION A-A

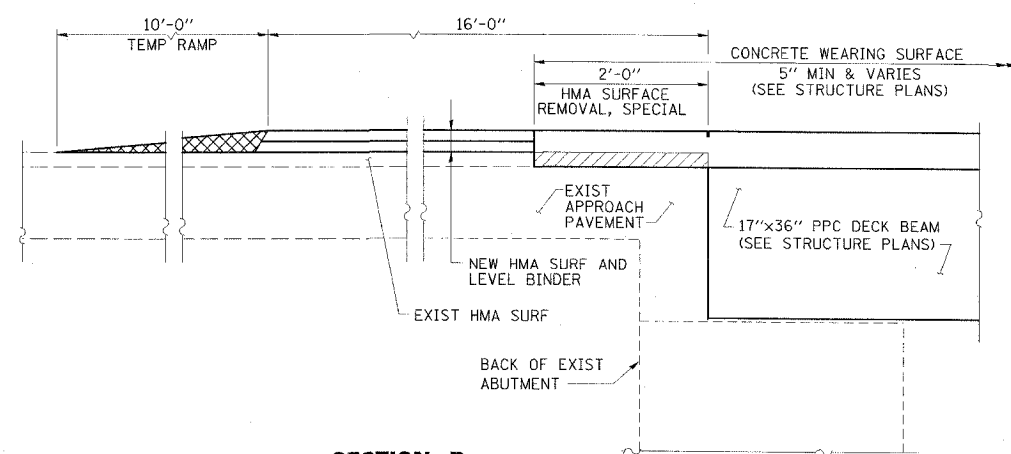

SECTION B-B

STAGE I CONSTRUCTION
IL 34/145 OVER BRIER CREEK
FAP ROUTE 132 - SECTION 1BR-1
SALINE COUNTY
STATION 102+28.00
STRUCTURE NO. 083-0018

ESCA
CONSULTANTS, INC.

DESIGNED BY:	JMS/MTD	05/07
DRAWN BY:	cj	05/07
CHECKED BY:	MTD	06/07
APPROVED BY:	RDP	06/07