

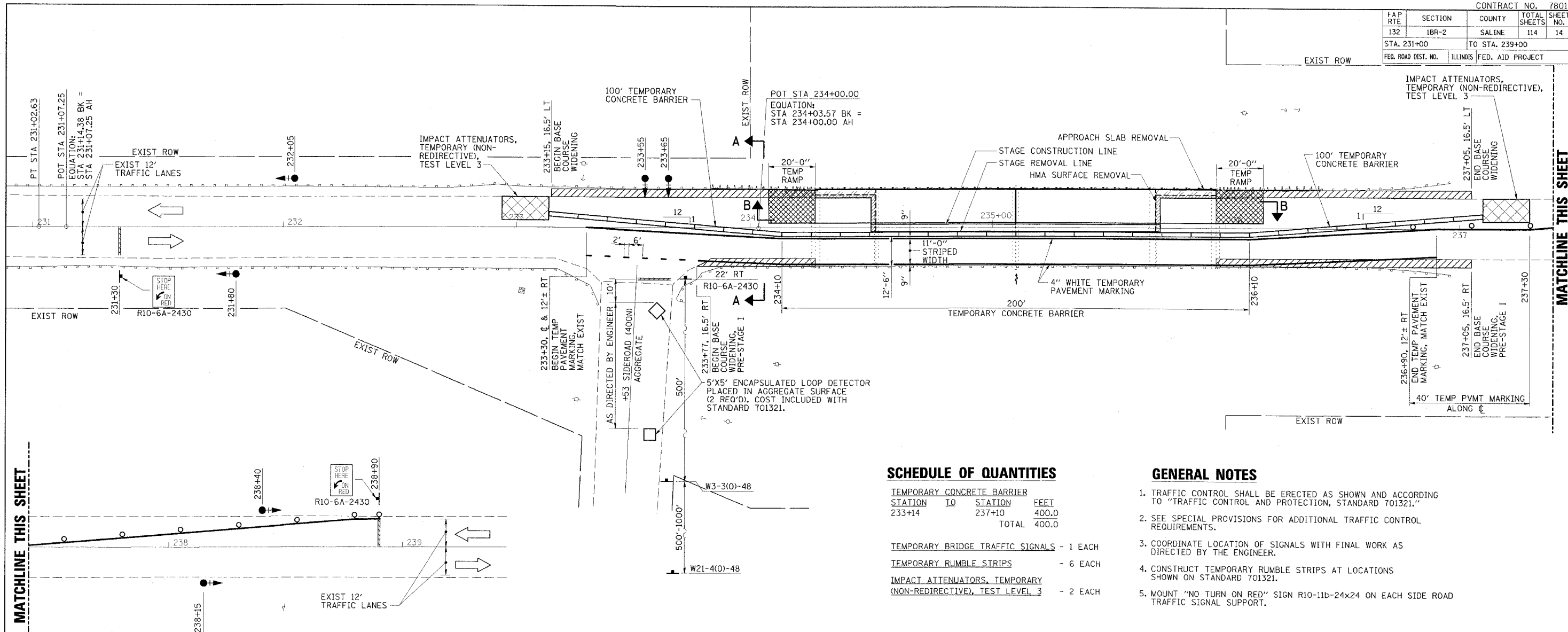

FAP RTE		SECTION	COUNTY	TOTAL SHEETS	CONTRACT NO.
132		1BR-2	SALINE	114	78010
STA. 231+00		TO STA. 239+00		TOTAL SHEET NO.	
FED. ROAD DIST. NO.		ILLINOIS	FED. AID PROJECT		



SCHEDULE OF QUANTITIES

TEMPORARY CONCRETE BARRIER	STATION	TO	STATION	FEET
	233+14		237+10	400.0
	TOTAL			400.0

TEMPORARY BRIDGE TRAFFIC SIGNALS - 1 EACH

TEMPORARY RUMBLE STRIPS - 6 EACH

IMPACT ATTENUATORS, TEMPORARY (NON-REDIRECTIVE), TEST LEVEL 3 - 2 EACH

GENERAL NOTES

1. TRAFFIC CONTROL SHALL BE ERECTED AS SHOWN AND ACCORDING TO "TRAFFIC CONTROL AND PROTECTION, STANDARD 701321."
2. SEE SPECIAL PROVISIONS FOR ADDITIONAL TRAFFIC CONTROL REQUIREMENTS.
3. COORDINATE LOCATION OF SIGNALS WITH FINAL WORK AS DIRECTED BY THE ENGINEER.
4. CONSTRUCT TEMPORARY RUMBLE STRIPS AT LOCATIONS SHOWN ON STANDARD 701321.
5. MOUNT "NO TURN ON RED" SIGN R10-11b-24x24 ON EACH SIDE ROAD TRAFFIC SIGNAL SUPPORT.

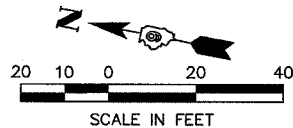

LEGEND

- TRAFFIC SIGNAL WITH BACKPLATE
SIGNAL DIRECTION INDICATED
- ▨ BASE COURSE WIDENING, 10"
- ▨ TEMPORARY RAMP
- ▨ HMA SURFACE REMOVAL, SPECIAL
- ▨ APPROACH SLAB REMOVAL

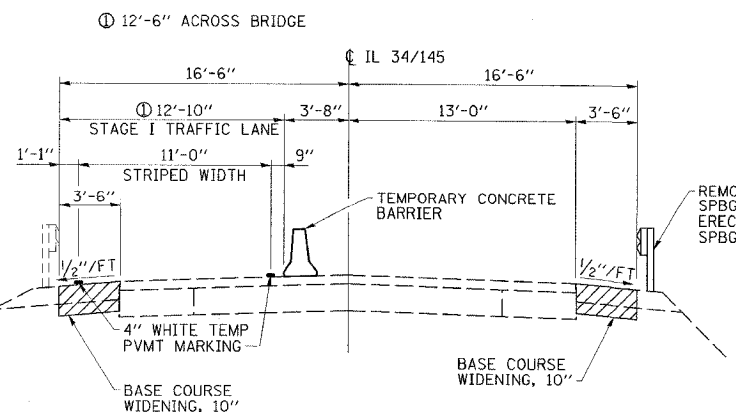

SECTION A-A

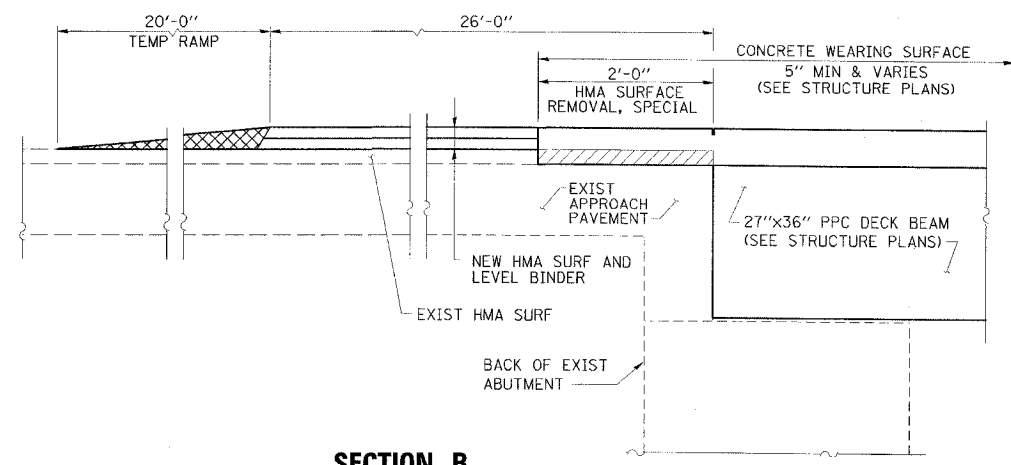

SECTION B

ESCA
CONSULTANTS, INC.

DESIGNED BY:	JMS/MTD	05/07
DRAWN BY:	cj	05/07
CHECKED BY:	MTD	06/07
APPROVED BY:	RDP	06/07

STAGE I CONSTRUCTION
IL 34/145 OVER SOUTH FORK
SALINE RIVER
FAP ROUTE 132 - SECTION 1BR-2
SALINE COUNTY
STATION 235+10.00
STRUCTURE NO. 083-0019