

|               |                |          |              |           |
|---------------|----------------|----------|--------------|-----------|
| FAU RTE.      | SECTION        | COUNTY   | TOTAL SHEETS | SHEET NO. |
| 3791          | 02-00037-00-WR | COOK     | 40           | 34        |
| E.H.W.A. REG. |                | ILLINOIS | PROJECT:     |           |
| 83957         |                |          |              |           |

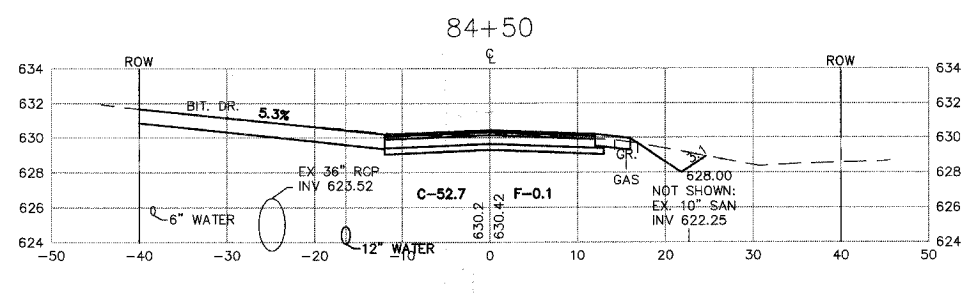
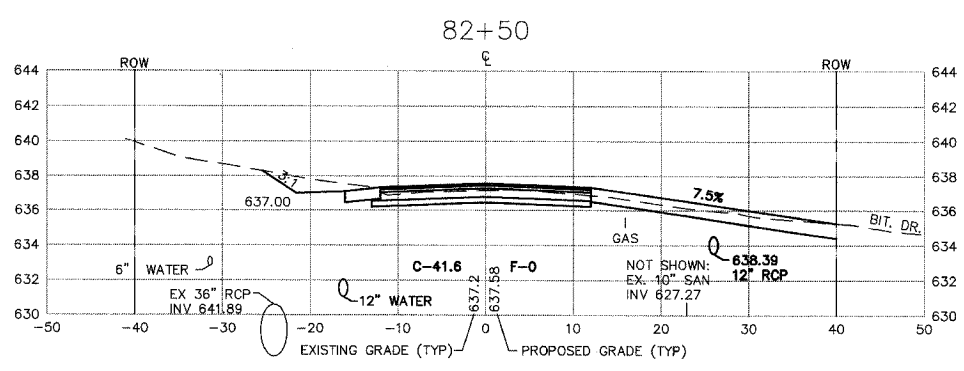
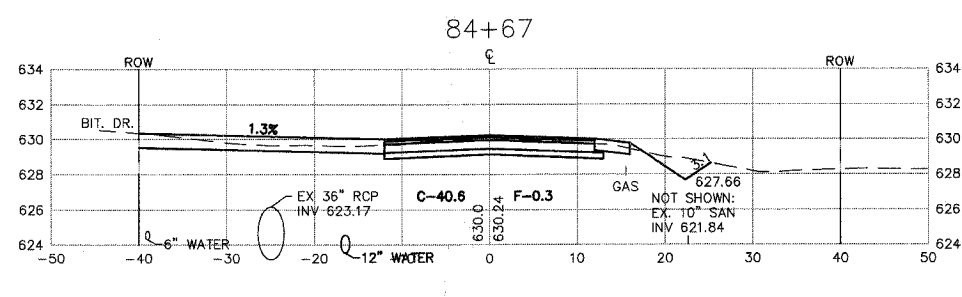
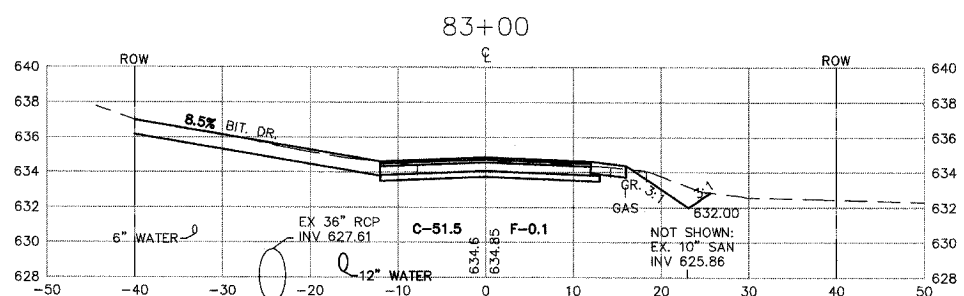
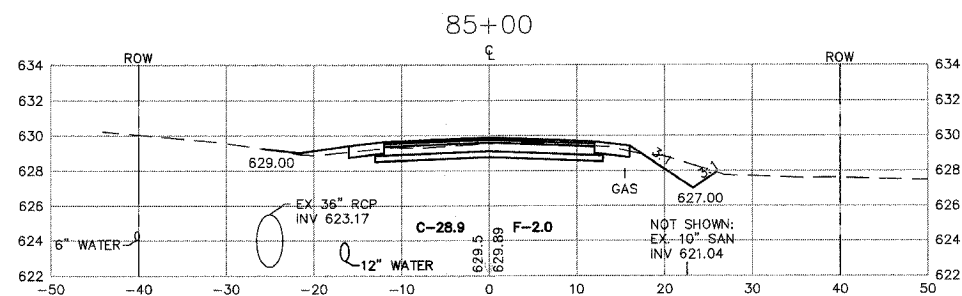
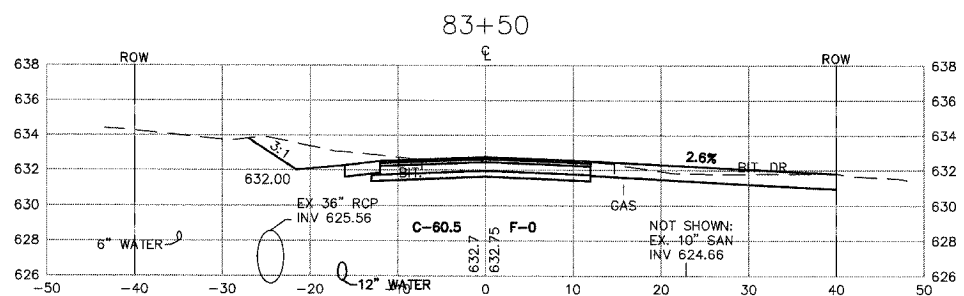
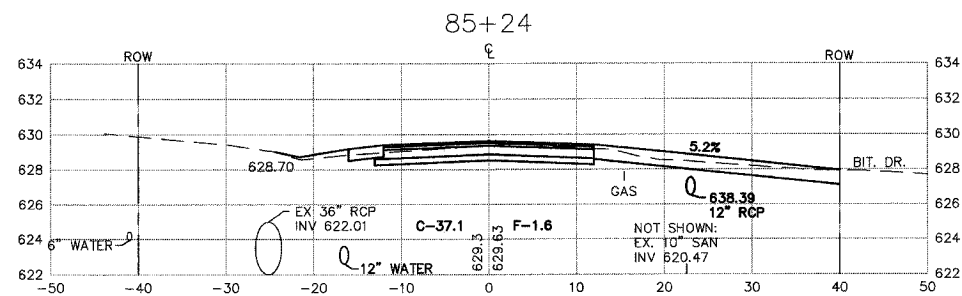
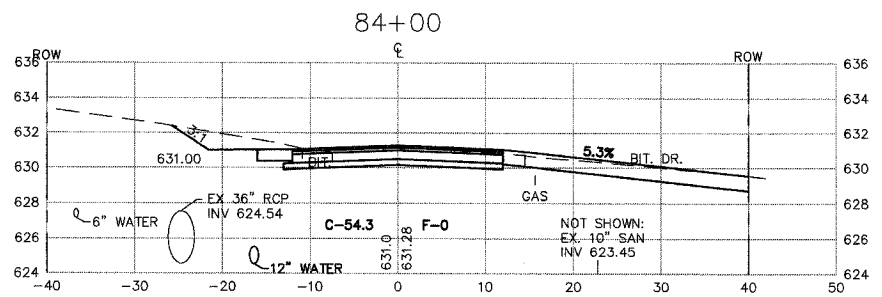
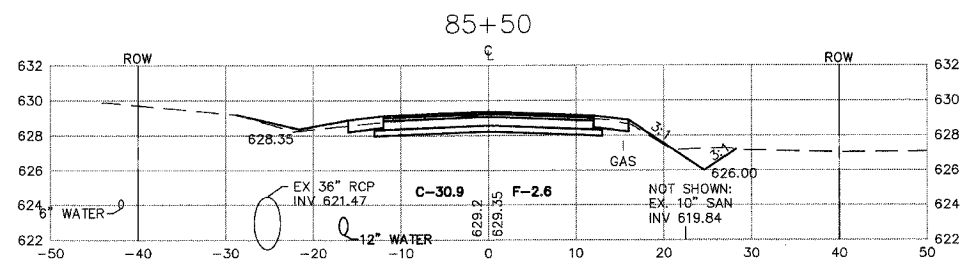
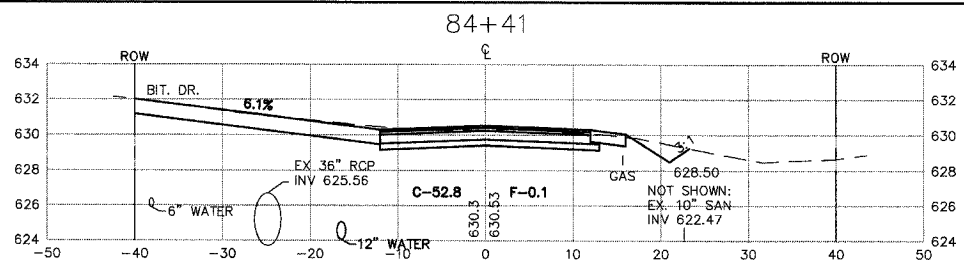

PLOT DATE: Sep 03, 2007  
 ILLINOIS: H:\04-PH\3003\PLANS-ENG\REV-3\dwg\SHEET-XSECS.dwg

# MORRIS ENGINEERING, INC.

5100 LINCOLN AVE Lisle, ILLINOIS 60532  
 PHONE: (630)271-0770 • WEBSITE: ECIVIL.COM  
 LOCATION: H:\04-PH\3003\PLANS-ENG\REV-3\dwg\SHEET-XSECS.dwg  
 DRAWN BY: CJS DESIGN BY: RAC CHECKED BY: JJV  
 JOB NO.: 04-PH-3003 SCALE: 1"=10' H 1"=5' V

## 76TH AVENUE RECONSTRUCTION 127TH STREET TO ILLINOIS ROUTE 83

### CROSS SECTIONS STA. 82+50 TO STA. 85+50

| DATE      | REVISIONS       | BY  | SHEET                     |
|-----------|-----------------|-----|---------------------------|
| 1 5-09-07 | PER IDOT REVIEW | RAC | <b>34</b><br>OF 40 SHEETS |
| 2 5-24-07 | PER IDOT REVIEW | RAC |                           |
| 3 9-04-07 | PER IDOT REVIEW | RAC |                           |
| 4         |                 |     |                           |