

FILE #	SECTION	COUNTY	TOTAL SHEETS	SHEET NO.
2744	06-00241-00-PV	COOK	115	56
STA. 113+82.50		TO STA. 153+00		
XX-XXXXX-XX-XX	BLANDS	SURFACE TRANSPORTATION FUNDING		
CONTRACT NUMBER 83968				

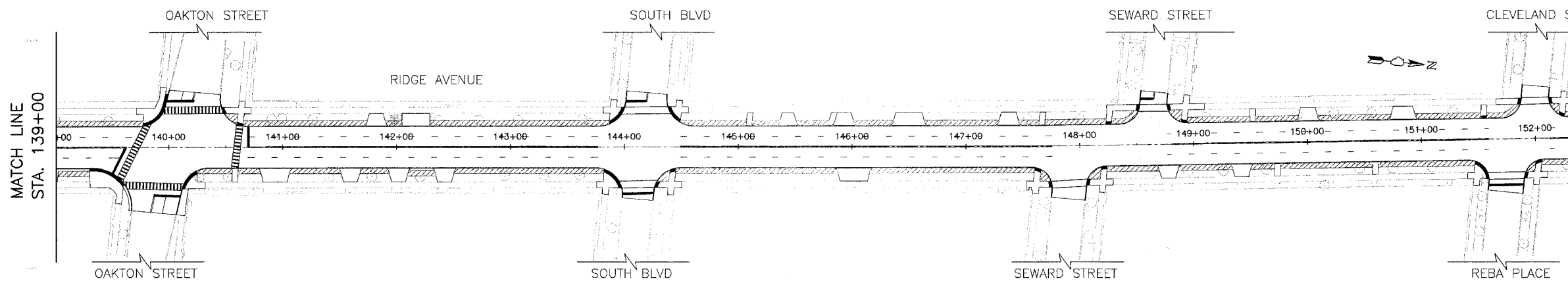
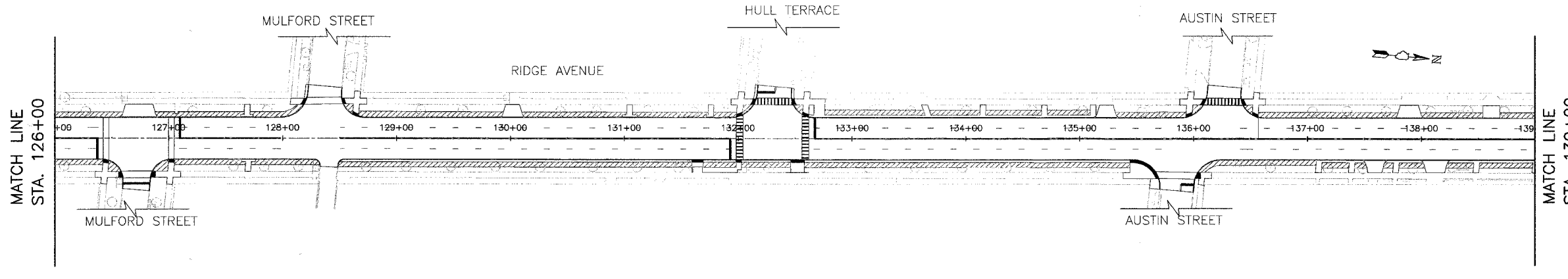
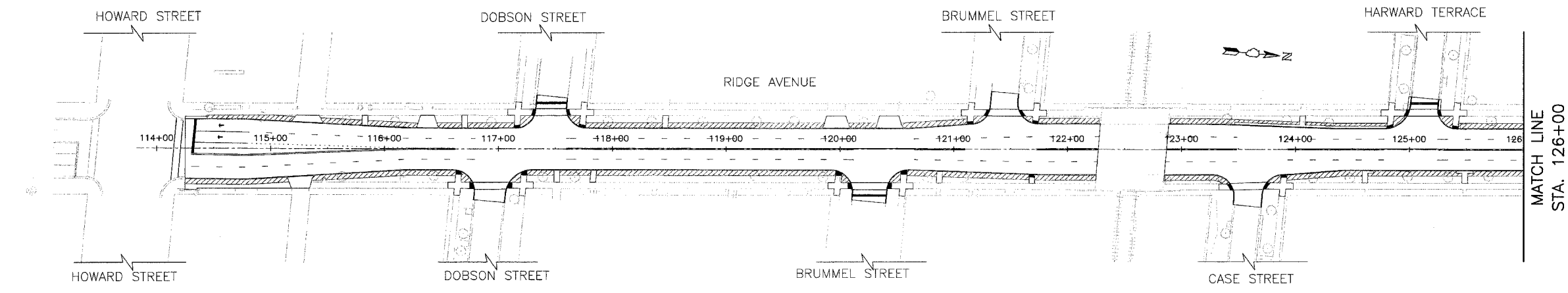

- NOTES:
- EXISTING LANDSCAPE FEATURES WHETHER MANMADE OR NATURAL, SHALL BE PROTECTED THROUGH A PROCESS OF IDENTIFICATION, ENHANCEMENT, RESTORATION, OR PRESERVATION.
 - EXISTING TRADITIONAL LOOK OF THE ENVIRONMENT SHALL BE PROTECTED.
 - ALL EXISTING TREES SHALL BE PROTECTED UNLESS OTHERWISE NOTED.
 - FOR SAFETY AND EQUIPMENT MOVEMENTS PRUNING SHALL BE DONE FOR THE EXISTING TREE BRANCHES.
 - TO PRESERVE THE EXISTING PLANTINGS THE CONTRACTOR SHALL CONSIDER THE FOLLOWING GUIDELINE:
 - ROOT PRUNING SHALL BE DONE WHERE TRENCHING OR EXCAVATION IS WITHIN THE ROOT ZONE OF ADJACENT TREES OR SHRUBS.
 - CONTRACTOR SHALL FERTILIZE FOR EXISTING PLANTINGS THAT WILL BE DISTURBED BY THE CONSTRUCTION.
 - CONTRACTOR SHALL WATER EXISTING PLANTINGS THAT WILL BE DISTURBED BY THE CONSTRUCTION.
 - CONTRACTOR SHALL PRUNE AN ENTIRE TREE TO CORRECT STRUCTURAL PROBLEM, OR IMPROVE OVERALL APPEARANCE.

- THE NEW SOD SHALL MATCH THE EXISTING SOD.
- THE SALVAGED TOP SOIL SHALL BE USED IF ACCEPTABLE OR AS DIRECTED BY THE ENGINEER.

PLAN LEGEND

	PROPOSED SODDING AREA WITH 4" TOP SOIL FERTILIZER SHALL BE APPLIED AS PER ARTICLE 252.03 OF IDOT "STANDARD SPECIFICATION", ADOPTED 2007.
	EXISTING TREE TO REMAIN IN PLACE

NO.	DATE	DESCRIPTION

CITY OF EVANSTON

LANDSCAPE PLAN

RIDGE AVENUE IMPROVEMENT

STA. 113+82.50 TO 153+00

DATE: 8/31/2007
 DESIGNED BY: RAM
 TECHNICIAN: RR
 CHECKED BY: WCM

SCALE IN FEET

50 0 50 HORIZ.