

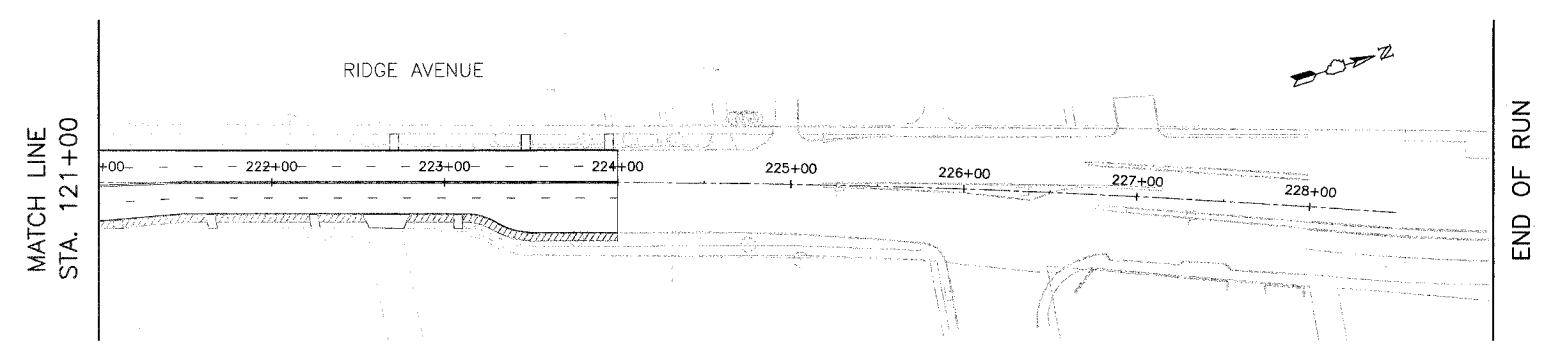

FILE#	SECTION	COUNTY	TOTAL SHEETS	SHEET NO
2744	06-00241-00-PV	COOK	115	58
STA. 192+00		TO STA. 1221+00		
XX-XXXXX-XX-XX		SURFACE TRANSPORTATION FUNDING		
CONTRACT NUMBER 83968				

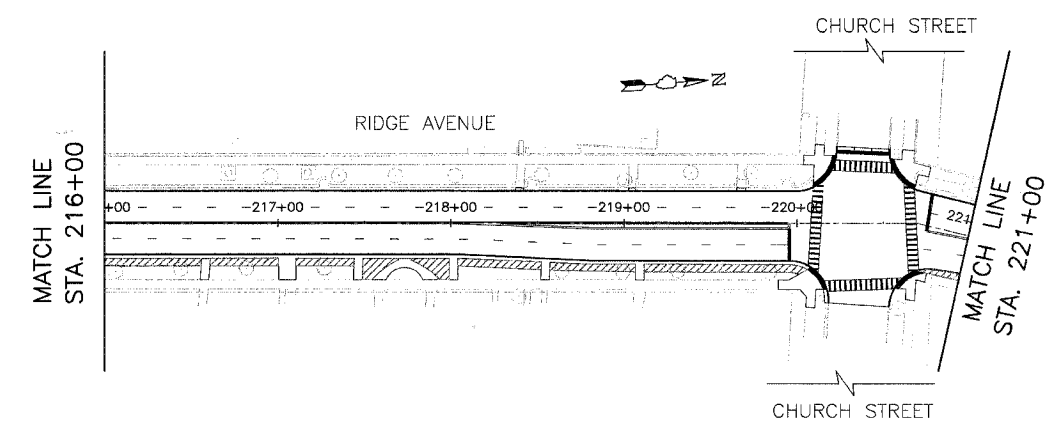
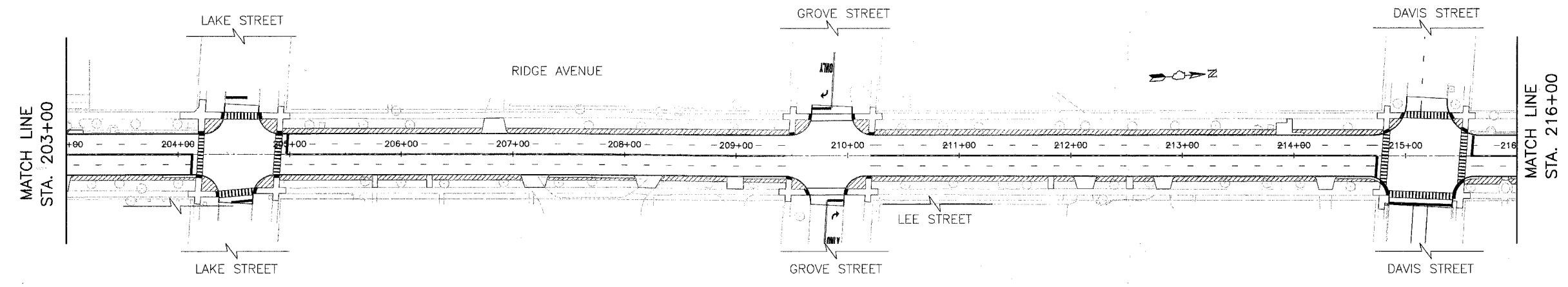
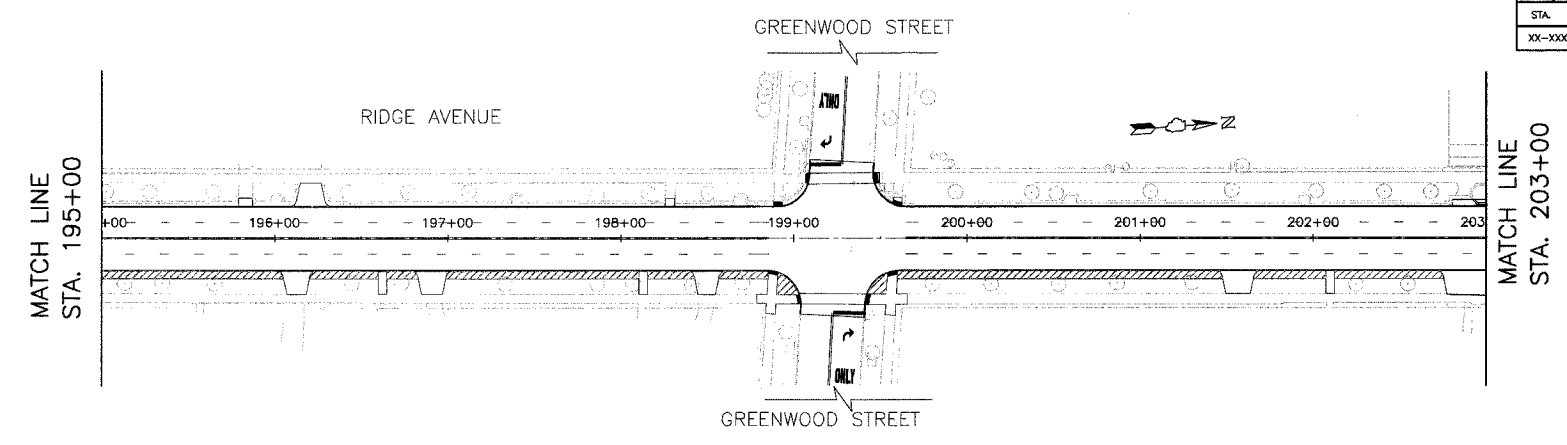
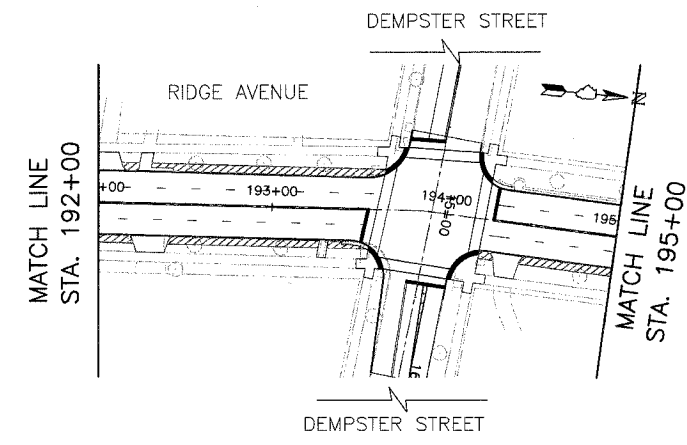

NOTES:

1. EXISTING LANDSCAPE FEATURES WHETHER MANMADE OR NATURAL, SHALL BE PROTECTED THROUGH A PROCESS OF IDENTIFICATION; ENHANCEMENT, RESTORATION, OR PRESERVATION.
2. EXISTING TRADITIONAL LOOK OF THE ENVIRONMENT SHALL BE PROTECTED.
3. ALL EXISTING TREES SHALL BE PROTECTED UNLESS OTHERWISE NOTED.
4. FOR SAFETY AND EQUIPMENT MOVEMENTS PRUNING SHALL BE DONE FOR THE EXISTING TREE BRANCHES.
5. TO PRESERVE THE EXISTING PLANTINGS THE CONTRACTOR SHALL CONSIDER THE FOLLOWING GUIDELINE:
 - A. ROOT PRUNING SHALL BE DONE WHERE TRENCHING OR EXCAVATION IS WITHIN THE ROOT ZONE OF ADJACENT TREES OR SHRUBS.
 - B. CONTRACTOR SHALL FERTILIZE FOR EXISTING PLANTINGS THAT WILL BE DISTURBED BY THE CONSTRUCTION.
 - C. CONTRACTOR SHALL WATER EXISTING PLANTINGS THAT WILL BE DISTURBED BY THE CONSTRUCTION.
 - D. CONTRACTOR SHALL PRUNE AN ENTIRE TREE TO CORRECT STRUCTURAL PROBLEM, OR IMPROVE OVERALL APPEARANCE.
6. THE NEW SOD SHALL MATCH THE EXISTING SOD.
7. THE SALVAGED TOP SOIL SHALL BE USED IF ACCEPTABLE OR AS DIRECTED BY THE ENGINEER.

PLAN LEGEND

-  PROPOSED SODDING AREA WITH 4" TOP SOIL FERTILIZER SHALL BE APPLIED AS PER ARTICLE 252.03 OF IDOT "STANDARD SPECIFICATION", ADOPTED 2007.
-  EXISTING TREE TO REMAIN IN PLACE

NO.	DATE	DESCRIPTION

CITY OF EVANSTON
LANDSCAPE PLAN
RIDGE AVENUE IMPROVEMENT
 STA. 192+00 TO 1221+00

50 0 50 HORIZ.
 SCALE IN FEET

DATE: 8/31/2007
 DESIGNED BY: RAM
 TECHNICIAN: RR
 CHECKED BY: WCM