

ROUTE NO.	SECTION	COUNTY	TOTAL SHEETS	SHEET NO.
CH 9	*	IROQUOIS	17	15
STA. 38+00.00 TO STA. 39+00.00				
FED. ROAD DIST. NO. 7	ILLINOIS	PROJECT	BRS-334(112)	
04-00052-03-BR		CONTRACT	#87557	

SURVEYED
 SURVEY
 PLOTTED
 NOTE BOOK
 PLATE
 AREA
 CHECKED
 NO.

SURVEYED
 SURVEY
 PLOTTED
 NOTE BOOK
 PLATE
 AREA
 CHECKED
 NO.

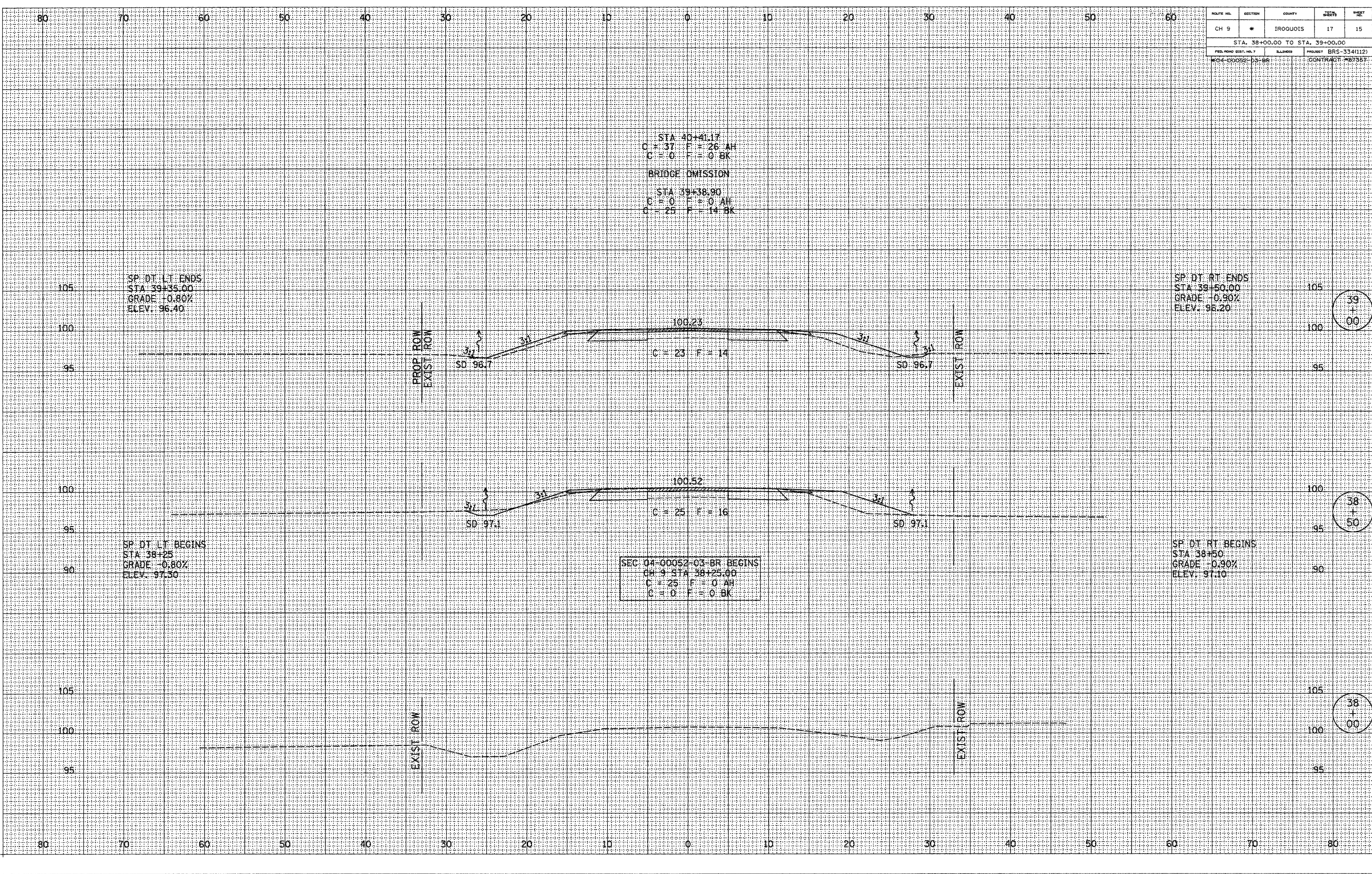

SP DT LT ENDS
 STA 39+35.00
 GRADE -0.80%
 ELEV. 96.40

SP DT RT ENDS
 STA 39+50.00
 GRADE -0.90%
 ELEV. 96.20

SP DT LT BEGINS
 STA 38+25
 GRADE -0.80%
 ELEV. 97.30

SP DT RT BEGINS
 STA 38+50
 GRADE -0.90%
 ELEV. 97.10

STA 40+41.17
 C = 37 F = 26 AH
 C = 0 F = 0 BK
 BRIDGE OMISSION
 STA 39+38.90
 C = 0 F = 0 AH
 C = 25 F = 14 BK

SEC 04-00052-03-BR BEGINS
 CH 9 STA 38+25.00
 C = 25 F = 0 AH
 C = 0 F = 0 BK

39 + 00

38 + 50

38 + 00