

Point 10 N 1,373,387.19 E 2,202,152.25

WORKING PT. 10

NOT TO SCALE

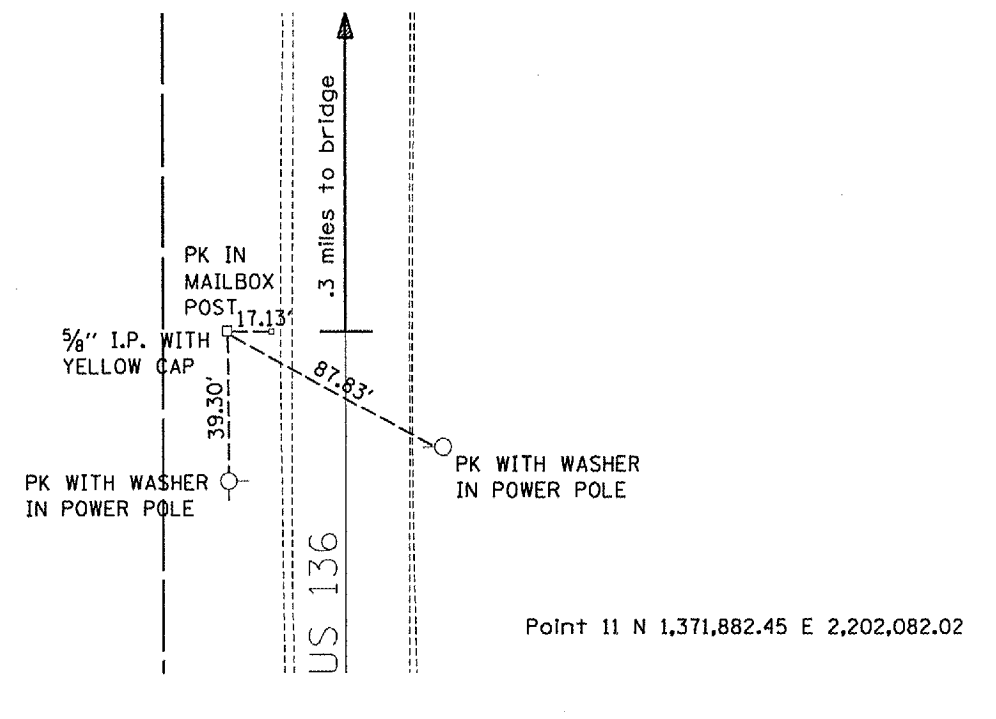

Point 11 N 1,371,882.45 E 2,202,082.02

WORKING PT. 11

NOT TO SCALE

Point 401 (POT):
N 1,374,095.38 E 2,202,140.42
Sta. 64+93.46

Point 402 (POT):
N 1,373,243.91 E 2,202,133.43
Sta. 73+44.97

Point 403 (POT):
N 1,372,438.39 E 2,202,126.83
Sta. 81+50.51

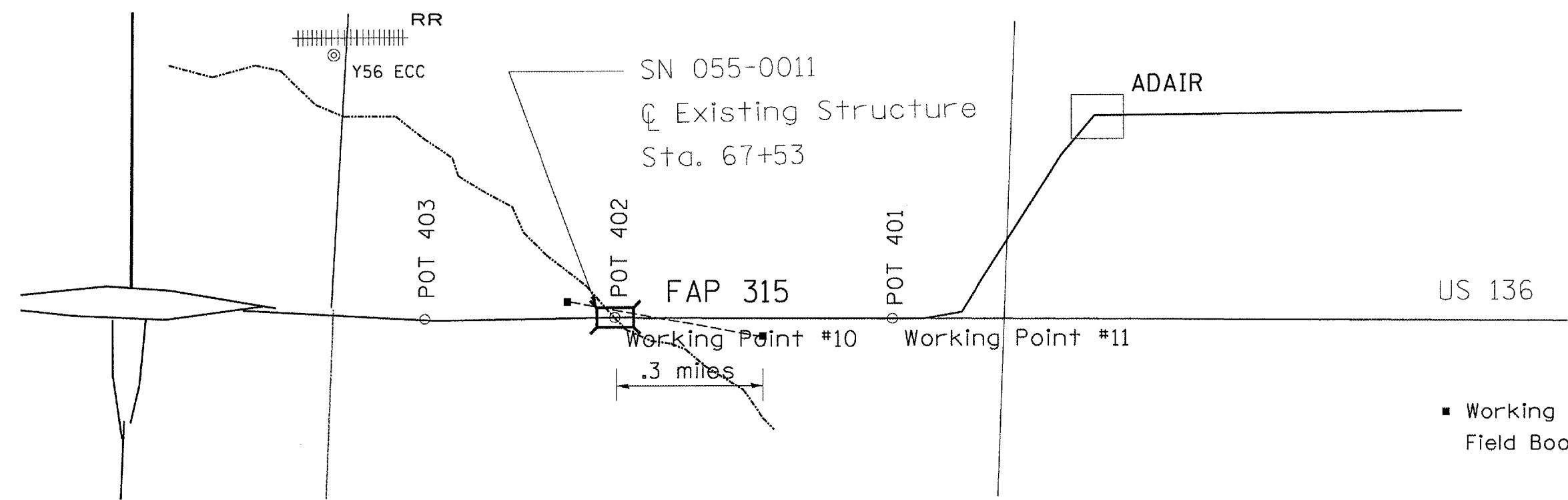

BENCHMARK:

A CHISELLED SQUARE ON THE TOP EAST SIDE OF THE SOUTH ABUTMENT S.N. 055-0011, ELEVATION 641.11

- Working Points (5/8" I.P. w/cap)
- Field Book 2800 - Various Bridges

REVISIONS	
NAME	DATE

ILLINOIS DEPARTMENT OF TRANSPORTATION
HORIZONTAL ALIGNMENT & LOCAL TIES
SCALE: 1" = 10'
DATE: MARCH, 2006
DRAWN BY: JH
CHECKED BY: FML