

PLAN

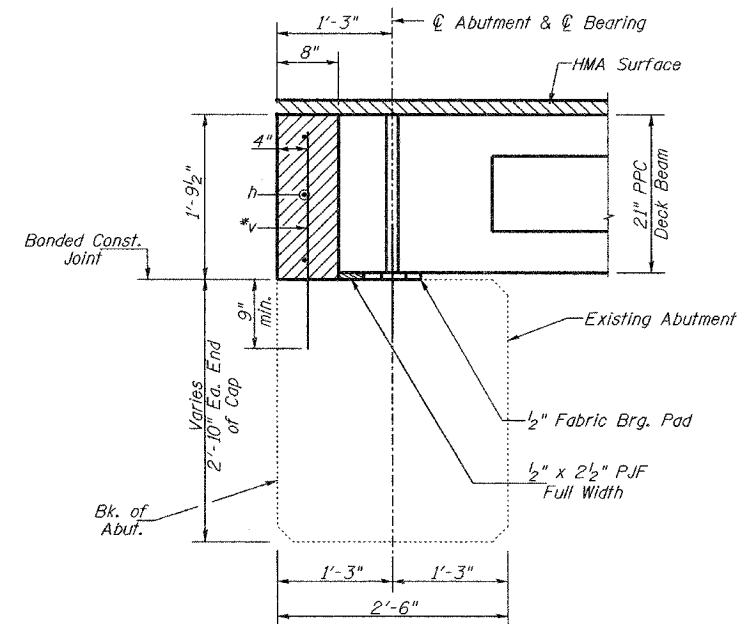

*Epoxy grout v bars in 9" min. drilled holes according to Section 584 of the Standard Specifications.

SECTION THRU ABUTMENT
(At Right Angles)

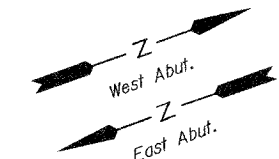
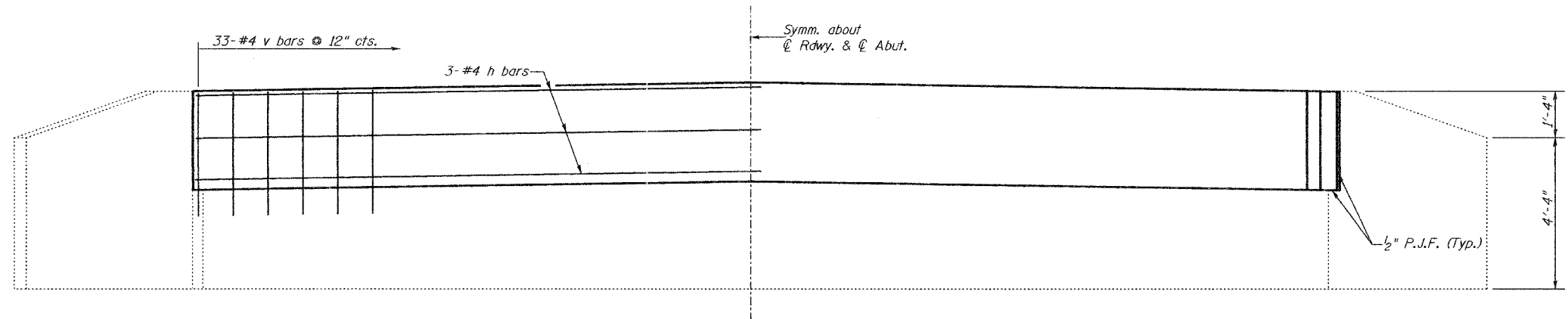

ELEVATION
(Front View of Abutment)

DESIGN STRESSES
 $f'_c = 3,500$ p.s.i.
 $f_y = 60,000$ p.s.i.

**TWO ABUTMENTS
BILL OF MATERIAL**

BAR	NO.	SIZE	LENGTH	SHAPE
h	6	#4	32'-0"	—
v	66	#4	2'-5"	—
Concrete Structures			CU YD	3.1
① Reinforcement Bars			POUND	230

① See Special Provisions

Notes:
 Minor concrete repairs to the substructure caps due to the beam removal process or for unforeseen existing conditions shall be repaired in accordance with the "Standard Specifications for Road and Bridge Construction" and to the satisfaction of the Engineer. Cost included with Concrete Structures.

Removal of all material located above abutment caps between the back of abutment and end of beams shall be removed to the satisfaction of the Engineer. The cost of the removal of this material shall be included with Removal of Existing Superstructures.

Existing curb end block monolithically poured with curb and separated from wing by P.J.F. shall be removed as part of Removal of Existing Superstructures.

**ABUTMENTS
 COUNTY HIGHWAY 19 OVER
 LITTLE INDIAN CREEK
 SECTION 07-00097-00-BR
 MORGAN COUNTY
 STATION 113+79.00**