

ROUTE No.	SECTION	COUNTY	TOTAL SHEETS	SHEET NO.
F.A.P. 827	12Z-3, 12BR	WABASH, IL GIBSON, IN	158	85
STA.		TO STA.		
F.H.W.A. REGION		ILLINOIS	PROJECT	

BRIDGE SHEET S69 OF S114 CONTRACT 94450

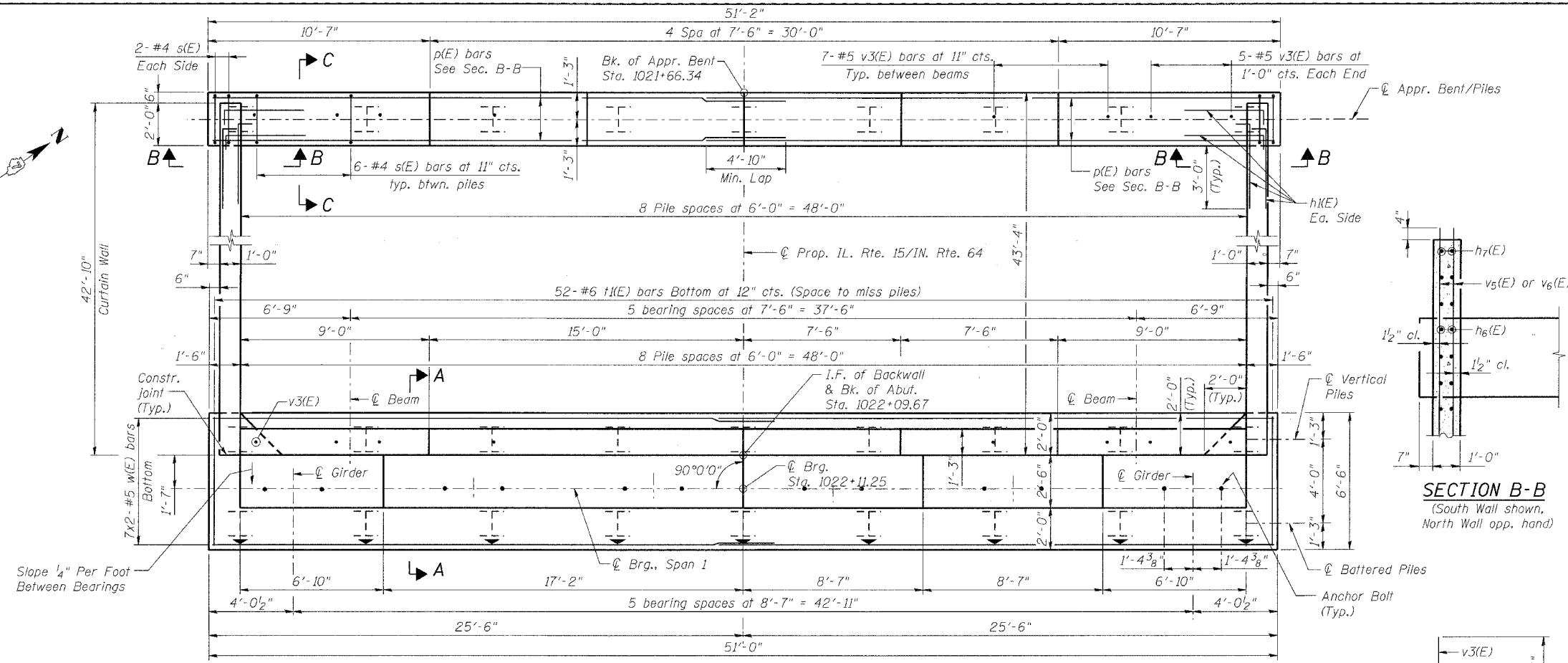

PLAN

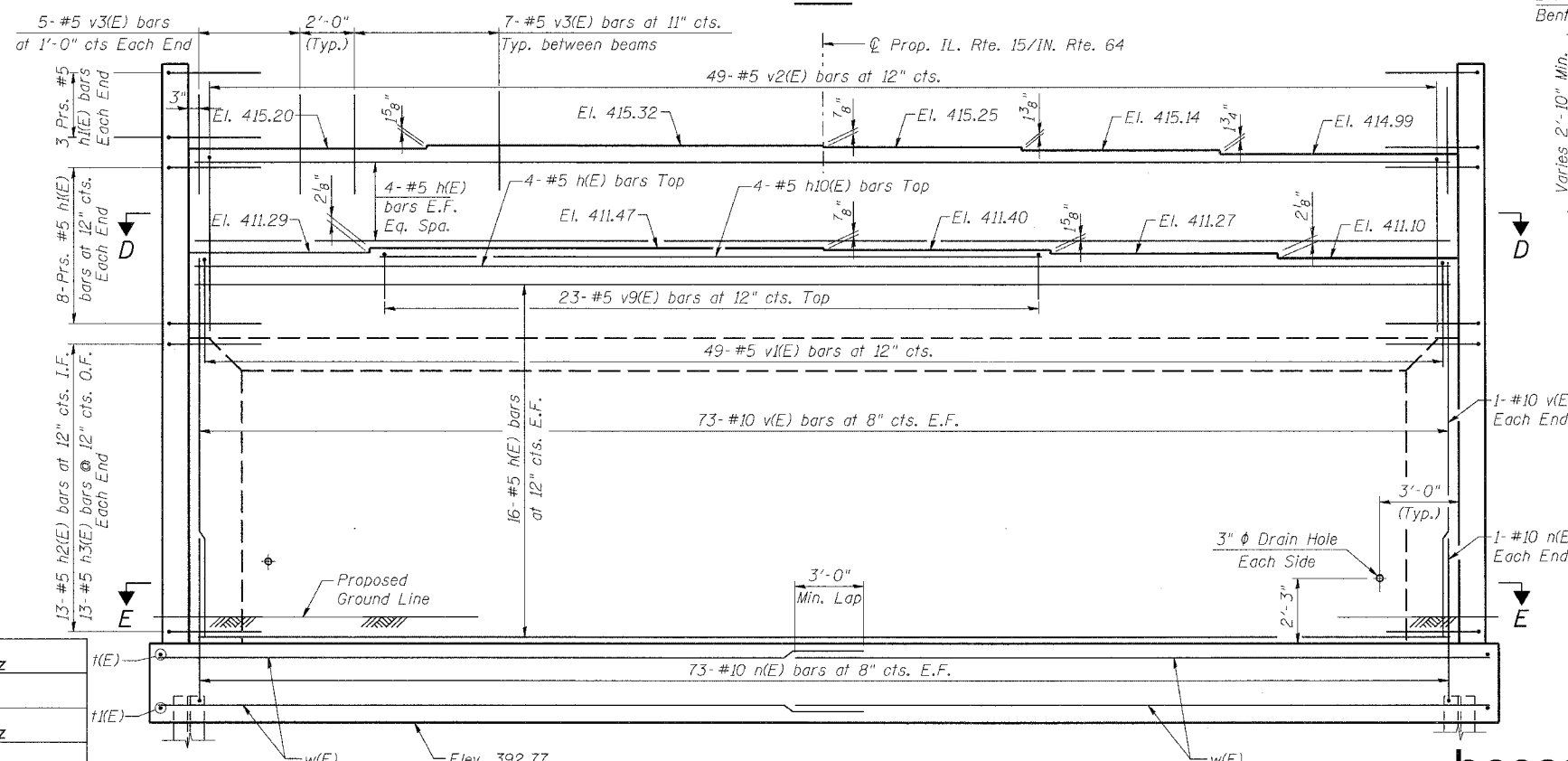

ELEVATION

SECTION B-B

(South Wall shown, North Wall opp. hand)

SECTION A-A

SECTION C-C

NOTES:

1. Space reinforcement in cap to miss anchor bolts.
2. Reinforcement bars designated (E) shall be epoxy coated.
3. Work this sheet with sheet S70.
4. Pour steps monolithically with cap.
5. For Sections D-D, E-E and F-F see Sheet S70.
6. E.F. Denotes Each Face  
I.F. Denotes Inside Face  
O.F. Denotes Outside Face
7. ▽ Denotes 3" per 12" batter.
8. Bars indicated thus: 7x2-#5 etc. indicates 7 lines of bars with 2 lengths per line.

ILLINOIS DEPARTMENT OF TRANSPORTATION  
IL ROUTE 15/IN ROUTE 64  
OVER WABASH RIVER PUBLIC WATERS  
FAP 827 SECT 12Z-3, 12BR

WEST ABUTMENT  
PLAN AND ELEVATION

SN: 093-0021 (IL)/9502700 (IN) STA. 1036+27  
WABASH CO., IL. DATE: JUNE 15, 2007



m:\proj\3426\stage\_2\structures\design\sub\subdt001.dgn

10:125 PM

6/26/2007

DESIGNED	WJZ
CHECKED	YS
DRAWN	WJZ
CHECKED	YS