

CONTRACT NO. 94967				
F.A.P. RTE.	SECTION	COUNTY	TOTAL SHEETS	SHEET NO.
327	151-2318-3	LAWRENCE	56	7
STA. 547+00		TO STA. 553+00		
FED. ROAD DIST. NO.		ILLINOIS FED. AID PROJECT		

PAVED DITCH REMOVAL

LT STA 550+24 TO 552+04 188 FOOT
 RT STA 550+15 TO 552+36 222 FOOT
 RT STA 550+50 TO 551+50 100 FOOT
 TOTAL 510 FOOT

PIPE CULVERT REMOVAL

LT STA 550+59 TO 550+98 41 FOOT

PROJECT BEGINS
STA 547+20

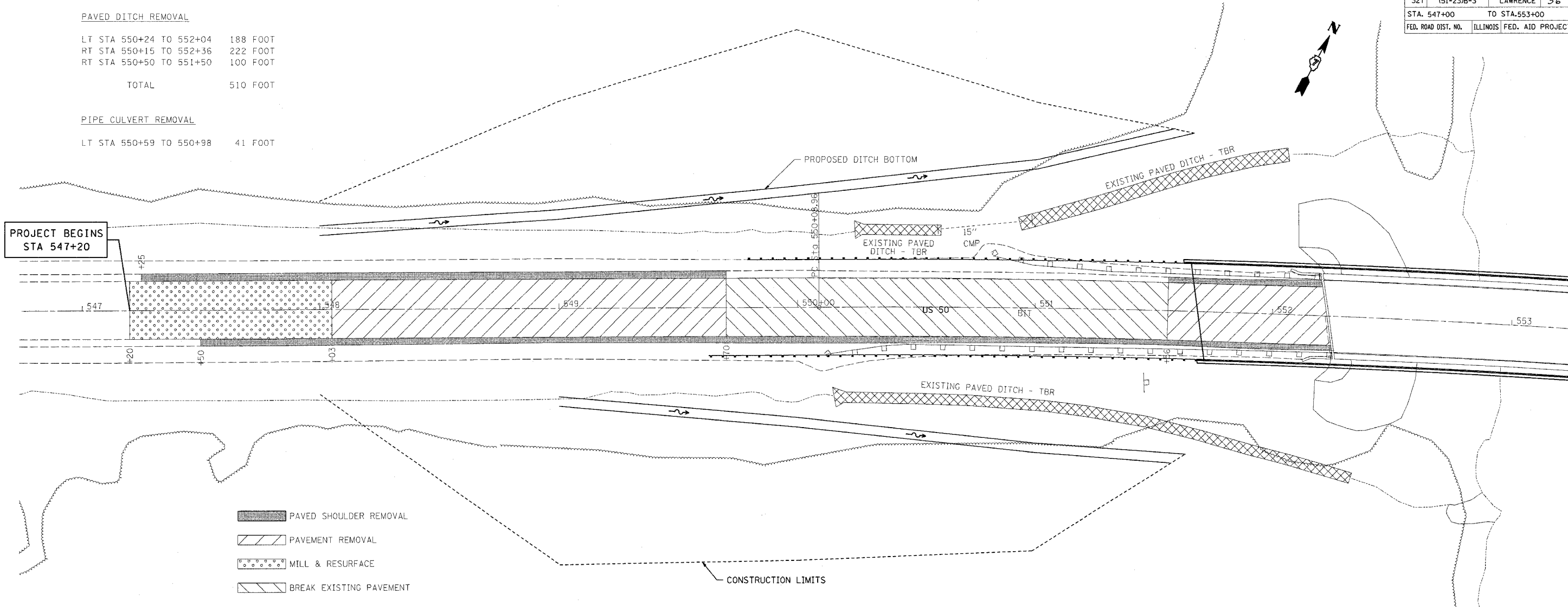

- PAVED SHOULDER REMOVAL
- PAVEMENT REMOVAL
- MILL & RESURFACE
- BREAK EXISTING PAVEMENT

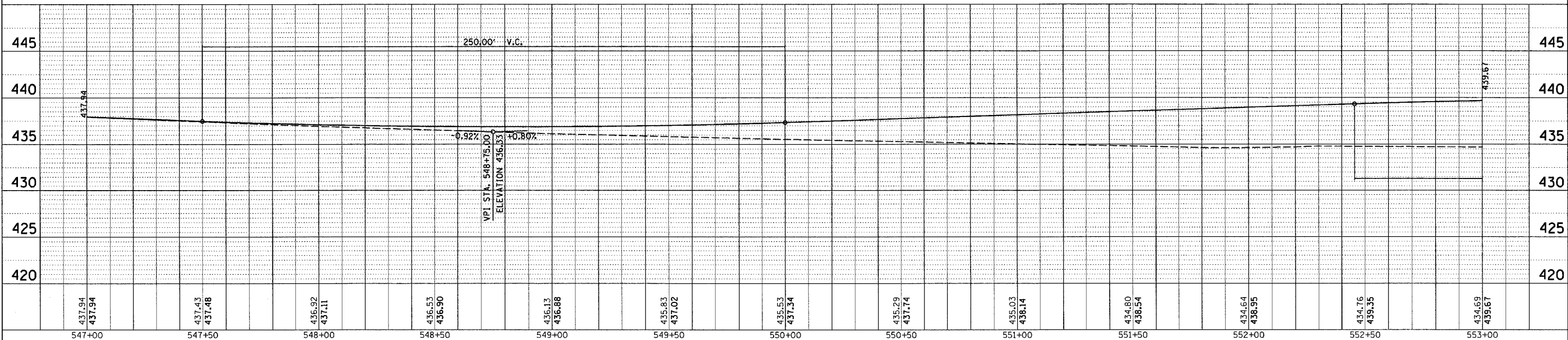

PLAN	DATE
SURVEYED	
ALIGNED	
CHECKED	
BY	
NO.	

PROFILE	DATE
SURVEYED	
GRADES	
CHECKED	
BY	
NO.	

PLOT DATE = 8/20/2007
 FILE NAME = c:\projects\94967\94967.dwg
 PLOT SCALE = 26.0000' / IN.
 USER NAME = sferfernk